

TOP FIVE II



Key features

Spa facilities: massage table, sauna

Beach Club at sea level

A fully equipped gym

Elevator serving all decks

Masseuse part of the crew

Jacuzzi forward of the master cabin

Pool on the upper deck

Zero speed stabilisers to reduce any rolling motion while at anchor

TOP FIVE II

Cruising



Aerial view



Sun deck



Upper deck



TOP FIVE II

Upper deck



Upper deck pool

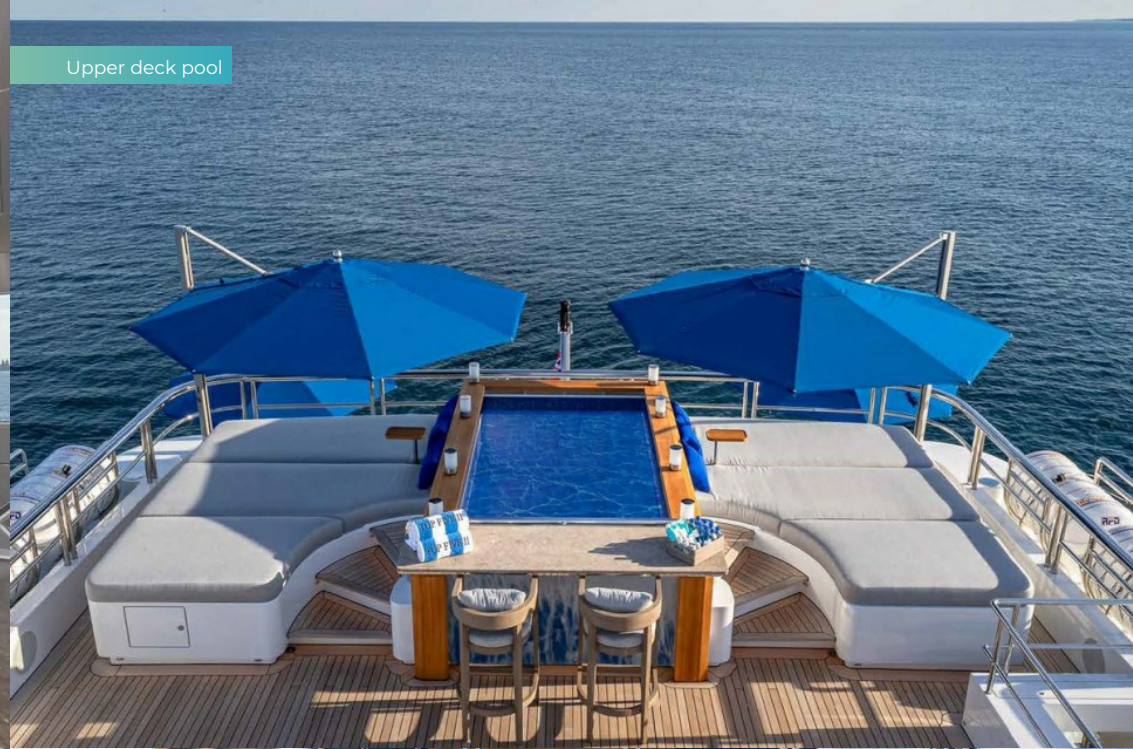

Owner's deck aft



Owner's deck aft



TOP FIVE II

Details



Main deck aft



Foredeck



Main deck lounge



TOP FIVE II

Main deck lounge



Main deck lounge



Owner's deck lounge



Owner's deck dining area



TOP FIVE II

Lower deck media room



Master cabin



Master lounge



Double cabin



TOP FIVE II

Double cabin



Double cabin



Double cabin



Twin cabin



TOP FIVE II

Balcony



Beach club gym















Stern view



TOP FIVE II

SPECIFICATION.

 Length 61m (200.1ft)	 Guests 12
 Built 2021, Royal Hakvoort Shipyard, The Netherlands	 No. of guest cabins 6 (4 × double, 2 × double/twin)
 Interior designer Sinot Yacht Architecture & Design	 Crew 19
 Beam 10.8m (35.4ft)	
 Draft 3.3m (10.8ft)	
 Gross tonnage 1,291	
 Cruising speed 12 knots	
 Maximum speed 14 knots	
 Fuel consumption at cruising speed 80 litres per hour	
 Engines 2 × 1,810hp Caterpillar	

[View yacht on website](#)

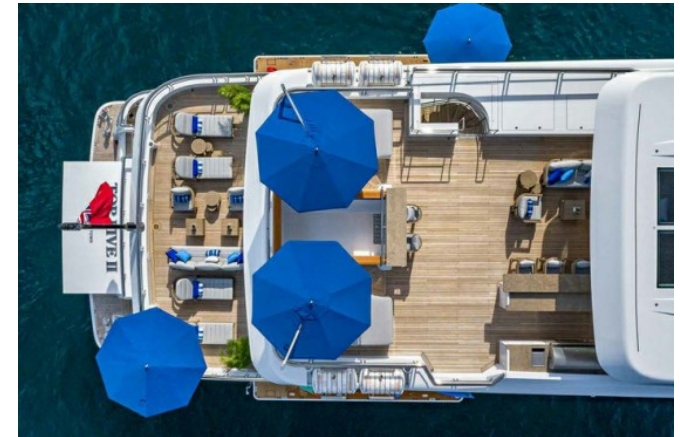

TOP FIVE II

TENDERS & TOYS



2 × Tenders



1 × Deck jacuzzi



Pool



Waterslide



Inflatable platform



4 × Waverunners



2 × SeaBobs



1 × Jetsurf



1 × eFoil



2 × Kayaks



2 × Stand up paddleboards



Wakeboard



Wakesurf



Kite surfing equipment



Waterskis



Inflatable tows



Scuba diving equipment



Fishing gear



Snorkelling gear

TOP FIVE II

FITNESS & WELLNESS



Balance trainer



Exercise balls



Free weights



Multi gym



Resistance bands



Rowing machine



Suspension trainer



Training bench



Treadmill



Upright stationary bike



Yoga mats



On board masseuse

TOP FIVE II

COMMUNICATION & ENTERTAINMENT



Wi-Fi internet access



Starlink



Indoor cinema



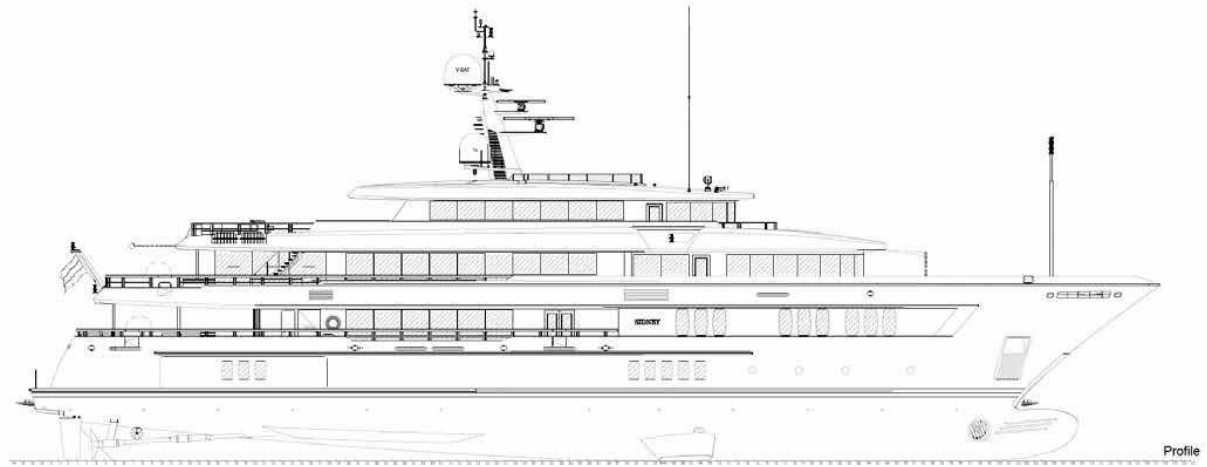

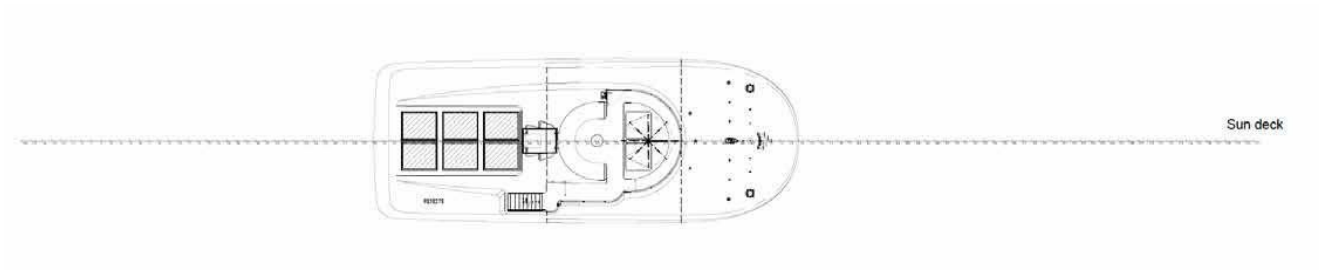

TOP FIVE II

Upper deck

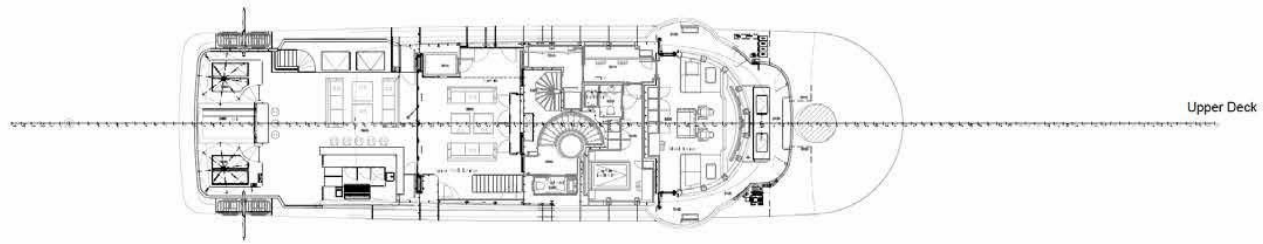

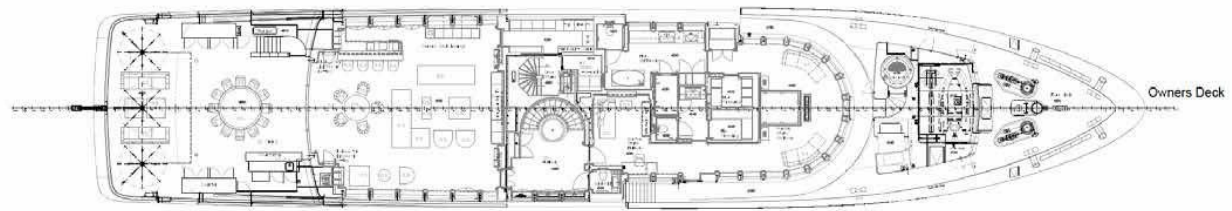

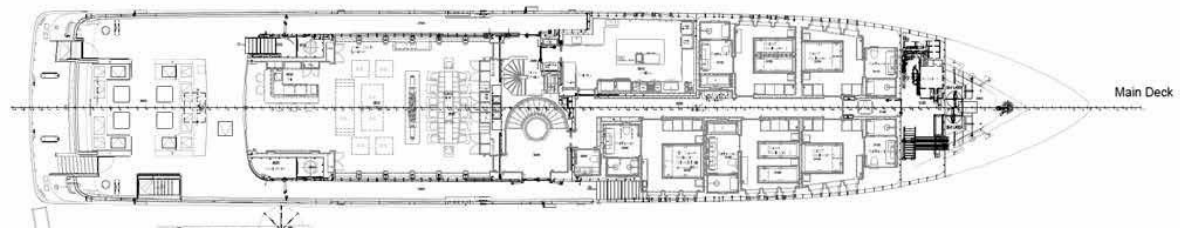

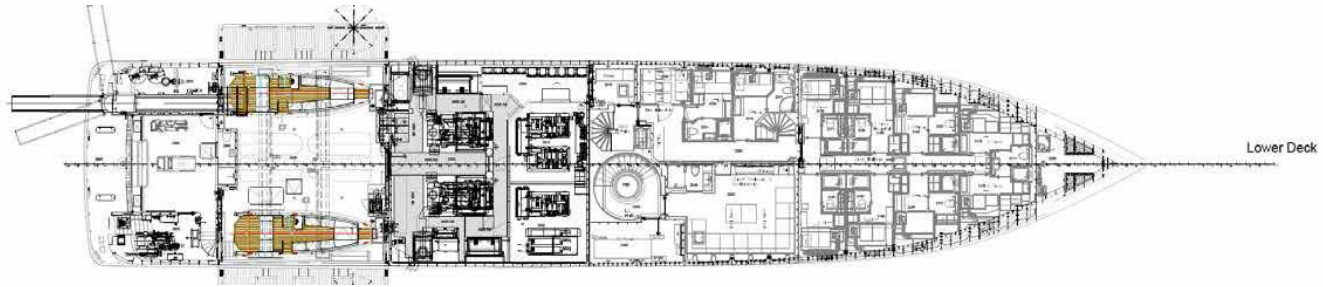

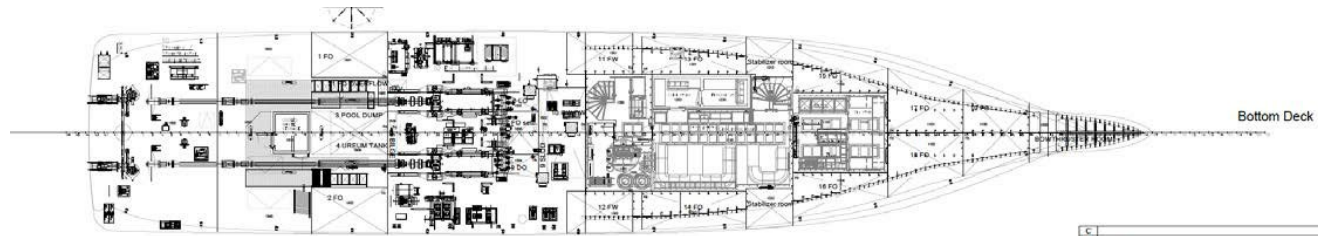

Bottom Deck

C	
B	
A	Last update 01.12.2019
Rev.	Revisions only
HAUVORT	

BURGESS

WORLD CLASS. WORLD WIDE.

London +44 20 7766 4300	Monaco +377 97 97 81 21	New York +1 212 223 0410	Miami +1 305 672 0150	Singapore +65 9665 8990	Beverly Hills +1 310 424 5112	Palma +34 971 495 413	Athens +30 210 967 1661
Dubai +971 4 425 5874	Phuket +66 7623 9739	Hong Kong +852 6496 2094	Tokyo +81 46 738 8612	Sydney +61 499 945 557	Mumbai +91 98211 67253	Shanghai +86 187 0898 6800	Rio de Janeiro +55 21 2553-3238
Aspen +1 970 710 2294							

Advertising of these vessel(s) in printed publications, on the internet or in any other medium is not permitted without prior written permission from Burgess. All particulars are given in good faith and are believed correct but they cannot be guaranteed.

Last updated: 21 January 2025