

# THE BEAST

---



THE BEAST

# OVERVIEW.

**THE BEAST is robust, rugged, and ready for adventures across the South Pacific, accommodating 12 guests. A 13m (42.7ft) 19-tonne, fully kitted-out custom sports tender, BABY BEAST, accompanies her. Freezer rooms and live bait tanks cater to serious big game fishing enthusiasts. A shallow 2.5m (8.2ft) draft allows access to secluded locations inaccessible to other yachts.**

Inspired by military vessels, yet uncompromising when it comes to luxury and comfort inside and out, THE BEAST was built for an extremely experienced owner and delivered in 2019 by New Zealand shipyard Profab Engineering. Her refined muscularity earned her a World Superyacht Award in 2020 for yachts under 499GT.

After experiencing the natural world up close, guests can celebrate their catch at the sun deck's sit-up bar, enjoying it freshly grilled Teppanyaki-style. Relaxation options include the forward observation lounge forward or sun loungers aft. Further open-air dining is available on the bridge deck aft, along with lounge areas fore and aft for after-dinner drinks. An intimate shaded lounge on the main deck aft offers a tranquil space to watch the world go by as you explore the open water.

Inside, cool, contemporary relaxed interiors are bathed in natural light, giving guests opportunities to make the most of the spectacular views. The bridge deck features a media lounge where you can watch footage of the day's action and there is formal dining and a lounge on the main deck.

More than just a luxurious charter yacht with a crew of nine, THE BEAST possesses a thirst for thrills, an appetite for action and a crew that can't wait to deliver both. If that sounds like something you need in your life, get in touch and organise your yacht charter with Burgess today.

## Key features

---

**Winner of best Displacement Motor Yachts Below 499GT - 30m to 39.9m at The World Superyacht Awards 2020**

---

**Three VIP cabins on the main deck**

---

**Exercise equipment**

---

**A Schiller Water Bike pedal powered catamaran - Schiller Bike**

---

**Dedicated fishing tender**

---

**A good choice of exterior and interior dining areas**

---

**Advanced stabilisation technology used in the hull design**

---



# THE BEAST

At anchor



Sun deck with Teppanyaki set-up



Teppanyaki grill



Bridge deck dining area





## THE BEAST

Bridge deck dining area

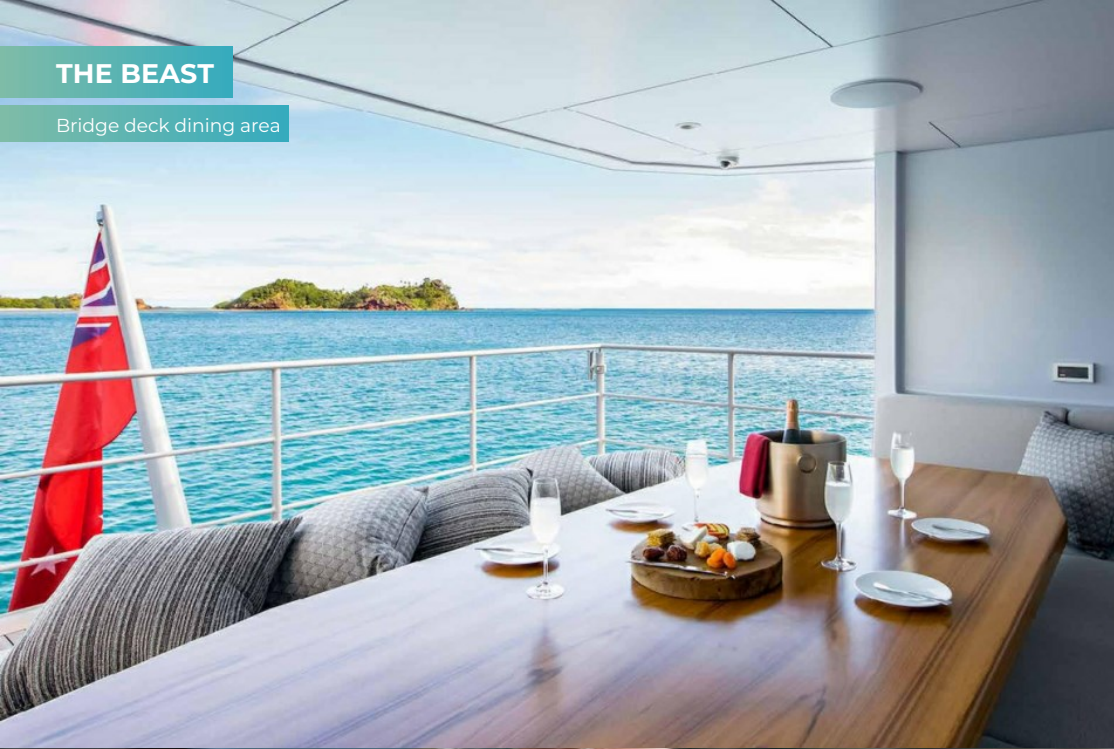

Breakfast set-up



Cocktails



Wheelhouse from the bow





# THE BEAST

Main deck dining area and lounge



Main deck lounge



Main deck dining area



Sky lounge





# THE BEAST

Office and design studio



# Hallway



# Master cabin



# Double cabin





# THE BEAST

Convertible double/twin cabin



Bunk bed cabin



Sports fishing boat



Sports fishing boat





# THE BEAST

Tender



Toys



Fishing equipment



Stern view





# THE BEAST

Cruising



At anchor





## THE BEAST

# SPECIFICATION.



Length  
**39.2m (128.6ft)**



Built  
**2019, ProFab Central Engineering Ltd**



Beam  
**12m (39.4ft)**



Draft  
**2.5m (8.2ft)**



Gross tonnage  
**493**



Cruising speed  
**10 knots**



Maximum speed  
**13 knots**



Fuel consumption at cruising speed  
**210 litres per hour**



Guests  
**12**



No. of guest cabins  
**5 (3 × double, 2 × double/twin, 2 × additional berths)**



Crew  
**9**

[View yacht on website](#)

[Watch yacht video](#)





THE BEAST

# TENDERS & TOYS



1 x Towed tender



2 x Tenders



6 x Kayaks



2 x Stand up paddleboards



Pedal board



Wakeboard



Waterskis



Scuba diving equipment



Snorkelling gear



Fishing gear



THE BEAST

# FITNESS & WELLNESS



Free weights



Upright stationary bike



Yoga mats





THE BEAST

# COMMUNICATION & ENTERTAINMENT



Satcom & cellular communications facilities



Wi-Fi internet access



Satellite television



Streaming services





# THE BEAST

Profile

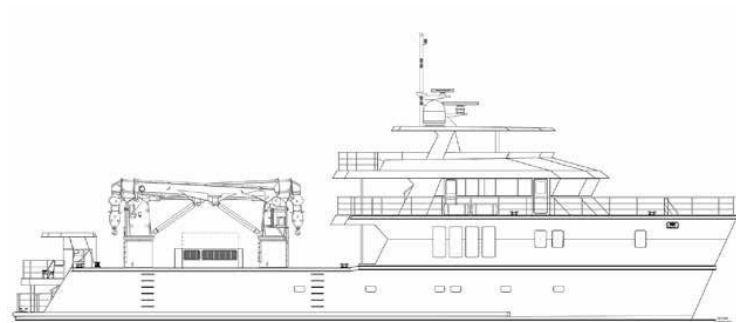



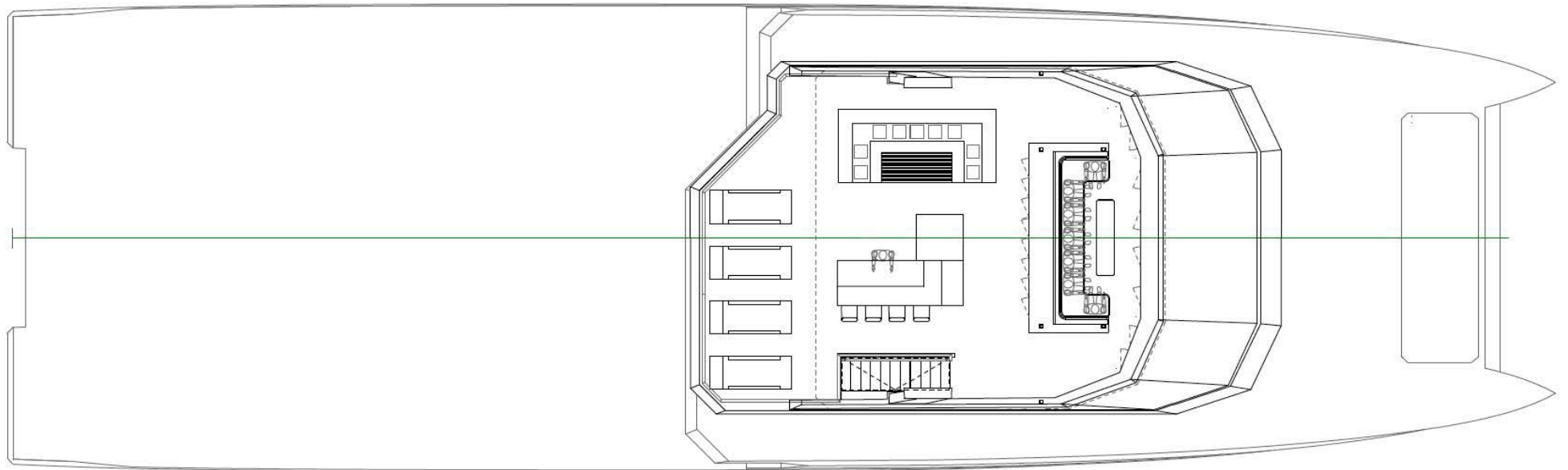

SUN DECK



# THE BEAST

Bridge deck

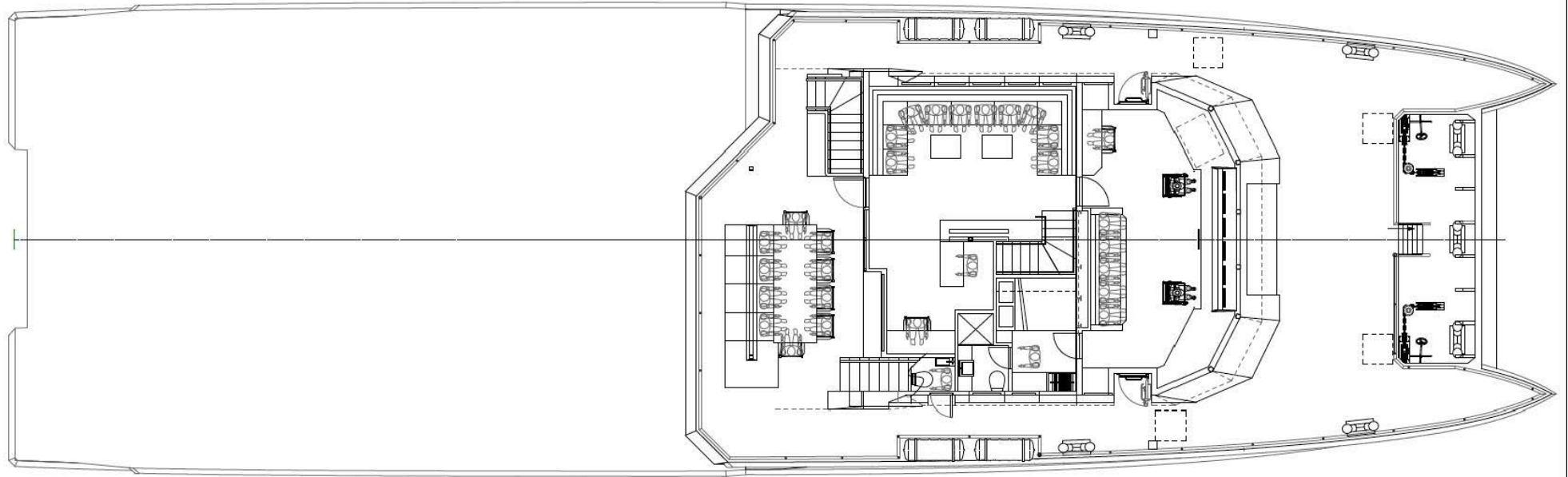

BRIDGE DECK



# THE BEAST

Main deck

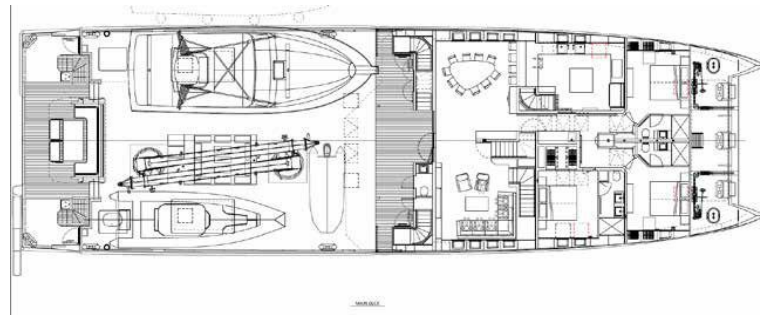



# THE BEAST

Lower deck

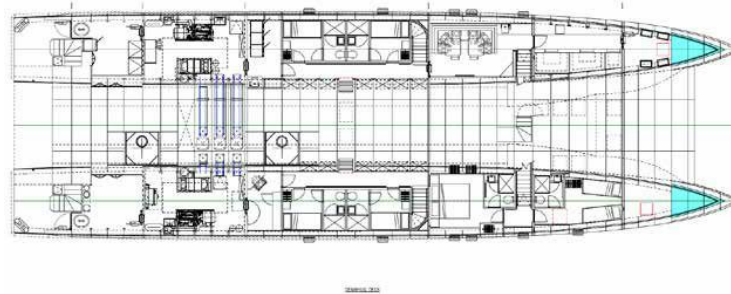



# BURGESS

# WORLD CLASS. WORLD WIDE.

<b>London</b> +44 20 7766 4300	<b>Monaco</b> +377 97 97 81 21	<b>New York</b> +1 212 223 0410	<b>Miami</b> +1 305 672 0150	<b>Singapore</b> +65 9665 8990	<b>Beverly Hills</b> +1 310 424 5112	<b>Palma</b> +34 971 495 413	<b>Athens</b> +30 210 967 1661
<b>Dubai</b> +971 4 425 5874	<b>Phuket</b> +66 7623 9739	<b>Hong Kong</b> +852 6496 2094	<b>Tokyo</b> +81 46 738 8612	<b>Sydney</b> +61 499 945 557	<b>Mumbai</b> +91 98211 67253	<b>Shanghai</b> +86 187 0898 6800	<b>Rio de Janeiro</b> +55 21 2553-3238
<b>Aspen</b> +1 970 710 2294							

Advertising of these vessel(s) in printed publications, on the internet or in any other medium is not permitted without prior written permission from Burgess. All particulars are given in good faith and are believed correct but they cannot be guaranteed.

Last updated: 03 March 2025