

THE BEAST



THE BEAST

OVERVIEW.

THE BEAST is robust, rugged and ready for adventures across the South Pacific. Scuba diving for 12 guests. A 13m (42.7ft), 19-tonne fully kitted-out custom sports tender known as BABY BEAST. Freezer rooms and live bait tanks for the serious big game fisher. Shallow 2.5m (8.2ft) draft to get into places other yachts can't.

Inspired by military vessels but unashamedly luxurious inside and out, THE BEAST was built for an extremely experienced owner and delivered in 2019 by New Zealand shipyard Profab Engineering. Her refined muscularity was immediately recognised when she won a World Superyacht Award in 2020 for yachts under 499GT.

After getting up close and personal with the natural world, her 12 guests can toast their catch at the sun deck's sit-up bar then enjoy it freshly grilled Teppanyaki-style before gathering at the observation lounge forward or stretching out on the sun loungers aft. There's more open air dining on the bridge deck aft as well as lounge areas fore and aft for your digestif and another intimate shaded lounge on the main deck aft where you can watch the miles unwind.

Inside she has cool, contemporary relaxed interiors with generous natural light in all guest areas to make the most of the spectacular views. The bridge deck has a media lounge where you can watch footage of the day's action and there is formal dining and a lounge on the main deck.

This is not just a luxurious charter yacht with a crew of nine. This is a yacht with a thirst for thrills, an appetite for action and a crew that can't wait to deliver both. If that sounds like something you need in your life, get in touch.

Key features

Winner of best Displacement Motor Yachts Below 499GT - 30m to 39.9m at The World Superyacht Awards 2020

Three VIP cabins on the main deck

Exercise equipment

A pedal powered catamaran - Schiller Bike

Dedicated fishing tender

A good choice of exterior and interior dining areas

Advanced stabilisation technology used in the hull design

THE BEAST

At anchor



Sun deck with Teppanyaki set-up



Teppanyaki grill



Bridge deck dining area



THE BEAST

Bridge deck dining area

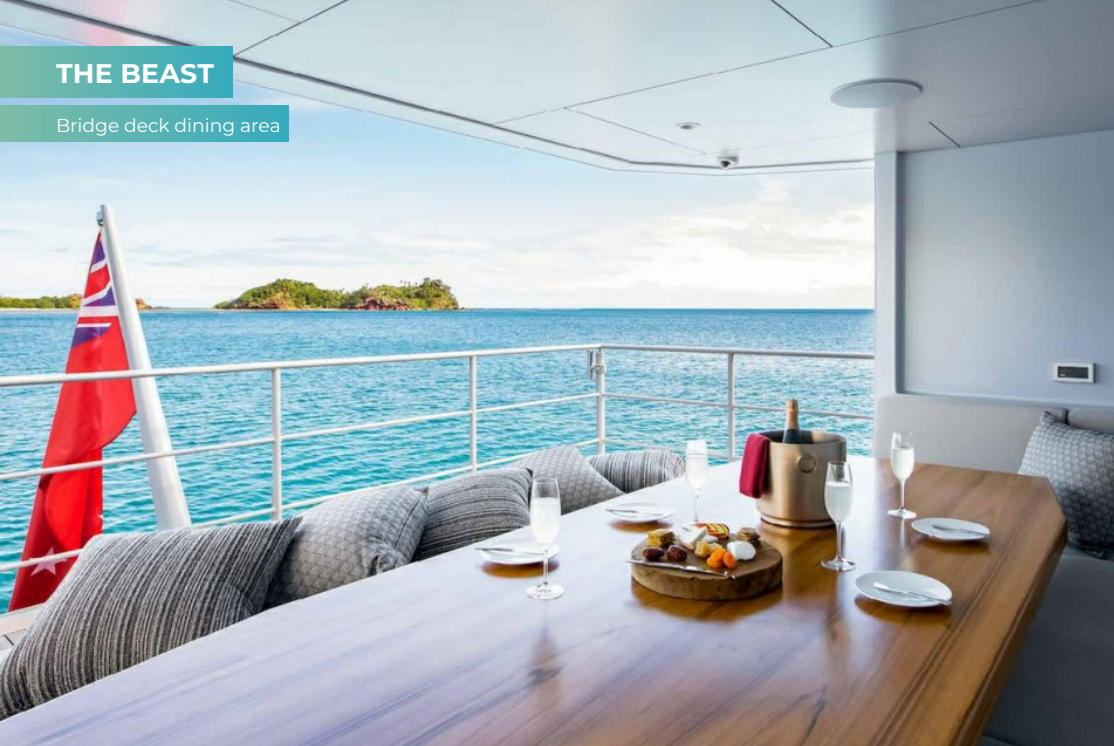

Breakfast set-up



Cocktails



Wheelhouse from the bow

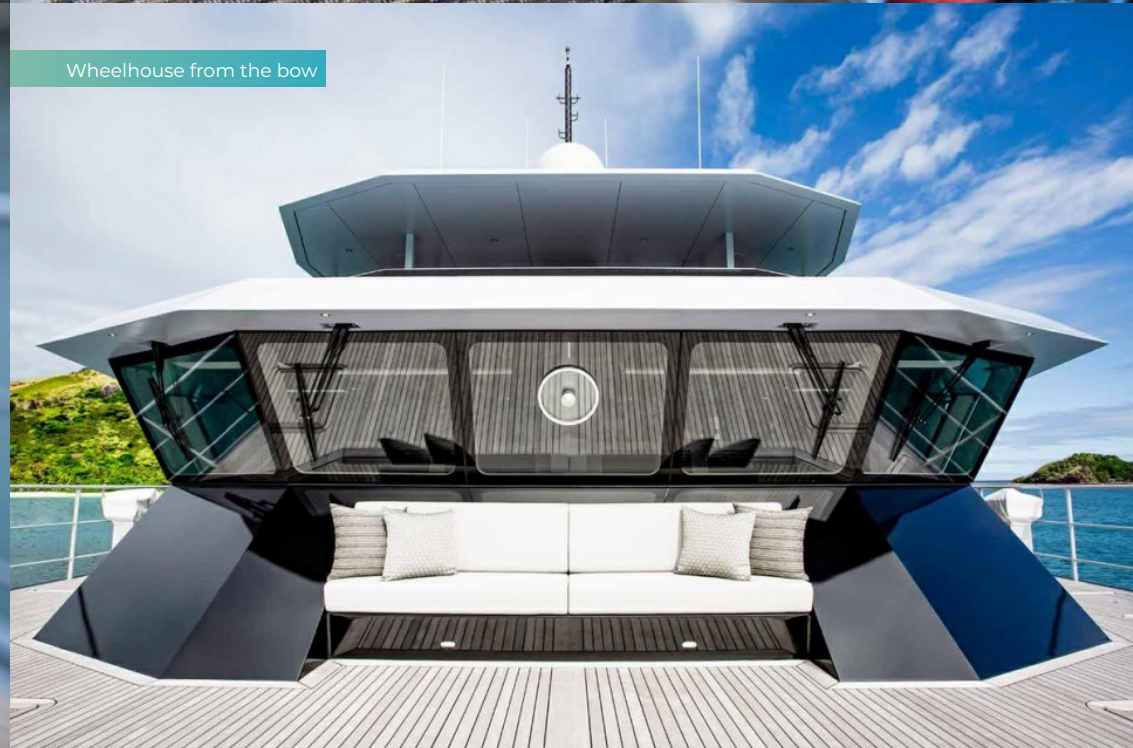

BURGESS

Discover the difference.
burgessyachts.com



THE BEAST

Main deck dining area and lounge



Main deck lounge



Main deck dining area



Sky lounge



THE BEAST

Office and design studio



Hallway



Master cabin



Double cabin



THE BEAST

Convertible double/twin cabin



Bunk bed cabin



Sports fishing boat



Sports fishing boat

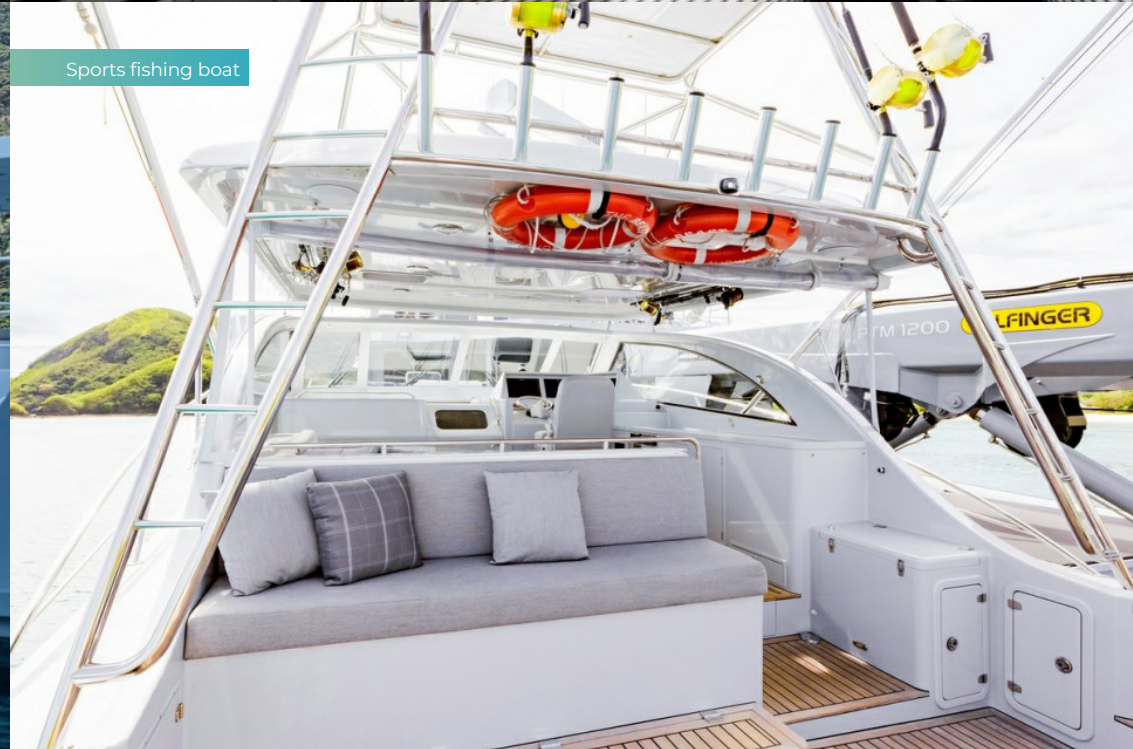

BURGESS

Discover the difference.
burgessyachts.com



THE BEAST

Tender



Toys



Fishing equipment



Stern view



BURGESS

Discover the difference.
burgessyachts.com



THE BEAST

Cruising



At anchor



BURGESS

Discover the difference.
burgessyachts.com



THE BEAST

SPECIFICATION.



Length
39.2m (128.6ft)



Built
2019, ProFab Central Engineering Ltd



Beam
12m (39.4ft)



Draft
2.5m (8.2ft)



Gross tonnage
493



Cruising speed
10 knots



Maximum speed
13 knots



Fuel consumption at cruising speed
210 litres per hour



Guests
12



No. of guest cabins
5 (3 × double, 2 × double/twin, 2 × additional berths)



Crew
9

[View yacht on website](#)

[Watch yacht video](#)



THE BEAST

EQUIPMENT.

Tenders & toys



1 × Towed tender



2 × Tenders



Wakeboard



Waterskis



6 × Kayaks



Scuba diving equipment



2 × Stand up paddleboards



Fishing gear



Pedal board



Snorkelling gear

Fitness & wellness



Free weights



Upright stationary bike



Yoga mats

THE BEAST

Profile

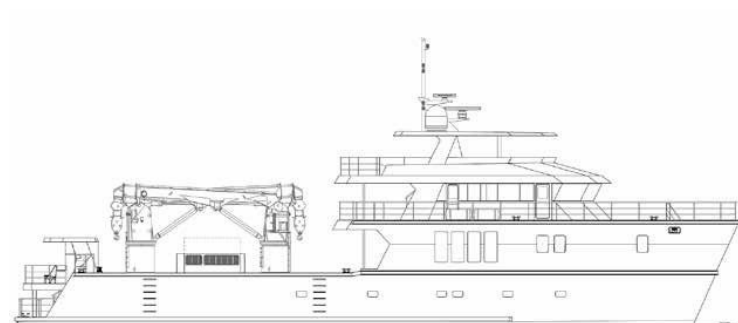

THE BEAST

Sun deck

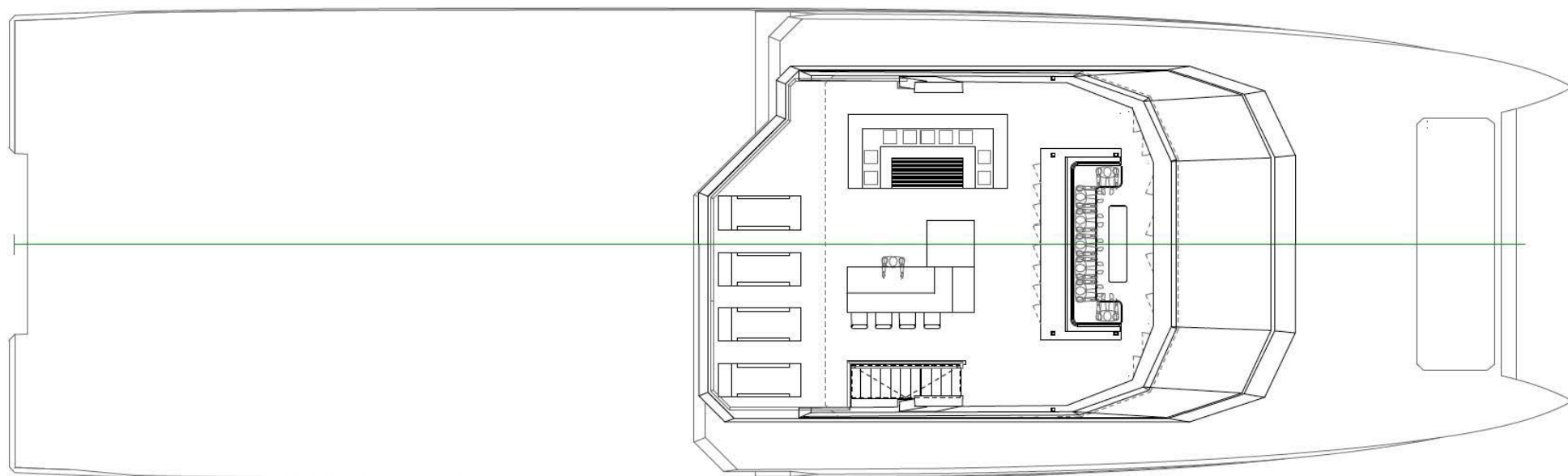

SUN DECK

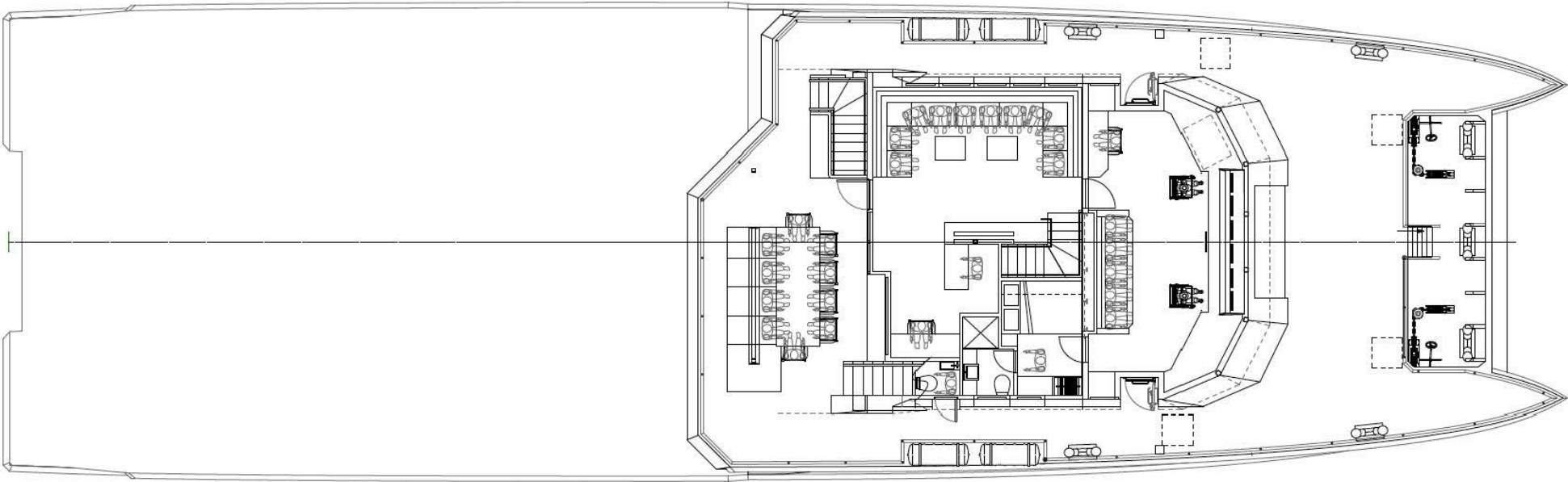

BRIDGE DECK

THE BEAST

Main deck

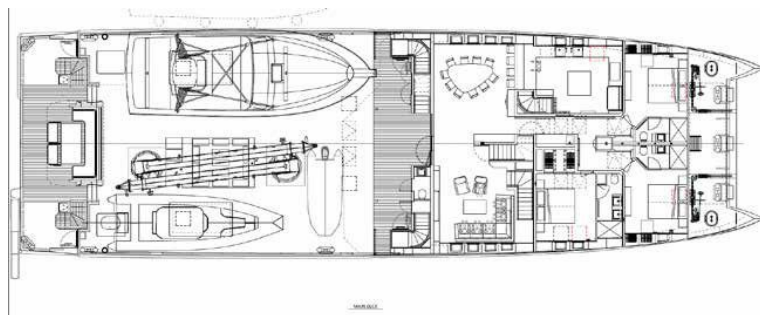

THE BEAST

Lower deck

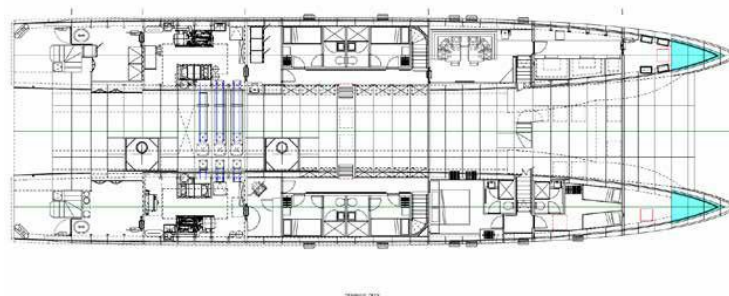

BURGESS

WORLD CLASS. WORLD WIDE.

London +44 20 7766 4300	Monaco +377 97 97 81 21	New York +1 212 223 0410	Miami +1 305 672 0150	Singapore +65 9665 8990	Beverly Hills +1 310 424 5112	Palma +34 971 495 413	Athens +30 210 967 1661
Dubai +971 4 425 5874	Phuket +66 7623 9739	Hong Kong +852 6496 2094	Tokyo +81 46 738 8612	Sydney +61 499 945 557	Mumbai +91 98211 67253	Shanghai +86 187 0898 6800	Rio de Janeiro +55 21 2553-3238

Advertising of these vessel(s) in printed publications, on the internet or in any other medium is not permitted without prior written permission from Burgess. All particulars are given in good faith and are believed correct but they cannot be guaranteed.

Last updated: 12 September 2024