

TALISMAN MAITON



OVERVIEW.

Boasting an enormous open plan sun deck and an eclectically styled interior with Art Deco features, TALISMAN MAITON is a perennially popular charter yacht.

Her eye-catching interior blends Asian influences with Art Deco touches to create lavish entertaining spaces that are also supremely comfortable to live in. The more formal main salon and dining area is offset by the relaxed setting of the sky lounge, with its large, curving corner sofa and wide opening onto the bridge deck aft.

TALISMAN MAITON has fantastic outdoor spaces, with extensive covered seating, al fresco dining areas and a platform above the sun deck offering sensational 360 degree views at sunset. The sun deck was made for sunbathing, with sun pads angled in every direction to catch the sun, and a shaded area mid-ships that houses a bar and dining table. The forward-facing jacuzzi is a pool with a view, and low profile glass shields surround the forward section to provide shelter from the wind. Six individually styled "boutique" cabins provide sumptuous accommodation for 12 guests. The eclectic master suite has an adjoining dressing room, an office and an en suite bathroom with a jacuzzi bath and shower. The VIP cabin is also positioned on the main deck, while the two double and two double/twin convertible cabins (each with a pullman berth) are located on the lower deck.

With an on board gym and plenty of hair-raising watersports equipment, TALISMAN MAITON offers the full superyacht experience.

Key features

Master and VIP cabins on the main deck

Office adjoining master cabin

The twin cabins convert to offer six double cabins in total

Gym

Vast sun deck

Zero speed stabilisers to reduce any rolling motion while at anchor

TALISMAN MAITON

Sun deck jacuzzi



Main deck lounge



Main deck bar area



Cocktails



BURGESS

Discover the difference.
burgessyachts.com



TALISMAN MAITON

Main deck dining



Detail



Master cabin



Master en suite



TALISMAN MAITON

Master office



VIP cabin



VIP cabin bathroom



Double cabin



TALISMAN MAITON

Double cabin



Convertible double/twin cabin



Convertible double/twin cabin



Bridge



TALISMAN MAITON

Games room



Bridge deck lounge



Bridge deck dining



Bridge deck



TALISMAN MAITON

Bridge deck



Sun deck



Sun deck dining area

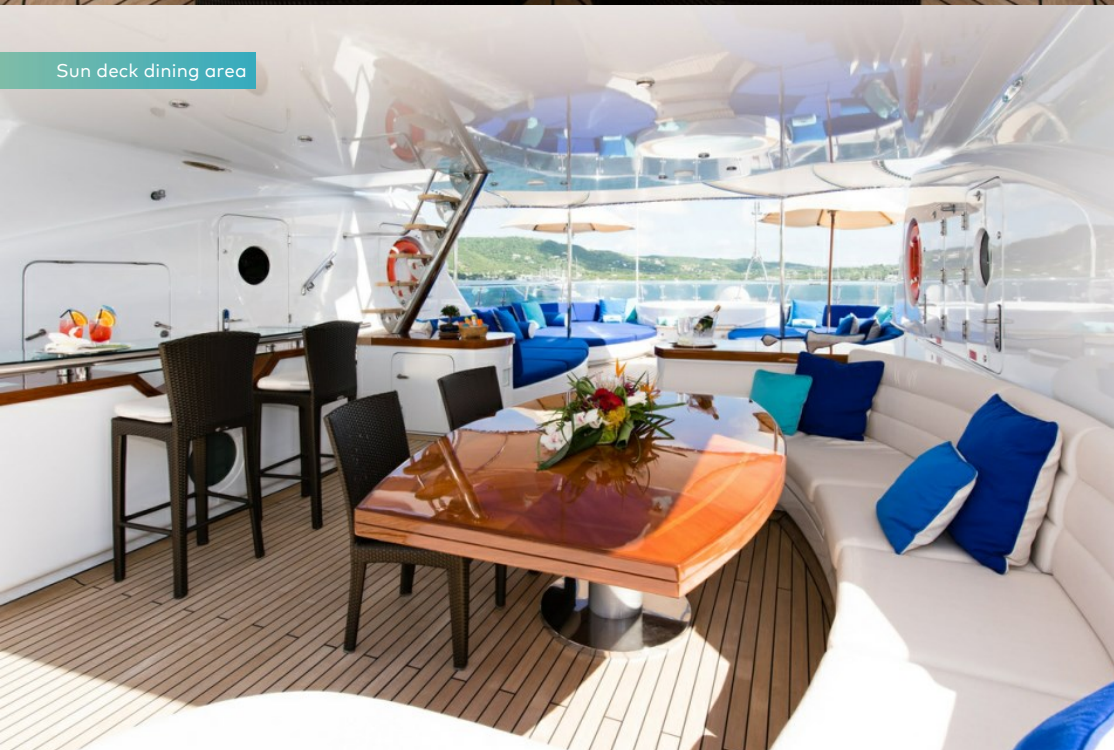

Portuguese bridge



BURGESS

Discover the difference.
burgessyachts.com



TALISMAN MAITON

Gym



Cruising



At anchor



BURGESS

Discover the difference.
burgessyachts.com



TALISMAN MAITON

SPECIFICATION.



Length
54.2m (177.8ft)



Built
2006 (refurbished 2012), Proteksan Turquoise,
Turkey



Interior designer
H2 Yacht Design



Beam
9.3m (30.5ft)



Draft
3.1m (10.2ft)



Gross tonnage
692



Cruising speed
13 knots



Maximum speed
16 knots



Fuel consumption at cruising speed
230 litres per hour



Engines
2 x 1,500hp Caterpillar



Guests
12



No. of guest cabins
6 (4 x double, 2 x double/twin, 2 x additional
berths)



Crew
13

Note













Fully licensed for charters in Spanish waters.

[View yacht on website](#)

[Watch yacht video](#)



Tenders & toys

-  2 × Tenders
-  1 × Deck jacuzzi
-  RYA training centre for jetskis & waverunners
-  2 × Waverunners
-  2 × SeaBobs
-  2 × Kayaks
-  2 × Stand up paddleboards
-  Wakeboard
-  Kneeboard
-  Waterskis
-  Inflatable tows
-  Fishing gear
-  Snorkelling gear

6.2m Castoldi tender with 260hp engine, 5m Polaris tender with 80hp engine, 2 x Yamaha EX Deluxe 1049cc waverunners (3 man), waterskis, wakeboards, kneeboard & tows, 2 x inflatable stand up paddle boards, 3 x inflatable kayaks (2 man), inflatable lounge, fishing gear, snorkelling gear, approved RYA training centre for guests' use of personal watercraft (jetskis)

Fitness & wellness



Free weights



Pedal bike



Training bench



Treadmill



Upright stationary bike

Running machine, bicycle, adjustable free weights, adjustable kettlebell, gym bench

Communication & entertainment

Comprehensive audio-visual systems, satellite television, Sony Playstation 4, satellite & cellular communications facilities, VSAT, Wi-Fi internet access, PC stations for guest use

UPPER DECK

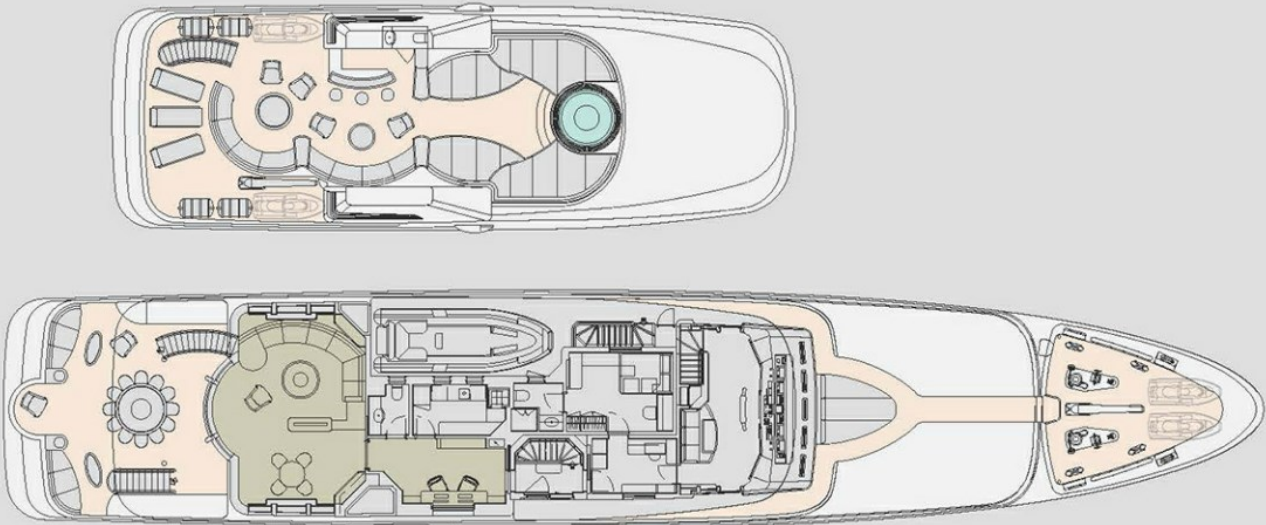

MAIN DECK

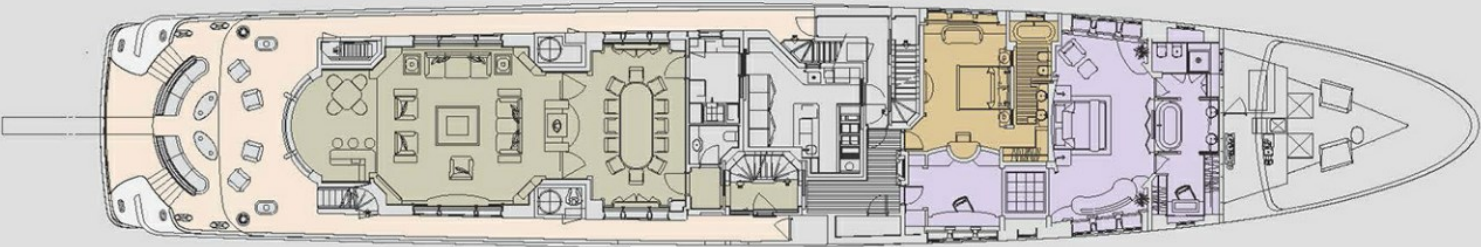

LOWER DECK

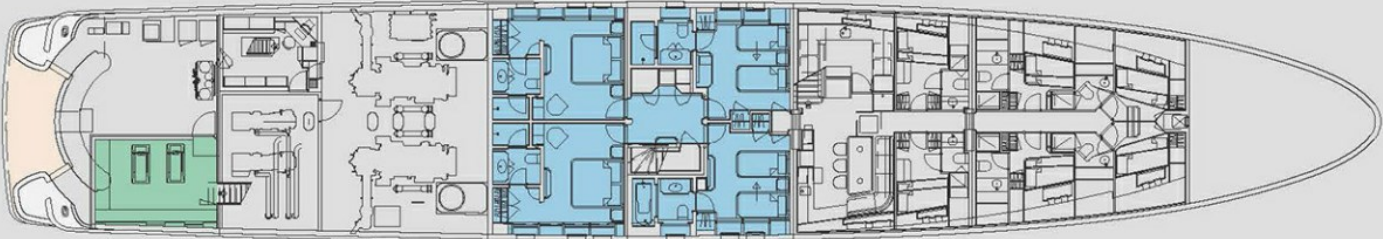

Living Areas

Master Suite

VIP Cabin

Guest Cabins

Gym

Jacuzzi

BURGESS

WORLD CLASS. WORLD WIDE.

London +44 20 7766 4300	Monaco +377 97 97 81 21	New York +1 212 223 0410	Miami +1 305 672 0150	Singapore +65 9665 8990	Beverly Hills +1 310 424 5112	Palma +34 971 495 413	Athens +30 210 967 1661
Dubai +971 4 425 5874	Phuket +66 7623 9739	Hong Kong +852 6496 2094	Tokyo +81 46 738 8612	Sydney +61 499 945 557	Mumbai +91 98211 67253	Shanghai +86 187 0898 6800	

Advertising of these vessel(s) in printed publications, on the internet or in any other medium is not permitted without prior written permission from Burgess. All particulars are given in good faith and are believed correct but they cannot be guaranteed.

Last updated: 15 April 2024