

# TALISMAN C

---



# OVERVIEW.

This immaculate 70.5m yacht was commissioned by the owner of a 54.2m yacht who wanted more space for family fun, more deck space, more toy storage, more room throughout. She has literally been designed and built for family fun.

Glass screens allow a perfect view of sunset over the anchorage from the day beds in the crow's nest and removable awnings deliver shade when needed. The sun deck below has a huge jacuzzi and a shower forward of a sit-up bar and a shaded al fresco dining area with plenty of space aft for activities. There's a 50in screen for movie nights too.

Lounge on the upper deck aft with a sit-up bar to keep everyone hydrated and an informal dining table for afternoon snacking. Inside is a daybed perfectly positioned for reviving snoozes and further forward is a comfortable lounge area with a 65in TV so you can drop the blinds and enjoy movies - or karaoke. There's a games room forward, which doubles as a study.

The staircase has a skylight above lighting an art installation by Crystal Caviar. It leads down to the main deck, with dedicated gym forward. Aft is an impressively large main saloon, stylish but welcoming, and a formal dining area forward, each with feature lighting. Outside is a raised sun lounger and two lounge areas separated by steps down to the amazing beach club.

Opening the huge toy locker with shell doors either side reveals a Novurania Chase 23 for getting ashore and exploring plus a Ski Nautique Super Air Nautique 230 for waterskiing and tow toys for getting thrills on the water. Add to that three Sea-Doos, four SeaBobs, kitesurfing kit and more and you have a yacht that can deliver huge smiles every day.

The master suite is forward on the main deck and features 180-degree views from the comfort of a vast bed. There's also a split-level bathroom, a walk-in wardrobe - even a private library to port that doubles as a wellness centre. To starboard is a VIP double cabin and there are two further double cabins and two twin cabins on the lower deck, making her well suited to family parties of up to 12 in six cabins. Also aboard are 19 expert crew who can't wait to welcome you aboard and help you create unforgettable memories.

## Key features

---

**Split level master suite, en suite with Neptune bath, separate shower plus large dressing room**

---

**Massage room with masseuse and beautician on board**

---

**VIP cabin on main deck**

---

**Main deck gym with treadmill, bikes and free weights**

---

**Observation deck or 'crow's nest' giving stunning views and perfect for sundowners**

---

**Oversized glass fronted jacuzzi on the sun deck**

---

**Zero speed stabilisers to reduce any rolling motion while at anchor**

---

TALISMAN C

Main deck lounge



Main deck bar



Main deck dining area



Hallway



TALISMAN C

Owner's cabin



Owner's cabin



Owner's bathroom en suite



Owner's dressing



TALISMAN C

VIP suite



VIP bathroom en suite



Staircase



Double cabin



# TALISMAN C

Double cabin bathroom en suite



Double cabin



Double cabin bathroom en suite



Twin cabin



TALISMAN C

Twin cabin bathroom en suite



Twin cabin



Twin cabin bathroom en suite



Sky lounge



# TALISMAN C

Sky lounge



Gym



Wellness area



Main deck aft





# TALISMAN C

Bridge deck aft



Bridge deck dining



Bridge deck seating area



Sun deck aft



# TALISMAN C

Sun deck dining



Sun deck jacuzzi



Sun deck jacuzzi



Observation deck



# TALISMAN C

Swim platform



At anchor



Aerial view



TALISMAN C



TALISMAN C

# SPECIFICATION.



Length  
70.6m (231.6ft)



Built  
2011, Proteksan Turquoise, Turkey



Interior designer  
H2 Yacht Design



Beam  
12.1m (39.7ft)



Draft  
4m (13.1ft)



Gross tonnage  
1,560



Cruising speed  
15 knots



Maximum speed  
18 knots



Fuel consumption at cruising speed  
828 litres per hour



Engines  
2 x 2,447hp Caterpillar



Guests  
12



No. of guest cabins  
6 (4 x double, 2 x twin, 2 x additional berths)



Crew  
19

## Note

Registered under the Yacht Engaged in Trade scheme (YET). All Mediterranean charters must start in either the South of France, Monaco or Corsica. For all charters, the principal charterer must be a non-EU resident.

[View yacht on website](#)



# EQUIPMENT.

## Tenders & toys



3 x Tenders



1 x Sailing dinghy



1 x Deck jacuzzi



RYA training centre for jetskis &amp; waverunners



3 x Waverunners



4 x SeaBobs



1 x Flyboard



1 x eFoil



3 x Kayaks



2 x Stand up paddleboards



Wakeboard



Wakesurf



Kite surfing equipment



Windsurfer



Waterskis



Inflatable tows



Scuba diving equipment



Air drone

7.7m Ski Nautique - Super Air Nautique with 230hp engine, 7m Novurania chase 23 with 250hp engine, 4.3m Narhwal rescue tender with Yamaha engine, 3 x Sea-Doo 300 GTX, Zapata flyboard pro series, 1 x Lift E-foil, 4 x Cayago SeaBobs, 3 x Kayaks (1 x double and 2 x single), 5 x sets of dive gear and dive compressor (x 9 if required with various sized BCDs and Regs), 1 x MiniCAT EU 460 inflatable catamaran dinghy, windsurf equipment (2 x boards, 3 x sails) - one is a Bic combi windsurf/paddleboard and one is a Fanatic windsurf, 2 x paddleboards (1 x combi windsurf/paddleboard, 1 x inflatable), 2 x adult waterskis, 1 x infant waterskis, 5 x wakeboards (various sizes), 1 x infant wakeboard, 3 x wakesurfs, 1 x King of the Mountain, 1 x Blockade 20, 1 x Foxtrot 20, 1 x Funair custom pool, numerous inflatables, approved RYA training centre for guests' use of personal watercraft.

# Fitness & wellness

---

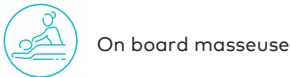
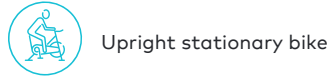

2 x treadmills (Life Fitness + Technogym), 2 x static bikes (Peloton + Life Fitness), 1 x bench, free weights ranging from 2.5lbs to 45lbs

# Communication & entertainment

---

Comprehensive AV systems, satellite television, karaoke, Playstation, Sky TV, Apple TV, Satcom & cellular communications facilities, Wi-Fi internet access

# SUN DECK

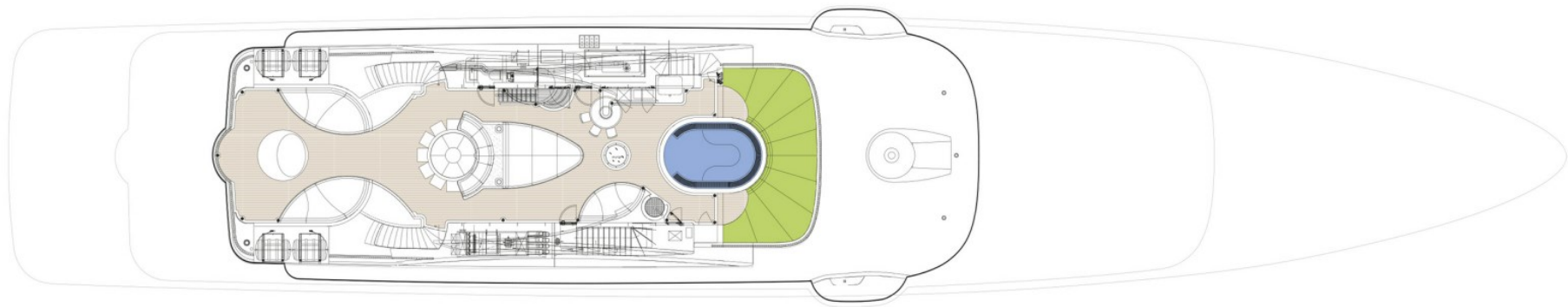

- GUEST AREAS
- OWNER'S SUITE
- VIP SUITES
- GUEST CABINS
- OWNER'S OFFICE
- GYM
- JACUZZI

# UPPER DECK



- GUEST AREAS
- OWNER'S SUITE
- VIP SUITES
- GUEST CABINS
- OWNER'S OFFICE
- GYM
- JACUZZI



# MAIN DECK



- GUEST AREAS
- OWNER'S SUITE
- VIP SUITES
- GUEST CABINS
- OWNER'S OFFICE
- GYM
- JACUZZI

# LOWER DECK

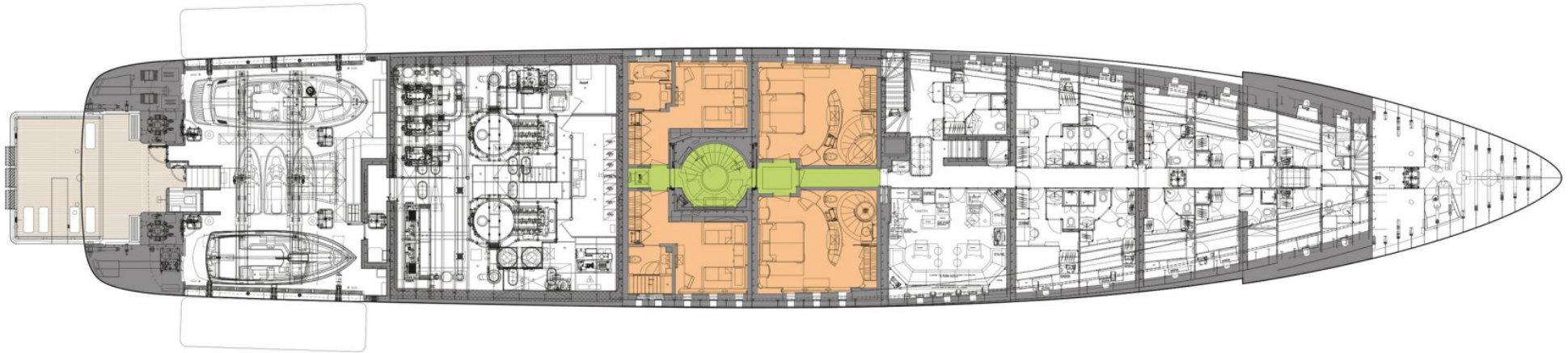

- GUEST AREAS
- OWNER'S SUITE
- VIP SUITES
- GUEST CABINS
- OWNER'S OFFICE
- GYM
- JACUZZI

# BURGESS

# WORLD CLASS. WORLD WIDE.

London +44 20 7766 4300	Monaco +377 97 97 81 21	New York +1 212 223 0410	Miami +1 305 672 0150	Singapore +65 9665 8990	Beverly Hills +1 310 424 5112	Palma +34 971 495 413	Athens +30 210 967 1661
	Dubai +971 4 425 5874	Phuket +66 7623 9739	Hong Kong +852 6496 2094	Tokyo +81 46 738 8612	Sydney +61 499 945 557	Mumbai +91 98211 67253	

---

Advertising of these vessel(s) in printed publications, on the internet or in any other medium is not permitted without prior written permission from Burgess. All particulars are given in good faith and are believed correct but they cannot be guaranteed.

Last updated: 09 April 2024