

SURINA



SURINA

OVERVIEW.

SURINA is a graceful 45-metre (147ft) tri-deck yacht from the esteemed Trident shipyard. She now has a chic, timeless and welcoming interior finished in blond hardwood and neutral tones with a new high-end music system throughout, some design classic furniture and original pieces of modern art, plus an excellent and wide variety of exterior spaces for guests to enjoy.

There's foredeck seating and a daybed on the bow, full walk-around decks on two levels and a sunbathing zone on the foredeck, plus everything else you'd expect. The sun deck has a sociable lounge and observation seats, a jacuzzi tub and a large expanse of sun pads. The upper aft deck, meanwhile, has a large teak dining table, a sit-up bar and a barbecue grill, all in ample shade and the main deck aft has separate lounge areas in shade and full sun.

Her interior layout is also a bit different. The master suite is a large, full-beam cabin, as you'd expect, with a finely crafted hardwood finish, two corner sofas and a study/vanity desk as well as a full-beam his and hers bathroom. The ideally located amidships on the lower deck – the most comfortable part of the yacht when she's anchored or under way – which frees up a huge amount of space on the main deck for luxurious living spaces, more than on a much larger yacht.

The main saloon is very generous with an eight-seat table for games and informal dining plus a lounge and a sit-up bar. The formal dining room is separate, all the way forward on the main deck with spectacular views out in three directions. The bridge deck also has a games table, large lounge area and bar, giving you two of everything and four dining areas in total.

There's also a wide variety of watersports equipment on board and a qualified scuba dive instructor among the crew. The stern platform serves as a beach club with 9m (30ft) floating island and sea pool for safe swimming when the anchor's down. Her inventory of toys includes a large towed tender as well as a 6.7m (22ft) RIB, two Waverunners, two SeaBobs, six paddleboards, a superb selection of waterskiing and wakeboarding kit, fishing, snorkelling and dive gear, exercise equipment and a full set of beach gear for private parties on deserted beaches. There's just so much to enjoy.

Key features

Recently refitted

Low fuel consumption

Exercise equipment

13m (42ft) Intrepid chase boat

Diving Instructor in the crew

Jacuzzi on the sun deck

Zero speed stabilisers to reduce any rolling motion while at anchor

SURINA

At anchor



Sun deck



Bridge deck aft



Main deck aft



SURINA

Main deck dining area



Main deck lounge



Main deck lounge



Main deck dining area



SURINA

Main deck foyer



Sky lounge



Sky lounge



Sky lounge



SURINA

Foyer



Lower deck master cabin



Lower deck master cabin



Lower deck master cabin



SURINA

Master bathroom en suite



Lower deck double cabin



Lower deck double cabin



Lower deck twin cabin



SURINA

Lower deck twin cabin



Toys



At anchor



SURINA

SPECIFICATION.



Length
44.8m (147ft)



Built
2000 (refitted 2022), Trident, United States Of America



Interior designer
Claudette Bonville



Beam
8.5m (27.9ft)



Draft
2.3m (7.5ft)



Gross tonnage
384



Cruising speed
12 knots



Maximum speed
19 knots



Fuel consumption at cruising speed
250 litres per hour



Engines
2 x 3,000hp MTU



Guests
10



No. of guest cabins
5 (3 x double, 2 x twin)



Crew
8

[View yacht on website](#)



SURINA

TENDERS & TOYS



1 x Towed tender



1 x Tender



1 x Deck jacuzzi



Anti-jellyfish pool



2 x Waverunners



2 x SeaBobs



1 x eFoil



2 x Kayaks



4 x Stand up paddleboards



Wakeboard



Kneeboard



Waterskis



Scuba diving equipment



Fishing gear



Snorkelling gear

SURINA

FITNESS & WELLNESS



Exercise balls



Free weights



Upright stationary bike



Yoga mats



SURINA

COMMUNICATION & ENTERTAINMENT



Wi-Fi internet access



Starlink



Satellite television



Speaker systems



Video games



Surina

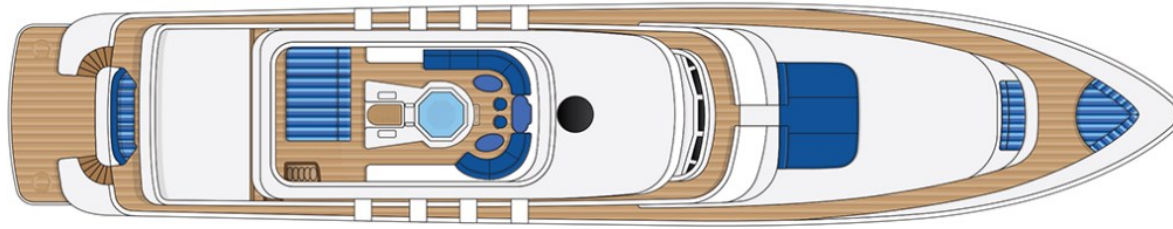

SUN DECK

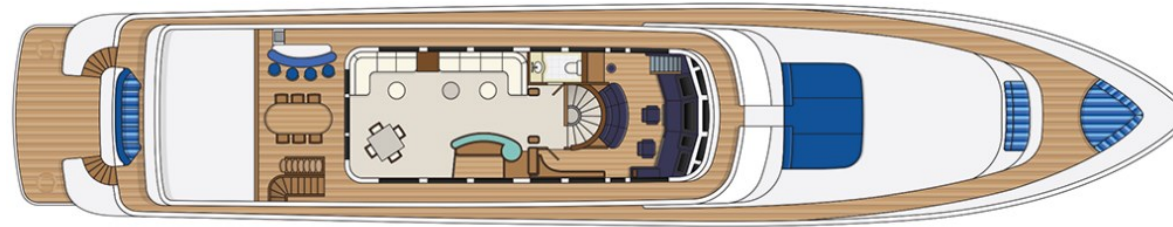

BRIDGE DECK

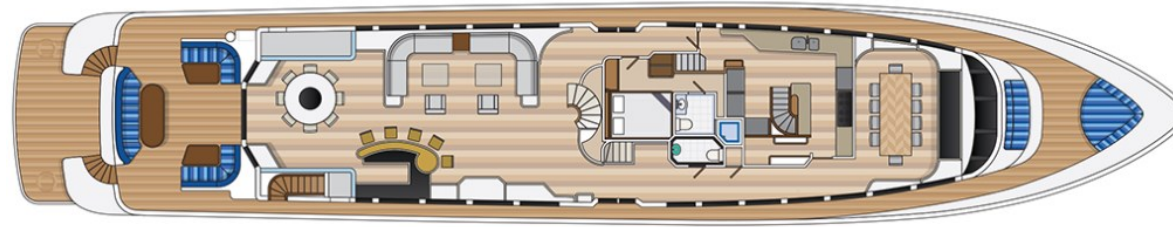

MAIN DECK

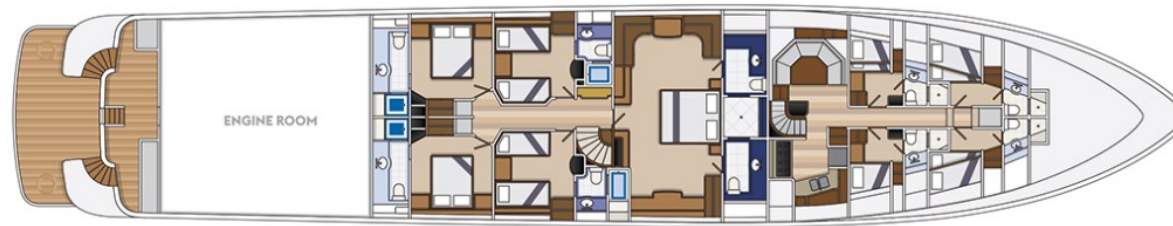

LOWER DECK

BURGESS

WORLD CLASS. WORLD WIDE.

London +44 20 7766 4300	Monaco +377 97 97 81 21	New York +1 212 223 0410	Miami +1 305 672 0150	Singapore +65 9665 8990	Beverly Hills +1 310 424 5112	Palma +34 971 495 413	Athens +30 210 967 1661
Dubai +971 4 425 5874	Phuket +66 7623 9739	Hong Kong +852 6496 2094	Tokyo +81 46 738 8612	Sydney +61 499 945 557	Mumbai +91 98211 67253	Shanghai +86 187 0898 6800	Rio de Janeiro +55 21 2553-3238
Aspen +1 970 710 2294							

Advertising of these vessel(s) in printed publications, on the internet or in any other medium is not permitted without prior written permission from Burgess. All particulars are given in good faith and are believed correct but they cannot be guaranteed.

Last updated: 30 January 2025