

STYLIA



STYLIA

SPECIFICATIONS.



Prix demandé
EUR 6 000 000



Chantier
2022, Sunreef Yachts, Poland



Longueur
22,8m



Largeur
10,8m



Tirant d'eau min / max
-/1,9m



Déplacement
88 tonnes



Vitesse de croisière
9 knots



Vitesse maximale
11 knots



Pavillon
Gibraltar



Position
West Mediterranean



Classe
RINA Services S.p.A. (RINA)



Designer extérieur
Sunreef Yachts



Designer d'intérieur
Sunreef Yachts



Construction
Hull - GRP, Superstructure - GRP, Deck - Teak



Équipage
4



Invités
8



Cabines
4 (4 × double)



Moteurs
2 × 225hp John Deere



Propulsion
Twin screw diesel yacht

[Voir le yacht sur le site](#)



STYLIA



BURGESS

Discover the difference.
burgessyachts.com



STYLIA



BURGESS

Discover the difference.
burgessyachts.com



STYLIA



BURGESS

Discover the difference.
burgessyachts.com



STYLIA

APERÇU.

STYLIA is a nearly-new 22.8m (74.8ft) sailing catamaran loaded with every upgrade and extra on the list, from carbon spars to lithium batteries, solar panels to a hydraulic swim platform. Constructed to operate commercially though only ever used privately, she was built in GRP and delivered in 2022 by leading Polish shipyard Sunreef.

She was commissioned by an experienced owner building their second Sunreef 70. With so many improvements over the standard specification it would be no exaggeration to say that she is the best Sunreef 70 ever built. Without question she is the finest example on the market today.

With 287sqm (3,089sqft) of light, bright living space including a huge flybridge with lounge, dining and BBQ and more open-air dining on the main deck aft, she makes the very most of her 133GT volume.

The large hydraulic swim platform has three position options. It can be an extension to the main deck aft for more entertainment space, a beach club platform for sea-level living, and underwater as a tender recovery system with a load capacity of 1,200kg.

Inside on the main deck there are 360 views through large picture windows and hull-height sliding glass doors aft. There is a lounge area to port that could also serve as a formal dining area, a breakfast bar on the galley island, and the galley to starboard. Forward a door opens onto a large foredeck terrace and the huge relaxation space of the trampolines.

On the lower deck there are four suites for eight guests including an 'owner's hull' to port with a king-sized double berth, his-and-hers bathrooms and a large walk-in wardrobe. Three large hull ports and deck hatches above the bedroom and en suite deliver views and natural light. There are two additional queen-sized double berths in the starboard hull and a third gym/guest cabin aft, all en suite and with similar natural light, along with accommodation for up to five crew.

When not under sail, twin upgraded 225hp John Deere diesel engines give her a top speed of 11 knots and a cruising speed of nine knots. At anchor her 10.8m (35.4ft) beam give her natural stability and the lithium batteries offer the option of turning off the generators and switching to silent, eco mode.

Principales caractéristiques

Arguably the best Sunreef 70' Sailing ever built

Build in Poland under the supervision of independent project managers/surveyors

Full range of options and privately used only

Massive interior volume and exterior deck spaces

A dedicated owner's hull plus three additional guests cabins

Commercially compliant

FLYBRIDGE DECK

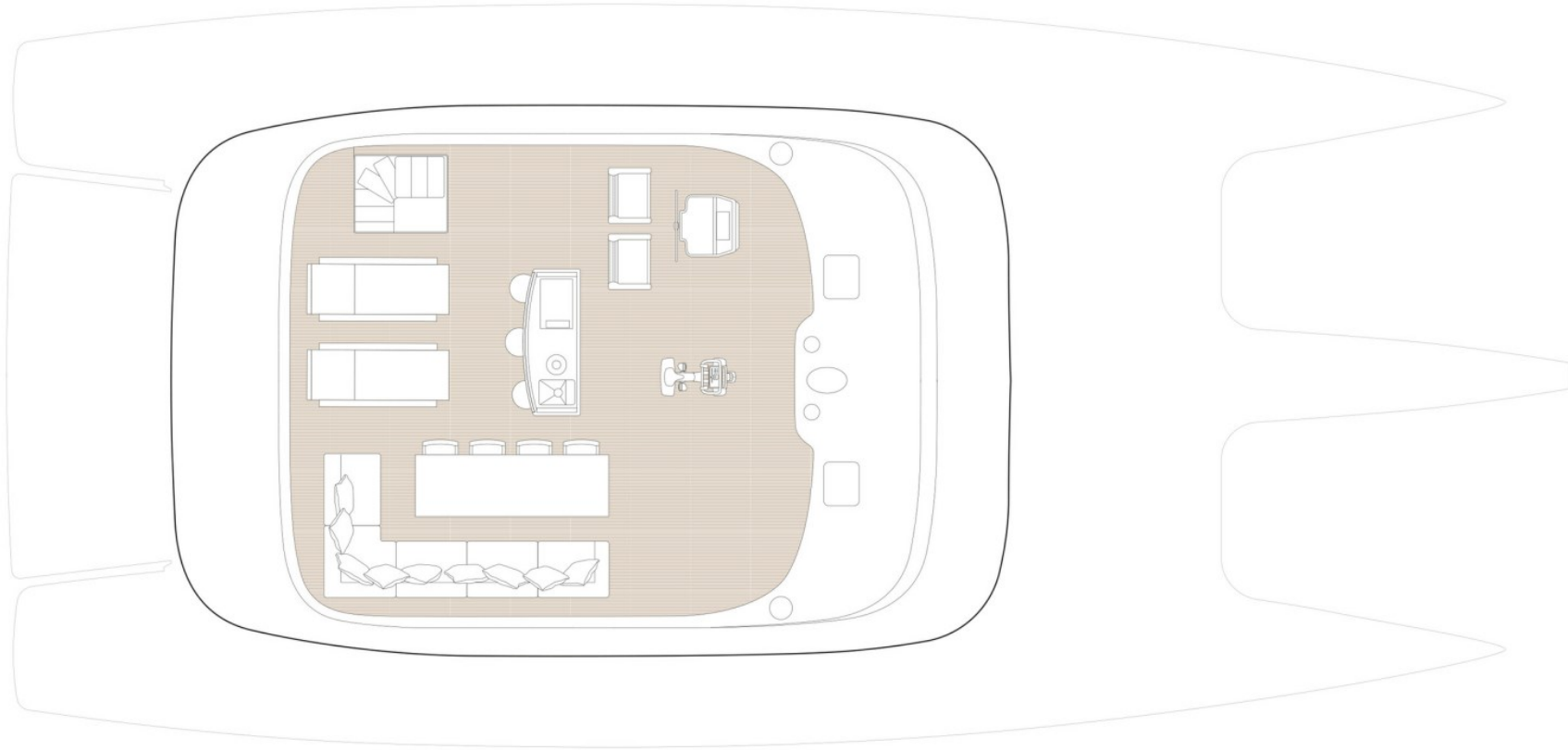

■ GUEST AREAS ■ MASTER SUITE ■ GUEST CABINS

MAIN DECK

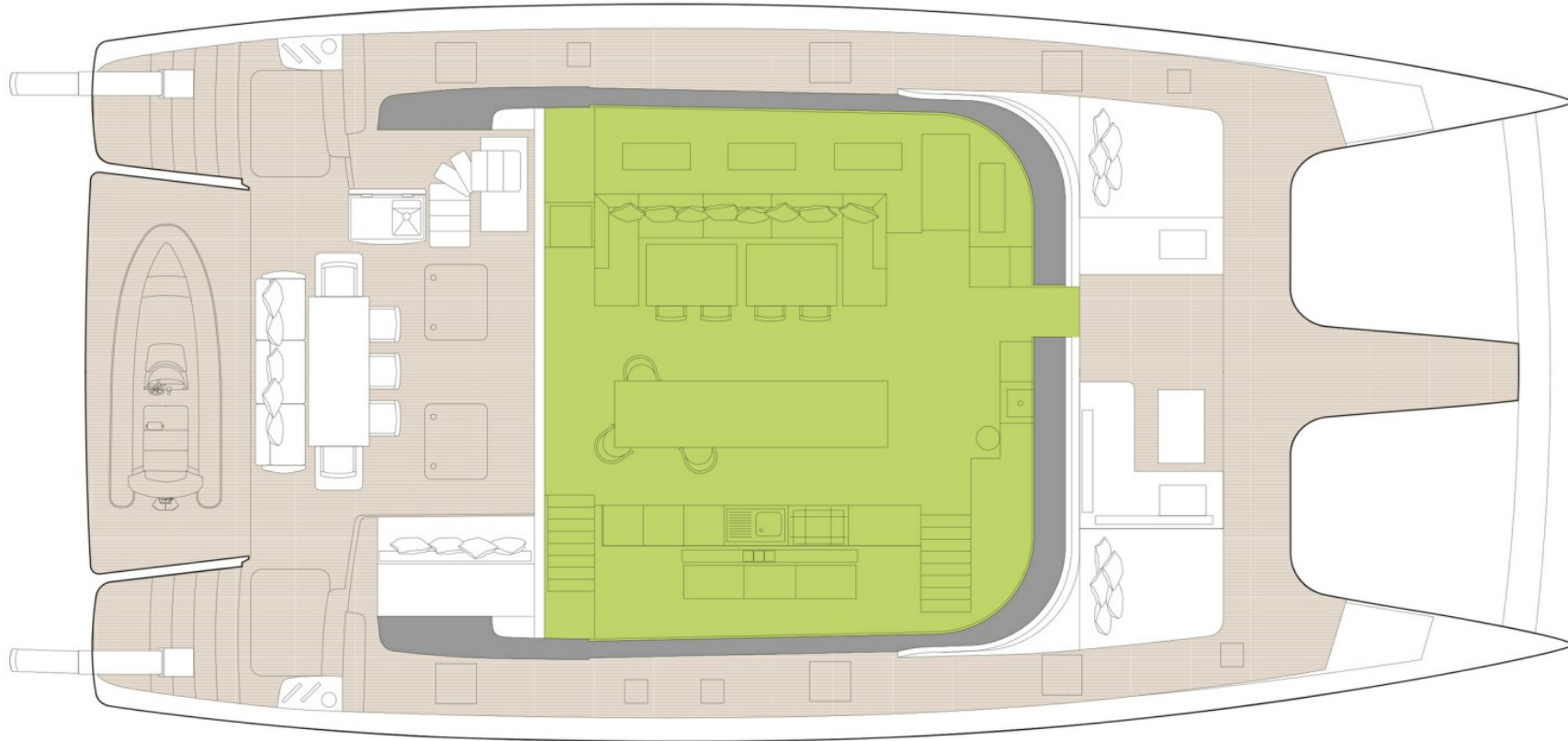

 GUEST AREAS  MASTER SUITE  GUEST CABINS

LOWER DECK



 GUEST AREAS  MASTER SUITE  GUEST CABINS

BURGESS

WORLD CLASS. WORLD WIDE.

London +44 20 7766 4300	Monaco +377 97 97 81 21	New York +1 212 223 0410	Miami +1 305 672 0150	Singapore +65 9665 8990	Beverly Hills +1 310 424 5112	Palma +34 971 495 413	Athens +30 210 967 1661
Dubai +971 4 425 5874	Phuket +66 7623 9739	Hong Kong +852 6496 2094	Tokyo +81 46 738 8612	Sydney +61 499 945 557	Mumbai +91 98211 67253	Shanghai +86 187 0898 6800	Rio de Janeiro +55 21 2553-3238
Aspen +1 970 710 2294							

La publicité de ce(s) navire(s) dans des publications imprimées, sur Internet ou sur tout autre support n'est pas autorisée sans l'autorisation écrite préalable de Burgess.
Toutes les informations sont données de bonne foi et sont considérées comme exactes, mais elles ne peuvent être garanties.

Dernière mise à jour : 05 mars 2025