

ST DAVID

ST DAVID

OVERVIEW.

Built by Benetti and designed inside and out by Winch Design, ST. DAVID is a great example of a pedigree Italian superyacht. Designed expressly for charter, she has excellent credentials and a stellar charter reputation.

Boarding ST. DAVID, sit back and relax on the large main deck sofa with a refreshing drink while being introduced to your award-winning crew. From here, step through the sliding doors to the opulent bar area preceding the main lounge, the perfect place for pre-dinner Martinis. Moving through the main saloon and formal dining area to the ornate floating staircase at the centre of the yacht, your crew will escort you to your cabin. ST. DAVID accommodates up to 12 guests in six opulent cabins, including a split level master suite. Located on the main deck, the master suite includes a private study, his and hers bathrooms, and one of the finest sleeping quarters to be found on any yacht, with steps leading up to the raised area where the bed is topped by a skylight and affords 180-degree views forward. Further guest cabins include a VIP suite and four flexible double cabins, all located on the lower deck.

Once settled, head outside to discover the yacht's multi-dimensional entertainment spaces spread over her three decks. You will most likely choose to spend the majority of your day on the sun deck for al fresco living at its very best. Take a dip in the jacuzzi, relax on the sun pads, dine, drink and play to your heart's content. When the sun gets too hot, take refuge on the upper deck. The sky lounge is one of the yacht's best features and is also where you can enjoy a semi al fresco dining experience with large sliding doors open to the aft deck.

With so much to do on board, you need never set foot ashore. Get your pulse racing with a workout in the indoor/outdoor gym, complete with fresh air and sea views, or dive off the swim platform for a refreshing dip. Younger guests will be drawn to the swim platform like magnets, and ST. DAVID's crew will ensure they are kept entertained with a huge selection of watertoys for them to use while you abandon yourself in the luxurious spa, perhaps even with a massage from the on board masseuse.

Once the sun goes down it's time to make the most of the bar in the main saloon followed by dinner in the sophisticated dining room. After this the choice is yours – bar, disco, movie, or straight to bed ready to repeat it all again the next day.

Key features

Awarded 'Best Charter Yacht' by Robb Report in 2009

Spa facilities: massage room and on board masseuse

Flexible cabin configurations

Exercise equipment

Outdoor cinema on the sun deck

Jacuzzi on the sun deck

Zero speed stabilisers to reduce any rolling motion while at anchor

ST DAVID

At anchor



Jet ski



Sun deck jacuzzi

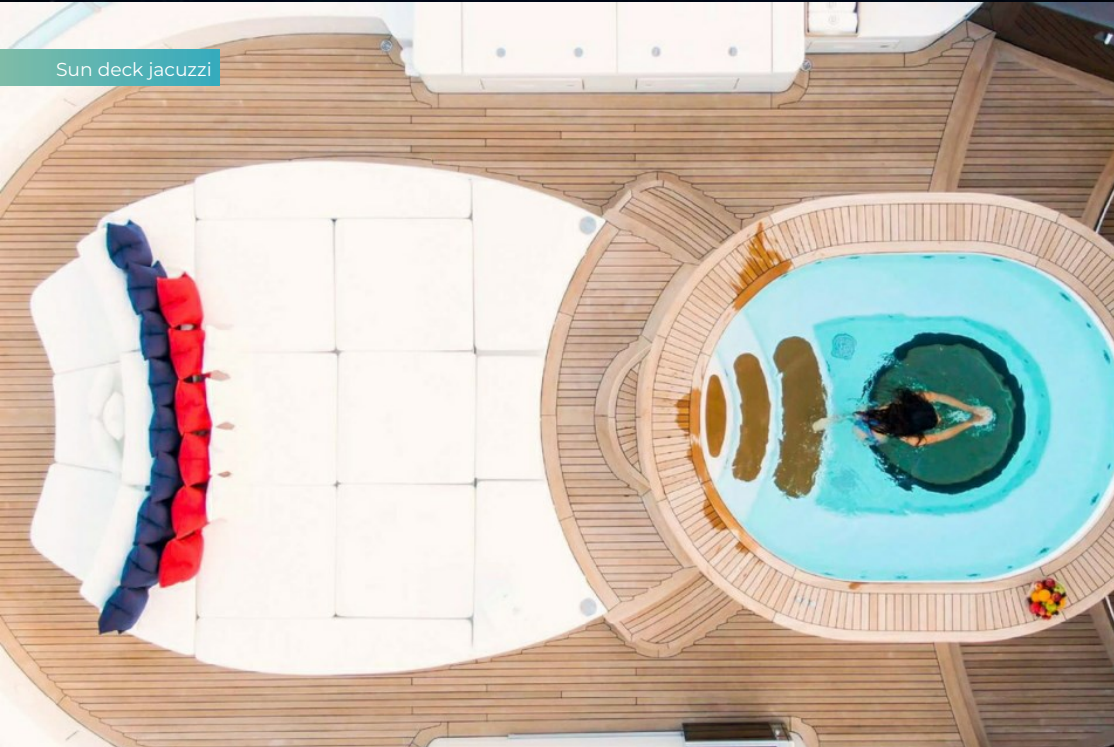

Sun deck



ST DAVID

Sun deck dining area



Upper deck aft



Main deck aft



Main deck lounge



ST DAVID

Main deck lounge bar



Main deck dining area



Sky lounge



Sky lounge dining area



ST DAVID

Sky lounge dining area



Two-level master cabin



Master staircase



Master office



ST DAVID

Master library



Master bathroom en suite



VIP cabin



VIP cabin



ST DAVID

VIP bathroom en suite



Convertible double/twin cabin



Convertible double/twin cabin



Convertible double/twin cabin



ST DAVID

Convertible double/twin cabin



Diving



Tender



At anchor



ST DAVID

SPECIFICATION.



Length
60m (196.8ft)



Built
2008 (refitted 2025), Benetti, Italy



Interior designer
Winch Design



Beam
10.4m (34.1ft)



Draft
3.6m (11.8ft)



Gross tonnage
969



Cruising speed
12 knots



Maximum speed
15.5 knots



Fuel consumption at cruising speed
315 litres per hour



Engines
2 x 1,850hp Caterpillar



Guests
12



No. of guest cabins
6 (2 x double, 4 x double/twin)



Crew
15

Note

Fully licensed for charters in Greek waters.

[View yacht on website](#)

[Watch yacht video](#)

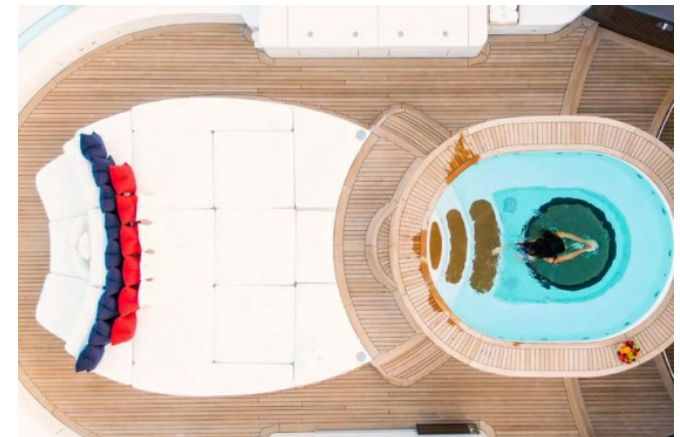

ST DAVID

TENDERS & TOYS



3 × Tenders



1 × Sailing dinghy



1 × Deck jacuzzi



2 × Waverunners



2 × SeaBobs



1 × eFoil



1 × Kayak



3 × Stand up paddleboards



Windsurfer



Surfboard



Wakeboard



Kneeboard



Waterskis



Inflatable toys



Scuba diving equipment



Snorkelling gear



Fishing gear



Air drone



RYA training centre for jetskis & waverunners

ST DAVID

FITNESS & WELLNESS



Exercise balls



Free weights



Treadmill



Upright stationary bike



Yoga mats



Massage room



On board masseuse

ST DAVID

COMMUNICATION & ENTERTAINMENT



Satcom & cellular communications facilities



Wi-Fi internet access



Starlink



Outdoor cinema

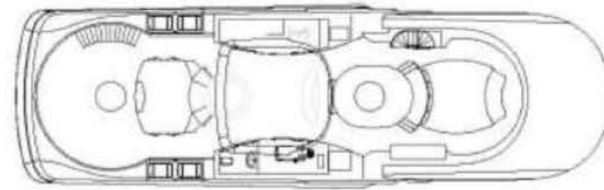

SUN DECK

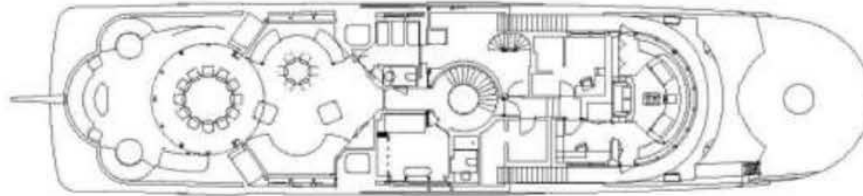

UPPER DECK

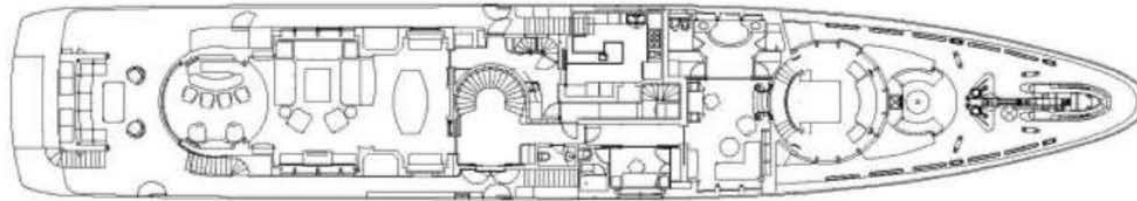

MAIN DECK

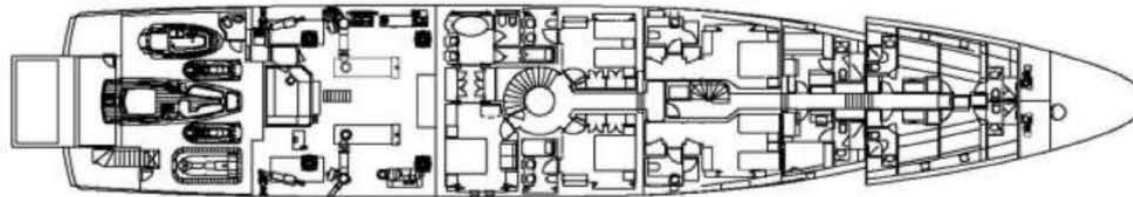

LOWER DECK

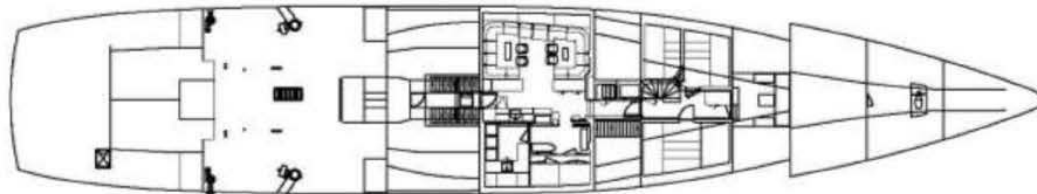

UNDER LOWER DECK

BURGESS

WORLD CLASS. WORLD WIDE.

London +44 20 7766 4300	Monaco +377 97 97 81 21	New York +1 212 223 0410	Miami +1 305 672 0150	Singapore +65 9665 8990	Beverly Hills +1 310 424 5112	Palma +34 971 495 413	Athens +30 210 967 1661
Dubai +971 4 425 5874	Phuket +66 8257 01150	Hong Kong +852 6496 2094	Tokyo +81 46 738 8612	Sydney +61 499 945 557	Mumbai +91 98211 67253	Shanghai +86 159 0162 1898	Rio de Janeiro +55 21 2553-3238
		Aspen +1 970 710 2294	Guernsey +44 1481 735360	Palm Beach +1 561 973 2768			

Advertising of these vessel(s) in printed publications, on the internet or in any other medium is not permitted without prior written permission from Burgess. All particulars are given in good faith and are believed correct but they cannot be guaranteed.

Last updated: 30 April 2026