

SOUNDWAVE



OVERVIEW.

Launched in 2015 by the prestigious Italian yacht builder Benetti, SOUNDWAVE was immediately recognised as one of the greats, winning a World Superyacht Award in 2016.

She possesses a striking axe bow with vertical blade, a feature which enhances the fuel efficiency of this world cruiser. Crafted by the owner's personal design team, her interiors draw inspiration from the Art Deco period, combining cool beiges, dark browns, whites and creams accented with textured fabrics and hand crafted, one-of-a-kind pieces throughout.

She offers flexible accommodation that is ideal for family groups. The full-beam VIP suite sits on the main deck and is as large as the master, with its own, separate lounge and spacious bathroom. The master is on the upper deck and comes complete with its own private deck and 180 degree views, jet pool and sunbathing area. There is also a nursery room with a cot adjacent to the master. The four other guest cabins are on the lower deck and are all doubles, though two can convert to twins if preferred.

The exteriors are extremely well designed, offering a variety of areas to enjoy throughout the day: a split-level sundeck with large jacuzzi pool, bar, seating and sunbathing, dining on the upper deck aft and a very welcoming exterior lounge on the main deck aft.

For those wishing to relax, the spa, complete with treatment room and steam room will be appreciated, but once energy levels are revived, the choice of watertoys will not fail to impress as well!

Key features

Winner of the World Superyacht Awards

Interior refit in winter 2023/24

Spa facilities: steam room and massage room

Private master sun deck with jet pool

Masseuse part of the crew

Exercise equipment

Jacuzzi on the sun deck

Zero speed stabilisers to reduce any rolling motion while at anchor

SOUNDWAVE

Sky lounge bar



BURGESS

Discover the difference.
burgessyachts.com



SOUNDWAVE

SPECIFICATION.



Length
63m (206.6ft)



Built
2015, Benetti, Italy



Interior designer
Candy & Candy



Beam
10.8m (35.4ft)



Draft
3.5m (11.5ft)



Gross tonnage
1,181



Cruising speed
14 knots



Maximum speed
16.5 knots



Fuel consumption at cruising speed
400 litres per hour



Engines
2 x 1,800hp Caterpillar



Guests
12



No. of guest cabins
6 (4 x double, 2 x double/twin, 3 x additional berths)



Crew
15

[View yacht on website](#)





















[Watch yacht video](#)



SOUNDWAVE

EQUIPMENT.

Tenders & toys

- | | | | | |
|--|--|---|---|---|
|  1 x Limousine tender |  1 x Tender |  2 x Deck jacuzzis |  Waterslide |  Anti-jellyfish pool |
|  Climbing wall |  Trampoline |  RYA training centre for jetskis & waverunners |  2 x Waverunners |  3 x SeaBobs |
|  2 x Underwater scooters |  1 x Flyboard |  1 x eFoil |  2 x Kayaks |  4 x Stand up paddleboards |
|  Wakeboard |  Kneeboard |  Surfboard |  Windsurfer |  Waterskis |
|  Inflatable toys | | | | |

Fitness & wellness



Free weights



Yoga mats



On board masseuse

SUN DECK

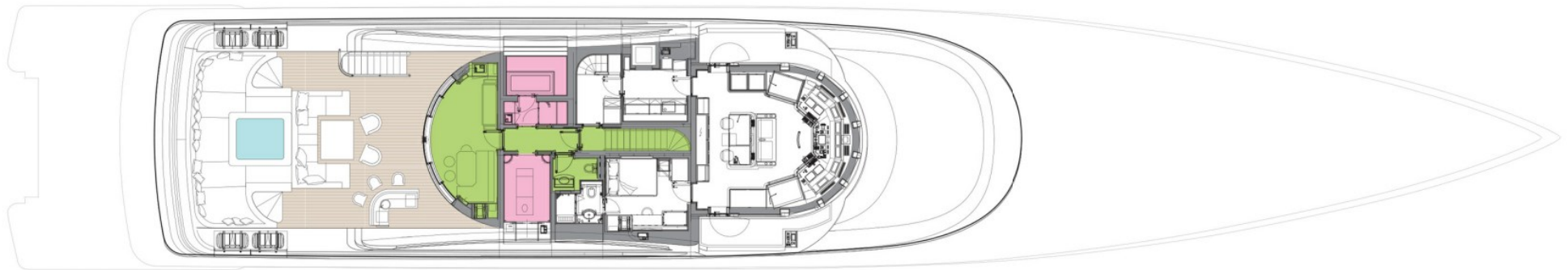

GUEST AREAS OWNER'S SUITE GUEST CABINS OWNER'S OFFICE SPA JACUZZI POOL

UPPER DECK



GUEST AREAS OWNER'S SUITE GUEST CABINS OWNER'S OFFICE SPA JACUZZI POOL

MAIN DECK



 GUEST AREAS  OWNER'S SUITE  GUEST CABINS  OWNER'S OFFICE  SPA  JACUZZI  POOL

LOWER DECK

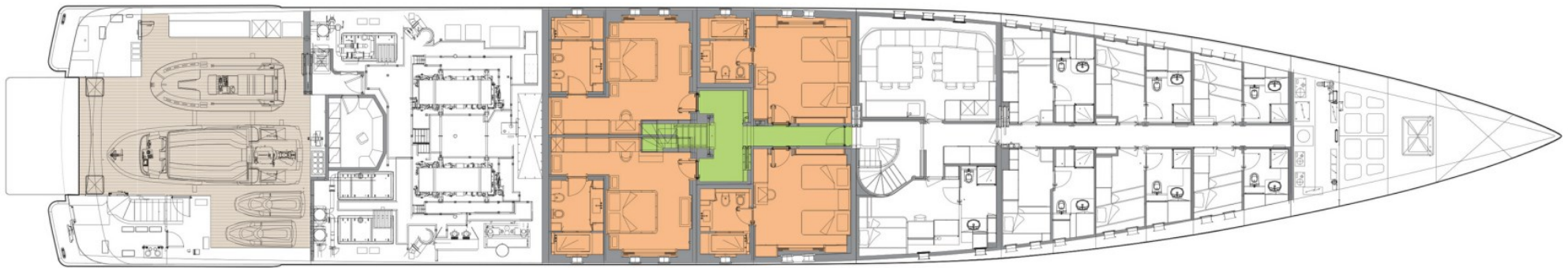

 GUEST AREAS  OWNER'S SUITE  GUEST CABINS  OWNER'S OFFICE  SPA  JACUZZI  POOL

TANK DECK

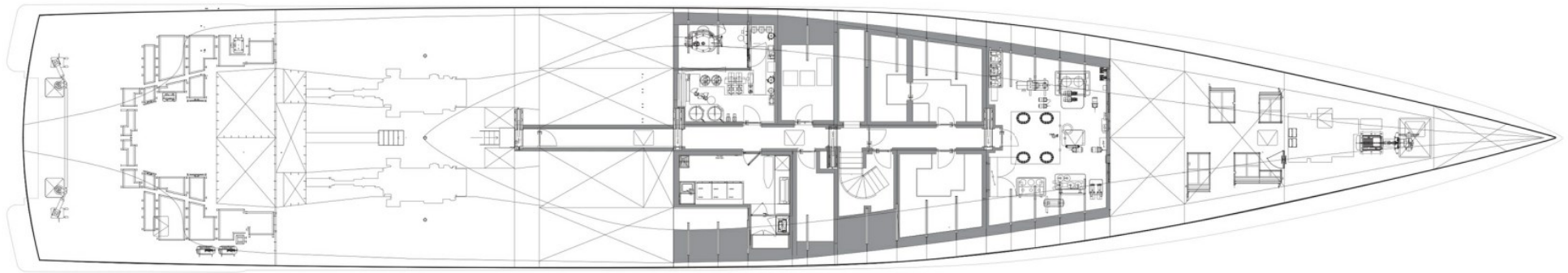

GUEST AREAS OWNER'S SUITE GUEST CABINS OWNER'S OFFICE SPA JACUZZI POOL

BURGESS

WORLD CLASS. WORLD WIDE.

London +44 20 7766 4300	Monaco +377 97 97 81 21	New York +1 212 223 0410	Miami +1 305 672 0150	Singapore +65 9665 8990	Beverly Hills +1 310 424 5112	Palma +34 971 495 413	Athens +30 210 967 1661
	Dubai +971 4 425 5874	Phuket +66 7623 9739	Hong Kong +852 6496 2094	Tokyo +81 46 738 8612	Sydney +61 499 945 557	Mumbai +91 98211 67253	

Advertising of these vessel(s) in printed publications, on the internet or in any other medium is not permitted without prior written permission from Burgess. All particulars are given in good faith and are believed correct but they cannot be guaranteed.

Last updated: 01 March 2024