

# SILVER DREAM

---



SILVER DREAM

# APERÇU.

**With her distinctive silver and black profile, SILVER DREAM is instantly recognisable. Renowned for her sophisticated styling and exceptional crew, she remains a perennial favourite among charter guests.**

SILVER DREAM cleverly maximises her interior space with an expansive main saloon and dining area. The elegant silver and black theme continues throughout, accented by striking Aboriginal artwork. The bridge deck sky lounge offers a tranquil retreat, featuring a calm, neutral colour scheme and large windows that flood the space with natural light.

The thoughtfully designed sun deck provides ample seating and sunbathing space under collapsible parasols, while the aft jacuzzi offers a refreshing escape for guests to plunge in and cool off. For the ultimate space to relax in private, the luxurious double sun pad, forward of the bridge, provides breathtaking views. Enjoy pre-dinner cocktails on the bridge deck before the crew serve a spectacular al fresco dinner at the circular table on the main deck aft.

The supremely spacious full-beam master suite incorporates its own saloon, study, dressing room and his and her bathrooms. Gently curved shapes and warm tones create a peaceful ambience. Two double and two twin cabins on the lower deck offer a welcoming retreat for other at the end of the day.

SILVER DREAM boasts an abundance of water toys, guaranteeing endless entertainment on, above and below the waterline. Contact Burgess today to discover SILVER DREAM.

## Principales caractéristiques

---

**Projector screen in the sky lounge provides on board cinema experience**

---

**Gym**

---

**On board masseuse and spa therapist**

---

**Swim platform/watersports area with an extensive selection of watertoys**

---

**Sun deck jacuzzi**

---



# SILVER DREAM

At anchor



Main deck lounge



Main deck lounge



Dining room





# SILVER DREAM

Main deck atrium



Dining room



Main deck starboard side



Master suite





# SILVER DREAM

Master suite



Master suite office



Master bathroom (hers)



Master shower room (his)





SILVER DREAM

Double cabin



Guest shower room



Twin cabin



Double cabin





# SILVER DREAM

Twin cabin



Sky lounge



Sky lounge cinema screen



On board spa treatments





## SILVER DREAM

Spa treatment products



## Bridge



## Aft deck dining



## Dining details





# SILVER DREAM

Main deck aft



Bridge deck aft



Main deck aft



Sun deck





# SILVER DREAM

Sun deck jacuzzi



Sun deck



Overhead views



Foredeck





SILVER DREAM

Gym



Watersports



Toys



Watersports





# SILVER DREAM

Swim platform



Transom



Cruising



At anchor





SILVER DREAM

# SPECIFICATIONS.



Longueur  
**43,8m**



Chantier  
**2001, Warren Yachts, Australia**



Designer d'intérieur  
**Sam Sorgiovanni/Thomas Hamel**



Largeur  
**8,5m**



Tirant d'eau  
**2,1m**



Tonnage brut  
**395**



Vitesse de croisière  
**12 knots**



Vitesse maximale  
**16 knots**



Consommation de carburant en vitesse de croisière  
**240 litres par heure**



Moteurs  
**2 x 1 350hp Caterpillar**



Invités  
**10**



Nb de cabines invités  
**5 (3 x double, 2 x twin)**



Équipage  
**10**

[Voir le yacht sur le site](#)  
[Regarder la vidéo du yacht](#)





SILVER DREAM

# ANNEXES & JEUX NAUTIQUES



2 × Tenders



1 × Sailing dinghy



1 × Deck jacuzzi



2 × Waverunners



2 × SeaBobs



1 × eFoil



2 × Kayaks



3 × Stand up paddleboards



Wakeboard



Kneeboard



Wakeskate



Waterskis



Inflatable platform



Inflatable tows



Snorkelling gear



Fishing gear



RYA training centre for jetskis  
& waverunners

5.5m Castoldi jet tender with 125hp engine | 4.5m Rescue tender with 25hp engine | 2 x Sea-Doo Spark Rotax 900 ACE waverunners (2 man) | 2 x stand up paddleboards | 2 x inflatable kayaks | Waterskis | Wakeboard & tows | Wakeskate | Fishing gear | Snorkelling gear | Approved RYA training centre for personal watercraft



SILVER DREAM

# REMISE EN FORME & BIEN-ETRE



Boxing equipment



Exercise balls



Free weights



Personal trainer



Rowing machine



Suspension trainer



Training bench



Upright stationary bike



SILVER DREAM

# COMMUNICATION ET DIVERTISSEMENT



Satcom & cellular communications facilities



Wi-Fi internet access



Starlink



Satellite television



Streaming services

Comprehensive audio-visual systems | Satellite television (in restricted areas) | Apple TV | Satcom & cellular communications facilities | Fleet 55 | Wi-Fi internet access





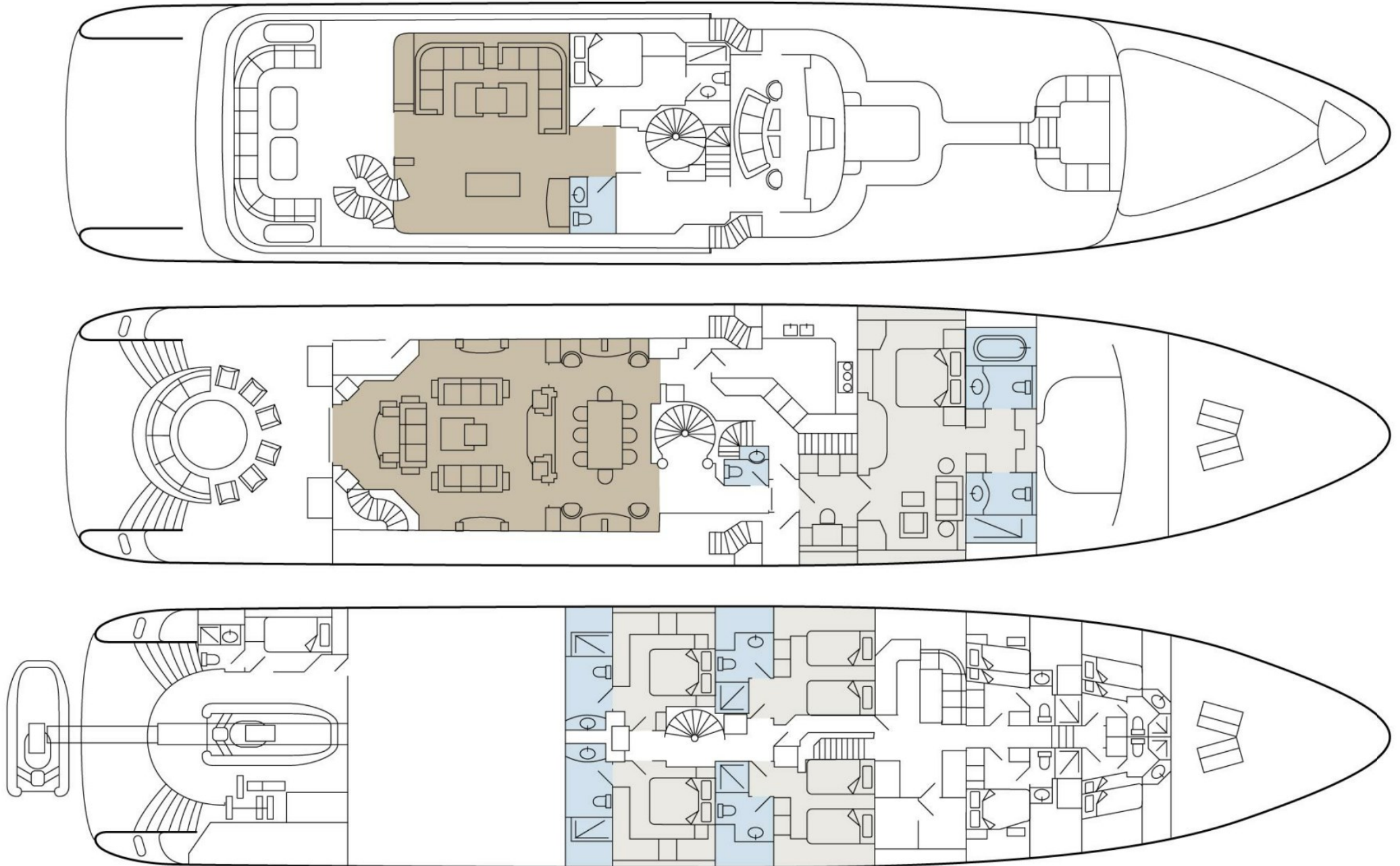



# BURGESS

# WORLD CLASS. WORLD WIDE.

<b>London</b> +44 20 7766 4300	<b>Monaco</b> +377 97 97 81 21	<b>New York</b> +1 212 223 0410	<b>Miami</b> +1 305 672 0150	<b>Singapore</b> +65 9665 8990	<b>Beverly Hills</b> +1 310 424 5112	<b>Palma</b> +34 971 495 413	<b>Athens</b> +30 210 967 1661
<b>Dubai</b> +971 4 425 5874	<b>Phuket</b> +66 7623 9739	<b>Hong Kong</b> +852 6496 2094	<b>Tokyo</b> +81 46 738 8612	<b>Sydney</b> +61 499 945 557	<b>Mumbai</b> +91 98211 67253	<b>Shanghai</b> +86 187 0898 6800	<b>Rio de Janeiro</b> +55 21 2553-3238
<b>Aspen</b> +1 970 710 2294							

La publicité de ce(s) navire(s) dans des publications imprimées, sur Internet ou sur tout autre support n'est pas autorisée sans l'autorisation écrite préalable de Burgess.  
Toutes les informations sont données de bonne foi et sont considérées comme exactes, mais elles ne peuvent être garanties.

Dernière mise à jour : 06 mars 2025