

# SILVER ANGEL

---



SILVER ANGEL

# OVERVIEW.

Perhaps the most dramatically styled yacht available for charter, SILVER ANGEL is a stunning combination of elegant design and luxury comfort. A fine example of the yachts that gave the Benetti yard its excellent reputation, she is vast in both size, appeal and potential. One of the highest volume yachts of her length, deck space is extraordinary and has great entertainment potential.

Thanks to her wide beam, there is plenty of room for her spectacular Art Deco design to excel. As you enter the main saloon you will find a world of indulgence and extravagance. Glossy black oak is set against white marble, with decorative mirroring adding to the incredible spaciousness. Acclimatise with your imperial new surroundings as you sink into the plush settees that fill the saloon.

Step out onto one of the three aft decks where the Art Deco style continues, but in a tropical variant. With lots of settees and a variety of al fresco dining possibilities, you could spend each day in a different area. Start your day with a workout in the air-conditioned gym on the main deck, or a yoga session on the foredeck. The crew includes a masseuse so you can soothe away all the tensions of modern life.

On to the sun deck the mosaic-tiled plunge pool forward has a counter-current for those looking for further activity. The entire raised jacuzzi area surrounding it is decorated with travertine marble partially covered by large sun pads, while sweeping travertine steps lead down to a large travertine bar. Following a morning of sun spent here, step inside to the indoor/outdoor dining area and enjoy a BBQ lunch.

After lunch, spend the afternoon discovering SILVER ANGEL's armada of watertoys, including jetskis and scuba diving equipment. Back onboard, relax in the steam room before a refreshing sundowner. Come dinner time, there are several seating and al fresco dining areas on offer, with a particularly grand dining table on the aft of the main deck. Enjoy a gastronomic extravaganza at any of them before retiring to one of her seven well-appointed cabins.

## Key features

---

Spa facilities: hammam and massage room

---

Beach club at sea level

---

A fully equipped gym

---

On board masseuse

---

A good choice of exterior and interior dining areas

---

Jacuzzi on the sun deck

---

Zero speed stabilisers to reduce any rolling motion while at anchor

---



SILVER ANGEL

Waterslide



Sun deck jacuzzi



Sun deck jacuzzi



Sun deck





# SILVER ANGEL

Sun deck dining area



Breakfast set up



Bridge deck aft



Upper deck aft dining and seating area





# SILVER ANGEL

Upper deck aft dining area



Main deck aft seating area

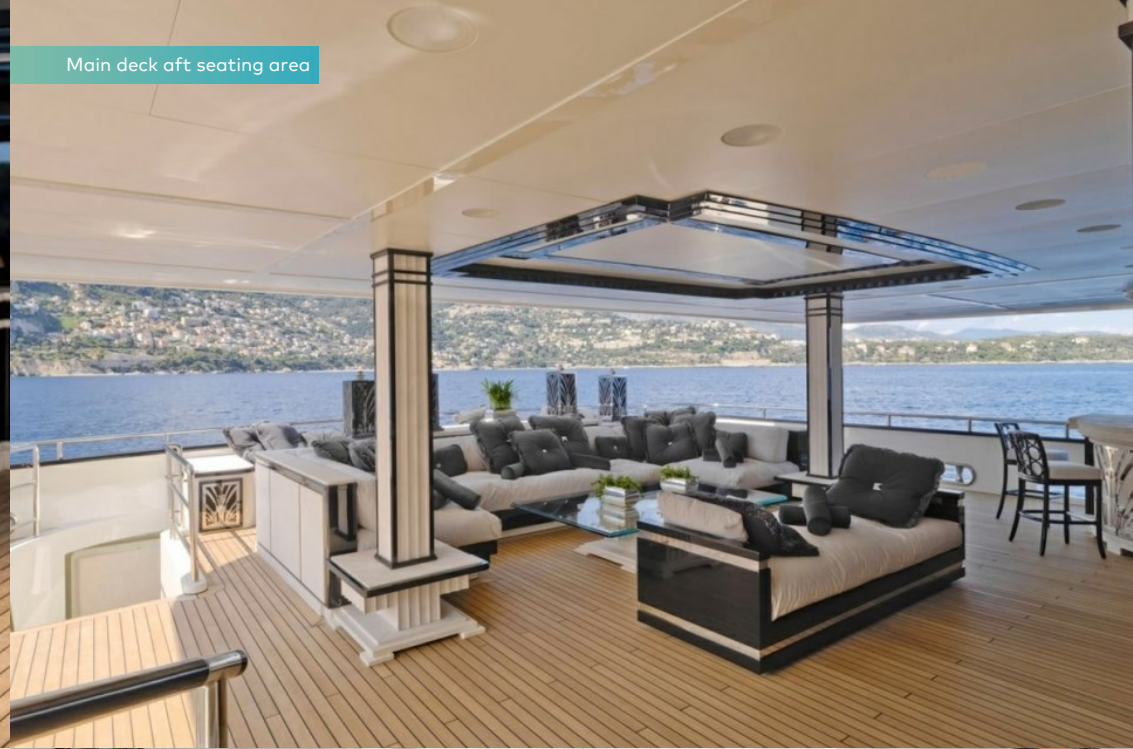

Main deck lounge



Main deck lounge





SILVER ANGEL

# SPECIFICATION.



Length  
64.5m (211.6ft)



Built  
2009 (refitted 2015), Benetti, Italy



Interior designer  
Argent Design



Beam  
12m (39.4ft)



Draft  
3.6m (11.8ft)



Gross tonnage  
1,407



Cruising speed  
13 knots



Maximum speed  
16 knots



Fuel consumption at cruising speed  
550 litres per hour



Engines  
2 x 4,500hp Caterpillar



Guests  
12



No. of guest cabins  
7 (5 x double, 2 x twin)



Crew  
19

[View yacht on website](#)

[Watch yacht video](#)



# EQUIPMENT.

## Tenders & toys

---



2 x Tenders



1 x Deck jacuzzi



Waterslide



Climbing wall



Trampoline



Aquapark



RYA training centre for jetskis & waverunners



2 x Waverunners



2 x SeaBobs



2 x Kayaks



3 x Stand up paddleboards



Wakeboard



Kneeboard



Kite surfing equipment



Waterskis



Inflatable tows



Scuba diving equipment



Fishing gear



Snorkelling gear

# Fitness & wellness

---



Cross trainer



Free weights



Kinesis machine



Training bench



Upright stationary bike



Yoga mats



Hammam/Steam room



Massage room



On board masseuse





# SILVER ANGEL

Sun and upper decks

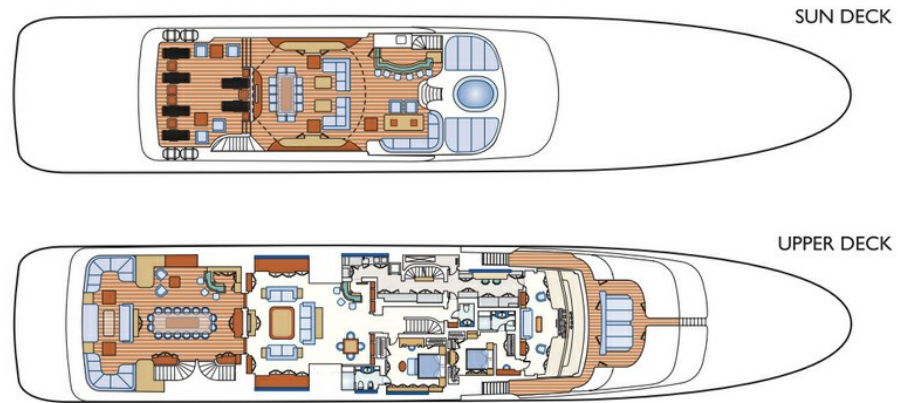



# SILVER ANGEL

Main, lower and under lower decks

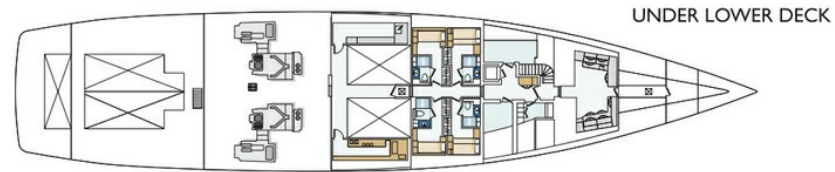
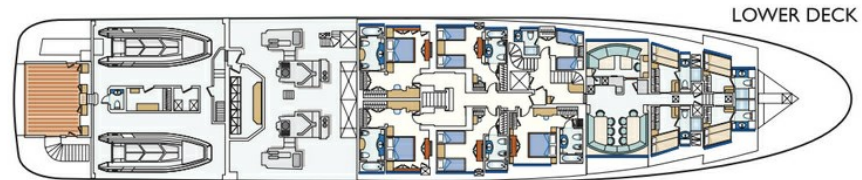
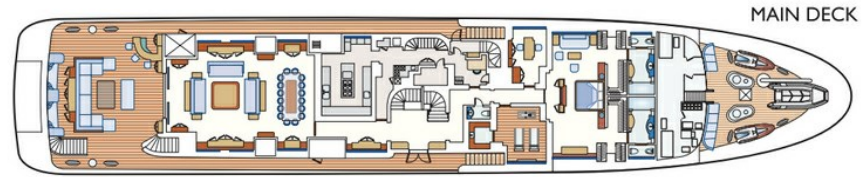



# BURGESS

# WORLD CLASS. WORLD WIDE.

London +44 20 7766 4300	Monaco +377 97 97 81 21	New York +1 212 223 0410	Miami +1 305 672 0150	Singapore +65 9665 8990	Beverly Hills +1 310 424 5112	Palma +34 971 495 413	Athens +30 210 967 1661
	Dubai +971 4 425 5874	Phuket +66 7623 9739	Hong Kong +852 6496 2094	Tokyo +81 46 738 8612	Sydney +61 499 945 557	Mumbai +91 98211 67253	

Advertising of these vessel(s) in printed publications, on the internet or in any other medium is not permitted without prior written permission from Burgess. All particulars are given in good faith and are believed correct but they cannot be guaranteed.

Last updated: 01 March 2024