

SHENANDOAH OF SARK



SHENANDOAH OF SARK

SPECIFICATIONS.



Prix demandé
EUR 7 800 000 (EU VAT paid)



Chantier
1902 (refitted 2018), Townsend Downey, United States Of America



Longueur
54,4m



Largeur
8,2m



Tirant d'eau min / max
-/4,7m



Déplacement
300 tonnes



Vitesse de croisière
9 knots



Vitesse maximale
12 knots



Pavillon
United Kingdom



Position
West Mediterranean



Classe
MCA



Designer extérieur
Theodore E Ferris



Designer d'intérieur
Martin Francis Design



Construction
Hull - Steel, Superstructure - Timber



Équipage
12



Invités
10



Cabines
4 (4 x double, 2 x additional berths)



Moteurs
2 x 500hp Luger



Propulsion
Twin screw diesel yacht

[Voir le yacht sur le site](#)

[Regarder la vidéo du yacht](#)



SHENANDOAH OF SARK

On deck



Main lounge



Dining area



Master cabin



SHENANDOAH OF SARK

Master shower room en suite



Master cabin



Master cabin



Exterior dining area



SHENANDOAH OF SARK

Detail



Bow



On deck



Sailing



SHENANDOAH OF SARK

APERÇU.

SHENANDOAH of SARK was built in 1902 by Townsend & Downey, New York. She is a superb three masted gaff topsail schooner with a steel hull and twin Lugger diesels, plus she has been substantially refitted with modern functionality. She offers a very high quality, comfortable four suite interior plus room for 12 crew. Perhaps the most famous of all the classic yachts afloat today she combines the elegance of a bygone era with modern systems and is offered VAT paid.

Principales caractéristiques

Unique piece of maritime history

VAT paid for trouble free operation

Modern comfort, classic style

A beautiful classic yacht

Multiple upgrades and refits during current ownership

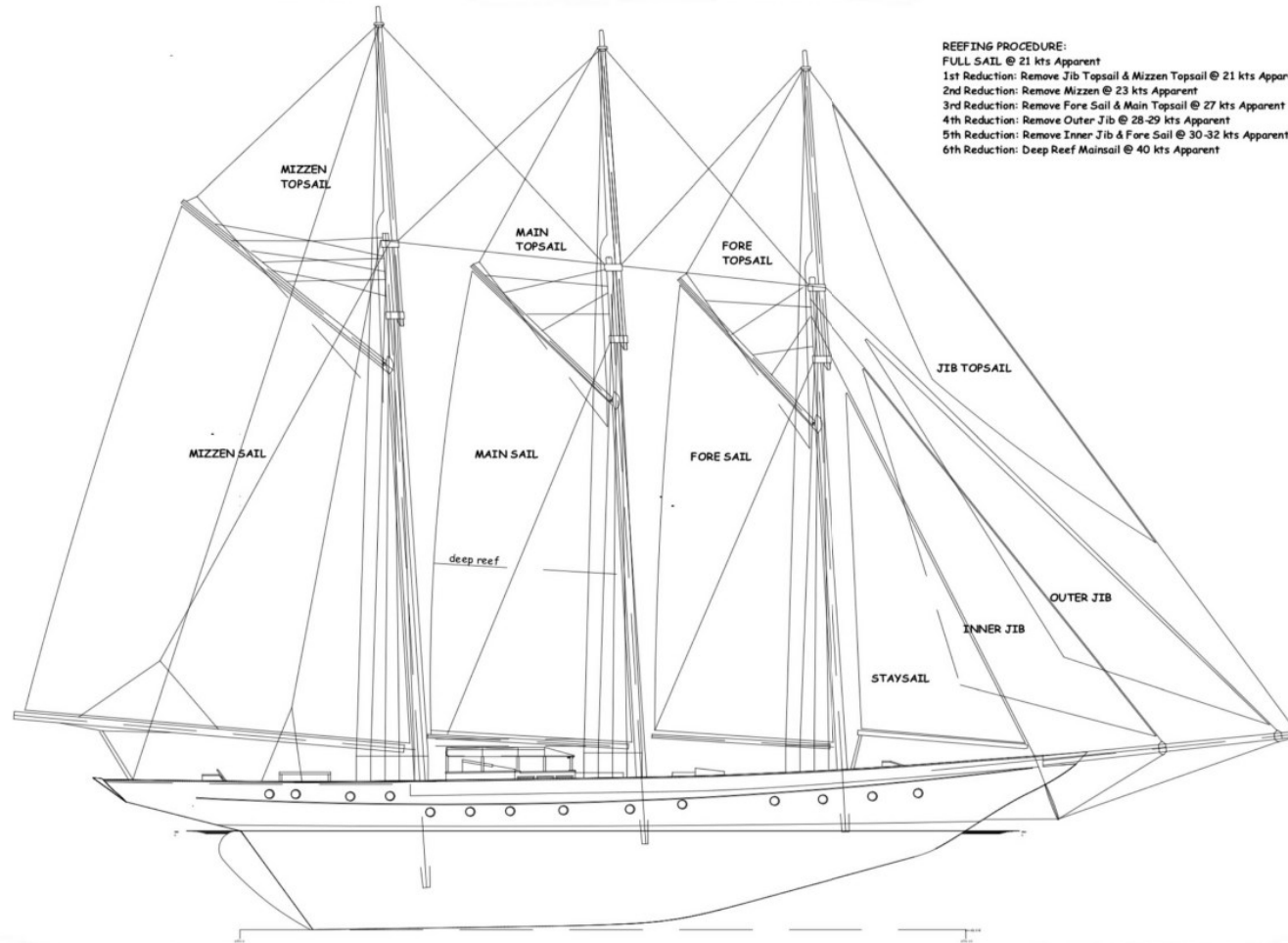

REEFING PROCEDURE:
FULL SAIL @ 21 kts Apparent
1st Reduction: Remove Jib Top Sail & Mizzen Top Sail @ 21 kts Apparent
2nd Reduction: Remove Mizzen @ 23 kts Apparent
3rd Reduction: Remove Fore Sail & Main Top Sail @ 27 kts Apparent
4th Reduction: Remove Outer Jib @ 28-29 kts Apparent
5th Reduction: Remove Inner Jib & Fore Sail @ 30-32 kts Apparent
6th Reduction: Deep Reef Mainsail @ 40 kts Apparent

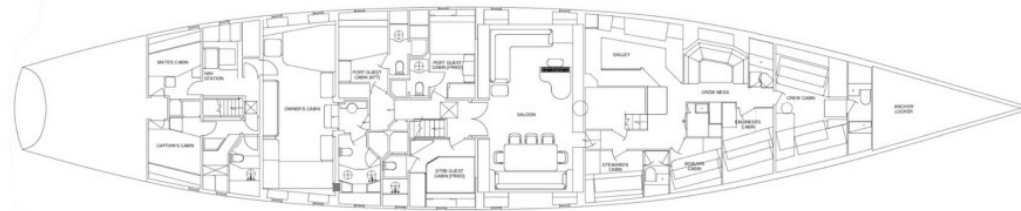

BURGESS

WORLD CLASS. WORLD WIDE.

London +44 20 7766 4300	Monaco +377 97 97 81 21	New York +1 212 223 0410	Miami +1 305 672 0150	Singapore +65 9665 8990	Beverly Hills +1 310 424 5112	Palma +34 971 495 413	Athens +30 210 967 1661
Dubai +971 4 425 5874	Phuket +66 8257 01150	Hong Kong +852 6496 2094	Tokyo +81 46 738 8612	Sydney +61 499 945 557	Mumbai +91 98211 67253	Shanghai +86 159 0162 1898	Rio de Janeiro +55 21 2553-3238
		Aspen +1 970 710 2294	Guernsey +44 1481 735360	Palm Beach +1 561 973 2768			

La publicité de ce(s) navire(s) dans des publications imprimées, sur Internet ou sur tout autre support n'est pas autorisée sans l'autorisation écrite préalable de Burgess.
Toutes les informations sont données de bonne foi et sont considérées comme exactes, mais elles ne peuvent être garanties.

Dernière mise à jour : 14 mai 2026