

# SHENANDOAH OF SARK

---



SHENANDOAH OF SARK

# SPECIFICATION.



Asking price  
**EUR 7,800,000 (EU VAT paid)**



Built  
**1902 (refitted 2018), Townsend Downey, United States Of America**



Length  
**54.4m (178.3ft)**



Beam  
**8.2m (26.9ft)**



Draft min/max  
**-/4.7m (15.4ft)**



Displacement  
**300 tonnes**



Cruising speed  
**9 knots**



Maximum speed  
**12 knots**



Flag  
**United Kingdom**



Lying  
**West Mediterranean**



Class  
**MCA**



Exterior designer  
**Theodore E Ferris**



Interior designer  
**Martin Francis Design**



Construction  
**Hull - Steel, Superstructure - Timber**



Crew  
**12**



Guests  
**10**



Cabins  
**4 (4 x double, 2 x additional berths)**



Engines  
**2 x 500hp Lugger**



Propulsion  
**Twin screw diesel yacht**

[View yacht on website](#)

[Watch yacht video](#)



# SHENANDOAH OF SARK

On deck



Main lounge



Dining area



Master cabin



# SHENANDOAH OF SARK

Master shower room en suite



Master cabin



Master cabin



Exterior dining area



# SHENANDOAH OF SARK

Detail



Bow



On deck



Sailing



SHENANDOAH OF SARK

# OVERVIEW.

SHENANDOAH of SARK was built in 1902 by Townsend & Downey, New York. She is a superb three masted gaff topsail schooner with a steel hull and twin Lugger diesels, plus she has been substantially refitted with modern functionality. She offers a very high quality, comfortable four suite interior plus room for 12 crew. Perhaps the most famous of all the classic yachts afloat today she combines the elegance of a bygone era with modern systems and is offered VAT paid.

## Key features

---

Unique piece of maritime history

---

VAT paid for trouble free operation

---

Modern comfort, classic style

---

A beautiful classic yacht

---

Multiple upgrades and refits during current ownership

---

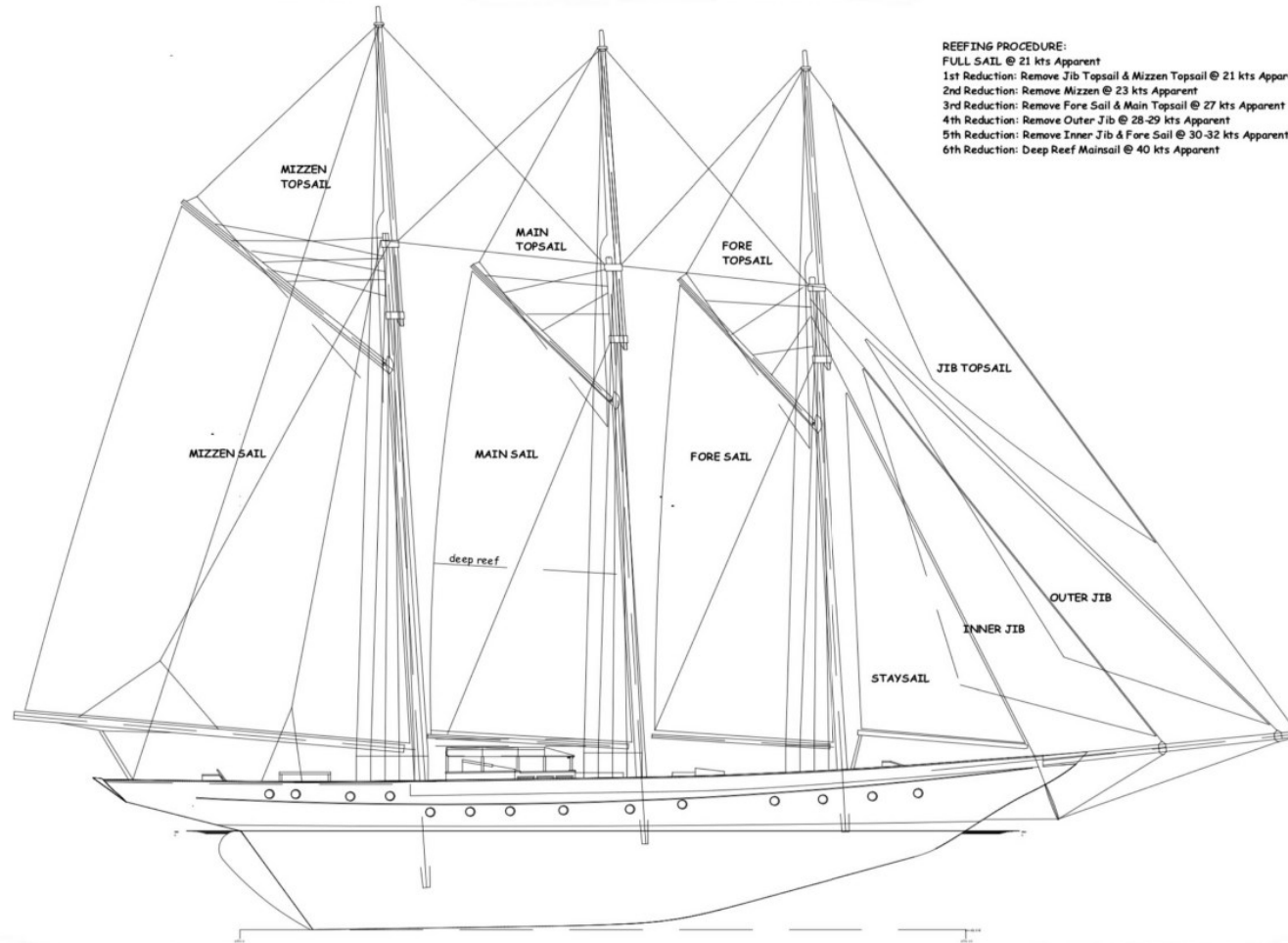

**REEFING PROCEDURE:**  
FULL SAIL @ 21 kts Apparent  
1st Reduction: Remove Jib Top Sail & Mizzen Top Sail @ 21 kts Apparent  
2nd Reduction: Remove Mizzen @ 23 kts Apparent  
3rd Reduction: Remove Fore Sail & Main Top Sail @ 27 kts Apparent  
4th Reduction: Remove Outer Jib @ 28-29 kts Apparent  
5th Reduction: Remove Inner Jib & Fore Sail @ 30-32 kts Apparent  
6th Reduction: Deep Reef Mainsail @ 40 kts Apparent

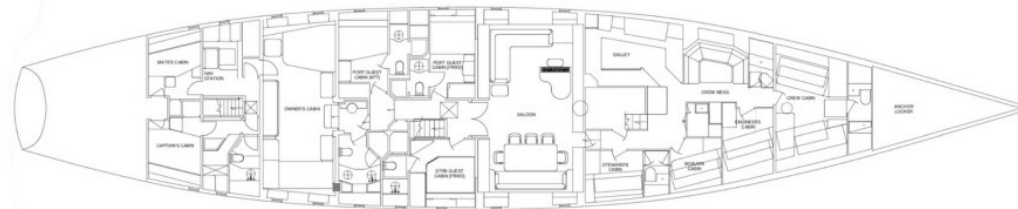

# BURGESS

# WORLD CLASS. WORLD WIDE.

<b>London</b> +44 20 7766 4300	<b>Monaco</b> +377 97 97 81 21	<b>New York</b> +1 212 223 0410	<b>Miami</b> +1 305 672 0150	<b>Singapore</b> +65 9665 8990	<b>Beverly Hills</b> +1 310 424 5112	<b>Palma</b> +34 971 495 413	<b>Athens</b> +30 210 967 1661
<b>Dubai</b> +971 4 425 5874	<b>Phuket</b> +66 8257 01150	<b>Hong Kong</b> +852 6496 2094	<b>Tokyo</b> +81 46 738 8612	<b>Sydney</b> +61 499 945 557	<b>Mumbai</b> +91 98211 67253	<b>Shanghai</b> +86 159 0162 1898	<b>Rio de Janeiro</b> +55 21 2553-3238
		<b>Aspen</b> +1 970 710 2294	<b>Guernsey</b> +44 1481 735360	<b>Palm Beach</b> +1 561 973 2768			

Advertising of these vessel(s) in printed publications, on the internet or in any other medium is not permitted without prior written permission from Burgess. All particulars are given in good faith and are believed correct but they cannot be guaranteed.

Last updated: 14 May 2026