

SERENGETI



SERENGETI

APERÇU.

One of the most established and successful charter yachts in Alaska and California, SERENGETI is the perfect platform for exploration. Whether discovering the breath-taking fjords, watching wildlife, heli-skiing remote peaks, swimming in hot springs or wild salmon fishing, SERENGETI's experienced crew caters to all these interests and more.

Arrive on the spacious main deck where a dedicated crew of seven welcomes you. The entire main deck and flybridge can convert into a climate controlled enclosed space without losing the views. There is a dining table for up to 12 and surrounding sofas, a sit-up bar and outdoor TV. Full walkaround decks are perfect for whale watching and lead you to another seating area at the bow.

The main lounge is airy, open, bright and inviting with comfortable seating. A cherry wood partition with granite countertop separates the room from the formal dining area for 10 guests. The partition houses a pop-up 42in TV for those low key evenings in the lounge after an action packed day.

On the lower deck, a marble floored foyer divides off into four guest cabins: two large double cabins and two identical twin cabins each with pullman bunks for children. Your full beam master, forward on the main deck, is a traditionally styled, cedar lined cabin with an impressive en suite marble bathroom with his and hers sinks, shower and jacuzzi bath.

Guests may choose to retreat to the sky lounge where they will find a sofa area to enjoy their morning coffee gazing over the ocean. Later in the day, take a seat at the sky lounge bar for a pre-dinner cocktail or enjoy an after-dinner card game at the games table.

One deck up, the bridge deck offers a jacuzzi and a partially shaded L-shaped seating area. Taking the stairs up to the sun deck, guests can admire the sea views or sunbathe on the sun pads. This deck is the perfect al fresco party spot with a central bar and four stools, BBQ and TV. For those wishing to keep to their fitness regime, this deck doubles as an outdoor gym with access to a spin bike, yoga mats, free weights and a TRX system.

SERENGETI is fully equipped with a 10.3m (34ft) regulator centre console tender (with a dayhead), a 5.5m (18ft) Novurania expedition tender and complete sport fishing set-ups on the yacht and tenders. As for the toys, to name just a few, there are two three-seater waverunners, tandem kayaks, wakeboards, fun inflatables and a dive compressor.

Principales caractéristiques

Exercise equipment on the flybridge

A crew with local expertise

Jacuzzi on the flybridge

Zero speed stabilisers to reduce any rolling motion while at anchor

SERENGETI

At anchor



Flybridge aft jacuzzi



Flybridge bar



Flybridge



BURGESS

Discover the difference.
burgessyachts.com



SERENGETI

Main deck aft dining area



Foredeck seating area



Bow seating area



Main deck lounge

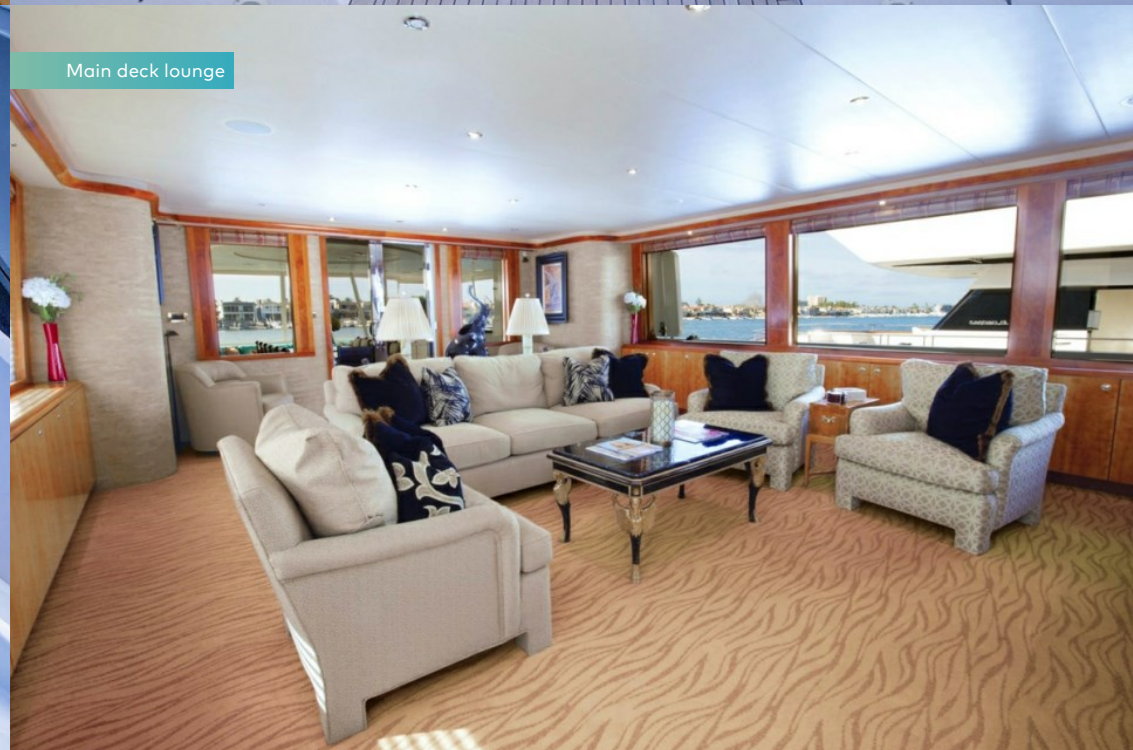

SERENGETI

Main deck dining area



Main deck dining area



Main deck master cabin



Exercise equipment



SERENGETI

Tender



At anchor















BURGESS

Discover the difference.
burgessyachts.com



SERENGETI SPÉCIFICATIONS.

 Longueur 39,6m	 Invités 12
 Chantier 2002 (refitted 2014), Westport Shipyard, United States Of America	 Nb de cabines invités 5 (3 × double, 2 × twin, 2 × additional berths)
 Designer d'intérieur Westport	 Équipage 7
 Largeur 7,9m	
 Tirant d'eau 2m	
 Tonnage brut 180	
 Vitesse de croisière 12 knots	
 Vitesse maximale 27 knots	
 Consommation de carburant en vitesse de croisière 80 litres par heure	
 Moteurs 2 × 2 200hp MTU	

[Voir le yacht sur le site](#)



Annexes & jeux nautiques



1 x Towed tender



1 x Tender



2 x Stand up paddleboards



Wakeboard



Scuba diving equipment



Fishing gear



1 x Deck jacuzzi



Surfboard



Snorkelling gear



2 x Waverunners



Waterskis



2 x Kayaks



Inflatable tows

Remise en forme & bien-être



Free weights



Resistance bands



Suspension trainer



Upright stationary bike



Yoga mats

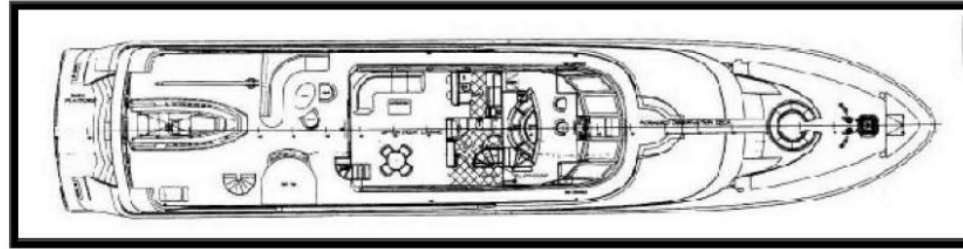

Upper Deck Arrangement

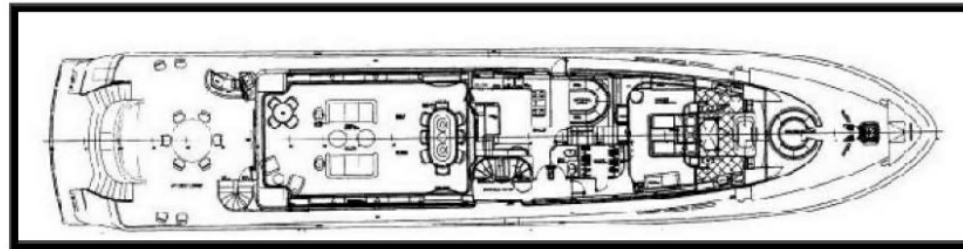

Main Deck Arrangement

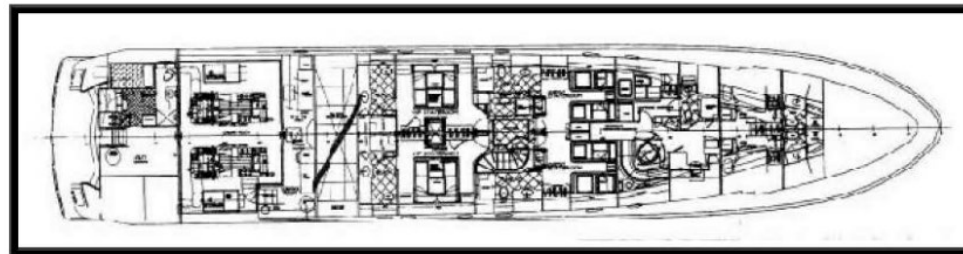

Lower Deck Arrangement

BURGESS

WORLD CLASS. WORLD WIDE.

London	Monaco	New York	Miami	Singapore	Beverly Hills	Palma	Athens
+44 20 7766 4300	+377 97 97 81 21	+1 212 223 0410	+1 305 672 0150	+65 9665 8990	+1 310 424 5112	+34 971 495 413	+30 210 967 1661
Dubai	Phuket	Hong Kong	Tokyo	Sydney	Mumbai	Shanghai	
+971 4 425 5874	+66 7623 9739	+852 6496 2094	+81 46 738 8612	+61 499 945 557	+91 98211 67253	+86 187 0898 6800	

La publicité de ce(s) navire(s) dans des publications imprimées, sur Internet ou sur tout autre support n'est pas autorisée sans l'autorisation écrite préalable de Burgess.
Toutes les informations sont données de bonne foi et sont considérées comme exactes, mais elles ne peuvent être garanties.

Dernière mise à jour : 01 mai 2024