

SEALION



SEALION

OVERVIEW.

Life on the award-winning SEALION is all about refined opulence, blending uplifting light, plush textures and high gloss finishes. With a showstopping sun deck, cutting edge entertainment systems and a variety of relaxation and dining spaces, she offers the full package for a luxurious modern charter.

Wake up in the palatial owner's suite and walk a few steps to the gym for an early morning workout. Then, after freshening up, take the elevator to the bridge deck and join everyone outside to enjoy a healthy breakfast cooked to order.

Mornings are a great time to enjoy watersports and SEALION has a full complement of watertoys for fun above the surface, as well as scuba diving equipment. Are you brave enough to try the vertiginous sun deck waterslide? If you prefer to watch than take part in the action, the main deck aft offers a great vantage point from its comfy sofas.

A leisurely lunch is served on the stunning sun deck, with the large jacuzzi inviting you in for a dip afterwards. The toughest choice you now face is where to relax and enjoy the afternoon sun, either on the vast bank of sun pads nearby, the many sun loungers or the rotating circular sun pad. For a little quiet time, curl up under a cashmere throw to watch a movie on 103-inch plasma screen TV in the media room, which also features a complex spinning solar system model. SEALION's award-winning interior, perhaps best described as contemporary Art Deco, is a feast for the eyes and the senses, with intricate attention to detail throughout.

With cocktail hour approaching, head to your cabin to change. SEALION accommodates up to 12 guests in six cabins, including the split-level master suite with large walk-in wardrobe and spacious marble bathroom; a VIP suite with walk-in wardrobe, also on the main deck; and two double and two convertible twin cabins on lower deck.

Sip a romantic sundowner with a loved one on the secluded Portuguese bridge, then join everyone in the main deck lounge with music from the piano and expertly mixed cocktails, before moving to the formal dining area for an impeccable banquet. Continue the festivities on the sun deck, now transformed to an open air nightclub, with bar service, great music and the table converted into a stage for dancing and performers. Or for a more sedate option, enjoy a movie on the vast outdoor cinema screen under the natural amphitheatre of the stars.

Key features

Winner of the World Superyacht (2010), International Yacht (2011) and SBID Design Awards (2011)

Refitted in 2023

Beach club at sea level

Walk-in dressing area

Child-friendly yacht

Fully equipped gym

Castoldi towed tender

Outdoor cinema screen

Shaded deck dining and deck areas

Elevator serving lower to bridge deck

Jacuzzi on the sun deck

Zero speed stabilisers to reduce any rolling motion while at anchor

SEALION

At anchor



Aerial view



Cruising



At anchor



SEALION

Sun deck aft



Sun deck bar



Sun deck jacuzzi



Sun deck aft



SEALION

Sun deck dining



Sun deck dining



Upper deck dining



Upper deck



SEALION

SPECIFICATION.



Length
62m (203.4ft)



Built
2009 (refitted 2023), Viareggio Superyachts, Italy



Interior designer
Candy & Candy



Beam
11m (36.1ft)



Draft
3.3m (10.8ft)



Gross tonnage
1,056



Cruising speed
15 knots



Maximum speed
17 knots



Fuel consumption at cruising speed
80 litres per hour



Engines
2 x 2,682hp Caterpillar



Guests
12



No. of guest cabins
6 (4 x double, 2 x twin)



Crew
16

[View yacht on website](#)

[Watch yacht video](#)



SEALION

TENDERS & TOYS



4 x Tenders



1 x Deck jacuzzi



2 x Waverunners



4 x SeaBobs



2 x eFoils



2 x Kayaks



2 x Stand up paddleboards



Wakeboard



Waterskis



Anti-jellyfish pool



Inflatable platform



Waterslide



Inflatable tows



Snorkelling gear



Fishing gear



RYA training centre for jetskis
& waverunners

SEALION

FITNESS & WELLNESS



Cross trainer



Free weights



Training bench



Treadmill



Yoga mats



SEALYON 62

GENERAL ARRANGEMENT

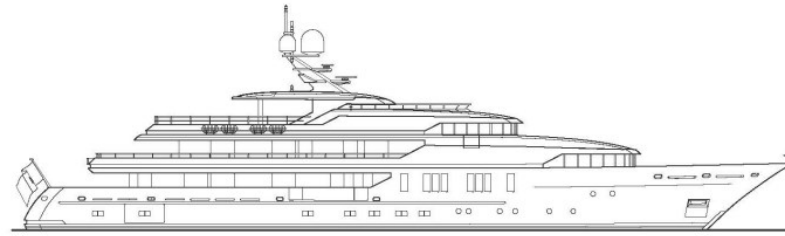

PROFILE

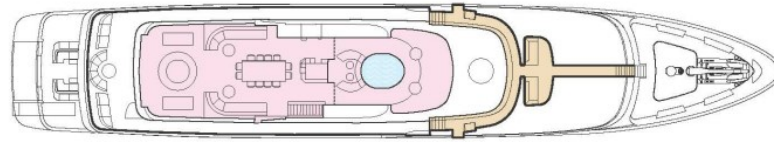

SUN DECK

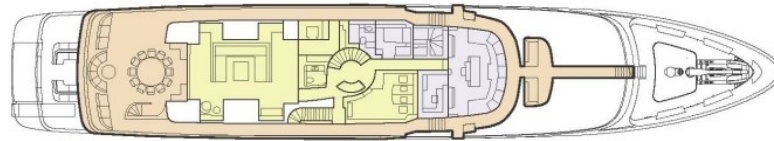

BRIDGE DECK

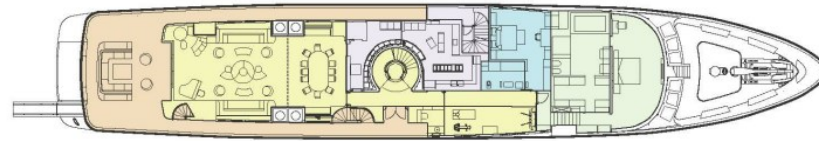

MAIN DECK

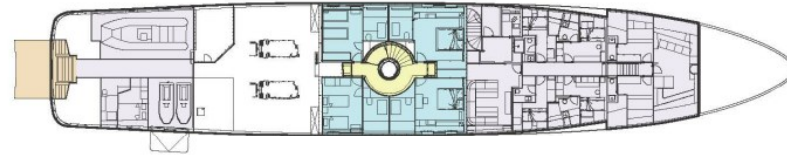

LOWER DECK



KEY

- | | |
|--------------|--------------|
| DECK | SUN DECK |
| MASTER CABIN | GUEST CABINS |
| GUEST AREAS | CREW AREAS |

BURGESS

WORLD CLASS. WORLD WIDE.

| | | | | | | | |
|-----------------------------------|-----------------------------------|------------------------------------|---------------------------------|-----------------------------------|---|--------------------------------------|---|
| London +44 20 7766 4300 | Monaco +377 97 97 81 21 | New York +1 212 223 0410 | Miami +1 305 672 0150 | Singapore +65 9665 8990 | Beverly Hills +1 310 424 5112 | Palma +34 971 495 413 | Athens +30 210 967 1661 |
| Dubai +971 4 425 5874 | Phuket +66 7623 9739 | Hong Kong +852 6496 2094 | Tokyo +81 46 738 8612 | Sydney +61 499 945 557 | Mumbai +91 98211 67253 | Shanghai +86 187 0898 6800 | Rio de Janeiro +55 21 2553-3238 |
| Aspen +1 970 710 2294 | | | | | | | |

Advertising of these vessel(s) in printed publications, on the internet or in any other medium is not permitted without prior written permission from Burgess. All particulars are given in good faith and are believed correct but they cannot be guaranteed.

Last updated: 04 March 2025