

SEA EAGLE

SEA EAGLE

APERÇU.

SEA EAGLE is a game-changing sailing yacht, a quite remarkable feat of design and engineering. With head-turning good looks, outstanding comfort and unbeatable performance, even in light winds, she possesses a unique attraction. She will also appeal to those who appreciate bold achievements as she is one of the 10 largest sailing yachts ever built. She is all about the superlative.

As well as being an aesthetically alluring yacht, one with real presence on the water, this is a yacht that regularly sails at double-digit speeds and takes a matter of minutes to go from anchored to sailing. She can harness the natural power of the wind and convert it into a blistering 22 knots, her vertical bow slicing through the waves with barely a whisper. SEA EAGLE is a yacht that places you at one with nature.

The sheer exhilaration of sailing at this speed cannot be overstated. There is a feeling of being connected to a natural force. This pace also makes it easy for her to relocate quickly, allowing you to sail where you want without sacrificing valuable time. When the day is calm, the yacht's two large engines keep the itinerary on track.

Despite her ocean-taming pace and beguiling good looks, SEA EAGLE is very comfortable underway, ensuring utmost comfort when moving around on board in any conditions. Her highly experienced crew are available to help with your every need.

At anchor her vast deck spaces transform into a playground of possibilities. See the sun set with a cocktail on the flybridge as the chef prepares an informal dinner on the BBQ. Watch a movie on a huge screen in the main deck's outdoor cinema or climb into the eagle's nest that rises up the main mast to enjoy thrilling bird's-eye views of your anchorage.

Enjoy a pre-dinner drink at the inside-outside bar on the main deck aft or take lunch in the open-air dining table shaded by the overhang before stretching out on the expansive aft deck. For special occasions there's a formal dining room and lounge with wraparound views.

If you want to venture ashore to explore, she has a midships boarding platform that can be used in any conditions. Otherwise access to the water is via the folding swim platform aft, where the crew is ready to help you enjoy a vast range of watertoys, from waverunners to e-foils, SeaBobs to sailing dinghies, scuba diving kit to kayaks and SUPs.

When it's time for bed, she has extremely versatile accommodation on the lower deck with two master suites, three twin suites and a gym that can convert into a children's cabin, a nanny's cabin with cot, or a staff cabin.

If your guests are seeking to understand the epic power of nature, appreciate the wonder of the ocean and revel in a seven-star retreat, no other sailing yacht delivers like SEA EAGLE. All this while enjoying a wonderful holiday afloat with a crew that everyone loves. Book your unforgettable charter today.

Principales caractéristiques

The world's largest aluminium luxury schooner yacht

Winner of the International Superyacht Society Awards of Distinction for Best Sail above 500GT

Outstanding sailing experience and performance with up to 22 knots under sail

Unrivalled range allowing the most efficient relocation on charter

Six guest cabins including one convertible twin cabin into a gym

From anchored to sailing in minutes

Guest crow's nest on main mast

SEA EAGLE

SEA EAGLE exquisite lines



Welcome onboard



Aft deck lounging



Versatile flybridge



SEA EAGLE

Aft deck outdoor dining



Flybridge



Unique lounging option on the forward deck



Sunset on the flybridge



SEA EAGLE

Unique dinner experience



Romantic dinner on the water



Outdoor cinema on aft deck



Night at anchor



SEA EAGLE

Master cabin



Twin cabin



Bathroom en suite



Outstanding service onboard SEA EAGLE



SEA EAGLE

Massage room/gym



Gym/massage room



Forward lounge and dining



Forward lounge



SEA EAGLE

Aft lounge



Aft lounge bar



Access to cabins



Outdoor workout on aft deck



SEA EAGLE

Access to swim platform



Swim platform



Tenders and toys



Going sailing



SEA EAGLE

SEA EAGLE sailing around the World



SEA EAGLE in Scotland

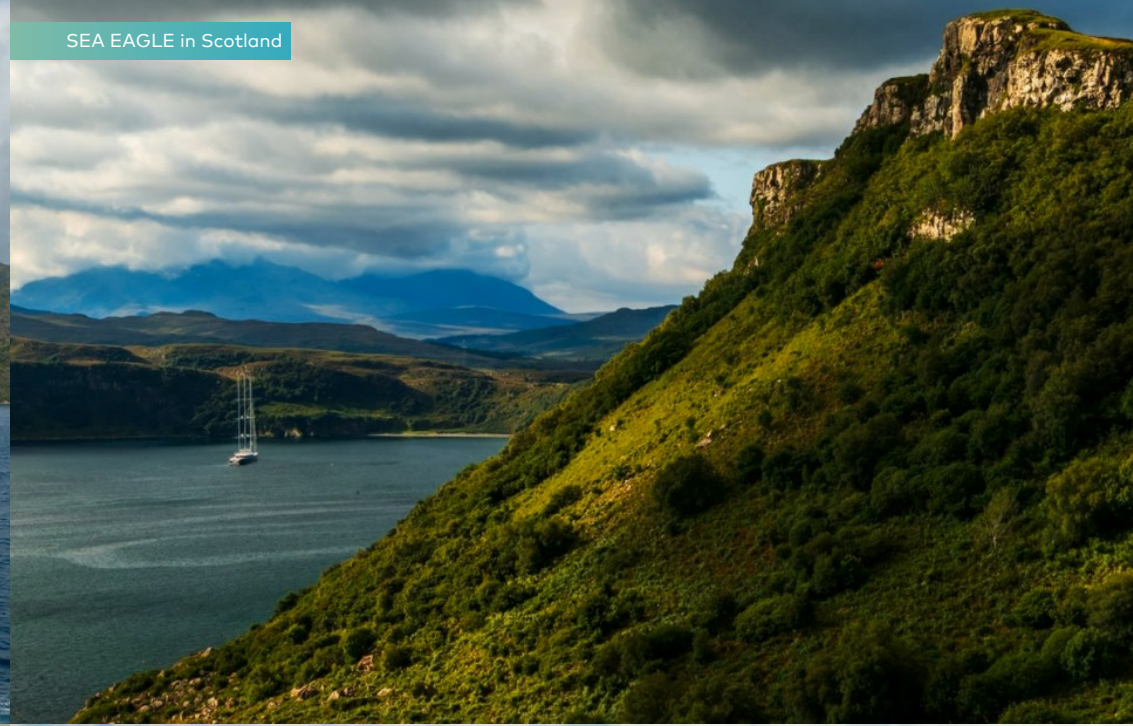

Cosy lunch in Scotland



SEA EAGLE in Norway



SEA EAGLE

Scandinavian times on board SEA EAGLE



SEA EAGLE in Norway



SEA EAGLE in St Lucia



SEA EAGLE in French Polynesia



SEA EAGLE SPÉCIFICATIONS.



Longueur
81m



Chantier
2020 (refitted 2022), Royal Huisman Shipyard, The Netherlands



Designer d'intérieur
Mark Whiteley Design



Largeur
12,3m



Tirant d'eau min / max
6m/6m



Déplacement
1 104 tonnes



Vitesse de croisière
12 knots



Vitesse maximale
22 knots



Consommation de carburant en vitesse de croisière
200 litres par heure



Moteurs
2 x 1 450hp Caterpillar



Invités
12



Nb de cabines invités
6 (4 x double, 1 x double/twin, 1 x twin)



Équipage
14

[Voir le yacht sur le site](#)

[Regarder la vidéo du yacht](#)



Annexes & jeux nautiques



2 x Tenders



2 x Sailing dinghies



Inflatable platform



RYA training centre for jetskis & waverunners



2 x Waverunners



2 x SeaBobs



1 x eFoil



2 x Kayaks



4 x Stand up paddleboards



Wakeboard



Kite surfing equipment



Windsurfer



Scuba diving equipment



Fishing gear



Snorkelling gear

8m RIB-X D Tube Yanmar 6CYL 260HP Inboard Diesel propeller - for watersports use - with awnings, 5m RIB-X SOLAS Med Yanmar 150HP Inboard Diesel Jetdrive, 2 x Jet ski Sea Doo 90Hp engine - 2seaters each, Wake board JOBE, 4 x Stand Up Paddle Boards (2xJOBE 10.6ft, 2xFanatics 11.6ft long), 2 x Kayaks Nomad (1 pax each), 2 x Sea Bob F5S 5HP engine, Inflatable JOBE Airstream Funtube (4 pax), 2 x Nautibuoy teak platforms for transom, 6 x Dive gear Aqua Lung (Rendez Vous only), 15 x Snorkels and fins Aqua Lung Various sizes , eFoil Flightboard, Electric surfboard A-Wake, 2 x RS Neos Dinghys (1 or 2 pax), Kitesurf (2 kites), Windsurf, 2 x Professional fishing chairs with fishing gear

Remise en forme & bien-être

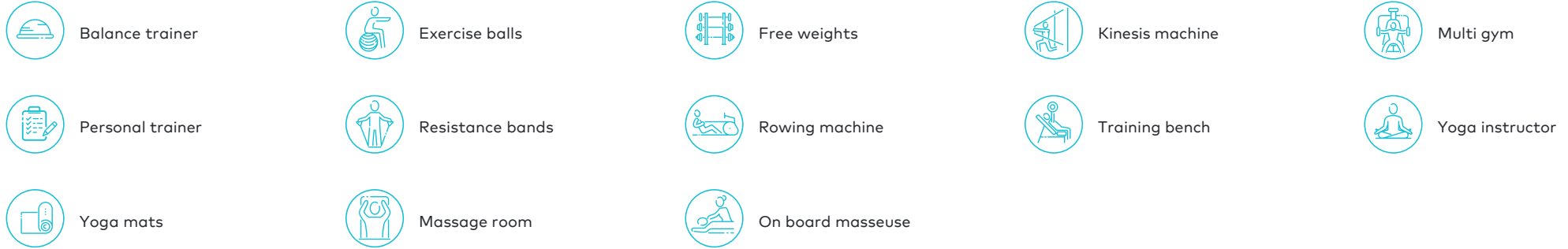

Technogym wall kinesis, Technogym bench with weights - new from November 2022, Kettle bells, TRXs, Rowing machine, Yoga mats, Resistance bands, 2 x E-Bikes Specialized Mountain bikes

Communication et divertissement

State-of-the-art audio visual equipment with movies and music on demand, outdoor cinema set up, Starlink internet Convertible cabin into a gym, outdoor gym equipment, convertible cabin into a massage room

SEA EAGLE

Deck Plan

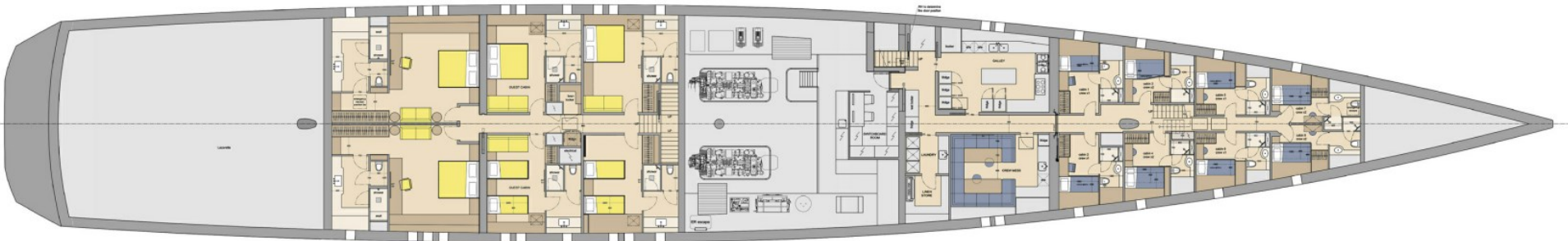
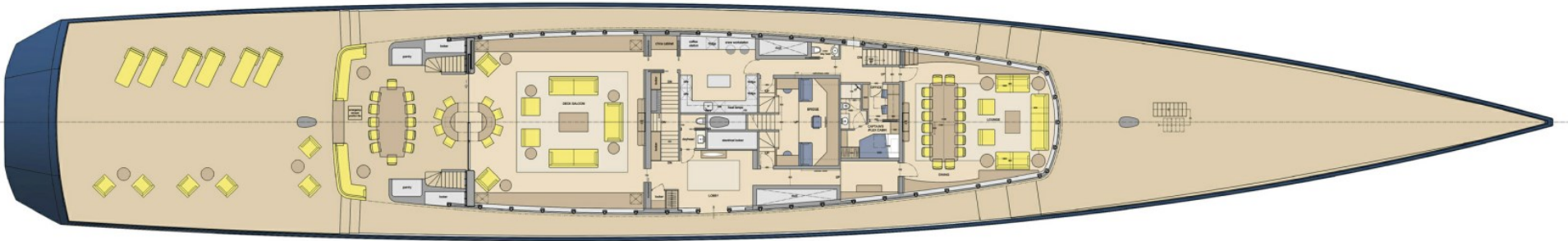
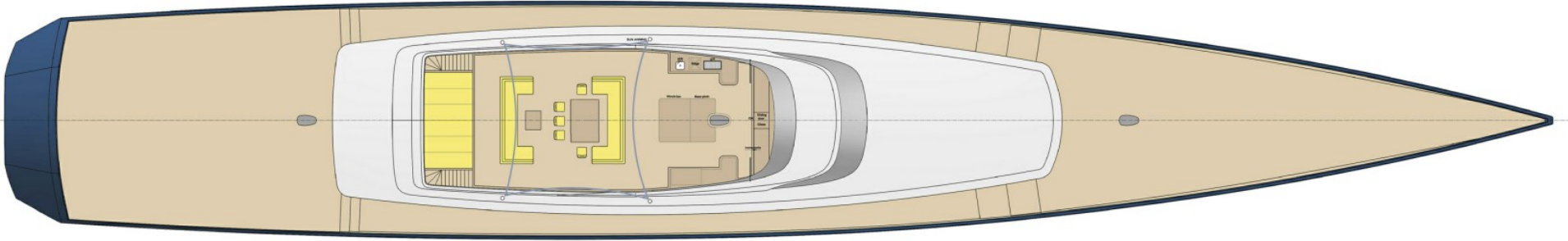

BURGESS

WORLD CLASS. WORLD WIDE.

London +44 20 7766 4300	Monaco +377 97 97 81 21	New York +1 212 223 0410	Miami +1 305 672 0150	Singapore +65 9665 8990	Beverly Hills +1 310 424 5112	Palma +34 971 495 413	Athens +30 210 967 1661
	Dubai +971 4 425 5874	Phuket +66 7623 9739	Hong Kong +852 6496 2094	Tokyo +81 46 738 8612	Sydney +61 499 945 557	Mumbai +91 98211 67253	

La publicité de ce(s) navire(s) dans des publications imprimées, sur Internet ou sur tout autre support n'est pas autorisée sans l'autorisation écrite préalable de Burgess.
Toutes les informations sont données de bonne foi et sont considérées comme exactes, mais elles ne peuvent être garanties.

Dernière mise à jour : 28 mars 2024