

# SEA D

---



SEA D

# OVERVIEW.

**Cruising exclusively in the island-speckled aquatic playground that is Thailand and South East Asia, SEA D is your gateway into an unspoilt natural wonderland.**

Whether you want to take the high-speed jet tender ashore to experience the temples, jungles, markets and nightlife, play with all the watertoys, go fishing or dive the day away, SEA D's creatively talented chef will keep you coming back on board while her gym, sauna and massage treatments make sure you'll stay fit, fresh and focused.

Her SCUBA diving equipment means you can get up-close to some of the world's healthiest reefs, teeming with colour and marine life - including whale sharks and giant oceanic mantas. Her kayaks and stand-up paddleboards are perfect for exploring the dramatic limestone cliffs of Phang Nga Bay and meeting the rare dugong of Koh Libong and Koh Muk.

Start the day with breakfast al fresco on the upper deck aft then head down to the huge swim platform where the crew have all the toys fired up, including two Axis A20 wake boats, for the morning's thrills. As Captain Stefan, who knows every inch of these islands, guides the yacht to the next amazing location, you can chill on the sun deck with a cocktail from the bar or enjoy movies, sports or shows in the air-conditioned comfort of the media lounge.

On arrival, the crew sets up the beach BBQ for a sumptuous lunch of freshly caught fish before you glide around on the e-foil or go snorkelling to explore your new anchorage. For the evening, will you dine ashore to experience the friendliness and vibrancy of Thai cuisine and culture, or let the chef prepare something awesome to enjoy in the yacht's dining room, the perfect location for special celebrations?

Either way you can all gather on the main deck after with a night cap to talk about another amazing day. When bedtime comes, you'll find her versatile, family-friendly accommodation suits every need. Yours is the full-beam master suite on the main deck, en suite and with a walk-in wardrobe, and there's a full-beam VIP suite, two double cabins and a twin cabin on the lower deck, all featuring restful contemporary design. However you want to explore in South East Asia, SEA D has all you need to do it in the most unforgettable way.

## Key features

---

**Spa facilities: treatments available onboard (please enquire)**

---

**A crew with local expertise**

---

SEA D

Main deck lounge



Main deck master cabin

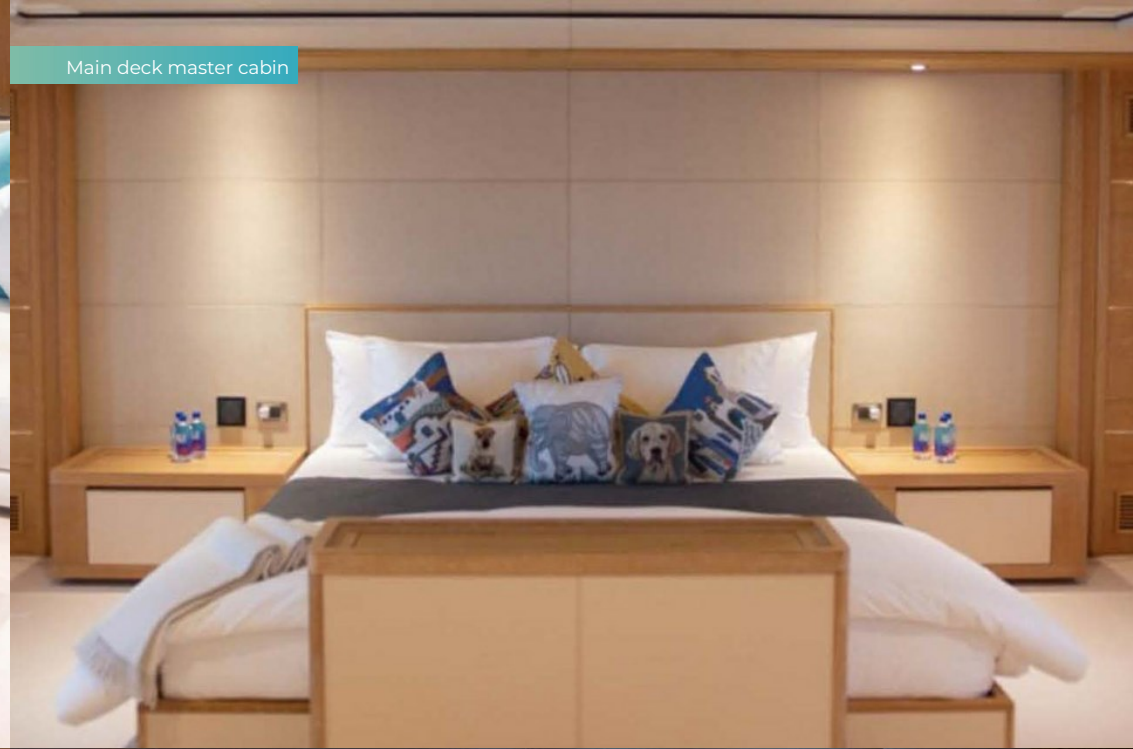

Guest cabin



Gym



SEA D

Stern view



BURGESS

Discover the difference.  
burgessyachts.com



SEA D

# SPECIFICATION.



Length  
**39.4m (129.3ft)**



Built  
**2003 (refitted 2007), Proteksan Turquoise, Turkey**



Interior designer  
**Jean-Guy Verges**



Beam  
**8.3m (27.2ft)**



Draft  
**1.8m (5.9ft)**



Gross tonnage  
**398**



Cruising speed  
**16 knots**



Maximum speed  
**18 knots**



Engines  
**2 x 2,285hp MTU**



Guests  
**10**



No. of guest cabins  
**5 (4 x double, 1 x twin)**



Crew  
**7**

[View yacht on website](#)



SEA D

# TENDERS & TOYS



2 × Tenders



2 × SeaBobs



2 × eFoils



2 × Kayaks



2 × Stand up paddleboards



Wakeboard



Wakesurf



Scuba diving equipment

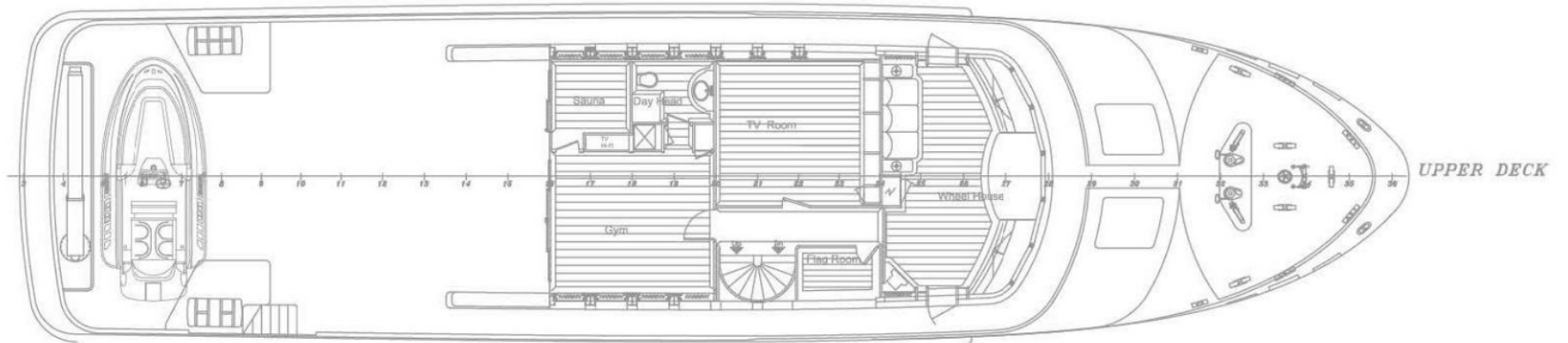
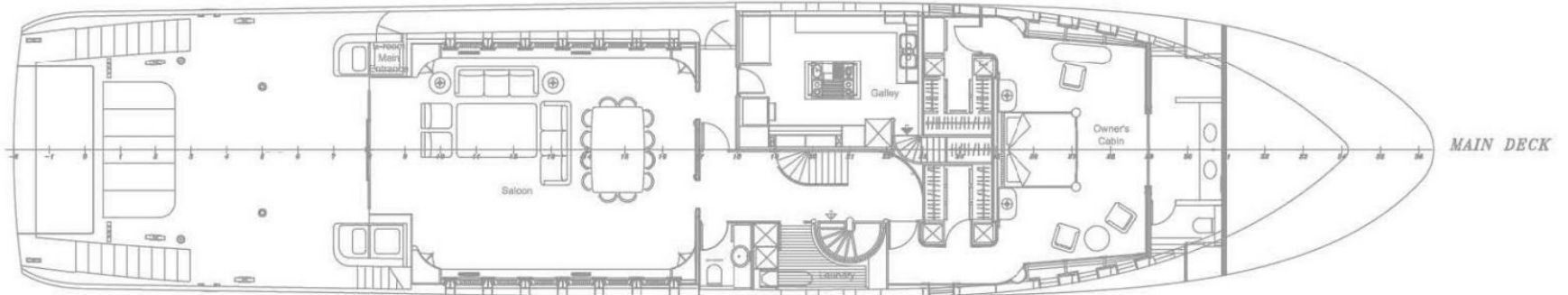
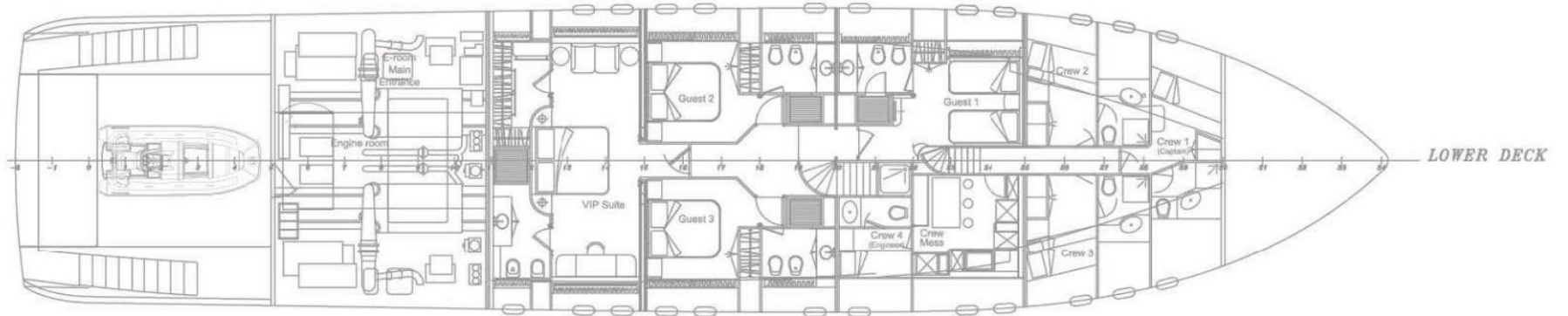

# BURGESS

# WORLD CLASS. WORLD WIDE.

<b>London</b> +44 20 7766 4300	<b>Monaco</b> +377 97 97 81 21	<b>New York</b> +1 212 223 0410	<b>Miami</b> +1 305 672 0150	<b>Singapore</b> +65 9665 8990	<b>Beverly Hills</b> +1 310 424 5112	<b>Palma</b> +34 971 495 413	<b>Athens</b> +30 210 967 1661
<b>Dubai</b> +971 4 425 5874	<b>Phuket</b> +66 7623 9739	<b>Hong Kong</b> +852 6496 2094	<b>Tokyo</b> +81 46 738 8612	<b>Sydney</b> +61 499 945 557	<b>Mumbai</b> +91 98211 67253	<b>Shanghai</b> +86 187 0898 6800	<b>Rio de Janeiro</b> +55 21 2553-3238

Advertising of these vessel(s) in printed publications, on the internet or in any other medium is not permitted without prior written permission from Burgess. All particulars are given in good faith and are believed correct but they cannot be guaranteed.

Last updated: 10 December 2024