

SEA CLASS



OVERVIEW.

For those in search of a stunning yacht with an abundance of water sports toys to keep you and your guests fully occupied, look no further. SEA CLASS boasts an outstanding collection of water sports equipment, complemented by an 8.2m (27ft) waterslide that descends from the magnificent sun deck to the sea below. Additionally, SEA CLASS features a 9.1m (30ft) in-water inflatable swimming pool with poolside loungers and dock space for four jet skis. The toy collection includes an 11.2m (37ft) tender, a jet RIB, two e-foils, two SeaBobs, kite surfing equipment, SUPs, and six sets of Scuba dive gear. These accompany a full range of towable inflatables, wakeboards, and water skis.

After indulging in these activities, you can enjoy a private beach party. Let her expert crew create an amazing experience for you and your guests, whether it's for a BBQ lunch or to watch the sunset. SEA CLASS is equipped with all you need for an exclusive seaside celebration.

For a more refined dining experience, you'll feel at home on board in her two dedicated dining areas. Beneath the hardtop, on the gorgeous sun deck, you can dine while taking in your surroundings from an elevated setting. There's also a beautiful formal dining area in the main deck saloon, where you can enjoy fine dining creations in comfort and style.

To relax, there are plenty of areas, whether it's outside on the sun deck – with its jacuzzi, sunpads, and freestanding sun loungers, in the long al fresco lounge area on the upper deck, or in the seating in the cockpit. There is no lack of space on deck for you and your party. The communal guest areas benefit from large picture windows, and a 2023 refit has left her immaculately presented. The bridge deck lounge area has a wet bar, games table, and relaxed seating space, while the main saloon has a vast lounge area and dining area.

At the end of each day, you can retire to the sanctuary of your full-beam main deck master suite, where you'll find a king-sized berth and an en suite bathroom with a separate shower compartment. To help you fully unwind, there's also a spa bath. Those with children or staff need not give up a suite on the lower deck. Just aft of the master suite, SEA CLASS surprises with a double suite that's accessible from the main foyer. Four more double guest suites can be found on the lower deck, three of which have the option to be converted to twin-berth cabins, giving SEA CLASS flexible berthing arrangements.

Key features

Child-friendly yacht

Flexible cabin configurations

Optional sixth cabin (double) suited for nanny, staff, or children

Exercise equipment

11m Everglades towed tender

Jacuzzi on the sun deck

Zero speed stabilisers to reduce any rolling motion while at anchor

SEA CLASS



BURGESS

Discover the difference.
burgessyachts.com



SEA CLASS

SPECIFICATION.



Length
47.2m (154.9ft)



Built
**1997 (refitted 2018, refurbished 2023),
Christensen Shipyards, United States Of
America**



Interior designer
Glade Johnson Design



Beam
8.4m (27.6ft)



Draft
2.5m (8.2ft)



Gross tonnage
460



Cruising speed
13 knots



Maximum speed
16 knots



Fuel consumption at cruising speed
385 litres per hour



Guests
12



No. of guest cabins
**5 (2 × double, 3 × double/twin, 1 × additional
berths)**



Crew
10

[View yacht on website](#)

[Watch yacht video](#)



SEA CLASS

TENDERS & TOYS



1 × Towed tender



1 × Tender



1 × Deck jacuzzi



Waterslide



Anti-jellyfish pool



4 × Waverunners



2 × SeaBobs



2 × eFoils



1 × Kayak



2 × Stand up paddleboards



Wakeboard



Kite surfing equipment



Waterskis



Inflatable toys



Scuba diving equipment

SEA CLASS

FITNESS & WELLNESS



Free weights



Resistance bands



Yoga mats



SEA CLASS

Deck plans

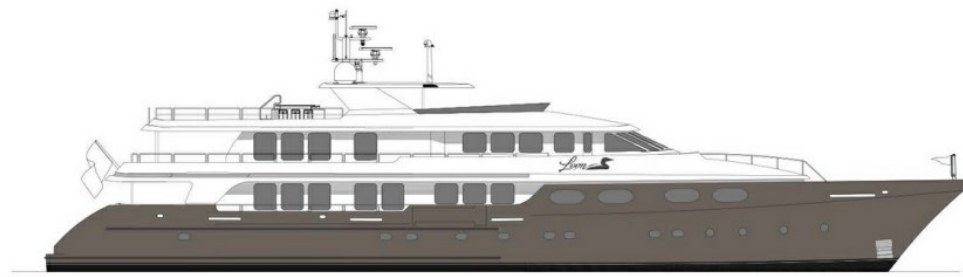

PROFILE

Jacuzzi

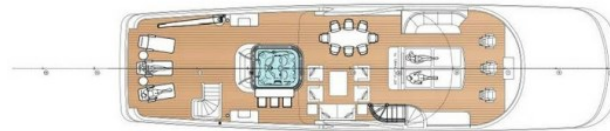

SUN DECK

Captain's Cabin
Skylounge
Pilot House

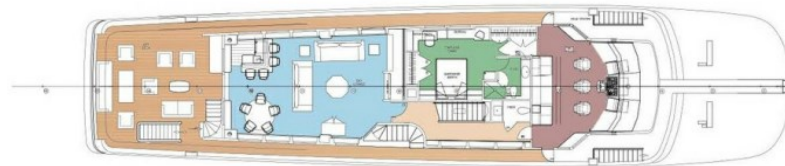

BRIDGE DECK

Master Cabin
Guest Space
Foyer
Kitchen
Dining Room
Main Salon



MAIN DECK

Guest Accommodations
House Keeping
Crew Lounge
Walk-in Refrigerator
Crew Quarters

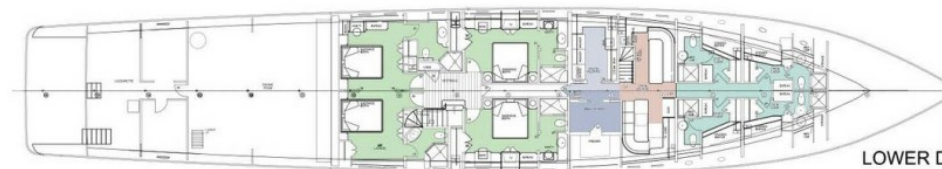

LOWER DECK

BURGESS

WORLD CLASS. WORLD WIDE.

London +44 20 7766 4300	Monaco +377 97 97 81 21	New York +1 212 223 0410	Miami +1 305 672 0150	Singapore +65 9665 8990	Beverly Hills +1 310 424 5112	Palma +34 971 495 413	Athens +30 210 967 1661
Dubai +971 4 425 5874	Phuket +66 7623 9739	Hong Kong +852 6496 2094	Tokyo +81 46 738 8612	Sydney +61 499 945 557	Mumbai +91 98211 67253	Shanghai +86 187 0898 6800	Rio de Janeiro +55 21 2553-3238

Advertising of these vessel(s) in printed publications, on the internet or in any other medium is not permitted without prior written permission from Burgess. All particulars are given in good faith and are believed correct but they cannot be guaranteed.

Last updated: 10 December 2024