

RUYA



RUYA

APERÇU.

Delivered in 2016, the 41.4m (135.9ft) motor yacht RUYA is a gleaming gem on the charter market. Guests love her award-winning, thoroughly original and truly outstanding Australian outback-inspired interior by famed designer Sam Sorgiovanni.

Built to celebrate al fresco living, she has a huge 93sqm (1,001sqft) sun deck complete with bar, BBQ, open-air dining shaded by the hardtop, a glass-fronted 10-person jacuzzi for soaking in the sun and gym equipment for morning workouts. Glass screens keep you draft-free without spoiling the views.

The hydraulic swim platform gives you step-free access to the water and the beach club where you can relax and snack between swims. She has an armada of watertoys to keep everyone's adrenaline levels up and the yacht is also an RYA-approved training centre so you can use the toys without a licence.

Inside, her interior makes use of indigenous material like bamboo and Australian silky oak to create a relaxed, comforting environment. Floor-to-ceiling glass in the main lounge and formal dining room create a remarkable sense of openness and that flows into the main deck aft lounge area. There's shaded open-air dining and a sun lounge on the upper deck aft and inside is a home cinema with an 80in screen and surround sound for movie nights.

She welcomes 10 guests in five finely appointed suites. There is a full-beam master suite forward on the main deck, wonderfully illuminated by large picture windows, with a private office and his-and-hers bathroom with bath and shower area. Two double cabins and two twin cabins on the lower deck complete her accommodation.

This is a yacht that intimately connects her guests to their environment, from the sun deck to the beach club, served by a crew that always gets brilliant feedback. For fans of the great outdoors, look no further than RUYA.

Principales caractéristiques

Impressive interior volume of 499GT usually found on much larger yachts

Generous 93sqm sun deck with large jacuzzi

Thoroughly original Sam Sorgiovanni interior design

Vast hydraulic swim platform

Low fuel consumption

Zero speed stabilisers to reduce any rolling motion while at anchor

RUYA

Main deck aft



Main deck lounge



Main deck lounge



Main deck dining area



RUYA

Main deck dining area



Main deck master cabin



Main deck master cabin study



Main deck master cabin bathroom en suite



RUYA

Main deck master cabin bathroom en suite



Lower deck double cabin



Lower deck double cabin bathroom en suite



Lower deck twin cabin



RUYA

Lower deck twin cabin bathroom en suite



Upper deck outdoor dining



Sun deck lounge



Sun deck



RUYA

Sun deck jacuzzi



Upper deck lounge



Upper deck lounge



Sun deck



BURGESS

Discover the difference.
burgessyachts.com



RUYA

Beach club



Watersports



Running



BURGESS

Discover the difference.
burgessyachts.com



RUYA

SPÉCIFICATIONS.



Longueur
41,4m



Chantier
2016 (refitted 2021), Alia Yachts, Turkey



Designer d'intérieur
Sam Sorgiovanni



Largeur
8,9m



Tirant d'eau
2,5m



Tonnage brut
499



Vitesse de croisière
12 knots



Vitesse maximale
13 knots



Consommation de carburant en vitesse de croisière
120 litres par heure



Moteurs
2 x 1 000hp Caterpillar



Invités
10



Nb de cabines invités
5 (3 x double, 2 x double/twin, 2 x additional berths)



Équipage
8

Note

Not available for charter to US residents while in US waters.

[Voir le yacht sur le site](#)

[Regarder la vidéo du yacht](#)



Annexes & jeux nautiques



1 x Tender



1 x Deck jacuzzi



RYA training centre for jetskis & waverunners



2 x Waverunners



2 x SeaBobs



3 x Kayaks



3 x Stand up paddleboards



Wakeboard



Waterskis



Inflatable toys



Scuba diving equipment



Snorkelling gear

7.9m Century chase tender with 2 x 150hp engine (Available only in the Caribbean) | 5.8m Novurania chase tender with diesel jet Yanmar 260hp engine | 3.6m AB Navigo VS inflatable tender with Evinrude 25hp outboard engine | 2 x Sea-Doo RXT-X 300 (3 man) | 2 x SeaBobs F5S | 2 x inflatable kayaks | Waterskis, wakeboards | 3 x stand up paddle boards | 6 x towables | Snorkelling gear | Approved RYA training centre for guests

Remise en forme & bien-être



Free weights



Yoga mats

Weights | kettle bells | yoga mats

Communication et divertissement

Comprehensive AV systems | Satellite television | Apple TV | PLEX movie system | PlayStation, Xbox | Satcom & cellular communications facilities | VOIP, Fleet BB, Wi-Fi internet access | 2 x Starlink high speed internet

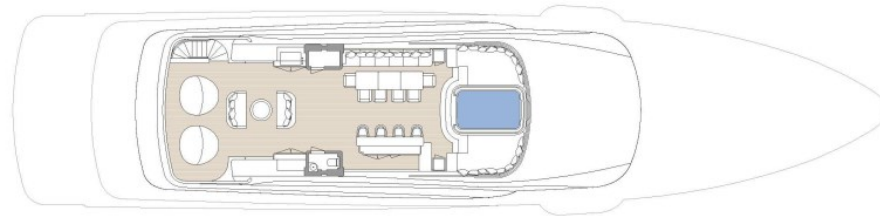

SUN DECK



UPPER DECK

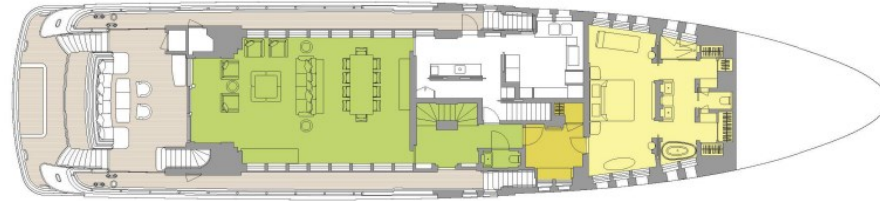

MAIN DECK

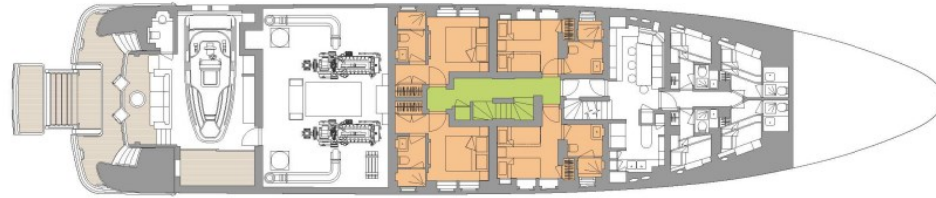

LOWER DECK

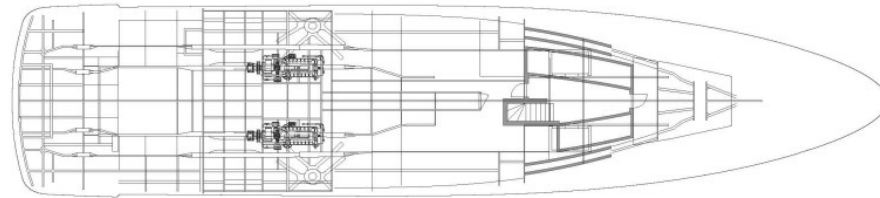

BOTTOM DECK

■ GUEST AREAS ■ MASTER SUITE ■ GUEST CABINS ■ MASTER SUITE OFFICE ■ JACUZZI

BURGESS

WORLD CLASS. WORLD WIDE.

London +44 20 7766 4300	Monaco +377 97 97 81 21	New York +1 212 223 0410	Miami +1 305 672 0150	Singapore +65 9665 8990	Beverly Hills +1 310 424 5112	Palma +34 971 495 413	Athens +30 210 967 1661
Dubai +971 4 425 5874	Phuket +66 7623 9739	Hong Kong +852 6496 2094	Tokyo +81 46 738 8612	Sydney +61 499 945 557	Mumbai +91 98211 67253	Shanghai +86 187 0898 6800	Rio de Janeiro +55 21 2553-3238

La publicité de ce(s) navire(s) dans des publications imprimées, sur Internet ou sur tout autre support n'est pas autorisée sans l'autorisation écrite préalable de Burgess.
Toutes les informations sont données de bonne foi et sont considérées comme exactes, mais elles ne peuvent être garanties.

Dernière mise à jour : 10 mai 2024