

ROMA



ROMA

OVERVIEW.

Designed by the highly acclaimed Norwegian architect Espen Oeino and built by the Italian yard Viareggio Superyachts, ROMA is a highly sought after yacht on the charter market with an exquisite interior designed by Katharina Raczek.

ROMA's bright cream and white colour palette creates an impressive feeling of space throughout. There are accents of deep red and gold which add character and elegance. Guests can marvel at the beautiful interior detailing such as the main lounge carpet which simulates sand on the sea bottom or the white Art Deco 3D laser cut panelling on the main staircase simulating sea shells. The large main lounge offers multiple seating options and a backlit onyx bar, circular dining for up to 12 and multiple coffee tables. One of her most impressive features on this deck is her on-board cinema / games room where the walls are ornamented with fibre optic stars!

ROMA's full beam sky lounge offers guests another social area to relax or play games on the games table. Outside, there is a second dining table with glass surround windbreaks and the magnificent sun deck offer multiple seating arrangements, adjustable sun pads for sunbathing, bar and a generous jet pool with adjustable current (perfect for a workout!). Furthermore, an air conditioned, well equipped gym ensures guests' every requirement is fulfilled.

Renewed in 2019, the full beam master cabin is immaculate. A king size bed and pull-out sofa look forward to panoramic sea views and there is a private working desk area, dressing area and spacious marble en suite. A further three guest cabins are beautifully appointed with champagne and cream tones; a fifth double cabin is located on the upper deck and a sixth convertible cabin is located on the lower deck, perfect for those seeking a little more privacy.

With an onboard PADI dive instructor, ROMA offers dive courses and supervision of activities to the very highest safety standard. It is therefore no surprise that ROMA holds a vast array of water toys. Included is a 16.8m chase boat, waverunners, jetskis, SeaBobs, a 27m water slide, a water trampoline and many more.

Key features

Wheelchair friendly

Spa facilities: licensed masseuse and beautician

Fully equipped gym

Elevator serving main to sun decks

PADI certified scuba dive yacht

18m Anvera chase tender

Child friendly yacht

Zero speed stabilisers to reduce any rolling motion while at anchor

ROMA

Aerial view



Sun deck forward pool



Cocktails



Media room



BURGESS

Discover the difference.
burgessyachts.com



ROMA

Masseuse



Sun deck aft dining area



Sun deck aft loungers



Upper deck aft dining area

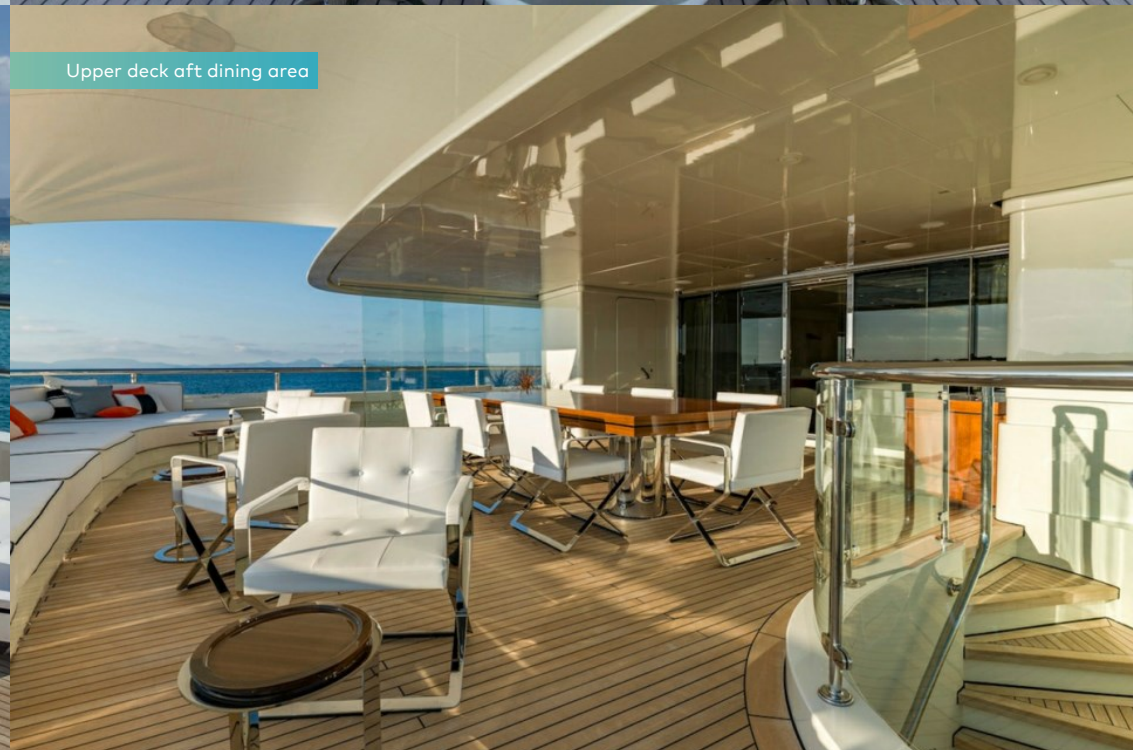

BURGESS

Discover the difference.
burgessyachts.com



ROMA

Upper deck aft dining area



Main deck aft seating area



Main deck aft seating area



Main deck lounge



ROMA

Main deck lounge



Main deck bar



Main deck dining area



Sky lounge



ROMA

Master cabin



Master cabin wardrobe



Master bathroom en suite



Double cabin



ROMA

Double cabin



Twin cabin



Foyer



PADI dive training

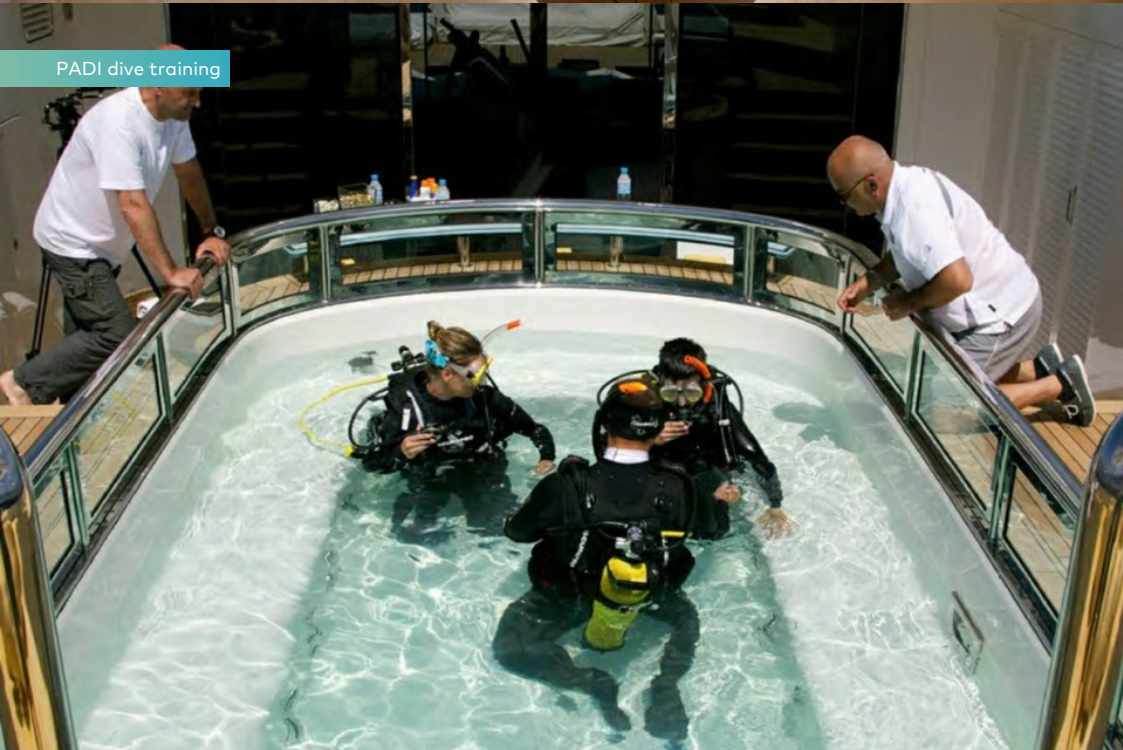

ROMA

Swim platform



Toys



Chase tender



Waverunners



BURGESS

Discover the difference.
burgessyachts.com



ROMA

Details



BURGESS

Discover the difference.
burgessyachts.com



ROMA

SPECIFICATION.



Length
62m (203.4ft)



Built
2010 (refitted 2019), Viareggio Superyachts, Italy



Interior designer
Newcruise



Beam
11m (36.1ft)



Draft
3.1m (10.2ft)



Gross tonnage
1,090



Cruising speed
14 knots



Maximum speed
17 knots



Fuel consumption at cruising speed
600 litres per hour



Engines
2 x 2,680hp Caterpillar



Guests
12



No. of guest cabins
6 (5 x double, 1 x double/twin)



Crew
18

Note

Fully licensed for charters in Spanish waters.

[View yacht on website](#)





















[Watch yacht video](#)



ROMA

EQUIPMENT.

Tenders & toys

- | | | | | |
|---|---|---|--|---|
|  1 x Towed tender |  1 x Tender |  Pool |  Waterslide |  Anti-jellyfish pool |
|  Trampoline |  RYA training centre for jetskis & waverunners |  3 x Waverunners |  1 x Stand up jetski |  3 x SeaBobs |
|  2 x Flyboards |  1 x Jetsurf |  2 x eFoil |  2 x Kayaks |  4 x Stand up paddleboards |
|  Windsurfer |  Inflatable toys |  Dive centre |  Scuba diving equipment |  Snorkelling gear |

Fitness & wellness



Boxing equipment



Cross trainer



Exercise balls



Free weights



Jump ropes



Resistance bands



Suspension trainer



Training bench



Treadmill



Upright stationary bike



Yoga instructor



Yoga mats



On board masseuse

DECK 5 / SUN DECK

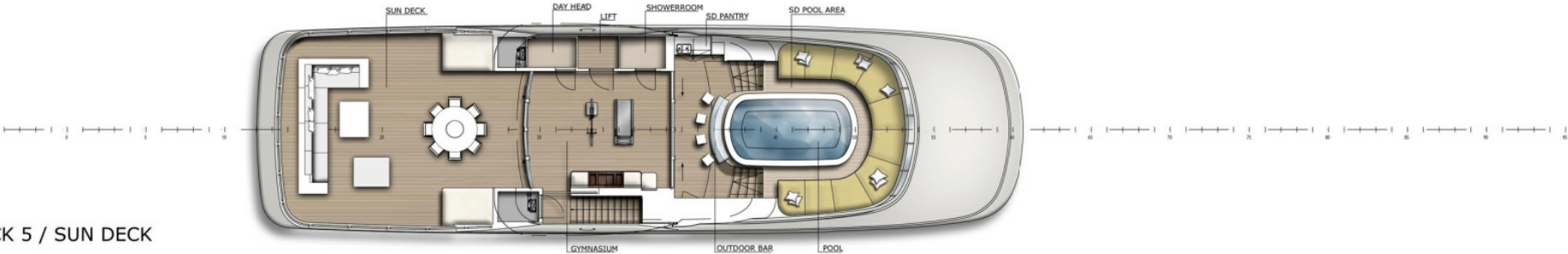



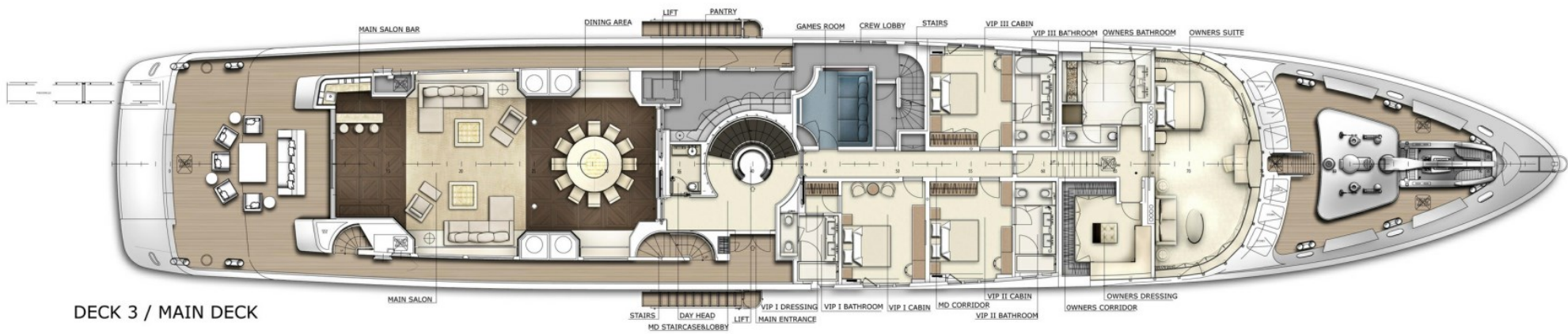

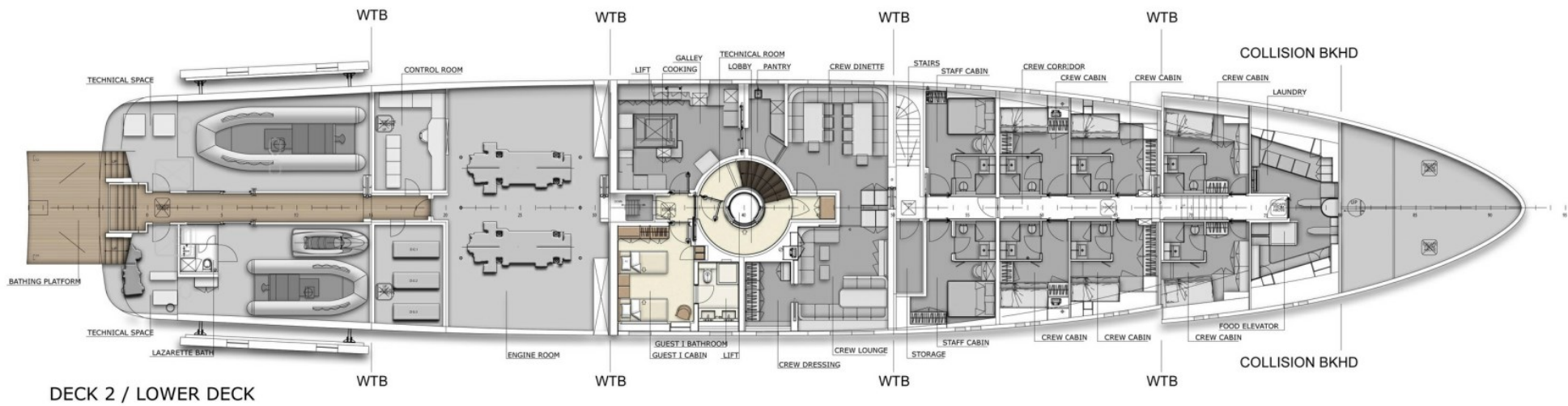

BURGESS

WORLD CLASS. WORLD WIDE.

| | | | | | | | |
|----------------------------|----------------------------|-----------------------------|-----------------------------|----------------------------|----------------------------------|---------------------------|----------------------------|
| London +44 20 7766 4300 | Monaco +377 97 97 81 21 | New York +1 212 223 0410 | Miami +1 305 672 0150 | Singapore +65 9665 8990 | Beverly Hills +1 310 424 5112 | Palma +34 971 495 413 | Athens +30 210 967 1661 |
| | Dubai +971 4 425 5874 | Phuket +66 7623 9739 | Hong Kong +852 6496 2094 | Tokyo +81 46 738 8612 | Sydney +61 499 945 557 | Mumbai +91 98211 67253 | |

Advertising of these vessel(s) in printed publications, on the internet or in any other medium is not permitted without prior written permission from Burgess. All particulars are given in good faith and are believed correct but they cannot be guaranteed.

Last updated: 26 March 2024