

PROJECT 515



PROJECT 515

SPECIFICATION.



Asking price
Price on application



Built
2026, Burger, United States Of America



Length
54.9m (180.1ft)



Beam
10m (32.8ft)



Draft
2.4m (7.9ft)



Gross tonnage
499



Cruising speed
11 knots



Maximum speed
17 knots



Range
4,000 nm



Lying
Under construction



Class
ABS



Exterior designer
Burger Boat Company/Gregory C Marshall Naval Architects



Interior designer
Burger Boat Company



Construction
Hull - Aluminium, Superstructure - Aluminium



Crew
14



Guests
14



Cabins
6 (4 x double, 2 x double/twin, 2 x additional berths)



Engines
2 x 2,366hp Caterpillar



Propulsion
Twin screw diesel yacht

[View yacht on website](#)





PROJECT 515



BURGESS

Discover the difference.
burgessyachts.com



PROJECT 515



BURGESS

Discover the difference.
burgessyachts.com



PROJECT 515



BURGESS

Discover the difference.
burgessyachts.com



OVERVIEW.

Embark on a journey of unparalleled luxury and sophistication with Burger's PROJECT 515, the second Burger 180 currently in build at Burger's shipyard in the United States. Crafted with meticulous attention to detail and designed to exceed your every expectation, this magnificent vessel promises an unforgettable yachting experience like no other.

Step aboard and discover a world of indulgence and comfort, where every detail has been carefully considered to ensure your utmost satisfaction. With six staterooms, including a lavish full-beam Owner's Stateroom and five exquisite Guest Staterooms, the yacht offers ample space for you and your guests to relax and unwind in style.

Luxury knows no bounds aboard PROJECT 515, with features such as a starboard side balcony in the Owner's Stateroom, offering breathtaking views of the surrounding seascape. The professionally designed commercial galley provides seamless service, with direct access to the sky lounge service pantry for added convenience.

Accessibility is paramount, with a handicap-accessible elevator servicing all four decks, ensuring that every guest can experience the ultimate in comfort and convenience. The flexible interior décor allows you to customize your yacht to suit your unique tastes, whether you choose your own designer or opt for an interior designed by the renowned De Basto Designs or Patrick Knowles Design.

Designed to maximize natural light and offer stunning panoramic views, the Burger 55m Motor Yacht features large windows throughout, creating an ambiance of spaciousness and tranquillity. The large windows in each crew stateroom ensure that even below deck, natural light abounds, creating a welcoming and inviting atmosphere.

Entertainment and relaxation are paramount aboard the Burger 55m Motor Yacht, with features such as the large aft deck Winter Garden, perfect for intimate dining experiences. The Infinity Deck aft, complete with a pool, provides easy access to the sea and offers expansive views of the surrounding landscape.

Key features

Flexible interior décor with options for your own designer

Built-in starboard side balcony in Owner's Stateroom

Large windows throughout provide ample sunlight

Wheelchair accessible guest elevator servicing all four decks

Massive 720 GT of usable space

Optional Naiad Dynamics Total Ride Control System for additional comfort while at sea

Last opportunity for a new build with a Tier II compliant engine room

Custom built in the USA

Tenders

1 x 7m DieselJet, 1 x Rescue Tender

NOTES:
1. ALL DIMENSIONS ARE TO FACE UNLESS OTHERWISE SPECIFIED.
2. ALL DIMENSIONS ARE TO BE TAKEN FROM THE CENTERLINE UNLESS OTHERWISE SPECIFIED.
3. ALL DIMENSIONS ARE TO BE TAKEN FROM THE EXTERIOR UNLESS OTHERWISE SPECIFIED.
4. ALL DIMENSIONS ARE TO BE TAKEN FROM THE INTERIOR UNLESS OTHERWISE SPECIFIED.
5. ALL DIMENSIONS ARE TO BE TAKEN FROM THE CENTERLINE UNLESS OTHERWISE SPECIFIED.
6. ALL DIMENSIONS ARE TO BE TAKEN FROM THE EXTERIOR UNLESS OTHERWISE SPECIFIED.
7. ALL DIMENSIONS ARE TO BE TAKEN FROM THE INTERIOR UNLESS OTHERWISE SPECIFIED.

NOTE: NOT ALL DETAILS ARE FULLY RESOLVED AND MAY CHANGE SLIGHTLY THROUGH FABRICATION DESIGN DEVELOPMENT. FINAL ARRANGEMENT MAY DIFFER IN SHAPE AND DETAILS TO ENSURE VESSEL IS LESS THAN 500GT

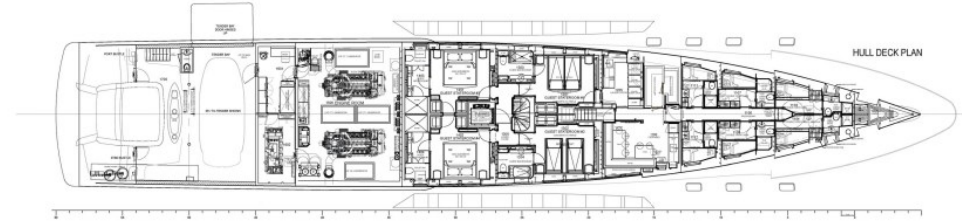
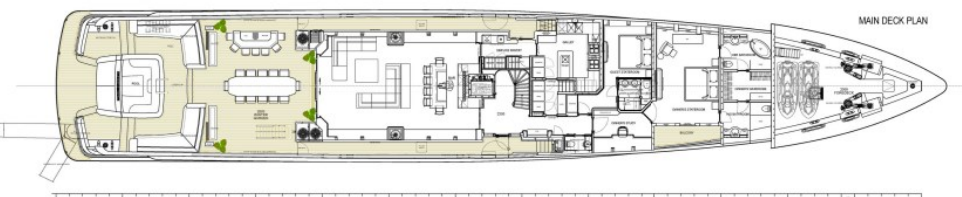
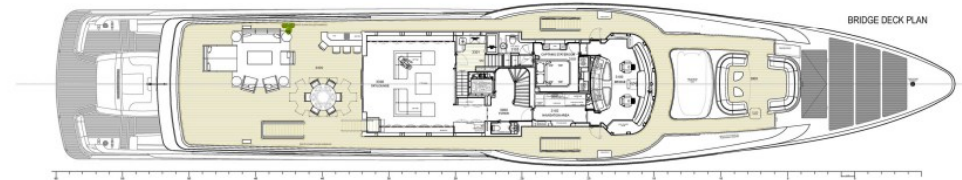
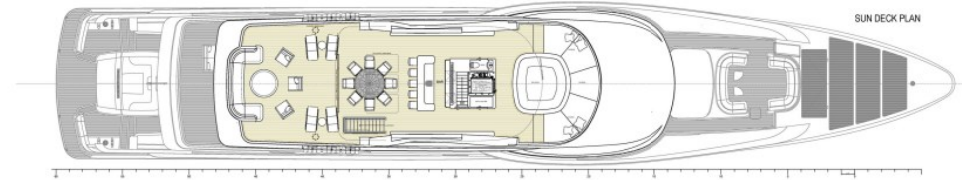
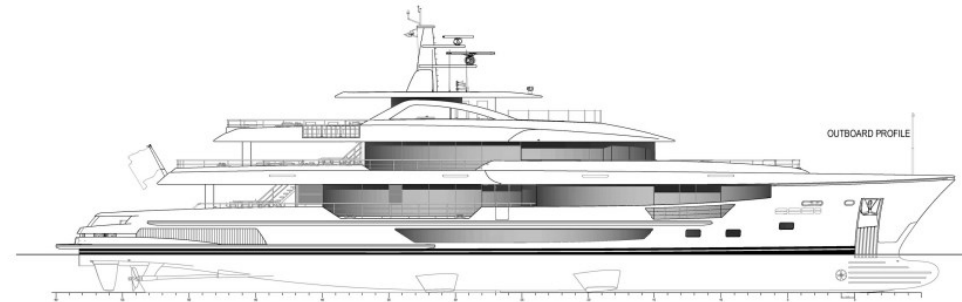

SCALE: 1/16"=1'-0"
DRAWN BY:
DATE: March 13, 2024 Rev. 0

BURGESS

WORLD CLASS. WORLD WIDE.

London +44 20 7766 4300	Monaco +377 97 97 81 21	New York +1 212 223 0410	Miami +1 305 672 0150	Singapore +65 9665 8990	Beverly Hills +1 310 424 5112	Palma +34 971 495 413	Athens +30 210 967 1661
	Dubai +971 4 425 5874	Phuket +66 7623 9739	Hong Kong +852 6496 2094	Tokyo +81 46 738 8612	Sydney +61 499 945 557	Mumbai +91 98211 67253	

Advertising of these vessel(s) in printed publications, on the internet or in any other medium is not permitted without prior written permission from Burgess. All particulars are given in good faith and are believed correct but they cannot be guaranteed.

Last updated: 18 March 2024