

OKTO



OVERVIEW.

The head turning OKTO was delivered in 2014 by the Italian shipyard ISA to an Andrea Vallicelli design, with interiors by the renowned Alberto Pinto, every inch of OKTO exhibits fine detailing and exceptional craftsmanship. With a host of unique features, OKTO also provides the perfect base for the ultimate charter experience.

Stepping on board guests will immediately be wowed by OKTO's striking grey and black decks. Made from an eco-friendly resin material by Esthec, unlike teak they allow high-heeled guests to roam freely on board. But who needs shoes when there is a 6m long infinity pool on the main deck, filled with either salt or fresh water, heated or cooled, the choice is yours. Following a refreshing dip, relax on the sumptuous sun loungers that surround the pool, and enjoy the beach club vibe. Stepping through the floor to ceiling glass doors that connect the aft deck area with the main saloon, guests are welcomed into OKTO's dazzling décor. A limited colour palette of black, white and silver, furnished with bold pieces of furniture and sculptures, combine to create a style that is contemporary and luxurious throughout.

Few places offer a better view than the sun deck, so to discover your surroundings take a dip in the raised jacuzzi with a view over the bow. Alternatively, you could work out in the air-conditioned gym with panoramic views and state of the art gym equipment. After an energetic morning, head down to the bridge deck aft and relax on the aft deck sofas, or head inside to the circular sky lounge and catch a film on the huge screen. For those looking for a more intimate space, a seating area forward of the bridge provides a private place to experience the magical solitude that being out on the ocean allows. The only disruption to your peace here might come from the helideck located forward, and it is also the perfect space for an al fresco workout or sunrise and sunset yoga sessions.

For thrill seeking charter guests, OKTO's 7.5m custom tender provides the ultimate platform for exploring the local setting, while watertoys include hoverboard, flyboard, Sea-Doos, and all sorts of toys. Speed and comfort continue back on board as you venture from anchorage to port, cruising in near silence at 16 knots. Equipped with zero speed stabilisers, on board comfort is the utmost in luxury. Rest assured all guests will sleep well in her sumptuous accommodation for 10 guests in five luxurious cabins.

Key features

Spa facilities: dedicated massage, beauty and therapy room

Private master balcony

Fully equipped gym

Elevator serving lower to upper decks

6 meter contraflow current swimming pool on the main deck aft

Jacuzzi on the sun deck

Zero speed stabilisers to reduce any rolling motion while at anchor

OKTO

Aerial view



Main deck aft pool



Sun deck jacuzzi

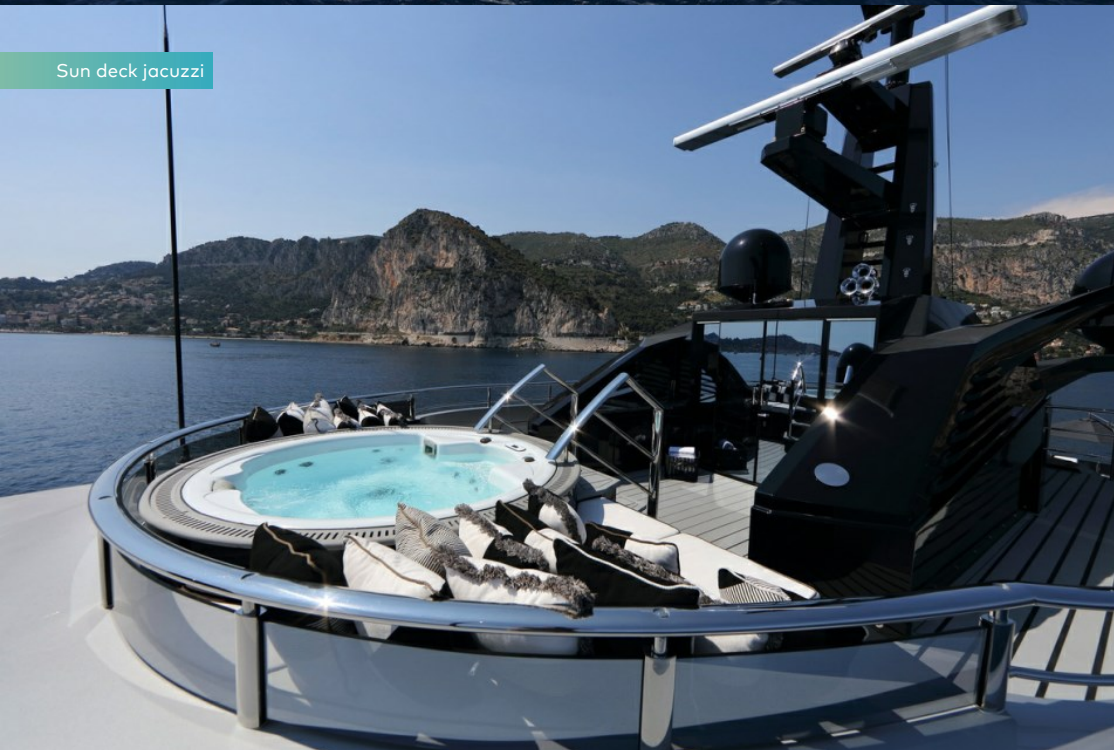

Upper deck aft



BURGESS

Discover the difference.
burgessyachts.com



OKTO

Main deck aft lounge



Main deck dining area



Main deck owner's cabin



Master bathroom en suite



OKTO

Master private balcony



Lower deck VIP cabin



Lower deck double cabin



Lower deck double cabin



BURGESS

Discover the difference.
burgessyachts.com



OKTO

Beauty room



Stern view



OKTO

SPECIFICATION.



Length
66.4m (217.8ft)



Built
2014, ISA Yachts, Italy



Interior designer
Alberto Pinto



Beam
10.5m (34.4ft)



Draft
3m (9.8ft)



Gross tonnage
1,149



Cruising speed
13 knots



Maximum speed
19 knots



Fuel consumption at cruising speed
300 litres per hour



Engines
2 x 2,366hp Caterpillar



Guests
11



No. of guest cabins
6 (5 x double, 1 x single)



Crew
16

[View yacht on website](#)

[Watch yacht video](#)



EQUIPMENT.

Tenders & toys



2 × Tenders



1 × Deck jacuzzi



Pool



Trampoline



Aquapark



Inflatable platform



RYA training centre for jetskis
& waverunners



2 × Waverunners



2 × SeaBobs



1 × Flyboard



1 × Hoverboard



1 × JetLev



2 × Jetsurfs



2 × Kayaks



2 × Stand up paddleboards



Wakeboard



Wakeskate



Kneeboard



Windsurfer



Waterskis



Inflatable tows

OKTO

GENERAL ARRANGEMENT

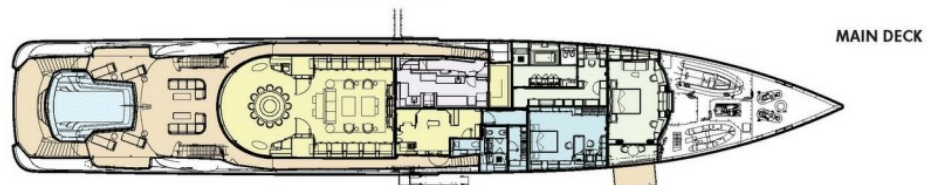
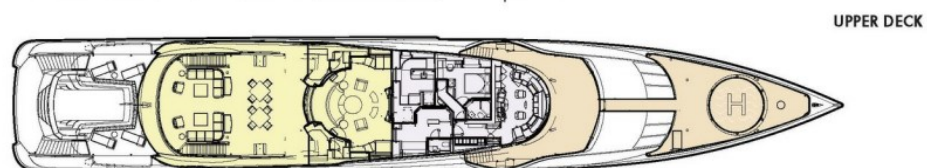
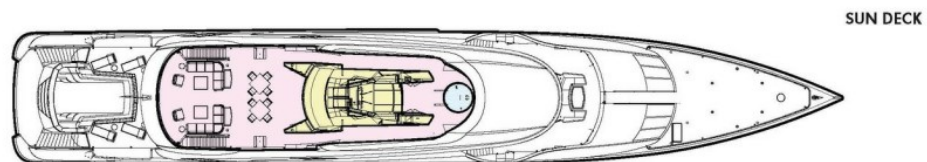

KEY

- | | |
|--------------|--------------|
| DECK | CREW AREAS |
| GUEST AREAS | GUEST CABINS |
| MASTER CABIN | SUN DECK |

BURGESS

WORLD CLASS. WORLD WIDE.

London +44 20 7766 4300	Monaco +377 97 97 81 21	New York +1 212 223 0410	Miami +1 305 672 0150	Singapore +65 9665 8990	Beverly Hills +1 310 424 5112	Palma +34 971 495 413	Athens +30 210 967 1661
Dubai +971 4 425 5874	Phuket +66 7623 9739	Hong Kong +852 6496 2094	Tokyo +81 46 738 8612	Sydney +61 499 945 557	Mumbai +91 98211 67253	Shanghai +86 187 0898 6800	

Advertising of these vessel(s) in printed publications, on the internet or in any other medium is not permitted without prior written permission from Burgess. All particulars are given in good faith and are believed correct but they cannot be guaranteed.

Last updated: 22 April 2024