



# OHANA

---

OHANA

# OVERVIEW.

**An exceptional, powerful and beautiful sailing yacht on an impressive scale, the 50m (163ft) sloop OHANA offers a winning combination of ample living space and high-level luxury with superb performance and handling under sail. She's equally ideal as a holiday platform for relaxed family cruising, as a highly competitive contender in any superyacht regatta, or as a safe and seaworthy ocean voyager for blue water adventures.**

Extensively upgraded in a major refit in 2023, OHANA is designed to host 10 guests on board in five cabins with a crew of eight at your service. She has a gorgeous contemporary interior, finished in whitewashed oak, and her sailing systems are state of the art.

One of her best features is a superb sundeck that puts you safely at the heart of the sailing action and provides an excellent open-air social space when she's anchored in a tranquil bay. Another is the snug, secure and spacious aft cockpit, which can be fully enclosed or open to let the sea air flow through its lounge and dining areas.

There's a seamless flow from the aft cockpit into the main deck lounge, which is a stunning yet soothing, wide-open living space with sweeping views of the seascape. The transparent perspex companionway steps leading up to the sundeck are a nice touch that enhances the feeling of ample space. A fine marble dining table is on one side of the lounge with a sofa further aft. There's a comfortable lounge with a projector screen cinema system and a bar on the other side. With a separate pilothouse up forward for the captain and crew, the lounge is entirely devoted to guests.

The master suite is a plush and roomy full-beam cabin with a king size bed on the centreline, a study desk on one side, a sofa on the other, and a marble en suite bathroom. The other four cabins are two VIP doubles and two twins which are almost the same size, each with its own private en suite bathroom.

She has a vast expanse of deck space for guests to spread out and enjoy when the anchor goes down, with plenty of awnings for shade. She carries two tenders, one of which is an 11m (36ft) RIB for comfortable ship-to-shore transfers and beach landings, and her inventory of toys includes windsurfers, paddleboards, a dive compressor and gear, a wide range of waterski kit and more.

## Key features

---

**Regularly maintained**

---

**Exercise equipment**

---

**11m MX-11 Coupe towed tender**

---

**Shaded deck dining area deck areas**

---

OHANA

Sailing



Swim platform



Main deck dining



Main deck lounge



BURGESS

Discover the difference.  
burgessyachts.com



# OHANA

Main deck lounge



Cinema



Master cabin



Master bathroom en suite



OHANA

Double cabin



Twin cabin



Sailing



BURGESS

Discover the difference.  
burgessyachts.com



OHANA

# SPECIFICATION.



Length  
**49.7m (163ft)**



Built  
**2012 (refitted 2025), Fitzroy Yachts, New Zealand**



Interior designer  
**TBC**



Beam  
**10m (32.8ft)**



Draft min/max  
**-/5.6m (18.4ft)**



Displacement  
**372 tonnes**



Cruising speed  
**12 knots**



Maximum speed  
**14 knots**



Fuel consumption at cruising speed  
**120 litres per hour**



Engines  
**1 x 1,450hp**



Guests  
**10**



No. of guest cabins  
**5 (3 x double, 2 x twin)**



Crew  
**8**

## Note

Fully licensed for charters in Greek waters.

[View yacht on website](#)

[Watch yacht video](#)

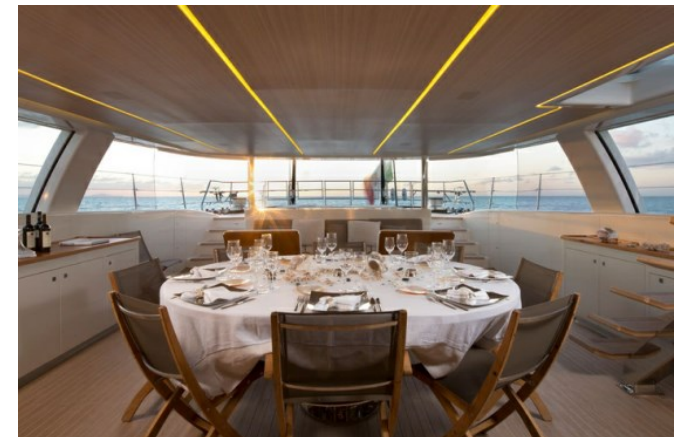

OHANA

# TENDERS & TOYS



1 × Towed tender



1 × Tender



1 × Subwing



2 × Stand up paddleboards



Windsurfer



Wakeboard



Waterskis



Scuba diving equipment



Snorkelling gear

OHANA

# FITNESS & WELLNESS



Free weights



Yoga mats





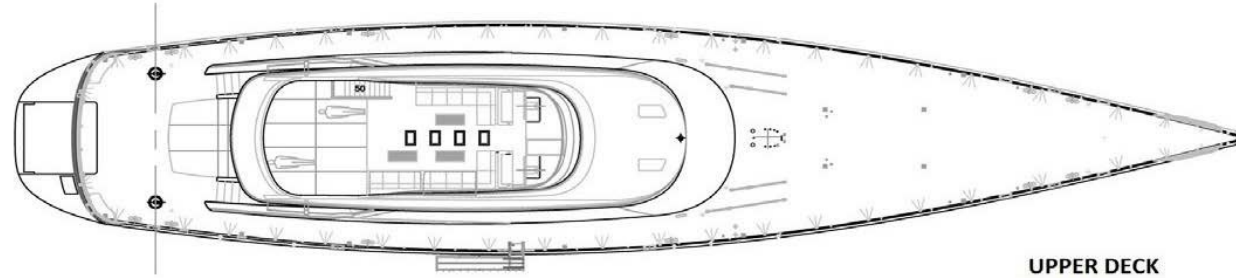

UPPER DECK

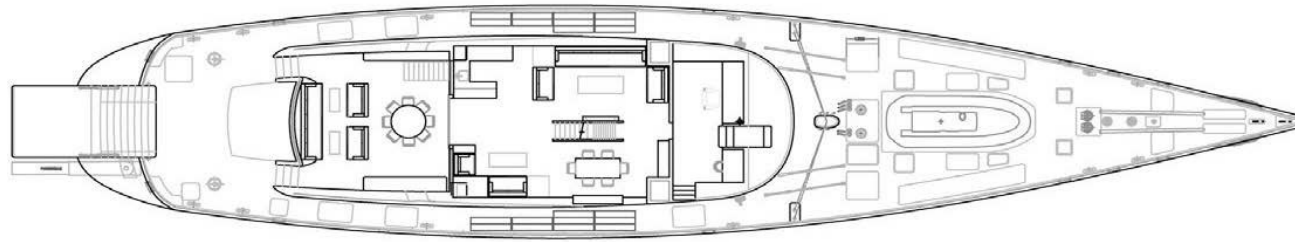

MAIN DECK

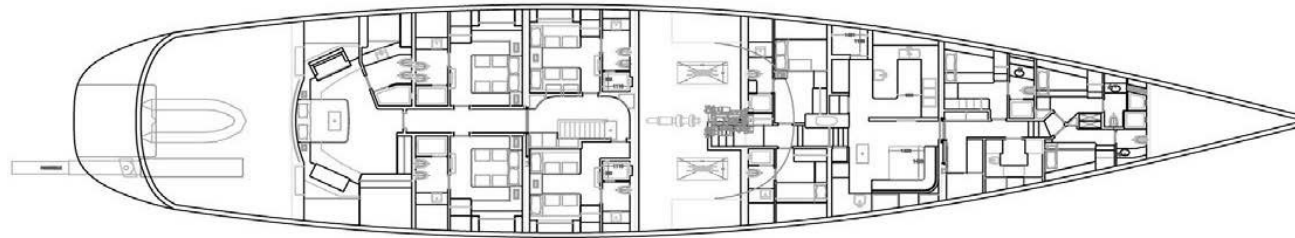

LOWER DECK

# BURGESS

# WORLD CLASS. WORLD WIDE.

<b>London</b> +44 20 7766 4300	<b>Monaco</b> +377 97 97 81 21	<b>New York</b> +1 212 223 0410	<b>Miami</b> +1 305 672 0150	<b>Singapore</b> +65 9665 8990	<b>Beverly Hills</b> +1 310 424 5112	<b>Palma</b> +34 971 495 413	<b>Athens</b> +30 210 967 1661
<b>Dubai</b> +971 4 425 5874	<b>Phuket</b> +66 7623 9739	<b>Hong Kong</b> +852 6496 2094	<b>Tokyo</b> +81 46 738 8612	<b>Sydney</b> +61 499 945 557	<b>Mumbai</b> +91 98211 67253	<b>Shanghai</b> +86 187 0898 6800	<b>Rio de Janeiro</b> +55 21 2553-3238
<b>Aspen</b> +1 970 710 2294							

Advertising of these vessel(s) in printed publications, on the internet or in any other medium is not permitted without prior written permission from Burgess. All particulars are given in good faith and are believed correct but they cannot be guaranteed.

Last updated: 13 March 2025