

OCEAN PARADISE



OVERVIEW.

OCEAN PARADISE is in equal parts cool metropolitan penthouse, fun-focused floating resort and relaxing sanctuary of calm. With her zen-like contemporary design and adaptive mood lighting complemented by huge windows to showcase the ever-changing seascape, she offers a unique, lifestyle-enhancing experience on the water.

Start your day with an intimate breakfast for two on the private balcony of the master cabin, which is richly decorated with a plush carpet, uplifting lighting and an elegant monochrome scheme. Make your way past the zen garden to join everyone enjoying a delicious breakfast in the main deck lounge, followed by coffee on the aft deck to plan your day with the captain.

Watersports are always a popular morning activity, and OCEAN PARADISE has a large array of toys to keep you entertained. Take a tender trip to a nearby reef for a snorkel or scuba safari, or stay closer to home with the jetskis, waterskiing and wakeboarding gear. There is a wide range of towable and static inflatables for all the family, then test your mettle on the large inflatable slide off the top deck. The extended beach club swim platform is a great base for your antics, as you can rinse off in the shower, lounge and enjoy refreshments between spells in the water.

A busy morning makes for a big lunchtime appetite, so head up to the sun deck for a relaxed lunch of grilled lobster, fish and meats freshly prepared by the chef on the BBQ. With the air of an exclusive rooftop members' club, you can while away a few hours on the sun deck with its waterfall jacuzzi, panoramic views and choice of vibrant lounging settings. Alternatively, catch a movie in the futuristic sky lounge with sumptuous velvet seating while the yacht moves to a new anchorage for the evening.

Before dinner, change in the well appointed guest accommodation for 12 in six cabins. As well as the full beam master suite, there is a VIP suite on the upper deck, and the lower deck features four cabins including two doubles, and two convertible twin cabins with additional pullman berths. Zero speed stabilisers promise ultimate comfort at anchor, both day and night.

Creative cocktails are expertly mixed at the upper deck aft bar before an Asian fusion banquet. Then head to your own private nightclub in the sky lounge, with its illuminated bar, atmospheric lighting and DJ booth. OCEAN PARADISE offers a blissful experience, whatever you are looking for.

Key features

Beach club at sea level

Private master balcony

Exercise equipment

Masseuse part of the crew

Flexible cabin configurations

Jacuzzi on the sun deck

Zero speed stabilisers to reduce any rolling motion while at anchor

OCEAN PARADISE

Aerial view



Sun deck forward jacuzzi



Sun deck aft seating area



Upper deck aft dining



OCEAN PARADISE

Main deck aft seating area



Main deck aft seating area



Lower deck aft beach club



Main deck lounge



OCEAN PARADISE

Main deck lounge



Main deck lounge



Main deck dining area



Sky lounge



OCEAN PARADISE

SPECIFICATION.



Length
55m (180.4ft)



Built
2013, Benetti, Italy



Interior designer
Mauro Izzo



Beam
9.2m (30.2ft)



Draft
3.5m (11.5ft)



Gross tonnage
710



Cruising speed
14.5 knots



Maximum speed
17 knots



Fuel consumption at cruising speed
460 litres per hour



Engines
2 x 2,365hp Caterpillar



Guests
12



No. of guest cabins
6 (4 x double, 2 x double/twin, 2 x additional berths)



Crew
12

[View yacht on website](#)



EQUIPMENT.

Tenders & toys



1 x Tender



1 x Deck jacuzzi



Waterslide



Trampoline



Aquapark



RYA training centre for jetskis & waverunners



2 x Waverunners



3 x SeaBobs



2 x Kayaks



6 x Stand up paddleboards



Wakeboard



Kneeboard



Waterskis



Inflatable toys



Scuba diving equipment



Fishing gear



Snorkelling gear

OCEAN PARADISE

Profile & sun deck

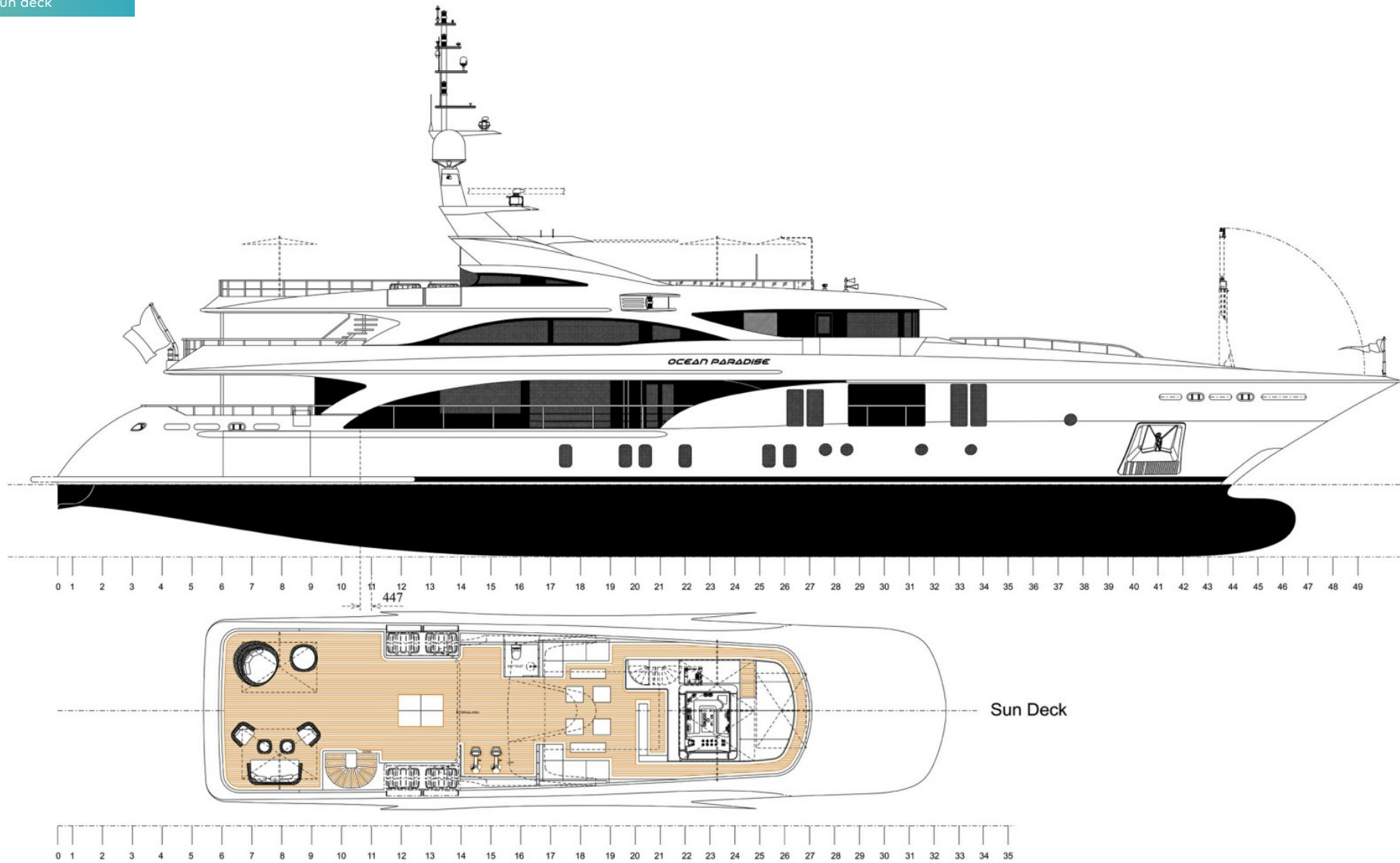

OCEAN PARADISE

Upper & main deck



Upper Deck

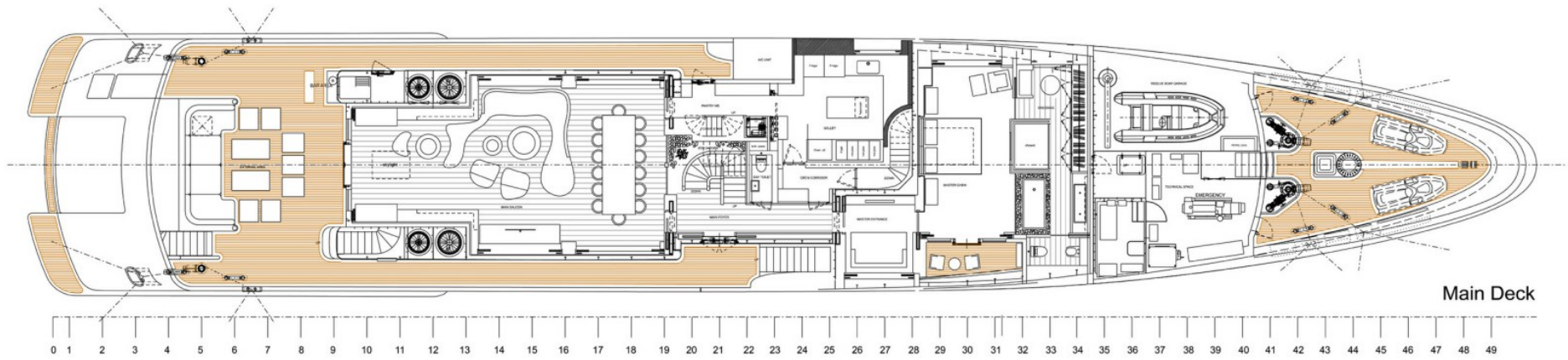

Main Deck

OCEAN PARADISE

Lower & tank deck

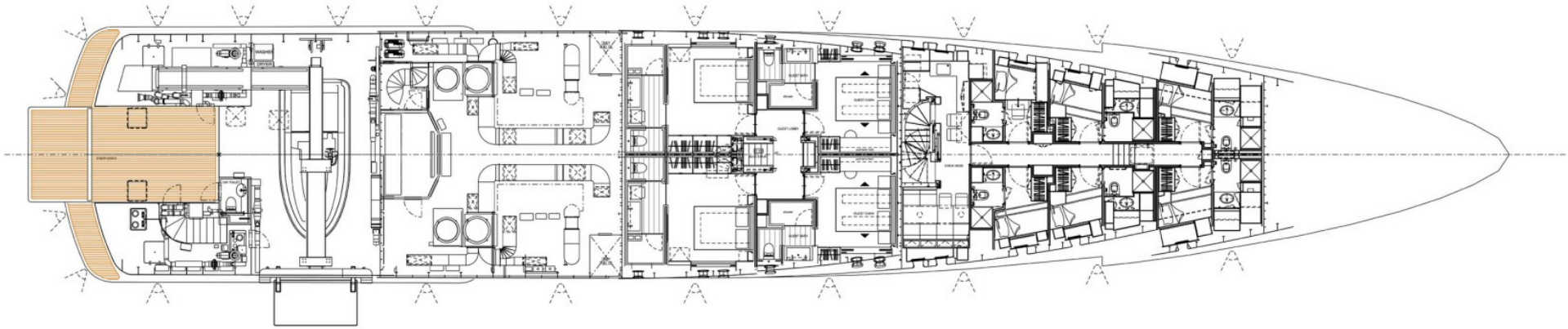

Lower Deck

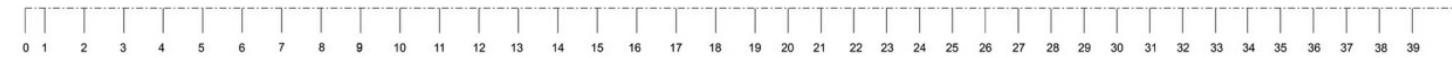
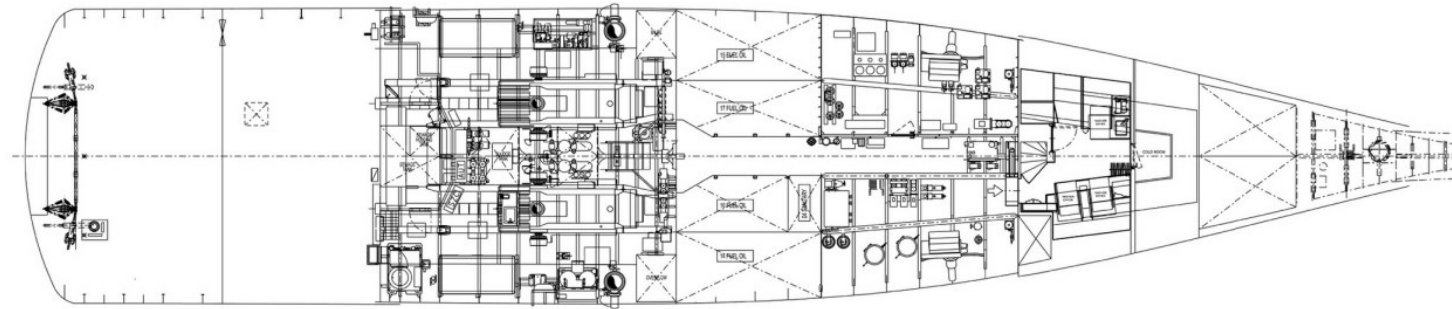
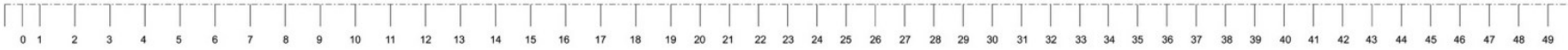

BURGESS

WORLD CLASS.
WORLD WIDE.

London +44 20 7766 4300	Monaco +377 97 97 81 21	New York +1 212 223 0410	Miami +1 305 672 0150	Singapore +65 9665 8990	Beverly Hills +1 310 424 5112	Palma +34 971 495 413	Athens +30 210 967 1661
	Dubai +971 4 425 5874	Phuket +66 7623 9739	Hong Kong +852 6496 2094	Tokyo +81 46 738 8612	Sydney +61 499 945 557	Mumbai +91 98211 67253	

Advertising of these vessel(s) in printed publications, on the internet or in any other medium is not permitted without prior written permission from Burgess. All particulars are given in good faith and are believed correct but they cannot be guaranteed.

Last updated: 01 March 2024