

# O'MATHILDE

---



O'MATHILDE

# OVERVIEW.

O'MATHILDE offers chic charter living with an added dose of fun. Built in 2018, she is impeccably presented with superb modern design, a huge choice of watertoys and a great charter reputation.

The perfect way to start a day on board O'MATHILDE is with a reviving workout in her fully equipped outdoor gym with spectacular sea views. Make your way to breakfast on the upper deck aft, where everyone is already busy planning their day's activities and adventures while enjoying the delicacies freshly prepared by the chef.

It is impossible to resist the allure of the water when you have such an extensive watertoy inventory at your disposal. Test your balance on the fast and fun jetsurfs, find your inner speed demon on the jetski, or give your snorkelling a boost with one of the underwater sea scooters. There is a wide range of toys to keep the whole family entertained. If water isn't your thing, take a trip ashore to tour the local coastline on one of the yacht's bikes; the handy e-bike option makes light work of steeper inclines.

Everyone comes together for a delicious lunch of freshly prepared local produce on the sun deck. After the morning's exertions, why not recline on the nearby sun pads located next to the inviting jacuzzi, while the yacht's attentive crew provide a steady stream of refreshments from the sun deck bar.

The captain lifts the anchors to take you to a new destination for the evening, so kick back and relax with a movie on the state of the art projector system from the comfort of the main deck aft sofa while underway. You arrive in the bay of a vibrant port town as a high tea with champagne is served, and the captain selects a prime anchorage for breath-taking evening views.

Retire to your 70sqm owner's suite on the upper deck to change for the evening. The luxurious suite features a beautiful marble bathroom, large walk in wardrobe, private lounge and office. The remainder of the guest accommodation is very well appointed, including a VIP suite, three doubles and two twin cabins, while zero speed stabilisers assure comfort on board. The yacht's Studio Vafiadis design features cream walls and furnishings complemented by dark wood and bright pops of colour from contemporary art.

Romantic cocktails and canapes are served on the spectacular bridge deck, followed by a light dinner on the upper deck aft before you head into town by tender to sample the fun local nightlife.

## Key features

---

A crew with local expertise

---

A fully equipped gym

---

Outdoor cinema

---

Jacuzzi on the sun deck

---

Zero speed stabilisers to reduce any rolling motion while at anchor

---

O'MATHILDE

Aerial view



Sun deck forward jacuzzi



Sun deck dining area



Upper deck aft dining area



BURGESS

Discover the difference.  
burgessyachts.com



O'MATHILDE

Main deck aft



Main deck lounge



Main deck lounge



Main deck dining area



O'MATHILDE

Upper deck master cabin



Upper deck master bathroom en suite



Main deck VIP cabin



Main deck starboard twin cabin with pullman



O'MATHILDE

Lower deck starboard double cabin



Lower deck starboard double cabin



Lower deck port twin cabin



Cruising



O'MATHILDE

# SPECIFICATION.



Length  
56m (183.7ft)



Built  
2018 (refitted 2023), Golden Yachts, Greece



Interior designer  
Studio Vafiadis



Beam  
9.2m (30.2ft)



Draft  
2.8m (9.2ft)



Gross tonnage  
706



Cruising speed  
15 knots



Maximum speed  
17 knots



Fuel consumption at cruising speed  
750 litres per hour



Engines  
2 x 2,365hp Caterpillar



Guests  
12



No. of guest cabins  
7 (5 x double, 2 x twin, 2 x additional berths)



Crew  
12

## Note

Fully licensed for charters in Greek waters.

[View yacht on website](#)

[Watch yacht video](#)



# EQUIPMENT.

## Tenders & toys

---



3 x Tenders



1 x Deck jacuzzi



Aquapark



2 x Waverunners



2 x SeaBobs



2 x Jetsurfs



2 x eFoils



3 x Kayaks



2 x Stand up paddleboards



Wakeboard



Wakesurf



Waterskis



Inflatable tows



Snorkelling gear



# Fitness & wellness

---



Exercise balls



Free weights



Multi gym



Resistance bands



Rowing machine



Training bench



Treadmill



Upright stationary bike



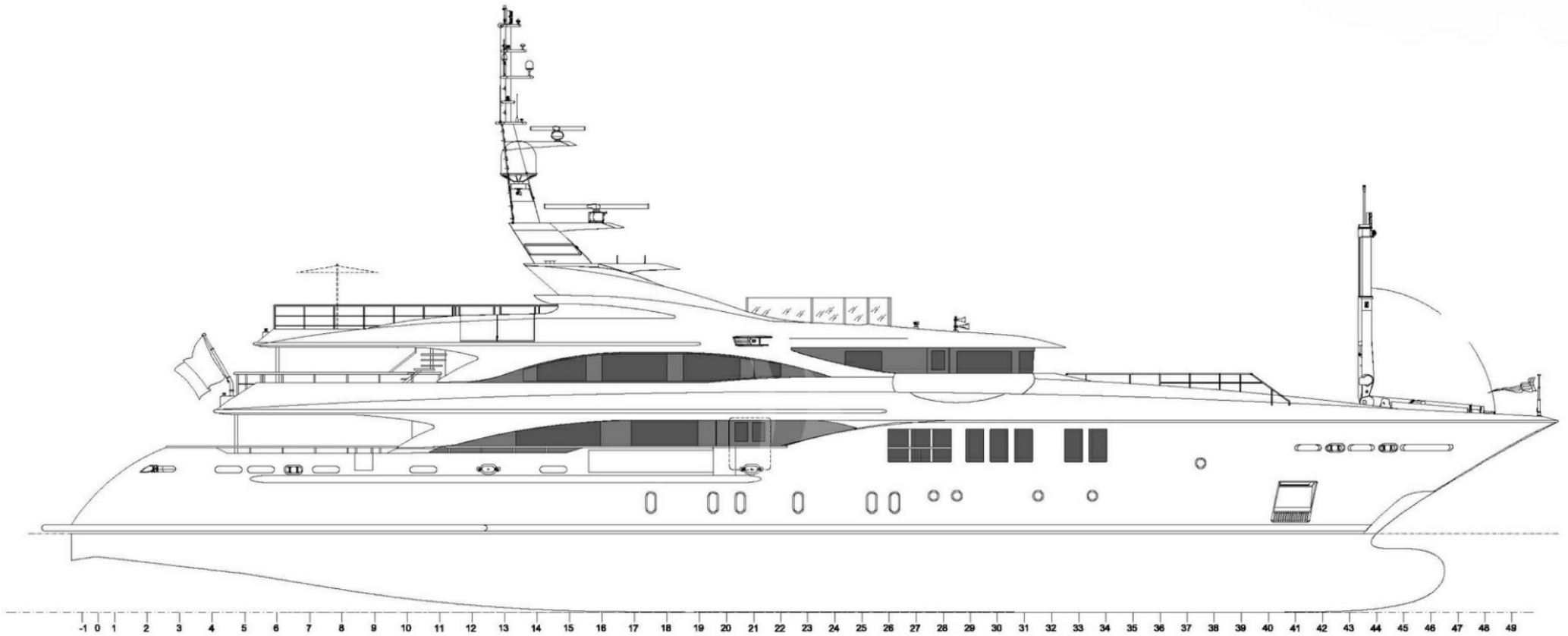

**PROFILE**  
**DRAWN BY YS&T FOR AZIMUT BENETTI SPA**

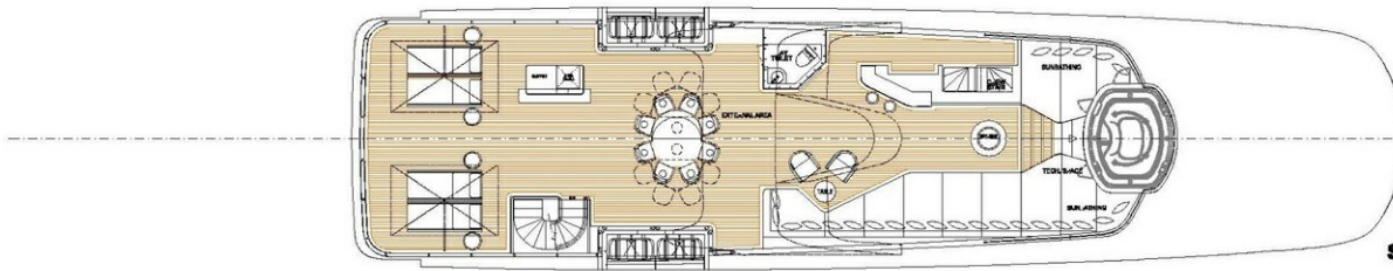

**SUN DECK**



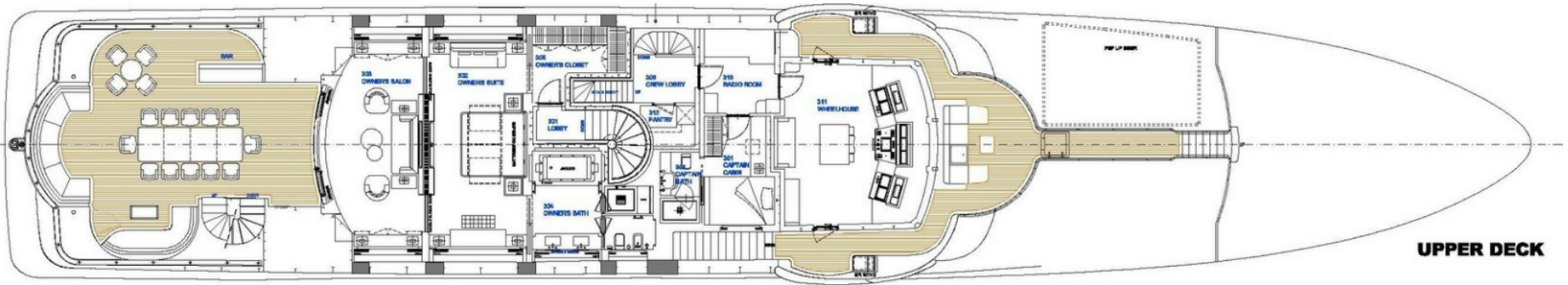

UPPER DECK

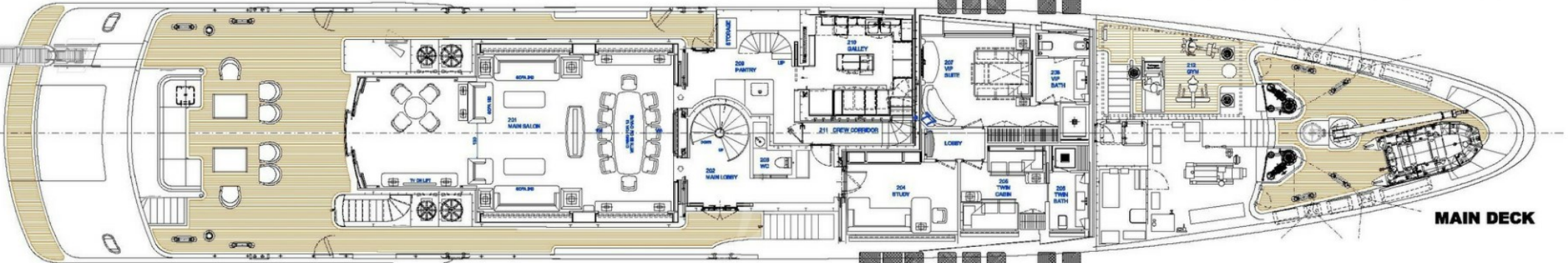

MAIN DECK

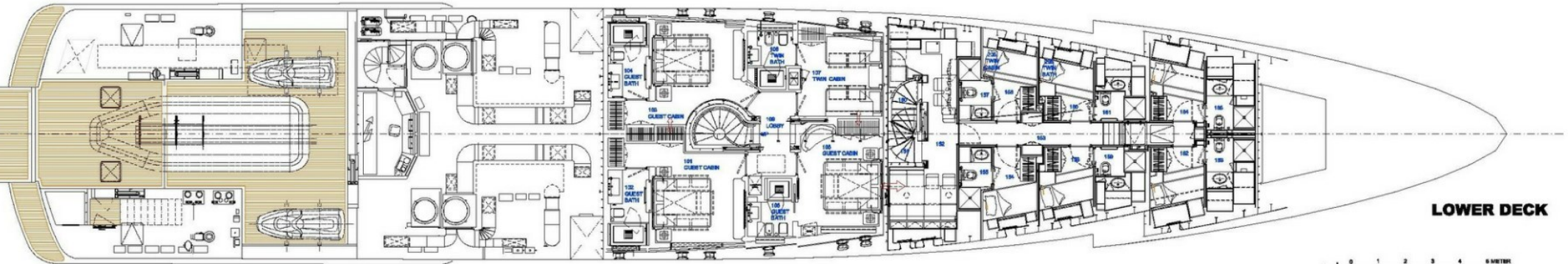
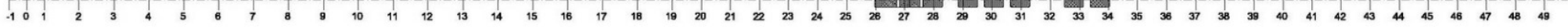

LOWER DECK

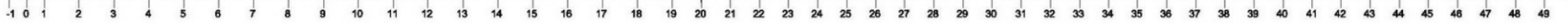

# BURGESS

# WORLD CLASS. WORLD WIDE.

London +44 20 7766 4300	Monaco +377 97 97 81 21	New York +1 212 223 0410	Miami +1 305 672 0150	Singapore +65 9665 8990	Beverly Hills +1 310 424 5112	Palma +34 971 495 413	Athens +30 210 967 1661
	Dubai +971 4 425 5874	Phuket +66 7623 9739	Hong Kong +852 6496 2094	Tokyo +81 46 738 8612	Sydney +61 499 945 557	Mumbai +91 98211 67253	

Advertising of these vessel(s) in printed publications, on the internet or in any other medium is not permitted without prior written permission from Burgess. All particulars are given in good faith and are believed correct but they cannot be guaranteed.

Last updated: 18 March 2024