

NORTHERN SUN



OVERVIEW.

Those with an adventurous streak, look no further: NORTHERN SUN is a luxurious charter yacht with world-class expedition credentials. With an extraordinary 12,000nm cruising range complemented by ample creature comforts and an impressive inventory of watersports toys, the only limit to a charter on board is your imagination.

Wake to the sight of a stunning new anchorage, where a day of exciting adventure awaits. After a hearty breakfast served on the main deck aft, you are ready for the morning's activities. Thanks to NORTHERN SUN's vast array of watertoys, you are spoiled for choice in how to explore local attractions that are rarely seen by visitors. Kayak through labyrinthine limestone caves, don your scuba gear for an underwater safari, or snorkel along coastal reefs teeming with sea life, aided by the SeaBob sea scooters.

The deck crew takes you by fast tender to a secluded cove, then guides you on a hike into the forest, which ends at a remote settlement where local villagers provide a cultural performance and blessing ceremony, followed by a BBQ beach lunch set up by the crew.

Head back to the yacht for the afternoon, where you can choose between a few hours of blissful relaxation on the sun deck with its jacuzzi and sun pads, some friendly competition on the yacht's two Laser dinghies or quiet time in one of the three on board lounges. NORTHERN SUN's spacious interior design transports you to an explorer's private hideaway with antique rugs from distant lands, original artwork, exotic artefacts and curios.

As evening draws in, it is time to change for dinner. The master suite is elegantly decorated with silk, makore and nara wood offsetting the calming cream palette. As well as having a private library and office, its bathroom features a full-size jacuzzi. Five further suites complete the accommodation for 12 guests, including two double cabins (one has a pullman) and three twin cabins.

With the sun dipping past the horizon, delicious cocktails and canapes are served on the forward lounging area, which also provides the perfect spot for a romantic dinner. A spectacular setting has been created in the formal dining area, especially attractive in colder climes. You finish up your action-packed day with a few rounds of cards at the games table, or head up to the sun deck to take in the stars, with cosy blankets and a cup of cocoa or digestif. This is authentic adventuring in comfort and style.

Key features

Exercise equipment

Jacuzzi on the sun deck

Zero speed stabilisers to reduce any rolling motion while at anchor

NORTHERN SUN

Aerial view



Stern view



Sun deck forward jacuzzi



Main deck aft seating area



BURGESS

Discover the difference.
burgessyachts.com



NORTHERN SUN

Main deck aft lounge



Main deck midship lounge



Main deck forward games room and piano



Fore deck dining area



NORTHERN SUN

Lower deck port dining room



Dining set-up



Lower deck starboard library



BURGESS

Discover the difference.
burgessyachts.com



NORTHERN SUN

SPECIFICATION.



Length
50.9m (167ft)



Built
1976 (rebuilt 2007, refitted 2022), Narasaki Shipyard, Japan



Interior designer
HYS Yachts



Beam
9m (29.5ft)



Draft
5m (16.4ft)



Gross tonnage
703



Cruising speed
10 knots



Maximum speed
12 knots



Fuel consumption at cruising speed
220 litres per hour



Engines
2 x 900hp Yanmar



Guests
12



No. of guest cabins
6 (4 x double, 2 x twin)



Crew
12

[View yacht on website](#)

[Watch yacht video](#)



NORTHERN SUN

EQUIPMENT.

Tenders & toys

- | | | | | |
|--|--|---|--|---|
|  2 × Tenders |  2 × Sailing dinghies |  1 × Deck jacuzzi |  Waterslide |  2 × Underwater scooters |
|  1 × Jetsurf |  10 × Kayaks |  4 × Stand up paddleboards |  Wakeboard |  Wakesurf |
|  Waterskis |  Inflatable tows |  Scuba diving equipment |  Snorkelling gear | |

This block contains three line drawings of the ship: a bow view on the left, a starboard profile view in the center, and a stern view on the right. The bow view shows a complex superstructure with multiple masts and radar domes. The starboard profile shows the ship's hull, deck, and the main mast structure. The stern view shows the aft part of the ship, including the stern mast and various equipment.

PROFILE VIEW

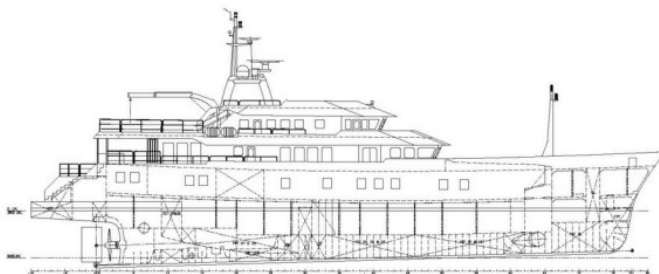

PROFILE VIEW

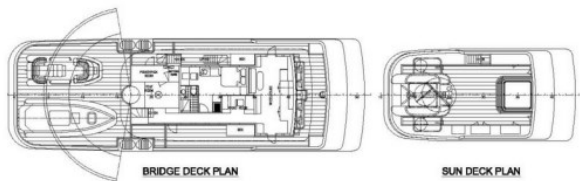

BRIDGE DECK PLAN

SUN DECK PLAN

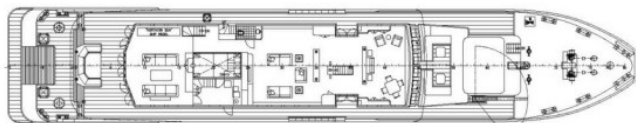

MAIN DECK PLAN

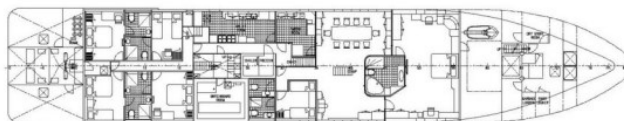

←
GUEST DECK PLAN

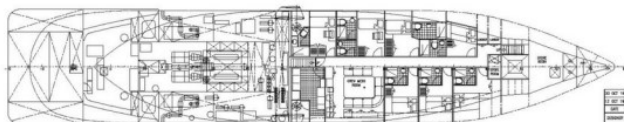

CREW DECK PLAN

VESSEL DATA SHEET:	
LENGTH OVERALL	: 32.90 mtrs
CHARGE LENGTH	: 45.72 mtrs
MAX BREADTH	: 6.00 mtrs
DEPTH OF KEEL (FROM BULK DECK)	: 8.75 mtrs
TOW BUILT	: 1978
HULL NO.	: 5 - 885
SPEED	: MAX - 12kts / 001.045

BRUSH / NET TONNAGE (TWA, CAPACITY) BRUSH WIDTH MAIN ENGINE	1 752 / 211 1 5.0 = 40.000 (LITERS, FUEL OIL = 150.000 (LITERS) 1 7.000 HOURS (APPROX) 1 CUMMINS 60-67 (300HP) C430 / SER. NO. 505 0228 & FUEL OIL, SERVO = CONTROLLABLE PITCH PROPELLER - KAWASU, TYPE CPC-40 / SER. NO. 2288	PORT OF REGISTRY TYPE OF VESSEL CONSTRUCTION BUILDER IMO NO.
--	---	--

- 1. INOTONDA, COOK IL.
- 2. PRIVATE YACHT
- 3. STEEL, RAIL AND SUPERSTRUCTURE TO BRIDGE 3 ALUMINUM FUNNEL, WHEELS AND SUN DECK
- 4. NAWANG STEELBUILDING CO. LTD. MUKOH, HOKKAIDO, JAPAN
- 5. TONIN 7

THIS DOCUMENT AND THE INFORMATION IT CONTAINS IS COPYRIGHT AND REMAINS THE PROPERTY OF L. I. CHAN PTE LTD.
IT IS NOT TO BE COPIED IN WHOLE OR IN PART OR DISCLOSED TO ANY THIRD PARTY WITHOUT WRITTEN PERMISSION FROM L. I. CHAN PTE LTD.

NO. OF UNPAID BILLS	NO.
NO. OF BILLS ON HAND	NO.
DATE	NO.

LY CHAN PTE. LTD.
 25 LARRY ROAD, SINGAPORE 400670
 TEL : (65) 8778 6888 - Fax : (65) 8848 3388

PROJECT :	YACHT "NORTHERN SUN"
TITLE :	GENERAL ARRANGEMENT

BANK OF AMERICA			FILL NO. 3 - 001	
CASH			CASH NO. -	
DATE	DEBIT	12 OCT 2018	5 : 148	0475-01001
CHECKED	01	12 OCT 2018	PAID BY	

THIS DOCUMENT AND THE INFORMATION IT CONTAINS IS COPYRIGHT AND REMAINS THE PROPERTY OF L. Y. CHAN PTE LTD.
IT IS NOT TO BE COPIED IN WHOLE OR IN PART OR DISCLOSED TO ANY THIRD PARTY, FOR ANY PURPOSES WITHOUT WRITTEN PERMISSION OF L. Y. CHAN PTE LTD.

BURGESS

WORLD CLASS. WORLD WIDE.

London +44 20 7766 4300	Monaco +377 97 97 81 21	New York +1 212 223 0410	Miami +1 305 672 0150	Singapore +65 9665 8990	Beverly Hills +1 310 424 5112	Palma +34 971 495 413	Athens +30 210 967 1661
	Dubai +971 4 425 5874	Phuket +66 7623 9739	Hong Kong +852 6496 2094	Tokyo +81 46 738 8612	Sydney +61 499 945 557	Mumbai +91 98211 67253	

Advertising of these vessel(s) in printed publications, on the internet or in any other medium is not permitted without prior written permission from Burgess. All particulars are given in good faith and are believed correct but they cannot be guaranteed.

Last updated: 01 March 2024