

# NERO

---





NERO

# APERÇU.

**The most head-turning yacht on the planet is ready to welcome you on board. 'Quiet luxury' is the name of the game, and guests will be transported to a glamorous bygone era but with all the mod-cons of the 21st century.**

NERO is an all-modern superyacht with classically-inspired lines. Designed in the 'spirit of Corsair', an iconic yacht launched in the 1930s that belonged to American financier JP Morgan, she truly embodies the glamour of yachting's golden age. This sophistication is evident throughout NERO, from her clipper bow to her iconic yellow funnel.

The head-turning queen of any anchorage, NERO is in immaculate condition. A 2021 refit included a full repaint and deck refresh, which has been meticulously maintained ever since. Inside, the contemporary yet classically elegant interiors come courtesy of Laura Pomponi who has masterfully kept the balance between a light aesthetic and NERO's 1930s soul. Expect beautiful handmade carpets paired with tasteful soft furnishings in nautical hues, as well as a scattering of artworks that showcase both tall ships and steamships.

Accommodating up to 12 guests across six luxurious cabins, NERO is perfect for family or groups of friends for all occasions. A mix of extremely spacious double and twin cabins, all with en suites, ensures that every guest is well catered for.

Keep fit on board in NERO's state-of-the-art gym on the sun deck, complete with top-of-the-range Technogym kit including a Kinesis, treadmill, cross trainer and a cardio bike. You will also find loose weights and everything needed for yoga and Pilates, including a qualified physical trainer as part of the crew.

For all your pampering needs, there is a beauty salon on the upper deck for manicures, pedicures, hair treatments and massages. After your treatment by the crew's very own beautician and masseuse, freshen up in the en suite bathroom and shower and emerge energised and ready to take on the world. She also has a second massage room if you need a change of scene.

For families, the top-of-the-range Icon AV/IT system enables streaming for all devices and a genuinely theatrical experience in the observation lounge cinema. Paired with homemade pizza straight out of the pizza oven and you've got yourself a perfect movie night.

Your NERO experience begins before you even reach the yacht, with an exquisite 9.5m Corsair custom-built tender transporting you in impeccable style. And when you're on board, a packed toy garage filled with everything from an inflatable waterslide to SeaBobs ensures you have an action-packed charter.

If you feel like being the centre of attention while working on your fitness, pampering yourself, dining exquisitely, swimming in the pool and having a whale of a time on the water, you need look no further than NERO.

## Principales caractéristiques

---

**Spectacular owner's duplex suite with separate lounge, study and his and hers bathrooms**

---

**Dedicated spa with on board masseuse and beautician**

---

**Dedicated sun deck gym with state of the art equipment and fitness instructor**

---

**5.7m resistance pool on the foredeck and large jacuzzi on the sun deck**

---

**High-profile, extensive refit, revitalising her classic charm**

---

**Bespoke Icon Connect integrated audio-visual platform for maximum accessibility**

---



NERO

Tender



Sun deck



Main deck lounge



Main deck dining room





NERO

Main deck library



Master cabin



Master office



Master bathroom en suite





NERO

VIP cabin



Guest bathroom



Double cabin



Twin cabin





**NERO**

Sky lounge



Sky lounge bar



Observation lounge



Additional seventh cabin





NERO

Additional seventh cabin



Spa facilities



Upper deck aft dining area



Upper deck aft dining area





# NERO

Upper deck aft seating area



Sun deck dining



Sun deck jacuzzi



Sun deck gym





NERO

Sun pad



Sun deck



FunAir slide



Tender



BURGESS

Discover the difference.  
burgessyachts.com





NERO

Tender



At anchor



Aerial view jetskis



BURGESS

Discover the difference.  
burgessyachts.com





NERO

# SPECIFICATIONS.



Longueur  
**90,1m**



Chantier  
**2007 (refitted 2021), Corsair Yachts, China**



Designer d'intérieur  
**Laura Pomponi**



Largeur  
**12m**



Tirant d'eau  
**4,9m**



Tonnage brut  
**1 413**



Vitesse de croisière  
**11,5 knots**



Vitesse maximale  
**14 knots**



Consommation de carburant en vitesse de croisière  
**432 litres par heure**



Moteurs  
**2 x 2 333hp Caterpillar**



Invités  
**12**



Nb de cabines invités  
**6 (4 x double, 2 x double/twin)**



Équipage  
**20**

## Note

Not available for charter to US residents while in US waters.

[Voir le yacht sur le site](#)

















[Regarder la vidéo du yacht](#)





# NERO

## ANNEXES & JEUX NAUTIQUES

- |   |   |  |   |   |
|---|---|--|---|---|
|  3 × Tenders  |  1 × Deck jacuzzi                              |  Pool       |  4 × Waverunners           |  1 × Stand up jetski |
|  5 × SeaBobs  |  1 × Flyboard                                  |  2 × Kayaks |  2 × Stand up paddleboards |  Wakeboard           |
|  Waterskis    |  Inflatable platform                           |  Waterslide |  Inflatable tows           |  Snorkelling gear    |
|  Fishing gear |  RYA training centre for jetskis & waverunners |  |   |   |

9.5m custom Corsair tender | 7.4m Zeta Elle tender | 5.2m custom Nautica Rib | 4 x Sea-Doos (2 x Spark, 2 x RXP) | 1 x Yamaha Superjet 700 (stand up jetski) | 4 x SeaBobs | Flyboard | 8m inflatable slide | 2 x Paddleboards | 2 x inflatable kayaks | 2 x inflatable dock platforms | 1 x inflatable cabana | Fishing gear | Snorkelling gear | Waterskis | Wakeboards and tows



NERO

# REMISE EN FORME & BIEN-ETRE



Balance trainer



Cross trainer



Exercise balls



Free weights



Jump ropes



Kinesis machine



Personal trainer



Resistance bands



Training bench



Treadmill



Upright stationary bike



Yoga mats



Beauty salon



Hair salon



Massage room



On board masseuse

1 x Technogym Kinesis | 1 x Octane Fitness XT3700 Cross-trainer | 1 x TechnoGym Bench | 1 x TechnoGym MyRun, Treadmill | 1 x TechnoGym Bike | 1 x Barbell and disk weights | 1 x Balance Dome | 6 x Fitness Mats | 4 x Foam Roller | 4 x Align Pilates, Pro Pilates Ring 12' | 4 x Align Pilates, Pro Soft 1kg Weights (pair) | 6 x Yoga Mad, 369 Yoga Block | 6 x Yoga Mad 2.5m Yoga Strap | 1 x Wellness ball 65cm | 1 x Wellness ball 55cm | 2 x Jump Rope | Set of Power Bands | Hexagon Dumbbells | Kettlebells 4-16kg | Slamballs 5-10kg Beauty Room fwd. of Sky lounge (old gym) with specialised Nilo Chair for manicures, pedicures, hair treatments which also articulates into a massage table with en suite bathroom and shower



NERO

# COMMUNICATION ET DIVERTISSEMENT



Satcom & cellular communications facilities



Wi-Fi internet access



Starlink



Indoor cinema



Speaker systems



Streaming services



Video games

State-of-the-art audio-visual systems | Large screens in nearly all cabins | Apple TV | Apple Airplay | Interior cinema featuring projector screen | All areas have either 5.1, 7.1 or 9.1 surround sound | High speed WiFi and hard cable internet connection | Crestron Steward/ess calling system | Playstation 5 | Kaleidescape | Starlink | Satcom & cellular communications facilities | Fleet Broadband | VSAT | Wi-Fi internet access





# NERO

Sun deck





# NERO

Upper deck

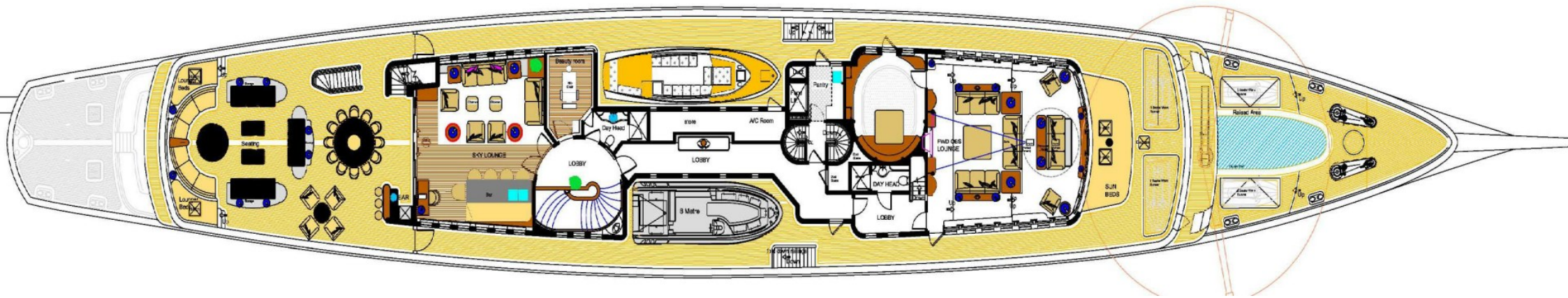



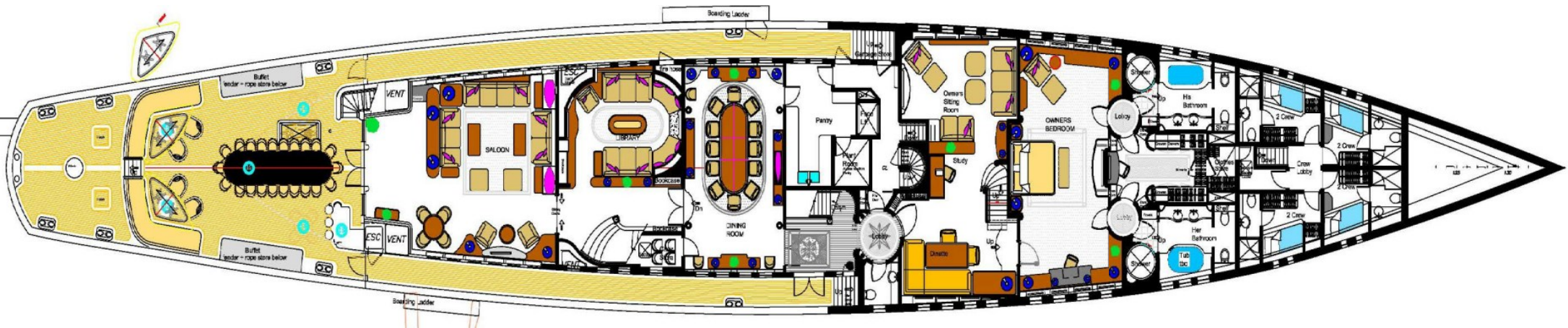







# BURGESS

# WORLD CLASS. WORLD WIDE.

<b>London</b> +44 20 7766 4300	<b>Monaco</b> +377 97 97 81 21	<b>New York</b> +1 212 223 0410	<b>Miami</b> +1 305 672 0150	<b>Singapore</b> +65 9665 8990	<b>Beverly Hills</b> +1 310 424 5112	<b>Palma</b> +34 971 495 413	<b>Athens</b> +30 210 967 1661
<b>Dubai</b> +971 4 425 5874	<b>Phuket</b> +66 7623 9739	<b>Hong Kong</b> +852 6496 2094	<b>Tokyo</b> +81 46 738 8612	<b>Sydney</b> +61 499 945 557	<b>Mumbai</b> +91 98211 67253	<b>Shanghai</b> +86 187 0898 6800	<b>Rio de Janeiro</b> +55 21 2553-3238
<b>Aspen</b> +1 970 710 2294							

La publicité de ce(s) navire(s) dans des publications imprimées, sur Internet ou sur tout autre support n'est pas autorisée sans l'autorisation écrite préalable de Burgess.  
Toutes les informations sont données de bonne foi et sont considérées comme exactes, mais elles ne peuvent être garanties.

Dernière mise à jour : 11 mars 2025