

MOSAIQUE



MOSAIQUE

APERÇU.

When you step aboard MOSAIQUE, you will congratulate yourself on your choice of charter. Although she was built in 2002, MOSAIQUE has the classic lines and spacious decks reminiscent of cruising's glory days. Newly refitted, her interior suggests high-end boutique hotel - and with every convenience on tap from fine dining to an RYA watersports centre, you'll want to come sailing every year.

Open your eyes to views of the anchorage glittering through the windows of your master stateroom. The ornate panelling and deep carpet underfoot creates an ambiance of easy luxury you as you dress for breakfast. This is one of six equally fine cabins aboard, so you know that your party of 12 will have all slept well.

Take the central stairs from the foyer to the upper deck where breakfast is laid ready on the teak aft deck. Everyone gathers here to start the day: in the shade of the awning coffee is sipped, oranges freshly-juiced and towers of pancakes devoured while the day's plan is discussed.

MOSAIQUE is approved as an RYA Training Centre so you couldn't be in better hands to hone your skills – and come away with a recognised certificate. Jetski, waterski, snorkel, scuba or kayak – just some of the options to keep you entertained. And for pure fun, take a ride on the inflatable donut.

When cruising, a trip ashore is a must to explore the local scene in each port, and the yacht's 8m (26.3ft) tender can nip you there in no time. After the markets and antiques, you'll be ready for lunch – maybe time for the crew to take you to that water-edge tavern renowned for the freshest seafood platters.

Back on board MOSAIQUE the sun deck is beckoning. With loungers, a jacuzzi and sit up bar, you will while away happy hours soaking in the warm sun and catching up on that reading that you've been looking forward to. Swimming off the platform astern is a lovely way to cool off after sunbathing.

As the sun begins to dip, find your way to the sky lounge bar. This glamorous room seamlessly marries tradition with edgy modern furniture in a cool designer scheme – the perfect place to gather for pre-dinner drinks.

Fine dine on the main deck with haute cuisine that you'll want to linger over, before stepping though to the main saloon. Leave the children in here, snuggled up to watch a movie – the star-lit sea beckons you out on deck to spend time alone with your loved one.

Principales caractéristiques

Recently refitted

Exercise equipment

Jacuzzi on the sun deck

Zero speed stabilisers to reduce any rolling motion while at anchor

MOSAIQUE

Toys



Aerial view



Sun deck



Sun deck gym



BURGESS

Discover the difference.
burgessyachts.com



MOSAIQUE

Sun deck



Bridge deck aft



Bridge deck aft



Main deck aft



BURGESS

Discover the difference.
burgessyachts.com



MOSAIQUE

Main deck lounge



Main deck seating area



Main deck dining area



Sky lounge



BURGESS

Discover the difference.
burgessyachts.com



MOSAIQUE

Master cabin



VIP cabin



Double cabin



Guest cabin



MOSAIQUE

Guest cabin en suite



Guest cabin



Guest en suite



At anchor



MOSAÏQUE SPÉCIFICATIONS.



Longueur
49,9m



Chantier
2002 (refitted 2020), Proteksan Turquoise, Turkey



Designer d'intérieur
Donald Starkey



Largeur
9,3m



Tirant d'eau
2,9m



Tonnage brut
589



Vitesse de croisière
12 knots



Vitesse maximale
15 knots



Consommation de carburant en vitesse de croisière
80 litres par heure



Moteurs
2 x 1 100hp Caterpillar



Invités
12



Nb de cabines invités
6 (5 x double, 1 x twin, 1 x additional berths)



Équipage
12

[Voir le yacht sur le site](#)

[Regarder la vidéo du yacht](#)



Annexes & jeux nautiques



2 × Tenders



1 × Deck jacuzzi



RYA training centre for jetskis
& waverunners



2 × Waverunners



2 × SeaBobs



1 × Kayak



3 × Stand up paddleboards



Wakeboard



Kneeboard



Waterskis



Inflatable tows



Scuba diving equipment



Snorkelling gear

Remise en forme & bien-être



Cross trainer



Free weights



Upright stationary bike



Yoga mats

SUN DECK

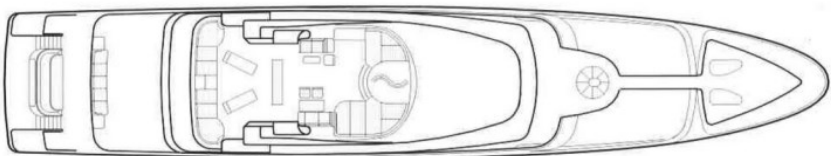

SKY DECK

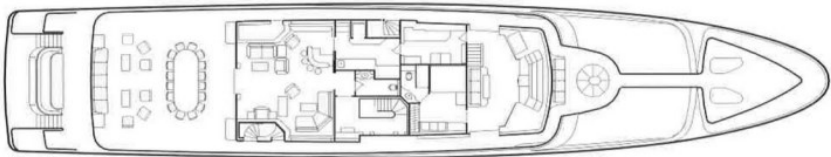

MAIN DECK



LOWER DECK



BURGESS

WORLD CLASS. WORLD WIDE.

London +44 20 7766 4300	Monaco +377 97 97 81 21	New York +1 212 223 0410	Miami +1 305 672 0150	Singapore +65 9665 8990	Beverly Hills +1 310 424 5112	Palma +34 971 495 413	Athens +30 210 967 1661
	Dubai +971 4 425 5874	Phuket +66 7623 9739	Hong Kong +852 6496 2094	Tokyo +81 46 738 8612	Sydney +61 499 945 557	Mumbai +91 98211 67253	

La publicité de ce(s) navire(s) dans des publications imprimées, sur Internet ou sur tout autre support n'est pas autorisée sans l'autorisation écrite préalable de Burgess.
Toutes les informations sont données de bonne foi et sont considérées comme exactes, mais elles ne peuvent être garanties.

Dernière mise à jour : 12 mars 2024