

LUNASEA



LUNASEA

APERÇU.

LUNASEA is a yacht of quite flawless pedigree. Designed inside and out by RWD to excel as a family yacht, she is an absolute gem for a truly extraordinary charter. Built by Feadship and launched in 2017, her exceptional quality was instantly recognised as award winning at the 2018 World Superyacht Awards.

The yacht offers extremely well-thought-out areas for each generation of the family to enjoy, from the oversized infinity pool on the main deck, or the vast sun deck with flowing indoor-outdoor bar and jacuzzi, to the dedicated spa treatment room. On board LUNASEA, one can enjoy a sense of calm and relaxation or fun and entertainment throughout the guest areas.

At 73m (239.5ft) with a beam of 11.9m (39ft), she has huge amounts of inside and outside space across her five decks. The interior showcases a bright and luxurious beach chic design reminiscent of Riviera lifestyle. Outside, a fold down TV on the main deck aft makes this area a family focus and with a BBQ on the bridge deck and a Teppanyaki grill on the sun deck, al fresco dining is all part of the picture.

One of her stand out features is the beach club on the lower deck, reached via a beautiful spiral staircase or by the elevator serving lower to bridge decks, making her wheelchair friendly. To port is a fully equipped gym with fold out sea terrace where guests can work out while enjoying sea views. To starboard is the beach club, also with a sea terrace, where guests can watch the sunset or the family play while enjoying a drink from the bar in the centre.

Also on the lower deck is the beautiful wellness spa complete with a massage room, hairdressing salon and shower where guests can unwind and let the cares of the day ease away.

A 9m Vikal limo tender, two sports tenders plus a RIB will make exploring and watersports a real highlight of your charter. Jetskis, SeaBobs, waterslide and waterskis are also part of the exceptional amenities on board. The design vision behind LUNASEA has created an impeccable yacht with impressive volume and relaxed indoor-outdoor living spaces to deliver the most exceptional charter experience.

Principales caractéristiques

Winner of 2018 World Superyacht Awards

Spa facilities: Massage room

Beach club at sea level

Exercise equipment

13m Invincible sports and dive tender

Outdoor cinema screen

Elevator servicing lower deck to bridge deck

Pool on the aft deck

Jacuzzi on the sun deck

Zero speed stabilisers to reduce any rolling motion while at anchor

LUNASEA

Aerial view



Outdoor cinema screen



Sun deck jacuzzi

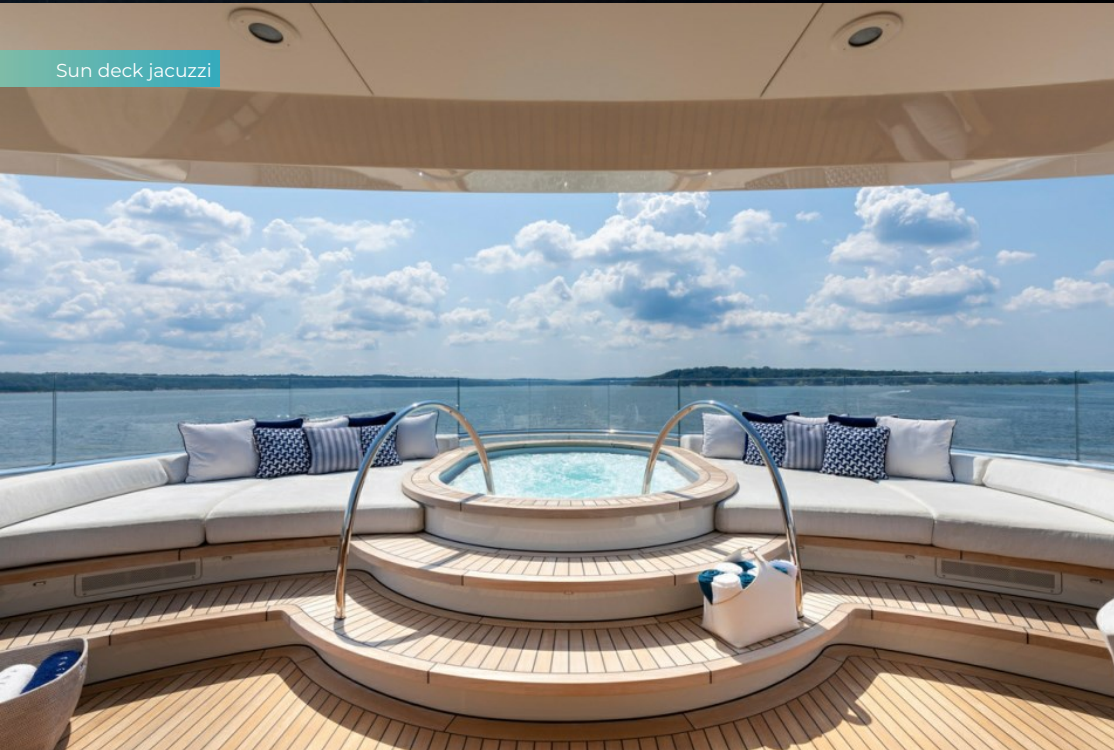

Sun deck seating area and jacuzzi



LUNASEA

Sun deck aft



Sun deck aft bar



Bridge deck aft dining area



Beach club



LUNASEA

Beach club



Main deck dining area



Main deck dining area



Sky lounge



BURGESS

Discover the difference.
burgessyachts.com



LUNASEA

Sky lounge bar



Sun deck lounge



Sun deck lounge bar



Main deck master cabin



LUNASEA

Main deck master cabin



Master lounge



Master bathroom en suite



Master study



LUNASEA

Bridge deck VIP cabin



Lower deck double cabin



Lower deck double cabin



Lower deck double cabin



BURGESS

Discover the difference.
burgessyachts.com



LUNASEA

Lower deck double cabin



Guest bathroom en suite



Main deck cinema



Massage and treatment room



LUNASEA

Massage and treatment room



Beach club exercise equipment



At anchor



Dive into your holidays



BURGESS

Discover the difference.
burgessyachts.com



LUNASEA

SPECIFICATIONS.



Longueur
73m



Chantier
2017, Feadship, Royal Van Lent, The Netherlands



Designer d'intérieur
RWD



Largeur
11,9m



Tirant d'eau
3,5m



Tonnage brut
1 577



Vitesse de croisière
14 knots



Vitesse maximale
16 knots



Consommation de carburant en vitesse de croisière
464 litres par heure



Moteurs
2 x 1 850hp MTU



Invités
12



Nb de cabines invités
6 (4 x double, 2 x double/twin)



Équipage
21

[Voir le yacht sur le site](#)

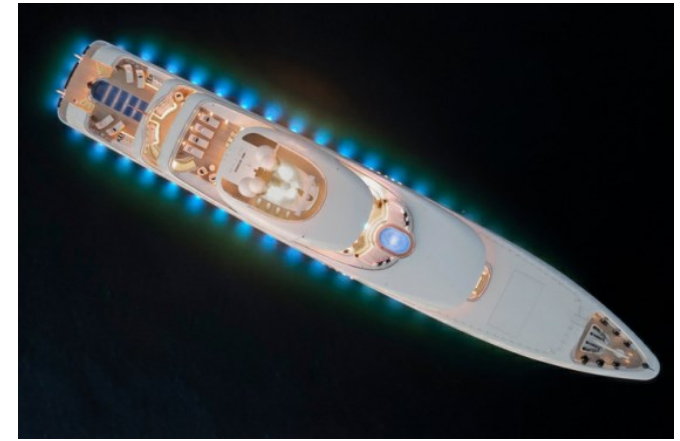

ANNEXES & JEUX NAUTIQUES



1 x Towed tender



1 x Limousine tender



2 x Tenders



1 x Deck jacuzzi



Pool



2 x Waverunners



4 x SeaBobs



5 x Stand up paddleboards



Wakeboard



Kneeboard



Wakeskate



Waterskis



Anti-jellyfish pool



Trampoline



Inflatable platform



Waterslide



Inflatable tows



Scuba diving equipment



Snorkelling gear



Fishing gear



RYA training centre for jetskis & waverunners

LUNASEA

REMISE EN FORME & BIEN-ETRE



Free weights



Multi gym



Rowing machine



Training bench



Upright stationary bike



Yoga mats



Massage room

LUNASEA

GENERAL ARRANGEMENT

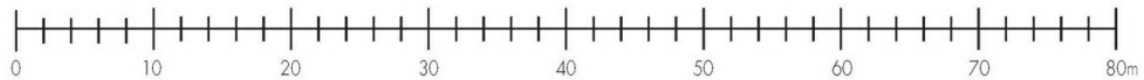
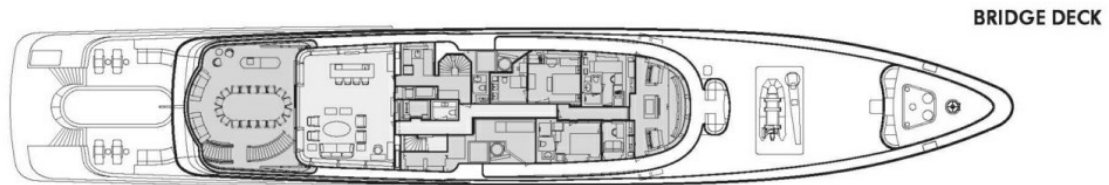
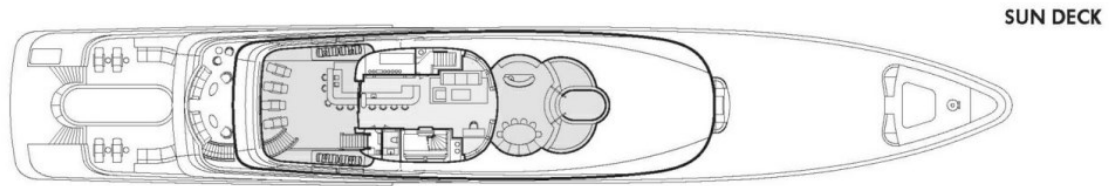

BURGESS

WORLD CLASS. WORLD WIDE.

London +44 20 7766 4300	Monaco +377 97 97 81 21	New York +1 212 223 0410	Miami +1 305 672 0150	Singapore +65 9665 8990	Beverly Hills +1 310 424 5112	Palma +34 971 495 413	Athens +30 210 967 1661
Dubai +971 4 425 5874	Phuket +66 7623 9739	Hong Kong +852 6496 2094	Tokyo +81 46 738 8612	Sydney +61 499 945 557	Mumbai +91 98211 67253	Shanghai +86 187 0898 6800	Rio de Janeiro +55 21 2553-3238
Aspen +1 970 710 2294							

La publicité de ce(s) navire(s) dans des publications imprimées, sur Internet ou sur tout autre support n'est pas autorisée sans l'autorisation écrite préalable de Burgess.
Toutes les informations sont données de bonne foi et sont considérées comme exactes, mais elles ne peuvent être garanties.

Dernière mise à jour : 13 février 2025