

LUMIR



LUMIR

SPECIFICATIONS.



Prix demandé
AUD 9 750 000 (Tax paid)



Chantier
2005 (refitted 2026), Heesen, The Netherlands



Longueur
36,8m



Largeur
7m



Tirant d'eau
2,2m



Tonnage brut
245



Vitesse de croisière
15 knots



Vitesse maximale
31 knots



Pavillon
Australia



Position
Australasia



Classe
American Bureau of Shipping (ABS)



Designer extérieur
Heesen Yachts/Omega Architects



Designer d'intérieur
Omega Architects



Construction
**Hull - Aluminium, Superstructure - Aluminium,
Deck - Teak**



Équipage
6



Invités
10



Cabines
4 (3 × double, 1 × twin, 2 × additional berths)



Moteurs
2 × 2 720hp MTU



2 × Northern Lights



Propulsion
Twin screw diesel yacht

[Voir le yacht sur le site](#)



LUMIR



BURGESS

Discover the difference.
burgessyachts.com

LUMIR



BURGESS

Discover the difference.
burgessyachts.com

LUMIR



BURGESS

Discover the difference.
burgessyachts.com

LUMIR



BURGESS

Discover the difference.
burgessyachts.com

LUMIR



BURGESS

Discover the difference.
burgessyachts.com

LUMIR



BURGESS

Discover the difference.
burgessyachts.com

LUMIR

APERÇU.

LUMIR is a 36.8m (120.7ft) yacht crafted by the iconic Dutch shipyard Heesen in 2005. She benefited from an extensive refit in 2013, followed by a continuous programme of major upgrades and works carried out under her current ownership between 2022 and 2026. Built in aluminium and showcasing Heesen's renowned expertise, she features exterior styling and naval architecture by the shipyard's in-house team, complemented by an elegant interior by Omega Architects.

Her profile carries all the hallmarks of Omega Architects' design language – clean, sporty lines, expansive deck spaces, and large windows that bathe the interior in natural light. LUMIR was conceived to deliver both exhilarating speed and uncompromising comfort, blending luxury and performance in perfect harmony.

A true high-performance yacht, LUMIR is powered by twin 3,650hp MTU diesel engines. Her lightweight aluminium hull enables impressive speeds, reaching up to 31 knots, with a comfortable cruising speed of around 26 knots. The result is a fast, sporty, and stable ride that appeals to owners who value both excitement and efficiency on the water.

Her outdoor living spaces are among her greatest highlights. The expansive flybridge is designed for effortless entertaining, featuring a fully equipped bar and a jacuzzi positioned to deliver sweeping ocean or harbour views. Numerous lounging and dining areas across her decks create inviting spots to sunbathe, gather, or enjoy relaxed al fresco dining at any time of day. Inside, the main saloon offers a warm and sophisticated atmosphere, with plush seating, a formal dining area, and a striking back-lit poker table – perfect for lively evenings and memorable social moments.

LUMIR accommodates up to 10 guests across four appointed cabins, including a full-beam master suite, two generous VIP cabins, and a twin cabin with additional bunks. The interior layout is designed to offer both privacy and comfort, making her ideal for families or groups of friends. Her sun deck is the heart of the yacht's outdoor lifestyle, featuring a large jacuzzi, ample loungers, shaded dining, and generous open spaces designed for relaxation and entertainment.

Principales caractéristiques

Northern European pedigree

Fast semi displacement yacht with maximum speeds of 31 knots

Accommodation for 10 guests in four cabins

Contemporary interior conceived by Omega Architects

Tender garage off the swim platform

Upgraded with zero-speed stabilisers by the current owner, delivering exceptional comfort by reducing roll both at anchor and underway

Annexes

21' Novurania launch, jet drive inboard diesel

FLYBRIDGE

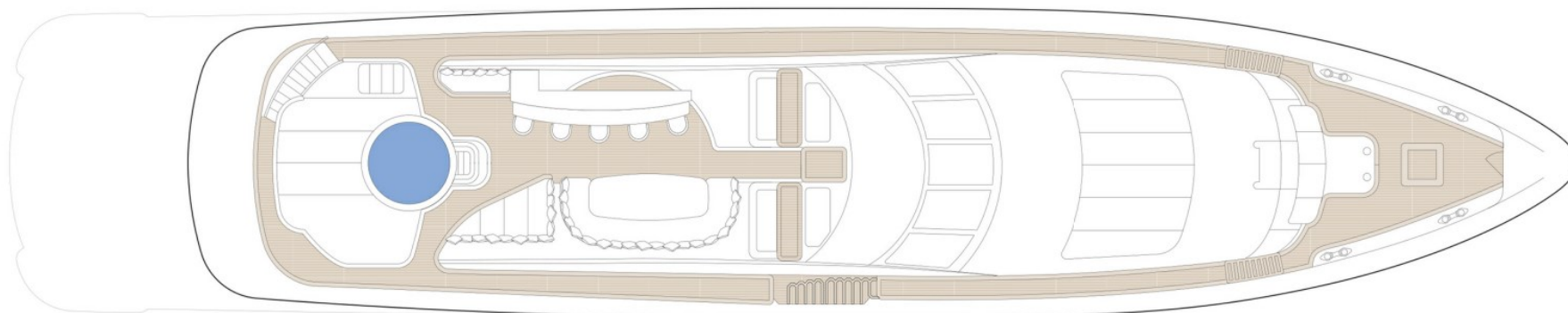

- GUEST AREAS
- MASTER SUITE
- GUEST CABINS
- GYM
- JACUZZI

WHEELHOUSE

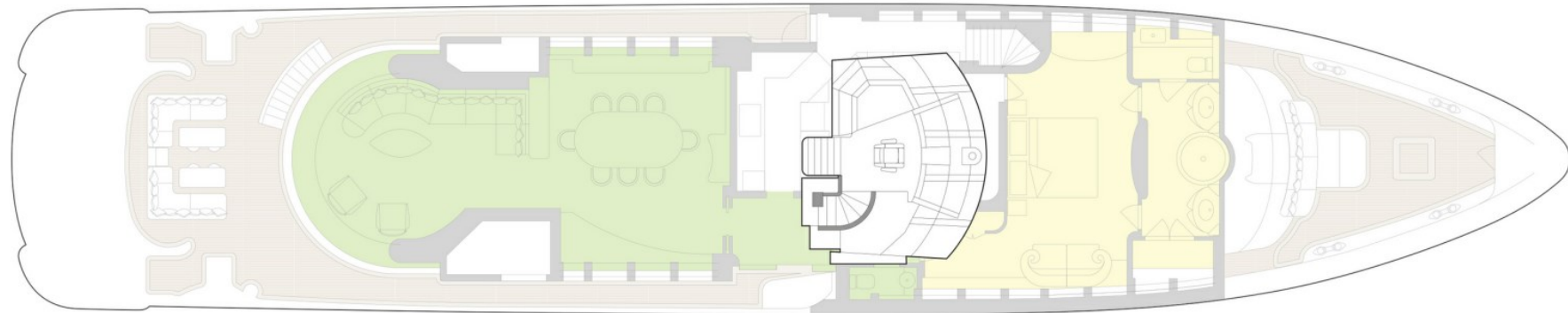

- GUEST AREAS
- MASTER SUITE
- GUEST CABINS
- GYM
- JACUZZI



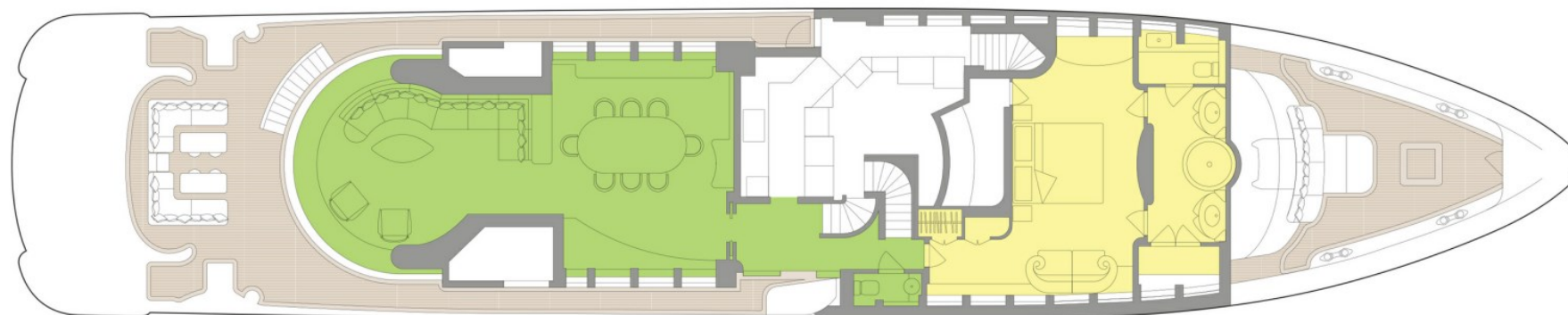

MAIN DECK

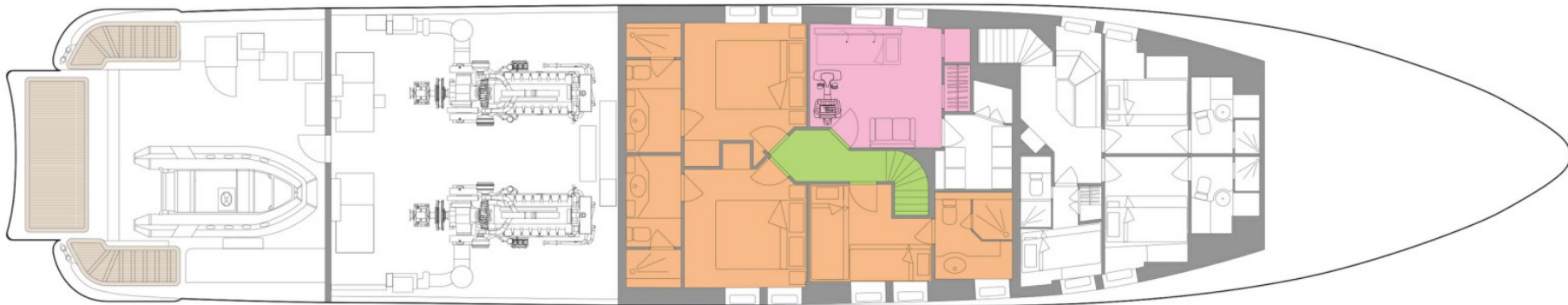

- GUEST AREAS
- MASTER SUITE
- GUEST CABINS
- GYM
- JACUZZI

LOWER DECK

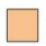

-  GUEST AREAS
-  MASTER SUITE
-  GUEST CABINS
-  GYM
-  JACUZZI

BURGESS

WORLD CLASS. WORLD WIDE.

London +44 20 7766 4300	Monaco +377 97 97 81 21	New York +1 212 223 0410	Miami +1 305 672 0150	Singapore +65 9665 8990	Beverly Hills +1 310 424 5112	Palma +34 971 495 413	Athens +30 210 967 1661
Dubai +971 4 425 5874	Phuket +66 8257 01150	Hong Kong +852 6496 2094	Tokyo +81 46 738 8612	Sydney +61 499 945 557	Mumbai +91 98211 67253	Shanghai +86 159 0162 1898	Rio de Janeiro +55 21 2553-3238
		Aspen +1 970 710 2294	Guernsey +44 1481 735360	Palm Beach +1 561 973 2768			

La publicité de ce(s) navire(s) dans des publications imprimées, sur Internet ou sur tout autre support n'est pas autorisée sans l'autorisation écrite préalable de Burgess.
Toutes les informations sont données de bonne foi et sont considérées comme exactes, mais elles ne peuvent être garanties.

Dernière mise à jour : 16 juin 2026