

# LUMIR

---



LUMIR

# SPECIFICATION.



Asking price  
**AUD 9,750,000 (Tax paid)**



Built  
**2005 (refitted 2026), Heesen, The Netherlands**



Length  
**36.8m (120.7ft)**



Beam  
**7m (23ft)**



Draft  
**2.2m (7.2ft)**



Gross tonnage  
**245**



Cruising speed  
**15 knots**



Maximum speed  
**31 knots**



Flag  
**Australia**



Lying  
**Australasia**



Class  
**American Bureau of Shipping (ABS)**



Exterior designer  
**Heesen Yachts/Omega Architects**



Interior designer  
**Omega Architects**



Construction  
**Hull - Aluminium, Superstructure - Aluminium,  
Deck - Teak**



Crew  
**6**



Guests  
**10**



Cabins  
**4 (3 × double, 1 × twin, 2 × additional berths)**



Engines  
**2 × 3,648hp MTU**



Generators  
**2 × Northern Lights**



Propulsion  
**Twin screw diesel yacht**

[View yacht on website](#)



LUMIR



BURGESS

Discover the difference.  
[burgessyachts.com](http://burgessyachts.com)

LUMIR



BURGESS

Discover the difference.  
[burgessyachts.com](http://burgessyachts.com)

LUMIR



BURGESS

Discover the difference.  
[burgessyachts.com](http://burgessyachts.com)

LUMIR



BURGESS

Discover the difference.  
[burgessyachts.com](http://burgessyachts.com)

LUMIR



BURGESS

Discover the difference.  
[burgessyachts.com](http://burgessyachts.com)

LUMIR



BURGESS

Discover the difference.  
[burgessyachts.com](http://burgessyachts.com)

LUMIR

# OVERVIEW.

**LUMIR is a 36.8m (120.7ft) yacht crafted by the iconic Dutch shipyard Heesen in 2005. She benefited from an extensive refit in 2013, followed by a continuous programme of major upgrades and works carried out under her current ownership between 2022 and 2026. Built in aluminium and showcasing Heesen's renowned expertise, she features exterior styling and naval architecture by the shipyard's in-house team, complemented by an elegant interior by Omega Architects.**

Her profile carries all the hallmarks of Omega Architects' design language – clean, sporty lines, expansive deck spaces, and large windows that bathe the interior in natural light. LUMIR was conceived to deliver both exhilarating speed and uncompromising comfort, blending luxury and performance in perfect harmony.

A true high-performance yacht, LUMIR is powered by twin 3,650hp MTU diesel engines. Her lightweight aluminium hull enables impressive speeds, reaching up to 31 knots, with a comfortable cruising speed of around 26 knots. The result is a fast, sporty, and stable ride that appeals to owners who value both excitement and efficiency on the water.

Her outdoor living spaces are among her greatest highlights. The expansive flybridge is designed for effortless entertaining, featuring a fully equipped bar and a jacuzzi positioned to deliver sweeping ocean or harbour views. Numerous lounging and dining areas across her decks create inviting spots to sunbathe, gather, or enjoy relaxed al fresco dining at any time of day. Inside, the main saloon offers a warm and sophisticated atmosphere, with plush seating, a formal dining area, and a striking back-lit poker table – perfect for lively evenings and memorable social moments.

LUMIR accommodates up to 10 guests across four appointed cabins, including a full-beam master suite, two generous VIP cabins, and a twin cabin with additional bunks. The interior layout is designed to offer both privacy and comfort, making her ideal for families or groups of friends. Her sun deck is the heart of the yacht's outdoor lifestyle, featuring a large jacuzzi, ample loungers, shaded dining, and generous open spaces designed for relaxation and entertainment.

## Key features

---

**Northern European pedigree**

---

**Fast semi displacement yacht with maximum speeds of 31 knots**

---

**Accommodation for 10 guests in four cabins**

---

**Contemporary interior conceived by Omega Architects**

---

**Tender garage off the swim platform**

---

**Upgraded with zero-speed stabilisers by the current owner, delivering exceptional comfort by reducing roll both at anchor and underway**

---

# FLYBRIDGE

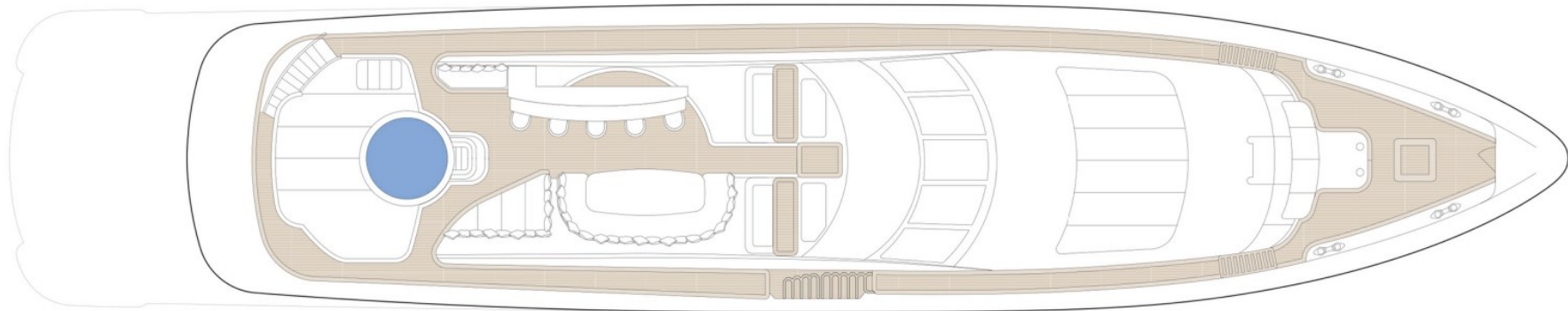

- GUEST AREAS
- MASTER SUITE
- GUEST CABINS
- GYM
- JACUZZI

# WHEELHOUSE

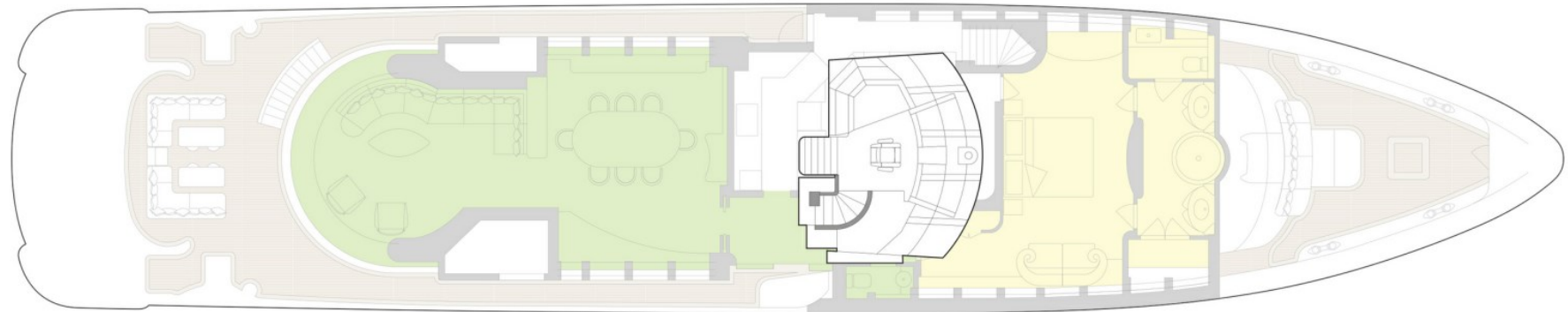

- GUEST AREAS
- MASTER SUITE
- GUEST CABINS
- GYM
- JACUZZI

# MAIN DECK

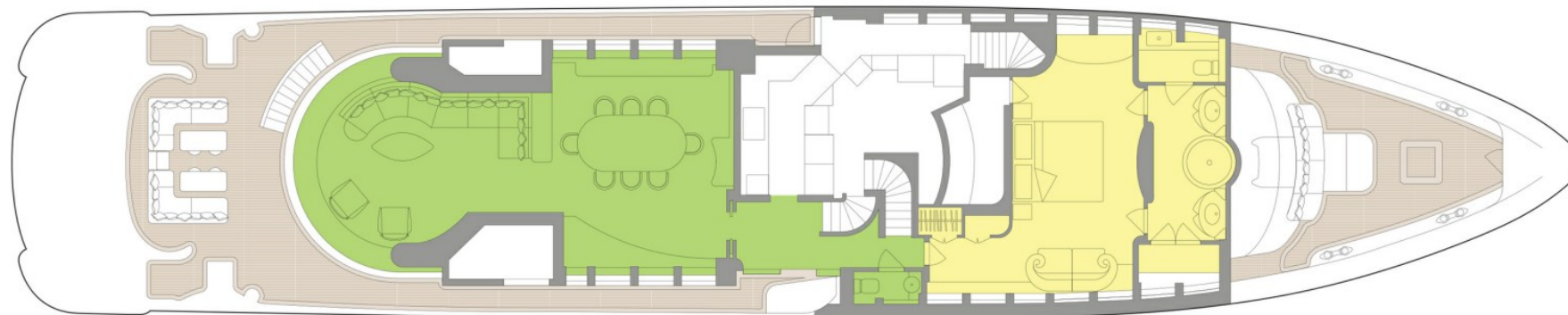

- GUEST AREAS
- MASTER SUITE
- GUEST CABINS
- GYM
- JACUZZI

# LOWER DECK

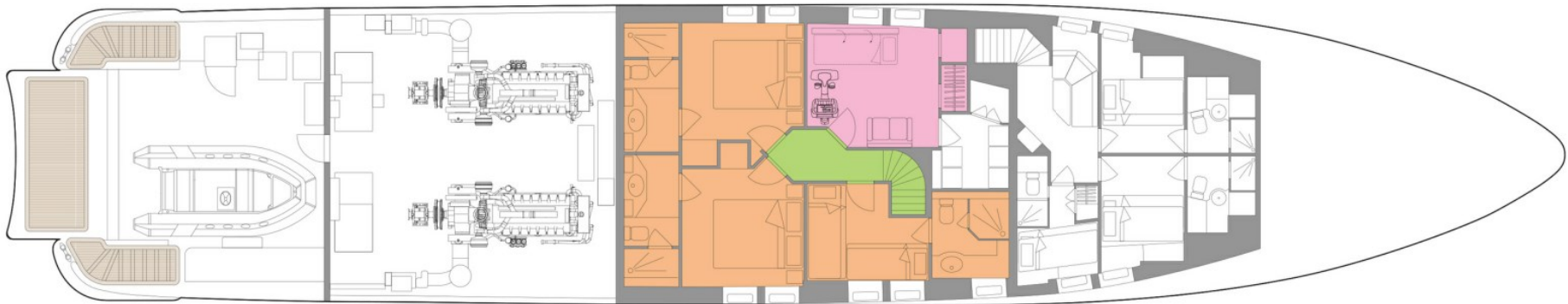

-  GUEST AREAS
-  MASTER SUITE
-  GUEST CABINS
-  GYM
-  JACUZZI

# BURGESS

# WORLD CLASS. WORLD WIDE.

<b>London</b> +44 20 7766 4300	<b>Monaco</b> +377 97 97 81 21	<b>New York</b> +1 212 223 0410	<b>Miami</b> +1 305 672 0150	<b>Singapore</b> +65 9665 8990	<b>Beverly Hills</b> +1 310 424 5112	<b>Palma</b> +34 971 495 413	<b>Athens</b> +30 210 967 1661
<b>Dubai</b> +971 4 425 5874	<b>Phuket</b> +66 8257 01150	<b>Hong Kong</b> +852 6496 2094	<b>Tokyo</b> +81 46 738 8612	<b>Sydney</b> +61 499 945 557	<b>Mumbai</b> +91 98211 67253	<b>Shanghai</b> +86 159 0162 1898	<b>Rio de Janeiro</b> +55 21 2553-3238
		<b>Aspen</b> +1 970 710 2294	<b>Guernsey</b> +44 1481 735360	<b>Palm Beach</b> +1 561 973 2768			

Advertising of these vessel(s) in printed publications, on the internet or in any other medium is not permitted without prior written permission from Burgess. All particulars are given in good faith and are believed correct but they cannot be guaranteed.

Last updated: 17 June 2026