

# LUISA

---



LUISA

# OVERVIEW.

**Fresh from her 2021 refit, LUISA offers you the unique opportunity to relax in an elegant interior designed by Ivana Porfiri. LUISA is your floating 5-star floating boutique hotel for you and your guests. Her stunning interior is dominated by warm sumptuous earthy tones of polished stone and satin-finished wood. The focal point is the stone-walled stairwell and spiral staircase that gives access to three decks.**

The owner's suite is on the main deck, the forward-facing island bed appears to float without support. Either side, large elliptical-shaped windows allow you to enjoy your surroundings, while forward, is a large en suite heads, with multi-nozzle shower, and a separate dressing room, further aft in the suite is the relaxing office space with views out over the ocean to calm or inspire you if you need to work. On the lower deck, there are two large double VIP suites and two twin cabins all accessed from the spectacular lower lobby. With the two double cabins and twin cabins closely located it makes LUISA particularly attractive to groups of guests with families and children.

In LUISA's main saloon and sky lounge, above it, there are floor to ceiling picture windows so while you may feel you're in one of the world's best hotels the views out will remind you why you chartered this luxury yacht. There is a formal dining area to the rear of the saloon on the main deck and an al fresco formal dining area on the upper deck.

While the interior is wonderfully calming, outside is where the fun begins. LUISA's jacuzzi is on the main deck and has many al fresco lounge areas with relaxed seating and sunpads. Then, of course, there are the toys, of which there are many. There are powered toys like the tender, PWC, efoil Waydoo Flyer, a SeaBob, four Yamaha Seascoters or the Jetsurf. Towed toys such as donuts, an inflatable sofa, wakeboards and water skis or relaxing toys for snorkelling, on a SUP, or relaxing on the water on the inflatable beach or in the Aquaglide inflatable Malibu lounge.

After all that fun on the water, what better place to relax than in the beach club area with a spell in the hammam or sauna before the evening dinner watching the sun set.

## Key features

---

**Regularly maintained**

---

**Flexible cabin configurations**

---

**Spa facilities: sauna, hammam, massage room**

---

**Exercise equipment**

---

**Jacuzzi on the main deck aft**

---

**Zero speed stabilisers to reduce any rolling motion while at anchor**

---

LUISA

Aft decks



Stern view



Sun deck seating and jacuzzi



Bridge deck aft



BURGESS

Discover the difference.  
burgessyachts.com



LUISA

Bridge deck aft



Main deck aft



Beach club



Main deck lounge



BURGESS

Discover the difference.  
burgessyachts.com



# LUISA

Main deck lounge



Main deck dining area



Sky lounge



Master cabin



LUISA

Master cabin



Master office



Stairway



Double cabin



LUISA

Double cabin



Twin cabin with pullman



Twin cabin



Tender



LUISA

At anchor



Cruising



BURGESS

Discover the difference.  
burgessyachts.com





LUISA

# SPECIFICATION.



Length  
**47.6m (156.1ft)**



Built  
**1998 (refitted 2021), Heesen, The Netherlands**



Interior designer  
**Ivana Porfiri**



Beam  
**8.5m (27.9ft)**



Draft  
**2.1m (6.9ft)**



Gross tonnage  
**466**



Cruising speed  
**14 knots**



Maximum speed  
**20 knots**



Fuel consumption at cruising speed  
**350 litres per hour**



Engines  
**2 x 3,700hp MTU**



Guests  
**12**



No. of guest cabins  
**5 (3 x double, 2 x twin, 2 x additional berths)**



Crew  
**9**

## Note

Fully licensed for charters in Spanish waters.

[View yacht on website](#)



LUISA

# TENDERS & TOYS



1 x Towed tender



1 x Tender



1 x Deck jacuzzi



1 x Waverunner



2 x SeaBobs



4 x Underwater scooters



1 x eFoil



1 x Jetsurf



4 x Stand up paddleboards



Wakeboard



Waterskis



Inflatable platform



Inflatable toys



Snorkelling gear

LUISA

# FITNESS & WELLNESS



Free weights



Yoga mats





PROFILE

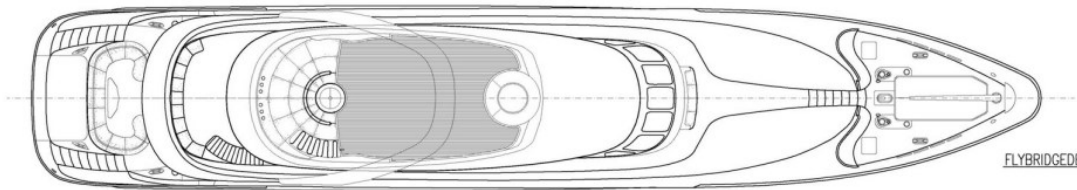

FLYBRIDGEDECK

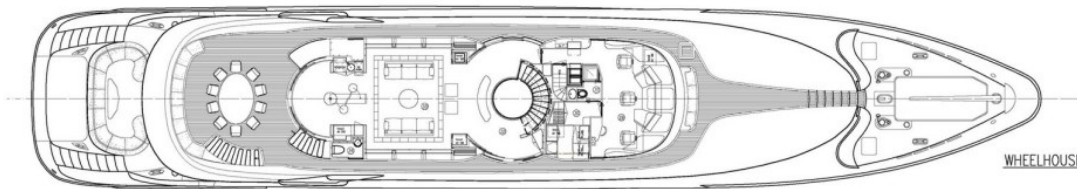

WHEELHOUSEDECK

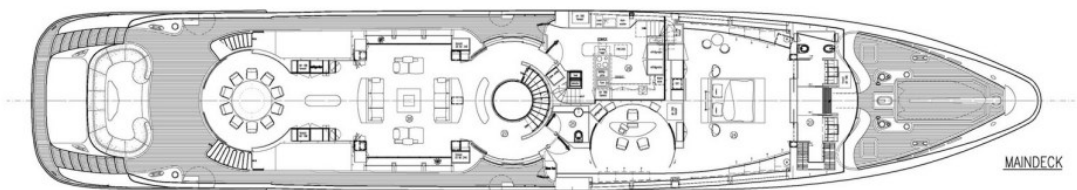

MAINDECK

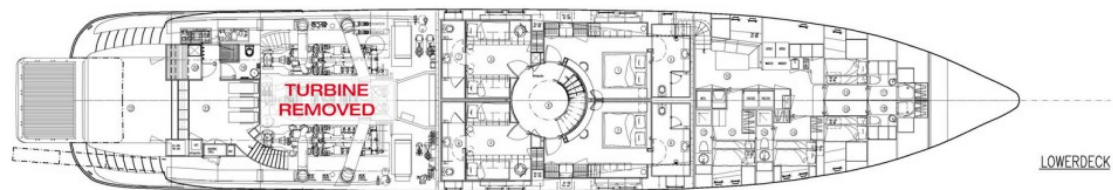

LOWERDECK

# BURGESS

# WORLD CLASS. WORLD WIDE.

<b>London</b> +44 20 7766 4300	<b>Monaco</b> +377 97 97 81 21	<b>New York</b> +1 212 223 0410	<b>Miami</b> +1 305 672 0150	<b>Singapore</b> +65 9665 8990	<b>Beverly Hills</b> +1 310 424 5112	<b>Palma</b> +34 971 495 413	<b>Athens</b> +30 210 967 1661
<b>Dubai</b> +971 4 425 5874	<b>Phuket</b> +66 7623 9739	<b>Hong Kong</b> +852 6496 2094	<b>Tokyo</b> +81 46 738 8612	<b>Sydney</b> +61 499 945 557	<b>Mumbai</b> +91 98211 67253	<b>Shanghai</b> +86 187 0898 6800	<b>Rio de Janeiro</b> +55 21 2553-3238
<b>Aspen</b> +1 970 710 2294							

Advertising of these vessel(s) in printed publications, on the internet or in any other medium is not permitted without prior written permission from Burgess. All particulars are given in good faith and are believed correct but they cannot be guaranteed.

Last updated: 03 March 2025