

LA LUNA



OVERVIEW.

Experience the exhilaration of surging through sparkling waves under a cloud of sail, powered purely by nature, on board a yacht that sacrifices absolutely nothing in luxury, watertoys and features. From her spectacular main deck circus lounge - a unique feature - to her swim platform, she has it all.

You awake in the full beam master cabin with sun streaming through the many portholes and settle onto the sofa to sip on a smoothie as you anticipate the day. After a quick session on the beach club's elliptical trainer, dress in the walk in wardrobe before joining the rest of the party in the main deck aft cockpit lounge, shaded by the flybridge overhang. Here fresh pastries, coffee and a selection of delicious plates are enjoyed as you talk through the day's plans with the captain.

Once dressed for action, walk through from your cabin to the beach club where the deck crew has the watertoys ready for action. After a morning full of high speed thrills and exploring underwater, you shower and make your way up to the flybridge where a lunch of grilled seafood and salads is ready for you. After lunch you can relax on the flybridge sunloungers and feel the awesome power of the wind or catch a movie in the main deck TV room, as the captain makes sail for the next destination.

With the sails furled and the anchors set, join your friends on the flybridge. As the breeze disappears and the sun heads for the horizon, toast another great day with sundowners before the greatest gastronomic show on earth begins beneath the big top of the main deck's amazing circus lounge and bar with fine dining for 10 guests.

As sleep beckons your guests retire to their cabins where they dream of what adventures are to come tomorrow.

Key features

Unique Perini with 'The Circus' on the forward bow area - with comfortable seating, bar and dining for 10 and more, surrounding windows that scroll down with blinds

Transom/Swim platform with shower and guard rails at sea level for day swim or romantic dinners

Balcony on port side with direct access to Master suite

Large options of outdoor guests spaces for dining, lunch and breakfast, lounging and shading on all decks with canopies on the forward deck and aft, and movable umbrellas

LA LUNA

Bridge deck aft



Bridge deck aft



Bridge deck aft lounge



Bridge deck aft lounge



BURGESS

Discover the difference.
burgessyachts.com



LA LUNA

Office/TV room



Office/TV room



Bar & seating area



Wheelhouse



LA LUNA

Lower deck lounge



Lower deck lounge



Master cabin



Master cabin



LA LUNA

Master cabin



Master cabin



Master cabin bathroom en suite



Double cabin



BURGESS

Discover the difference.
burgessyachts.com



LA LUNA

Twin cabin



Forward bow area - 'The Circus'



Forward bow area - 'The Circus'



'The Circus' details



BURGESS

Discover the difference.
burgessyachts.com



LA LUNA

'The Circus'



'The Circus' details



Bridge deck forward

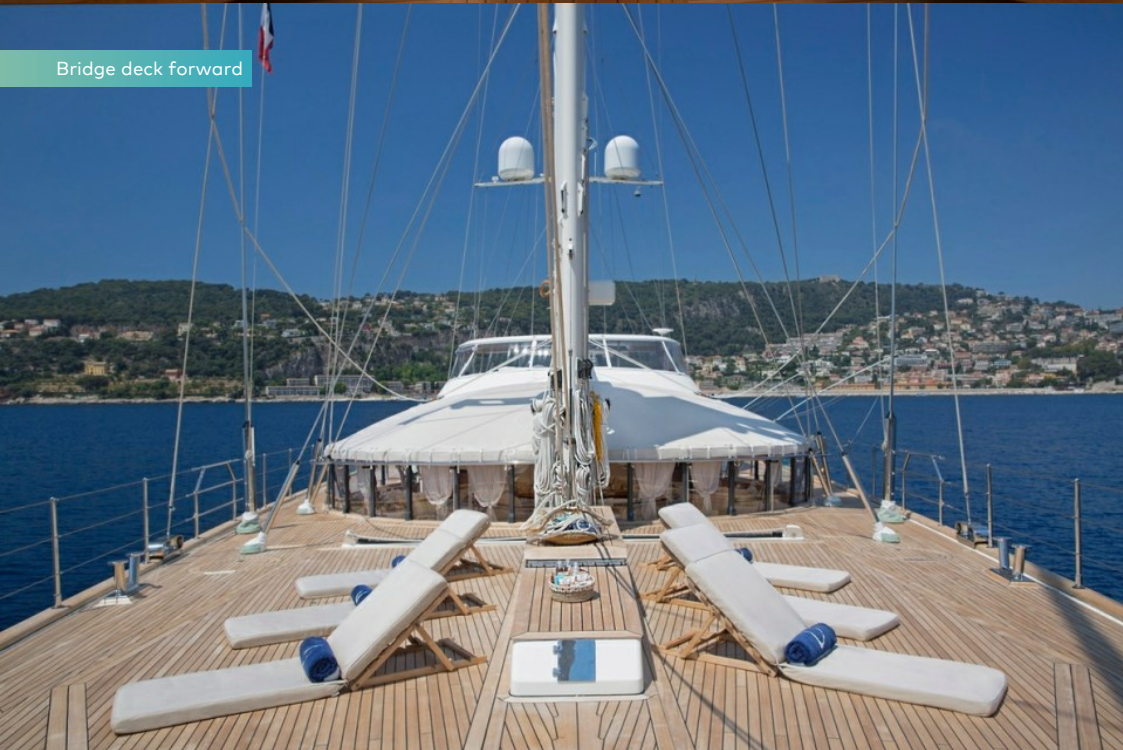

Bridge deck forward

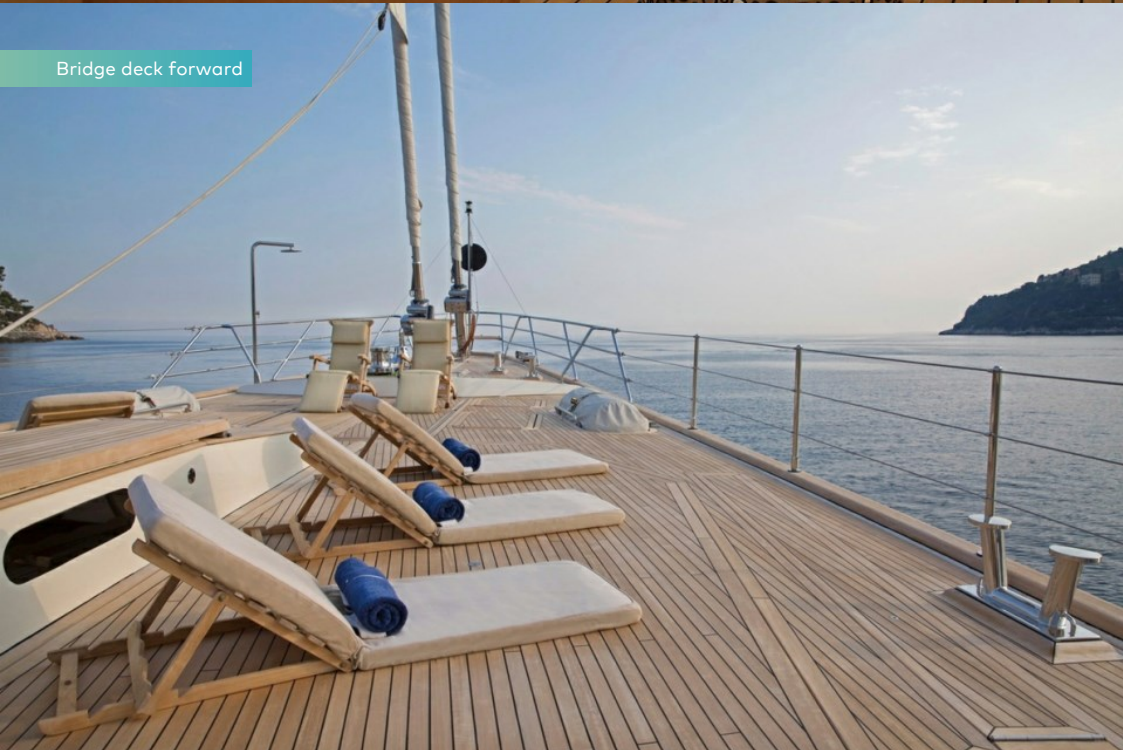

BURGESS

Discover the difference.
burgessyachts.com



LA LUNA

Bridge deck forward



Flybridge



Flybridge



Side platform



BURGESS

Discover the difference.
burgessyachts.com



LA LUNA

Swim platform



Lifestyle



Tender



At anchor



BURGESS

Discover the difference.
burgessyachts.com



LA LUNA

Underway



BURGESS

Discover the difference.
burgessyachts.com



LA LUNA

SPECIFICATION.



Length
53.2m (174.5ft)



Built
1997 (refitted 2017), Perini Navi, Italy



Interior designer
Perini Navi



Beam
11.4m (37.4ft)



Draft min/max
3.7m (12.1ft)/8.2m (26.9ft)



Displacement
540 tonnes



Cruising speed
11 knots



Maximum speed
13.5 knots



Fuel consumption at cruising speed
300 litres per hour



Engines
2 x 1,256hp Deutz



Guests
10



No. of guest cabins
5 (3 x double, 2 x twin, 2 x additional berths)



Crew
12

Note

Fully licensed for charters in Spanish waters.

[View yacht on website](#)



LA LUNA EQUIPMENT.

Tenders & toys



1 x Tender



3 x SeaBobs



2 x Kayaks



3 x Stand up paddleboards



Wakeboard



Windsurfer



Waterskis



Inflatable tows

7m Novamarine towed tender with 200hp mercury powered | 2 x Windsurf (2 sails) | 2 x Wakeboards | Waterskis double and single | 3 x SeaBob | 3 x paddle boards | 2 x rigid kayaks (1pax) | 2 x double inflatable canoe (2pax) | Inflatables including donuts (1pax) | Banana (3 pax)

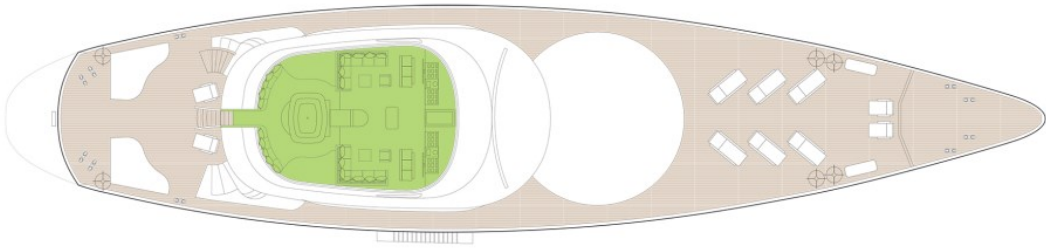

UPPER DECK

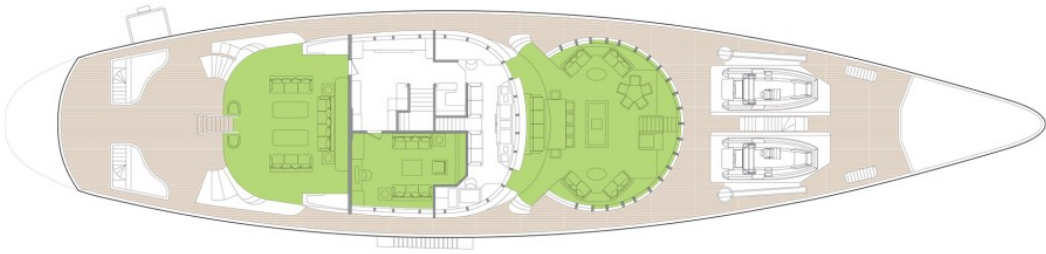

BRIDGE DECK

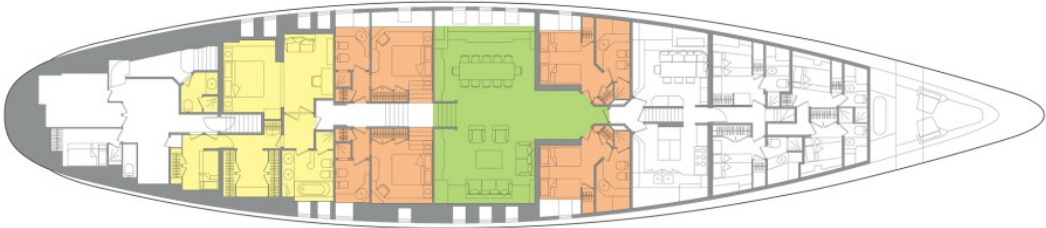

LOWER DECK

■ GUEST AREAS ■ MASTER SUITE ■ GUEST CABINS

BURGESS

WORLD CLASS. WORLD WIDE.

London +44 20 7766 4300	Monaco +377 97 97 81 21	New York +1 212 223 0410	Miami +1 305 672 0150	Singapore +65 9665 8990	Beverly Hills +1 310 424 5112	Palma +34 971 495 413	Athens +30 210 967 1661
	Dubai +971 4 425 5874	Phuket +66 7623 9739	Hong Kong +852 6496 2094	Tokyo +81 46 738 8612	Sydney +61 499 945 557	Mumbai +91 98211 67253	

Advertising of these vessel(s) in printed publications, on the internet or in any other medium is not permitted without prior written permission from Burgess. All particulars are given in good faith and are believed correct but they cannot be guaranteed.

Last updated: 26 March 2024