

LADYSHIP



LADYSHIP

OVERVIEW.

LADYSHIP represents the sophisticated retro style of the 1990s, with all the modernisation available to yachts, thanks to her 2016 refit. Her distinctive lines make this 41m (135ft) yacht a head turner in any port, and her generous inside-outside spaces make her just as cool on board.

Sailing out of Tivat, Montenegro, her crew are well versed in the nooks and crannies of the Adriatic Coast – so you can relax in the knowledge that they will find you all the prettiest islands, secret beaches, and sheltered anchorages to visit.

Families love the flexibility of the accommodation aboard; six cabins provide a range of bedrooms from VIP suite for the grandparents to twin cabin for the children. Find your master suite forward on the main deck, with access to step out onto the secluded fore deck and enjoy a little time a deux.

Confirmed as a RYA water sport centre in 2020, LADYSHIP offers a raft of water sports and toys. Her transom drops down to create a huge swim platform and dock. Take the kayak and paddle boards on a trip along the rocky coastline, and perhaps you will discover caves and tiny beaches. The faster option is to take Sea-Doos. The whole family will want to join in the fun with towable inflatables!

LADYSHIP is very economical and cruises at an easy 14.5 knots. Her super-modern NAIAD stabilisers ensure that you all stay comfortable when underway, so enjoy lunch on the upper deck's large tables and banquette while the captain navigates to your next port. There's always the jacuzzi and sunbathing to enjoy after lunch on the top deck.

When the sun begins to stain the sky red and orange, find one of the two bars aboard for the yachting tradition of sundowners. The evening offers the chance to step ashore and explore the bars and restaurants - while the children are tucked up watching a movie in the main saloon snug.

This is the charter life – LADYSHIP style.

Key features

Regularly maintained

A crew with local expertise

Shaded deck dining and deck areas

Jacuzzi on the sun deck

Zero speed stabilisers to reduce any rolling motion while at anchor

LADYSHIP

Aerial view



Sun deck jacuzzi



Sun deck



Sun deck



LADYSHIP

Upper deck aft



Main deck aft



Main deck lounge



Main deck dining



LADYSHIP

Main deck bar



Sky lounge



Sky lounge



Main deck master cabin



LADYSHIP

Main deck master cabin



Master bathroom en suite



Master bathroom en suite



Lower deck VIP cabin



LADYSHIP

Lower deck double cabin



Upper deck double cabin



VIP bathroom en suite



Lower deck twin cabin



LADYSHIP

Lower deck twin cabin



Watersports



Waverunner



Stern view



LADYSHIP

SPECIFICATION.



Length
41m (134.6ft)



Built
1994 (refitted 2016), Heesen, The Netherlands



Interior designer
Mulder Design



Beam
7.8m (25.6ft)



Draft
2.4m (7.9ft)



Gross tonnage
360



Cruising speed
14.5 knots



Maximum speed
19 knots



Fuel consumption at cruising speed
350 litres per hour



Guests
12



No. of guest cabins
6 (4 x double, 2 x twin)



Crew
7

[View yacht on website](#)



LADYSHIP

TENDERS & TOYS



1 × Tender



1 × Deck jacuzzi



RYA training centre for jetskis & waverunners



2 × Stand up jetskis



1 × eFoil



2 × Kayaks



2 × Stand up paddleboards



Wakeboard



Waterskis



Inflatable tows



Fishing gear



Snorkelling gear

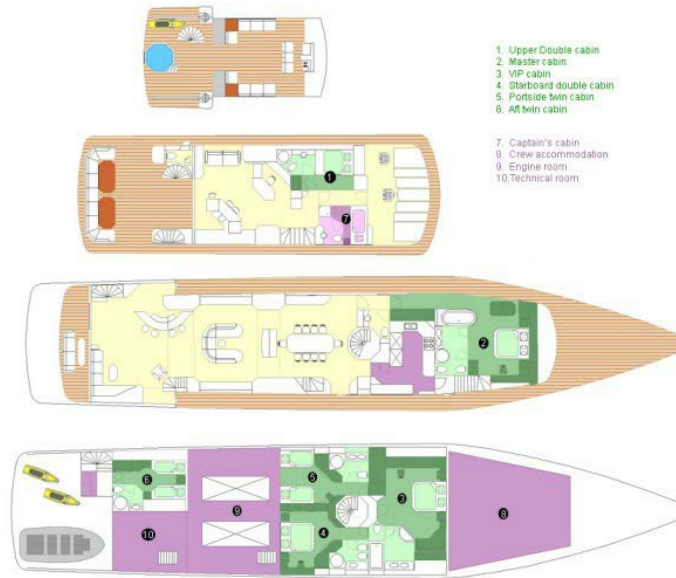

BURGESS

WORLD CLASS. WORLD WIDE.

London +44 20 7766 4300	Monaco +377 97 97 81 21	New York +1 212 223 0410	Miami +1 305 672 0150	Singapore +65 9665 8990	Beverly Hills +1 310 424 5112	Palma +34 971 495 413	Athens +30 210 967 1661
Dubai +971 4 425 5874	Phuket +66 7623 9739	Hong Kong +852 6496 2094	Tokyo +81 46 738 8612	Sydney +61 499 945 557	Mumbai +91 98211 67253	Shanghai +86 187 0898 6800	Rio de Janeiro +55 21 2553-3238

Advertising of these vessel(s) in printed publications, on the internet or in any other medium is not permitted without prior written permission from Burgess. All particulars are given in good faith and are believed correct but they cannot be guaranteed.

Last updated: 10 December 2024