

KING'S LAIR



KING'S LAIR

SPECIFICATIONS.



Prix demandé
USD 16 999 990



Chantier
2023 (refitted 2024), Benetti, Italy



Longueur
34,4m



Largeur
7,7m



Tirant d'eau
2m



Tonnage brut
269



Vitesse de croisière
12 knots



Vitesse maximale
16 knots



Pavillon
Jamaica



Position
USA



Classe
RINA Services S.p.A. (RINA) RINA



Designer extérieur
RWD



Designer d'intérieur
Bonetti/Kozerski Architecture



Construction
Hull - GRP, Superstructure - GRP, Deck - Teak



Équipage
7



Invités
10



Cabines
5 (3 × double, 2 × twin)



Moteurs
2 × 1 361hp MTU



2 × Kohler



Propulsion
Twin screw diesel yacht

Note

Not available for sale to US residents while in US waters.

[Voir le yacht sur le site](#)



KING'S LAIR



KING'S LAIR



BURGESS

Discover the difference.
burgessyachts.com

KING'S LAIR



BURGESS

Discover the difference.
burgessyachts.com

KING'S LAIR



KING'S LAIR



BURGESS

Discover the difference.
burgessyachts.com

KING'S LAIR

APERÇU.

KING'S LAIR is a 34.37 meter (112.9ft) Motor yacht with excellent pedigree. She was built in GRP and Teak decks by Benetti in 2023.

Her exterior was designed by RWD and was made for entertaining. Her main deck aft features an infinity pool, drop down balconies, full-service bar, fire pit, and ample seating. For guests who enjoy sunbathing, there are sun pads located on the stern, bow, and sun deck. KING'S LAIR sun deck also boasts a large al fresco dining table with seating for 10 guests, a BBQ, and an additional full-service bar.

Her interior was beautifully designed by Bonetti and Kozerski Architecture with a main salon surrounded by floor-to-ceiling windows. Her sun-soaked main salon features two sofas, a round coffee table, and a large formal dining table forward.

KING'S LAIR is configured to host 10 guests in five cabins. Her full-beam master cabin is located on the main deck and features oversized windows, large TV, desk, and a private en suite bathroom. Guests will find comfort in her two double cabins and two twin cabins located on the lower deck. The separate crew quarters can accommodate seven crewmembers.

Her top speed is 16.0 kn and she boasts a maximum range of 3000.0 nm when navigating at cruising speed, with power coming from two MTU diesel engines.

Principales caractéristiques

Built in 2023 by Benetti

Interior configured to host 10 guests in five cabins

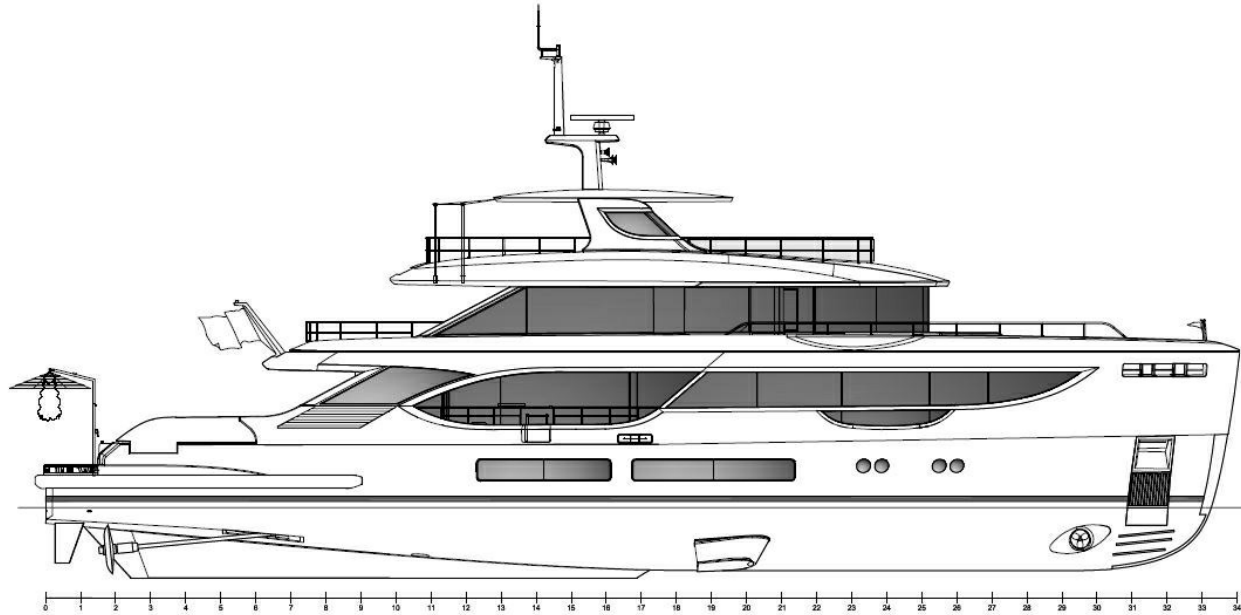

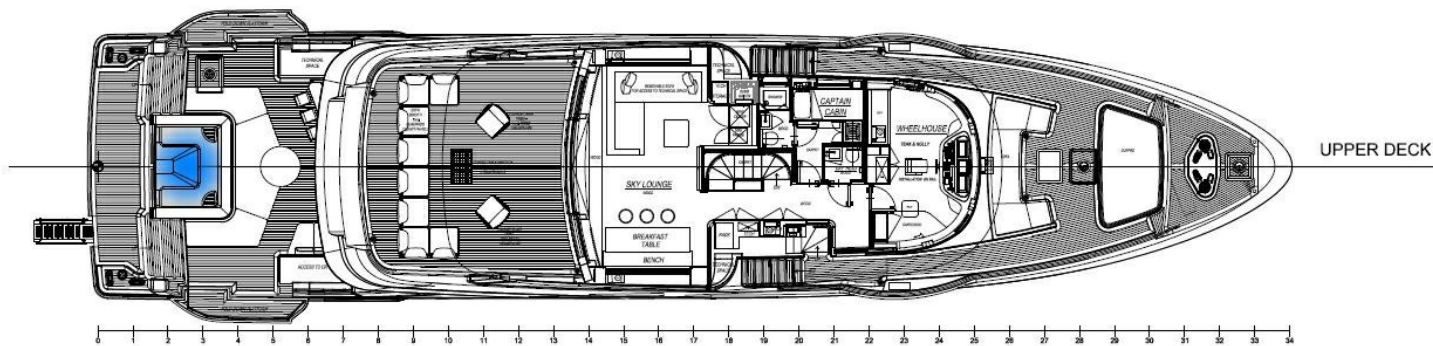
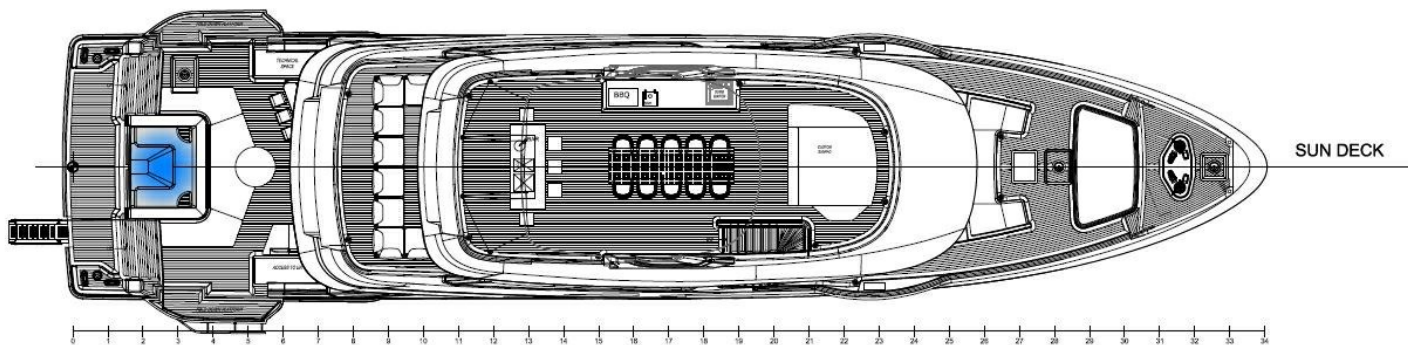

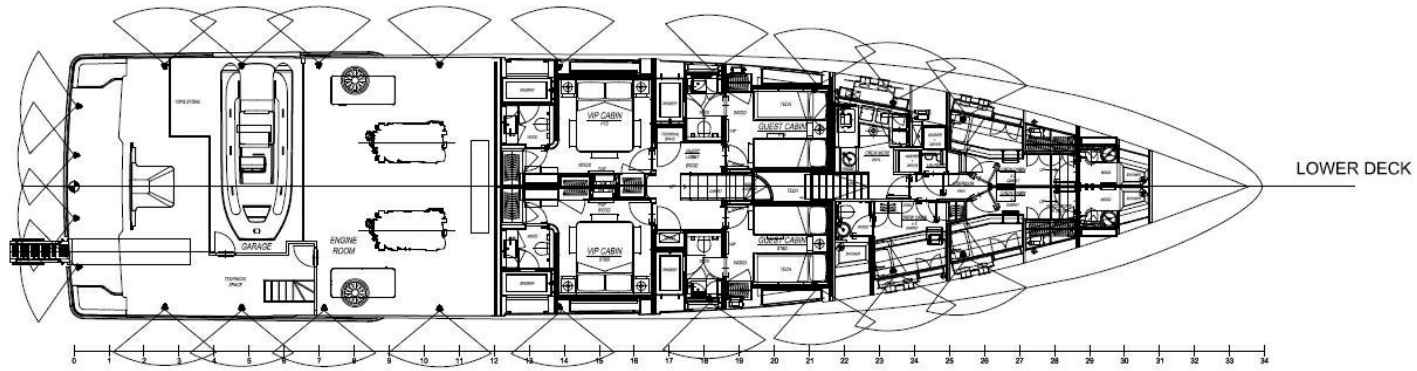
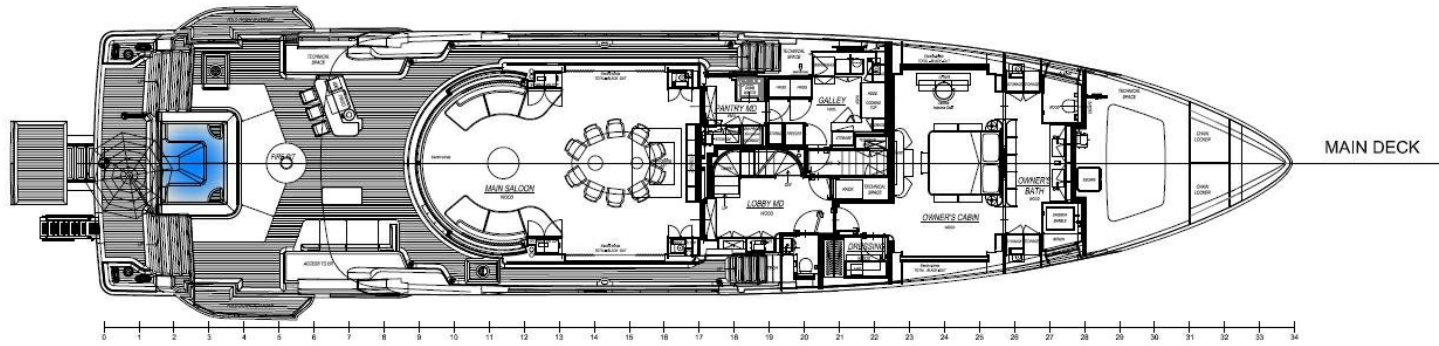

BURGESS

WORLD CLASS. WORLD WIDE.

London +44 20 7766 4300	Monaco +377 97 97 81 21	New York +1 212 223 0410	Miami +1 305 672 0150	Singapore +65 9665 8990	Beverly Hills +1 310 424 5112	Palma +34 971 495 413	Athens +30 210 967 1661
Dubai +971 4 425 5874	Phuket +66 8257 01150	Hong Kong +852 6496 2094	Tokyo +81 46 738 8612	Sydney +61 499 945 557	Mumbai +91 98211 67253	Shanghai +86 159 0162 1898	Rio de Janeiro +55 21 2553-3238
		Aspen +1 970 710 2294	Guernsey +44 1481 735360	Palm Beach +1 561 973 2768			

La publicité de ce(s) navire(s) dans des publications imprimées, sur Internet ou sur tout autre support n'est pas autorisée sans l'autorisation écrite préalable de Burgess.
Toutes les informations sont données de bonne foi et sont considérées comme exactes, mais elles ne peuvent être garanties.

Dernière mise à jour : 27 mai 2026