

KATHLEEN ANNE



KATHLEEN ANNE

APERÇU.

KATHLEEN ANNE has an elegant, contemporary profile. Her high forward bow reflects the overall clean lines of the vessel. The modern exterior comes from the drawing boards of Guido de Groot complemented by her warm and comfortable interior by Bannenberg Design. Her owner, who was closely involved in the project throughout the build, has succeeded in creating the very definition of a family yacht.

Principales caractéristiques

Regularly maintained

Flexible cabin configurations

Exercise equipment

Shaded deck dining & deck areas

Jacuzzi on the sun deck

Zero speed stabilisers to reduce any rolling motion while at anchor

KATHLEEN ANNE

Sun deck



Bridge deck aft



Main deck aft



Foredeck sun pads



KATHLEEN ANNE

Main deck lounge



Main deck lounge



Detail



Main deck dining area



KATHLEEN ANNE

Sky lounge



Sky lounge



Sky lounge



Main deck master cabin



KATHLEEN ANNE

Main deck master cabin



Master bathroom en suite



Convertible VIP double/twin cabin



Convertible VIP double/twin cabin



KATHLEEN ANNE

Lower deck twin cabin



Lower deck twin cabin



Guest bathroom en suite















Stern view



KATHLEEN ANNE

SPECIFICATIONS.

-  Longueur
39m
-  Chantier
2009, Feadship, De Vries, The Netherlands
-  Designer d'intérieur
Bannenberg & Rowell Design
-  Largeur
9,1m
-  Tirant d'eau
2,7m
-  Tonnage brut
437
-  Vitesse de croisière
12 knots
-  Vitesse maximale
13 knots
-  Consommation de carburant en vitesse de croisière
260 litres par heure
-  Moteurs
2 x 1 055hp Caterpillar

-  Invités
8
-  Nb de cabines invités
4 (2 x double, 2 x double/twin)
-  Équipage
7

[Voir le yacht sur le site](#)



KATHLEEN ANNE

ANNEXES & JEUX NAUTIQUES



1 × Tender



2 × Sailing dinghies



1 × Deck jacuzzi



2 × SeaBobs



2 × Kayaks



2 × Stand up paddleboards



Wakeboard



Kneeboard



Waterskis



Inflatable tows



Snorkelling gear

KATHLEEN ANNE

REMISE EN FORME & BIEN-ETRE



Treadmill



Upright stationary bike



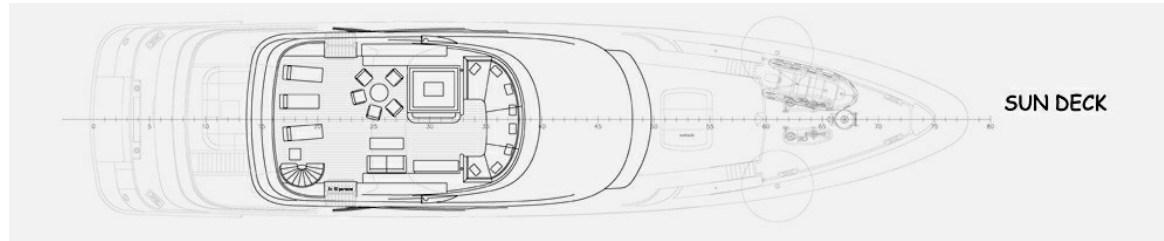

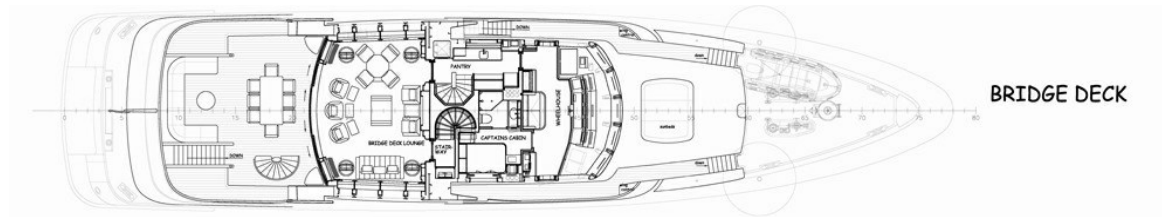

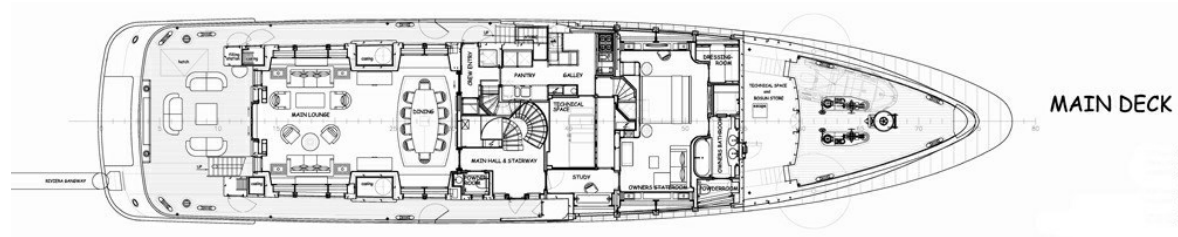

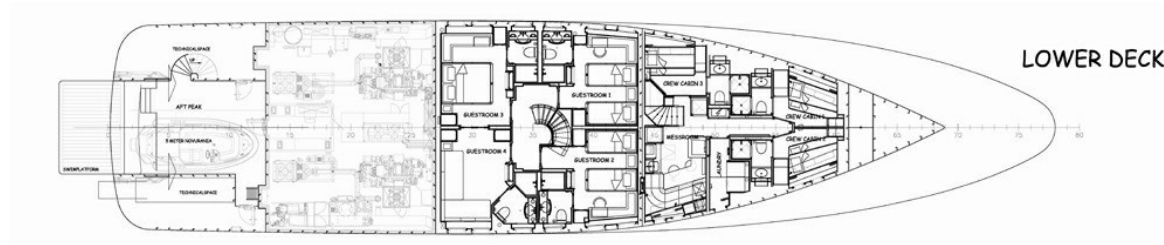

BURGESS

WORLD CLASS. WORLD WIDE.

London +44 20 7766 4300	Monaco +377 97 97 81 21	New York +1 212 223 0410	Miami +1 305 672 0150	Singapore +65 9665 8990	Beverly Hills +1 310 424 5112	Palma +34 971 495 413	Athens +30 210 967 1661
Dubai +971 4 425 5874	Phuket +66 7623 9739	Hong Kong +852 6496 2094	Tokyo +81 46 738 8612	Sydney +61 499 945 557	Mumbai +91 98211 67253	Shanghai +86 187 0898 6800	Rio de Janeiro +55 21 2553-3238
Aspen +1 970 710 2294							

La publicité de ce(s) navire(s) dans des publications imprimées, sur Internet ou sur tout autre support n'est pas autorisée sans l'autorisation écrite préalable de Burgess.
Toutes les informations sont données de bonne foi et sont considérées comme exactes, mais elles ne peuvent être garanties.

Dernière mise à jour : 06 janvier 2025