

# INSPIRATION

---





INSPIRATION

# SPÉCIFICATIONS.



Prix demandé  
USD 14 950 000



Chantier  
2017, Benetti, Italy



Longueur  
38,1m



Largeur  
8,5m



Tirant d'eau  
2,3m



Tonnage brut  
349



Vitesse de croisière  
17,5 knots



Vitesse maximale  
22 knots



Autonomie  
2 000 nm



Pavillon  
Jamaica



Position  
USA



Classe  
RINA, MCA



Designer extérieur  
Stefano Righini



Designer d'intérieur  
RWD



Construction  
Hull - GRP, Superstructure - CFRP, Deck - Teak



Équipage  
7



Invités  
10



Cabines  
5 (4 x double, 1 x twin)



Moteurs  
2 x 2 600hp MTU



Propulsion  
Twin screw diesel yacht

## Note

Not available for sale to US residents while in US waters.

[Voir le yacht sur le site](#)





# INSPIRATION

Main deck lounge



Main deck lounge



Main deck dining area



Main deck foyer





# INSPIRATION

Master cabin



Master cabin



Master cabin fold-down sea terrace



Master cabin walk-in wardrobe





## INSPIRATION

Master cabin en suite her bathroom



Master cabin en suite his bathroom



Lower deck guest foyer



Guest cabin





INSPIRATION

Guest cabin en suite



Guest cabin



Guest cabin en suite



Guest cabin





INSPIRATION

Sky lounge



Sky lounge



Sky lounge



Gym





INSPIRATION

Bridge



Galley



Tender garage



Sun deck





# INSPIRATION

Sun deck



Sun deck



Bridge deck aft



Main deck aft





INSPIRATION

Beach club



Foredeck



Aft decks



At anchor





# INSPIRATION

Aerial view



At anchor



BURGESS

Discover the difference.  
burgessyachts.com





# APERÇU.

INSPIRATION is a 38-metre (125ft) high-volume tri-deck yacht from Benetti, delivered in 2017. Constructed to RINA classification and MCA compliant, she has a full displacement fibreglass hull with a bulbous bow and lightweight carbon fibre composite superstructure. Her contemporary-styled exterior is drawn by Stefano Righini and her clean, crisp interior design is by Redman Whiteley Dixon.

Outside spaces on board include a spacious sundeck with a retractable hardtop bimini; a large Portuguese bridge on the forward coachroof with a large jacuzzi pool, two double sunpads and plenty of seats around twin tables; and a partially shaded upper aft deck set up for dining with ample space for open-air lounge furniture astern. The main deck aft cockpit is a fully shaded lounge with built-in banquettes. Covered companionways run forward to amidships on the main deck and steps lead down from the aft cockpit on both sides of the transom to the beach club in her stern.

Her sundeck has three high chairs up front with a spectacular view, a comfortable lounge opposite a well-equipped bar/grill under the convertible hardtop and a large, full-beam expanse of open-air deck astern.

Her interior volume adds up to 349GT, arranged on three main levels, with accommodation for up to 11 guests in five cabins, plus separate quarters on the lower deck for seven crew. Aft of the bridge on the upper deck there's a dedicated gym and a captain's cabin as well as a large, full-beam skylounge with a bar, sofas and armchairs, and wide-opening doors to the upper aft deck. One level down, the main deck saloon is an elegant, open plan space with a lounge aft and formal dining area forward. The yacht's main galley and pantry are amidships, to port.

The main foyer leads forward on the starboard side to the full-beam master suite, which has its own entrance lobby, walk-in closets, his-and-hers bathrooms with bathtub and shower, and pop-out terraces on both sides. The other four guest cabins – three doubles and a twin – are amidships on the lower deck.

She carries her main tender and two jet skis in a side-launching garage on the lower deck, which provides a buffer between the guest cabins and engine room.

Powered by twin MTU V16 M94 diesels with a combined output of 5,200hp, she cruises at 17.5kts with a maximum range (at long-distance passage speed) of 1,750nm and a top speed of 22kts.

\*Not available for sale to US residents while in US waters

## Principales caractéristiques

Bright and modern interior designed by the talented Redman Whiteley Dixon design team

Accommodation for up to 11 guests in five spacious cabins

Full-beam master cabin with his and hers en suite bathrooms, walk-in wardrobe, and fold-down balconies on both port and starboard side

Side-launching tender garage housing her main tender and two jet skis

Fold-down transom with swim platform and beach club

Fully equipped gym



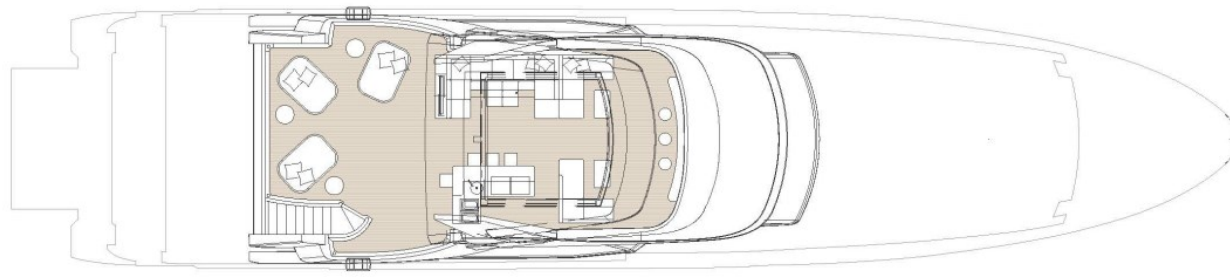

SUN DECK



UPPER DECK



MAIN DECK

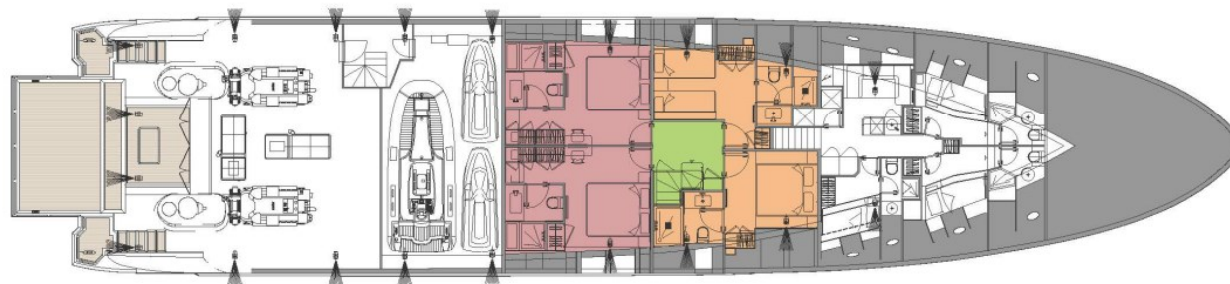

LOWER DECK

■ GUEST AREAS  
 ■ MASTER SUITE  
 ■ VIP SUITE  
 ■ GUEST CABINS  
 ■ GYM  
 ■ JACUZZI



# BURGESS

# WORLD CLASS. WORLD WIDE.

London +44 20 7766 4300	Monaco +377 97 97 81 21	New York +1 212 223 0410	Miami +1 305 672 0150	Singapore +65 9665 8990	Beverly Hills +1 310 424 5112	Palma +34 971 495 413	Athens +30 210 967 1661
Dubai +971 4 425 5874	Phuket +66 7623 9739	Hong Kong +852 6496 2094	Tokyo +81 46 738 8612	Sydney +61 499 945 557	Mumbai +91 98211 67253	Shanghai +86 187 0898 6800	Rio de Janeiro +55 21 2553-3238

---

La publicité de ce(s) navire(s) dans des publications imprimées, sur Internet ou sur tout autre support n'est pas autorisée sans l'autorisation écrite préalable de Burgess.  
Toutes les informations sont données de bonne foi et sont considérées comme exactes, mais elles ne peuvent être garanties.

Dernière mise à jour : 09 mai 2024