

IDYLLE



IDYLLE

APERÇU.

A charter on IDYLLE is quite simply, well, idyllic. Her recently refitted interior creates a serene ambience while her new inventory of water toys and multiple social spaces inside and out provide a sensational base from which to explore the eastern Mediterranean.

Wake from a refreshing sleep and make your way through the capacious main deck lounge, with its sumptuous sofas and large windows inviting in the seascape. The Benetti Classic's interior is immaculately presented thanks to a refit in 2020, with muted tones and warm natural woods creating a relaxed yet elegant mood. IDYLLE's main deck master suite, with its oversized windows and decor in calming hues, has a walk-in wardrobe, private study area, and his and hers bathroom in striking Italian marble. The lower deck features two doubles and two twin cabins, and IDYLLE's stabilisers ensure a comfortable night's sleep is had by all.

Continue outside to the main deck aft for a delectable breakfast served by the attentive interior crew, while the captain joins to discuss the day's plans. Mornings are perfect for high-energy watersports, and the friendly deck crew has all your bases covered. From the infinity island swim platform extension, test your mettle on the two-person jetski, take the plunge with the SeaBob and sea scooter, and try the stand up paddleboards, which are popular with guests of all ages. Turn up the speed with a session on the wakeboards, waterskis and towable inflatables. Or explore a snorkelling safari with all the family in the glass-clear water, and then it is time to refuel after the morning's exertions.

The crew has set up a private party on a nearby beach, with fun games for the children and refreshing cocktails for the adults. The chef prepares fresh local fish on the BBQ complemented by flavourful salads. Then after lunch, return to IDYLLE for a slower-paced afternoon of relaxation.

The sun deck is a great spot to soak up some rays, with a jacuzzi, sunloungers and sun pads to choose from. Alternatively, cosy up with a film in the sky lounge followed by afternoon tea on the upper deck aft, with its comfortable shaded seating.

After changing for dinner, make your way to the sun deck for spectacular views accompanied by canapes and sundowners. A stunning table has been set for an intimate dinner in the main deck lounge, while the children enjoy their own relaxed dinner and movie night in the sky lounge and upper deck aft.

Principales caractéristiques

Recently refitted

Shaded deck dining and deck areas

Exercise equipment

A crew with local expertise

Jacuzzi on sun deck

IDYLLE

Aerial view



Aerial view



Sun deck



Sun deck jacuzzi

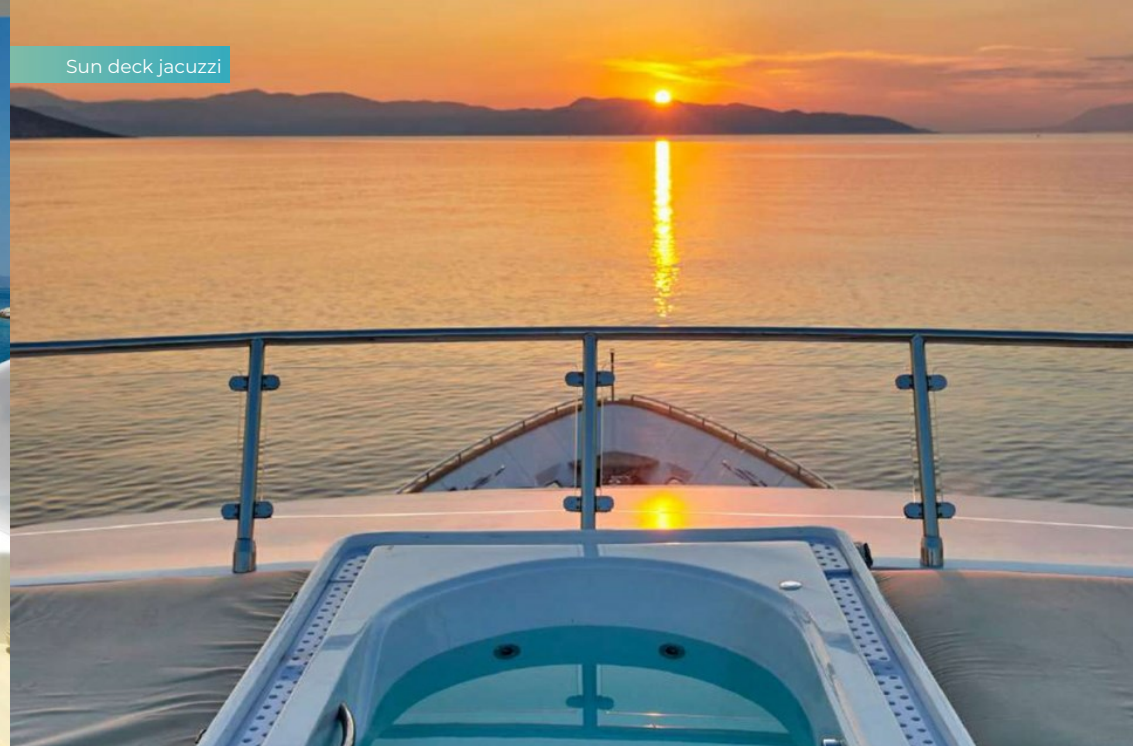

IDYLLE

Sun deck aft



Upper deck aft seating area



Main deck aft dining area



Main deck aft



IDYLLE

Main deck lounge



Main deck lounge



Main deck dining area



Main deck master cabin



IDYLLE

Main deck master cabin



Master bathroom en suite



Master bathroom en suite



Lower deck VIP cabin



IDYLLE

Lower deck twin cabin



Lower deck twin cabin



Aerial view



Waverunner



IDYLLE

At anchor



BURGESS

Discover the difference.
burgessyachts.com



IDYLLE

SPECIFICATIONS.



Longueur
36,8m



Chantier
1996 (refitted 2020), Benetti, Italy



Designer d'intérieur
Arnaboldi



Largeur
7,4m



Tirant d'eau
2,5m



Tonnage brut
279



Vitesse de croisière
11 knots



Vitesse maximale
13 knots



Consommation de carburant en vitesse de croisière
250 litres par heure



Moteurs
2 x 503hp Caterpillar



Invités
10



Nb de cabines invités
5 (3 x double, 2 x twin)



Équipage
7

Note

Fully licensed for charters in Greek waters.

[Voir le yacht sur le site](#)

[Regarder la vidéo du yacht](#)



IDYLLE

ANNEXES & JEUX NAUTIQUES



1 x Tender



1 x Deck jacuzzi



Inflatable platform



1 x Waverunner



2 x SeaBobs



2 x Stand up paddleboards



Wakeboard



Waterskis



Inflatable tows



Fishing gear



Snorkelling gear

IDYLLE

REMISE EN FORME & BIEN-ETRE



Free weights



Yoga mats



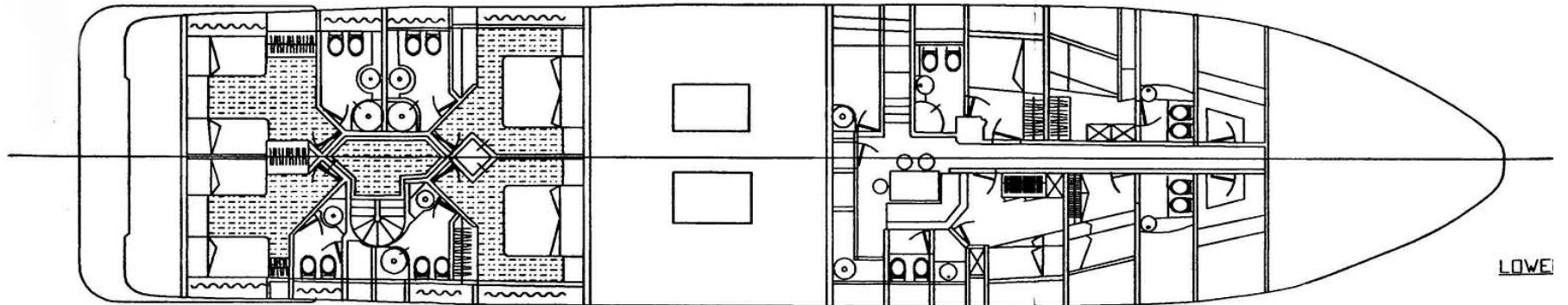
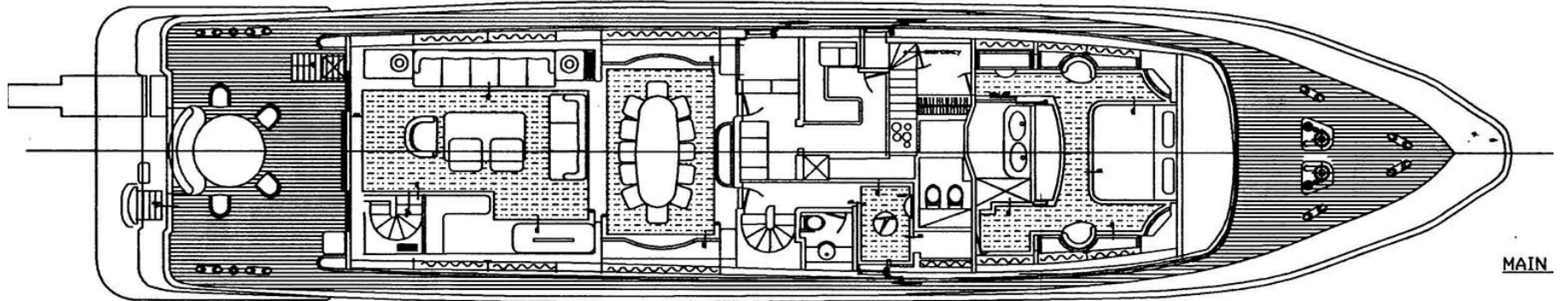
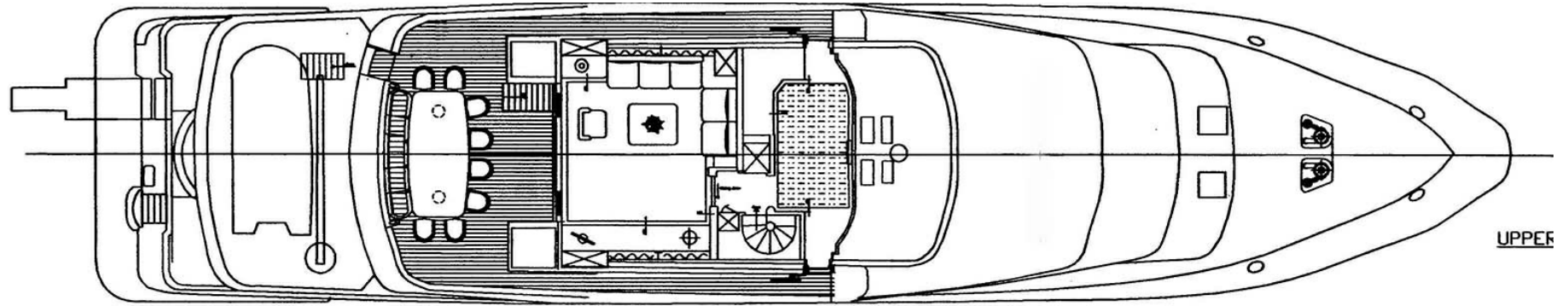

BURGESS

WORLD CLASS.
WORLD WIDE.

London +44 20 7766 4300	Monaco +377 97 97 81 21	New York +1 212 223 0410	Miami +1 305 672 0150	Singapore +65 9665 8990	Beverly Hills +1 310 424 5112	Palma +34 971 495 413	Athens +30 210 967 1661
Dubai +971 4 425 5874	Phuket +66 7623 9739	Hong Kong +852 6496 2094	Tokyo +81 46 738 8612	Sydney +61 499 945 557	Mumbai +91 98211 67253	Shanghai +86 187 0898 6800	Rio de Janeiro +55 21 2553-3238

La publicité de ce(s) navire(s) dans des publications imprimées, sur Internet ou sur tout autre support n'est pas autorisée sans l'autorisation écrite préalable de Burgess.
Toutes les informations sont données de bonne foi et sont considérées comme exactes, mais elles ne peuvent être garanties.

Dernière mise à jour : 10 décembre 2024