

HEMISPHERE



HEMISPHERE

OVERVIEW.

For those looking for something different to the standard charter, something more exciting and adventurous, something unforgettably special that celebrates the ocean and its inhabitants without sacrificing seven-star comfort and service, congratulations. You have just found your next charter.

HEMISPHERE, the world's largest sailing catamaran, is designed to deliver incredible experiences. She has a PADI-certified, Nitrox-capable dive centre for up to 12 guests and Captain Gavin is a qualified dive instructor with encyclopaedic knowledge and infectious passion for marine life in this divers' paradise. There is a 16.4m (53.8ft) sports fishing tender for exploring ashore and reaching special dive sites as well as tournament-standard fishing capabilities.

With a 16.6m (54.5ft) beam, her deck spaces are vast. From her flybridge jacuzzi and al fresco dining areas to her shaded spaces on the main deck aft and the sunbathing trampoline forward where you can watch dolphins play underway, she covers every base for relaxation and entertainment. The two VIP cabins on the main deck each have access to a terrace lounge forward and her award-winning interiors are refined yet instantly welcoming.

HEMISPHERE and her crew live to the maxim 'Sometimes you have to step off the beaten path, for the bigger rewards in life' and relentlessly glowing feedback from delighted guests means they deliver those rewards every time.

'Wow! Once again Captain Gavin you have exceeded our expectations! Our trip was full of surprises and adventure. Truly the best holiday a family could dream of sharing. Thank you for welcoming us back and we look forward to returning next year.'

'You are all amazing. We had such a fabulous week on board, everything about the charter was wonderful. The hospitality of the entire crew was unforgettable, I can't wait to be part of this experience again!'

'I have been on many boats in my 57 years and this holiday has surpassed all of them. The crew are the best we have been with. Sharks, whales, dolphins, sunsets, cocktails, laughter, loads of love -thank you Gavin and crew.'

Key features

Designed for off the beaten track exploration

Two principal suites

Included in price: 16.4m Custom Sports Fishing tender for shore excursions, diving and fishing trips

Certified PADI dive training centre with two dive instructors as part of the crew - guests can become PADI certified whilst on board

Large jacuzzi on the sun deck

Sport tournament standard fishing equipment

Long standing crew with outstanding charter record

Unrivalled deck and interior space in 499 GT

HEMISPHERE

Trampoline



Main deck aft seating area



Main deck aft dining area



Main deck aft dining area



HEMISPHERE

Main deck aft dining area



Main deck lounge



Main deck lounge



Main deck games room



HEMISPHERE

Main deck games room



Main deck VIP cabin



Main deck second VIP cabin



VIP shower room en suite



HEMISPHERE

VIP shower room en suite



Lower deck twin cabin with two pullman beds



Detail



Flybridge jacuzzi



HEMISPHERE

Flybridge dining area and sun pads



Sports fishing boat



Watersports



Stern view



HEMISPHERE

SPECIFICATION.



Length
44.2m (145ft)



Built
2011 (refitted 2023), Pendennis Shipyard, United Kingdom



Interior designer
Michael Leach Design



Beam
16.6m (54.5ft)



Draft min/max
-/3.1m (10.2ft)



Displacement
499 tonnes



Cruising speed
11 knots



Maximum speed
13 knots



Fuel consumption at cruising speed
230 litres per hour



Engines
2 x 490hp Caterpillar



Guests
10/12



No. of guest cabins
5 (4 x double, 1 x twin, 2 x additional berths)



Crew
10

Note

Not available for charter to US residents while in US waters.

[View yacht on website](#)

[Watch yacht video](#)



EQUIPMENT.

Tenders & toys



1 x Towed tender



2 x Tenders



1 x Sailing dinghy



1 x Deck jacuzzi



Diving board



Trampoline



Aquapark



Inflatable platform



4 x SeaBobs



1 x Kayak



1 x Stand up paddleboard



Wakeboard



Kneeboard



Windsurfer



Waterskis



Inflatable tows



Dive centre



Scuba diving equipment



Fishing gear



Snorkelling gear

Certified PADI dive centre, 16.4m F&S custom sports fishing boat with 2 x 1150hp engines, 8.2m Scorpion tender with 400hp engine, 4.5m Castoldi jet tender with 125hp, full scuba diving facilities for 12 guests, 4 x SeaBobs, windsurfers, kayak, waterskis, wakeboard, kneeboards & tows, stand up paddleboard, 4.8m inflatable water trampoline, inflatables, 0.5m high 2.4m professional diving board, snorkelling gear, sports tournament standard fishing equipment

Fitness & wellness



Free weights



Yoga mats

Yoga mats, free weights, jacuzzi

Communication & entertainment

Comprehensive audio visual systems, satellite television channels, Satcom & cellular communications facilities, VSAT, Fleet 77, Wi-Fi internet access

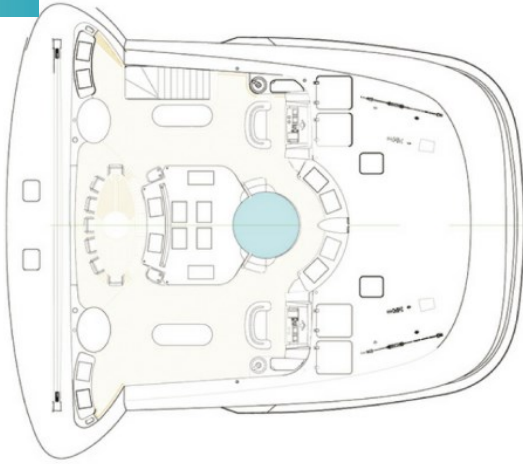

FLYBRIDGE

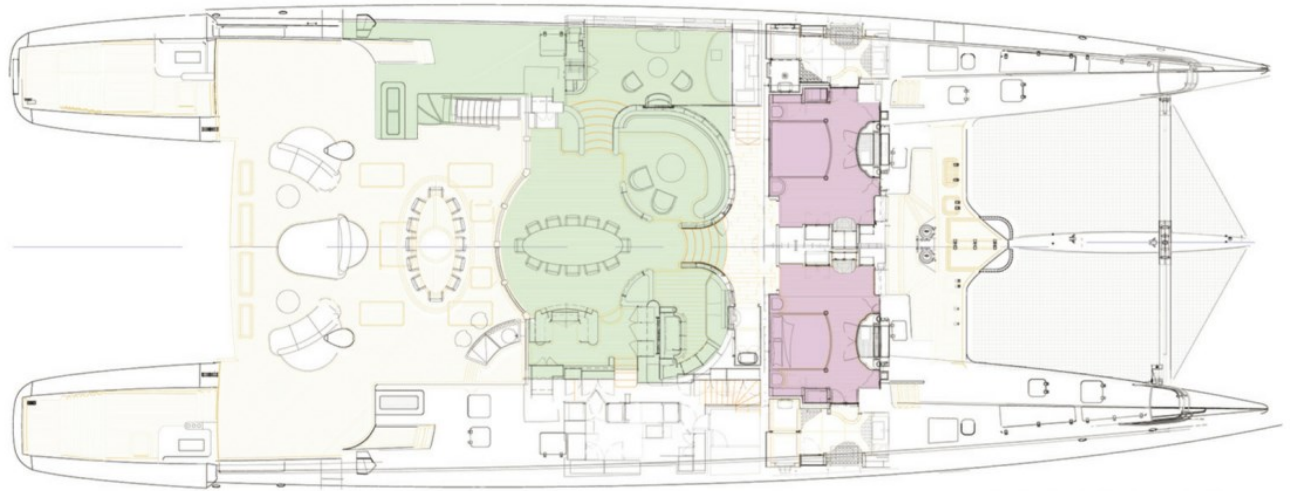

MAIN DECK

KEY:

- Living Areas
- Master/VIP Cabins
- Guest Cabins
- Jacuzzi
- Dive Locker

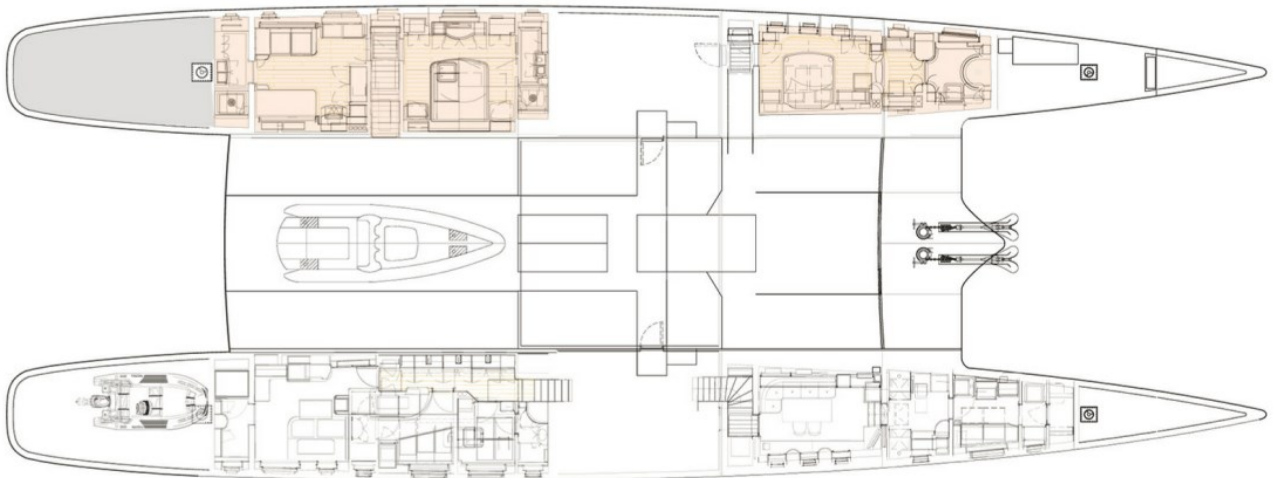

CABIN DECK

BURGESS

WORLD CLASS. WORLD WIDE.

London +44 20 7766 4300	Monaco +377 97 97 81 21	New York +1 212 223 0410	Miami +1 305 672 0150	Singapore +65 9665 8990	Beverly Hills +1 310 424 5112	Palma +34 971 495 413	Athens +30 210 967 1661
	Dubai +971 4 425 5874	Phuket +66 7623 9739	Hong Kong +852 6496 2094	Tokyo +81 46 738 8612	Sydney +61 499 945 557	Mumbai +91 98211 67253	

Advertising of these vessel(s) in printed publications, on the internet or in any other medium is not permitted without prior written permission from Burgess. All particulars are given in good faith and are believed correct but they cannot be guaranteed.

Last updated: 28 March 2024