

HANA



OVERVIEW.

HANA is a graceful and remarkably roomy 43-metre yacht – her interior has the spacious feel of a 50-metre vessel. She has a splendid variety of outside spaces too – on four different levels including the large, air-conditioned gym that opens directly onto her swim platform, so when you've finished your workout you can plunge straight into the sea.

Her tri-deck guest accommodation is designed for 10 or 11 guests, with three double cabins and a twin with a pullman berth as well as the full-beam master suite at the forward end of the main deck, which has its own separate study and private open-air space. There's a highly experienced nine-strong crew on board to take care of all your needs, led by a longstanding captain.

She's an excellent choice of charter yacht for a family holiday with a relaxed, welcoming feel. There's a good choice of large sociable spaces where everyone can enjoy being together, but also plenty of scope for people to spread out, find a private nook and do their own thing. She's an official RYA watersports training centre with qualified instructors on board, and the wide range of water toys in her inventory includes a good choice of activities and equipment for all ages.

She's also an exceptional party boat with a vast sundeck that's ideal for hosting events. The sunpads around the jacuzzi are a brilliant open-air social space and there's also a sit-up bar, a versatile area of modular seating, two big C-shaped sofas and some sun loungers, too.

One level down, there's a large outdoor dining space in full shade and a comfortable lounge area for sundowners on the upper aft deck and a seating area in front of the bridge, nicely separate from the other guest areas. The main deck aft is a spacious lounge with sofas in both sun and shade, so in total there are five different outside spaces available for a big gathering.

Her interior style is contemporary-classic, with a very high standard of finish throughout. The main deck saloon is a roomy and welcoming sitting room with a partially separate space for formal dining. The upper saloon serves a dual purpose as a smart-casual cocktail bar and family TV room.

The master suite is a tranquil haven, The office provides a buffer zone between the main cabin and the rest of the yacht, as well as a useful place to deal with any work that can't wait. There's a private outdoor terrace on one side of the cabin, and an opulent marble bathroom.

Key features

Regularly maintained

Private master balcony

Fully equipped gym

Jacuzzi on the sun deck

Zero speed stabilisers to reduce any rolling motion while at anchor

HANA

At anchor



Aerial view



Sun deck jacuzzi



Sun deck aft seating area and loungers

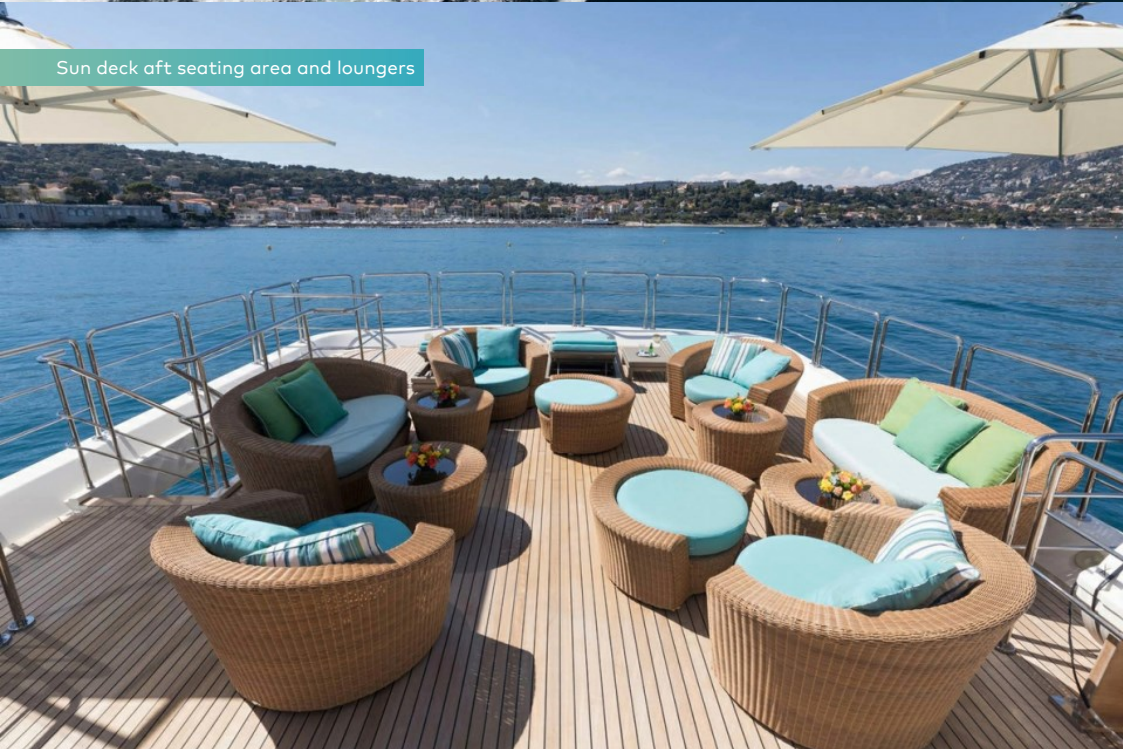

BURGESS

Discover the difference.
burgessyachts.com



HANA

Sun deck aft seating area and loungers



Sun deck aft seating area and loungers



Upper deck aft dining area



Upper deck aft seating area



HANA

Main deck aft seating area



Main deck lounge



Main deck lounge



Main deck dining area



BURGESS

Discover the difference.
burgessyachts.com



HANA

SPECIFICATION.



Length
42.6m (139.7ft)



Built
2008 (refitted 2019), CRN Ancona, Italy



Interior designer
Zuccon International Project/Laura Pomponi



Beam
8.7m (28.5ft)



Draft
2.4m (7.9ft)



Gross tonnage
453



Cruising speed
10 knots



Maximum speed
13 knots



Fuel consumption at cruising speed
220 litres per hour



Engines
2 x 1,399hp Caterpillar



Guests
11



No. of guest cabins
5 (4 x double, 1 x twin, 1 x additional berths)



Crew
10

[View yacht on website](#)



EQUIPMENT.

Tenders & toys



2 x Tenders



1 x Deck jacuzzi



Trampoline



RYA training centre for jetskis
& waverunners



1 x Waverunner



1 x Stand up jetski



2 x SeaBobs



1 x eFoil



2 x Stand up paddleboards



Wakeboard



Kneeboard



Waterskis



Inflatable tows



Snorkelling gear

Fitness & wellness



Free weights



Jump ropes



Resistance bands



Training bench



Treadmill



Yoga mats



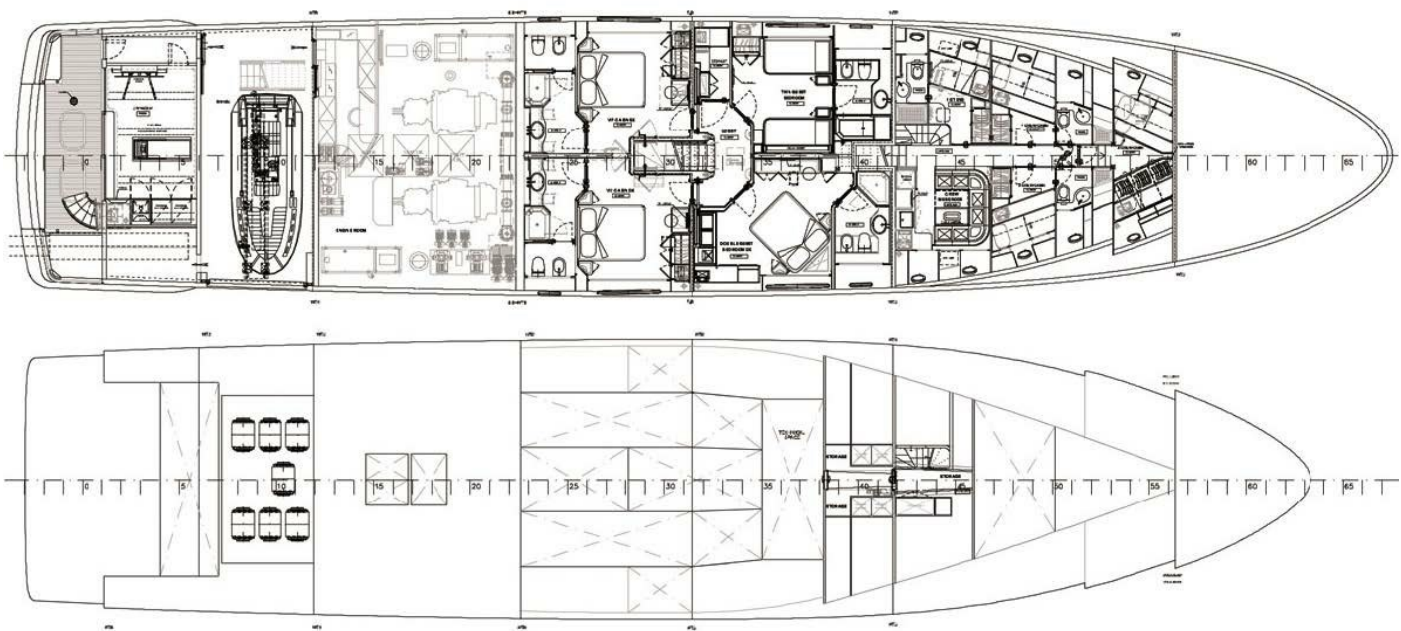

HANA

Sun, upper and main decks

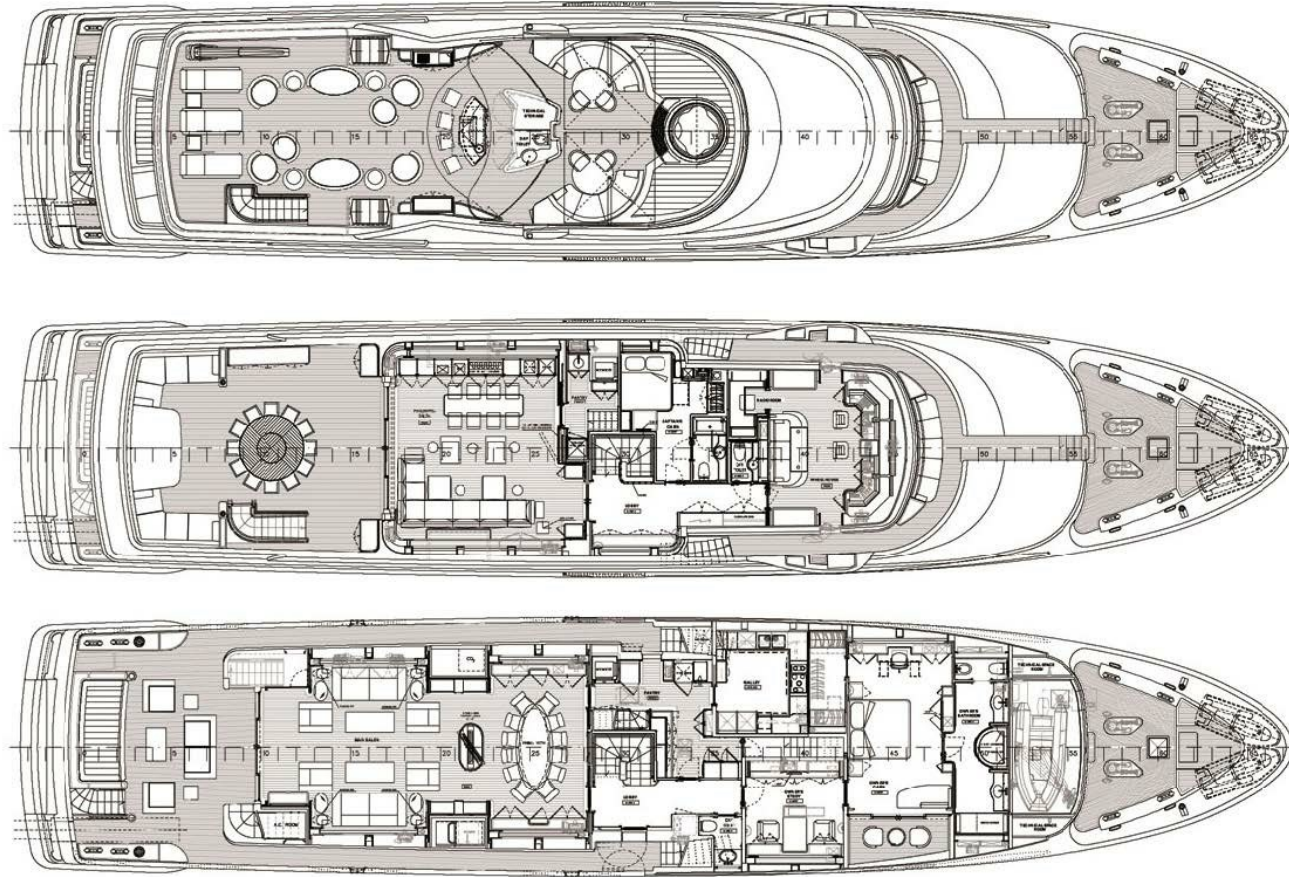

BURGESS

WORLD CLASS. WORLD WIDE.

London +44 20 7766 4300	Monaco +377 97 97 81 21	New York +1 212 223 0410	Miami +1 305 672 0150	Singapore +65 9665 8990	Beverly Hills +1 310 424 5112	Palma +34 971 495 413	Athens +30 210 967 1661
	Dubai +971 4 425 5874	Phuket +66 7623 9739	Hong Kong +852 6496 2094	Tokyo +81 46 738 8612	Sydney +61 499 945 557	Mumbai +91 98211 67253	

Advertising of these vessel(s) in printed publications, on the internet or in any other medium is not permitted without prior written permission from Burgess. All particulars are given in good faith and are believed correct but they cannot be guaranteed.

Last updated: 01 March 2024