

GRAN FINALE



GRAN FINALE

SPÉCIFICATIONS.



Prix demandé
USD 14 950 000



Chantier
2002 (refitted 2018), Delta Marine, United States Of America



Longueur
44,8m



Largeur
8,7m



Tirant d'eau
2,4m



Tonnage brut
451



Vitesse de croisière
15 knots



Vitesse maximale
20 knots



Autonomie
4 000 nm



Pavillon
St Vincent & the Grenadines



Position
USA



Designer extérieur
Delta Design Group/Jay Miner



Designer d'intérieur
Espinosa Yacht Design



Construction
Hull - GRP, Superstructure - GRP, Deck - Teak



Équipage
8



Invités
12



Cabines
5 (3 x double, 2 x twin, 2 x additional berths)



Moteurs
2 x 2 481hp Caterpillar



Propulsion
Twin screw diesel yacht

[Voir le yacht sur le site](#)



GRAN FINALE

Main deck lounge



Main deck lounge bar



Main deck lounge



Main deck dining area



GRAN FINALE

Main deck Chihuly wall



Master study



Master cabin



Master cabin



GRAN FINALE

Master cabin en suite bathroom



Lower deck guest foyer



VIP cabin



VIP cabin en suite bathroom



GRAN FINALE

Twin cabin



Twin cabin en suite bathroom



VIP cabin



VIP cabin settee



GRAN FINALE

VIP cabin en suite bathroom



Twin cabin



Twin cabin en suite bathroom



Elevator

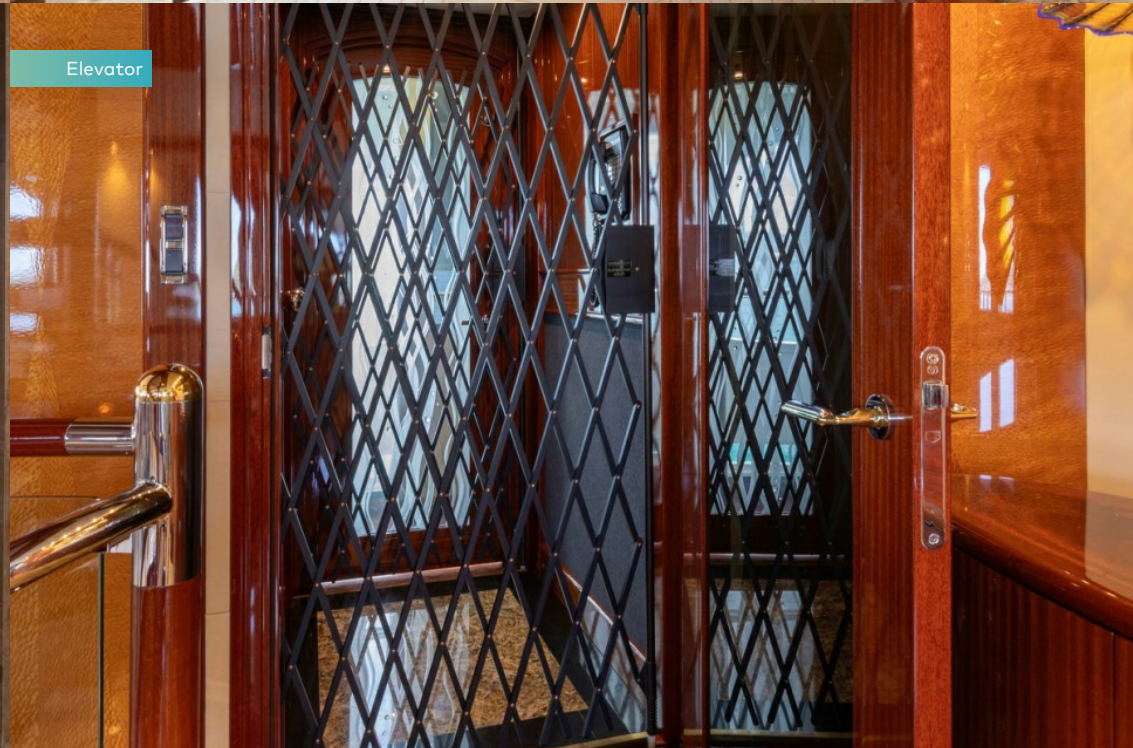

GRAN FINALE

Stairwell



Sky lounge



Sky lounge



Bridge



GRAN FINALE

Sky lounge



Sky lounge



Bridge deck aft bar



Bridge deck aft dining area



GRAN FINALE

Bridge deck aft



Sun deck



Sun deck



Cruising



BURGESS

Discover the difference.
burgessyachts.com



GRAN FINALE

Cruising



Cruising



At anchor



Aerial view



BURGESS

Discover the difference.
burgessyachts.com



GRAN FINALE

Engine room



Galley



GRAN FINALE won the Showboats 2003 Award for Best Motor Yacht under 50m. Delivered in 2002, this is a 45m (147ft) full custom tri-deck yacht. GRAN FINALE is constructed in GRP to ABS classification by celebrated Seattle-based shipyard Delta Marine. She features exterior design by the yard's in-house team in collaboration with Jay Miner and interior design is by J.C. Espinosa of Espinosa Yacht Design. Always professionally maintained, the yacht returned to her original build yard for extensive upgrades during a USD 2,500,000 refit in 2018.

Only ever used privately, she was originally conceived and optimized for ocean-going performance and has proved herself crossing the Atlantic & Pacific Oceans on her own bottom several times. GRAN FINALE has cruised extensively in Europe, throughout the South Pacific, Australia and the Maldives. This is thanks to a notably long range of 4,000nm at her passage speed of 12 knots, a high cruising speed of 15 knots, a top speed of 20 knots, low levels of noise and vibration thanks to floating decks and from reliable twin 2,481hp Caterpillar diesel engines and zero speed stabilizers for comfort.

Key exterior features include walkround decks and an open sun deck with a jacuzzi and sunpads, built-in seating and sun loungers. Her spacious upper deck aft has an L-shaped sit-up bar and a dining table shaded by the overhang, plus a BBQ next to an open boat deck. The upper deck features a mini kitchen. The main deck aft has a shaded lounge and dining space and steps lead down to the fishing cockpit & sea-level swim platform. There's also an intimate sunpad tucked away on the bow.

GRAN FINALE has 451GT of internal volume and a glass elevator serves lower to upper decks. The interior is classic and opulent with high ceilings, sculpted shapes, exotic hardwoods, handcrafted Italian furnishings and large expanses of glass. The light, bright main saloon has a marble-topped sit-up bar aft of a spacious lounge with sofas and armchairs. The sky lounge features floor-to-ceiling glass aft and huge picture windows either side and a retractable wall forward closes off the sky lounge from the bridge if desired.

She is designed to host 12 guests in five cabins with separate quarters for eight crew in four cabins. Up forward on the main deck, the full-beam master suite has an oversized king-sized bed set in high-gloss sapele and lacewood, and an open-plan en suite bathroom with onyx finishes and a two-person spa bath. The other four guest cabins, midships on the lower deck, are two VIP double cabins and two twin cabins with pullmans, all en suite.

She carries a 6.5m (21ft) Castoldi jet RIB tender with a V6 inboard diesel engine. Her inventory of toys includes a jetboard, two SeaBobs, two kayaks, two paddleboards and a Nautibuoy platform, plus a dive compressor and gear and extensive fishing equipment.

Principales caractéristiques

Accommodation for 12 guests in five well appointed cabins

Extensive refit completed at Delta in 2018

Extensive worldwide cruising history

Only used privately since new

Impressive cruising speed of 15 knots and a maximum speed of 20 knots

Glass elevator services lower and upper decks

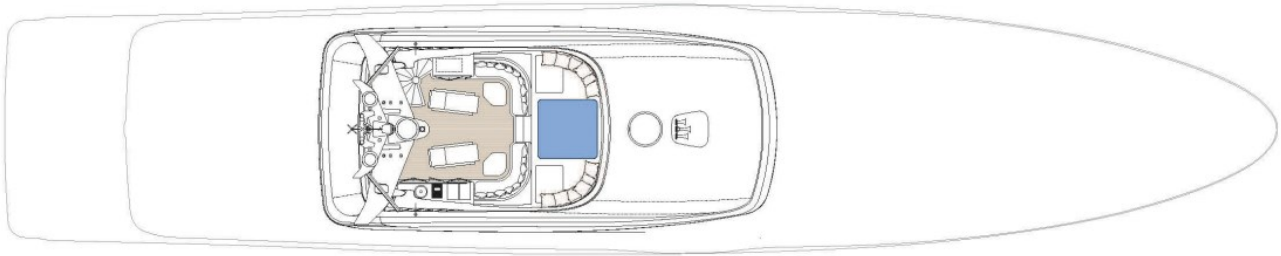

SUN DECK

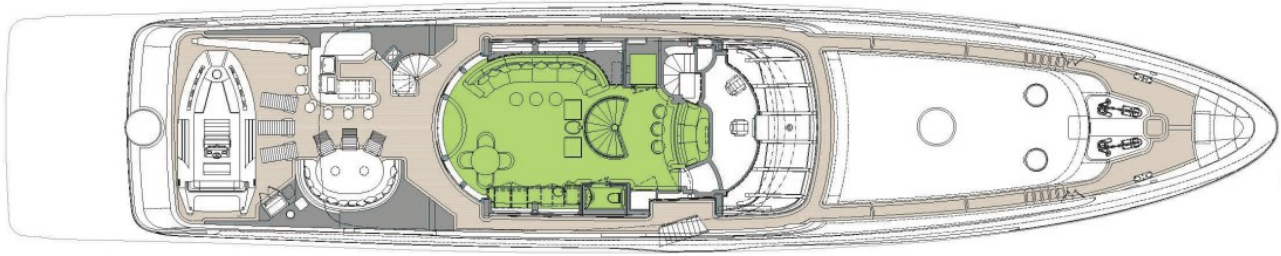

BOAT DECK

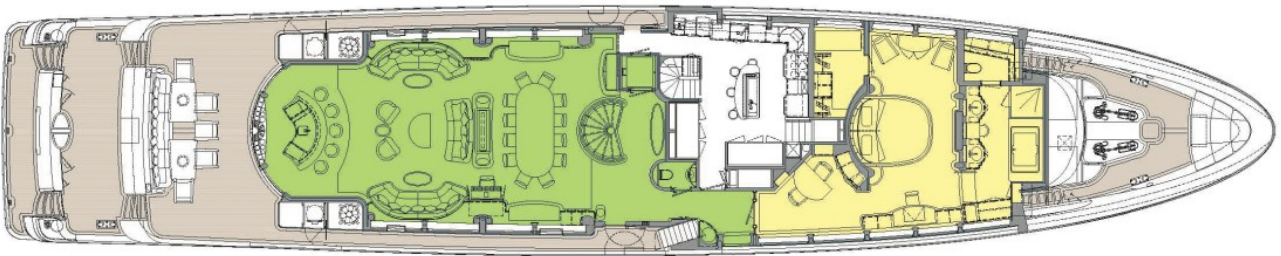

MAIN DECK

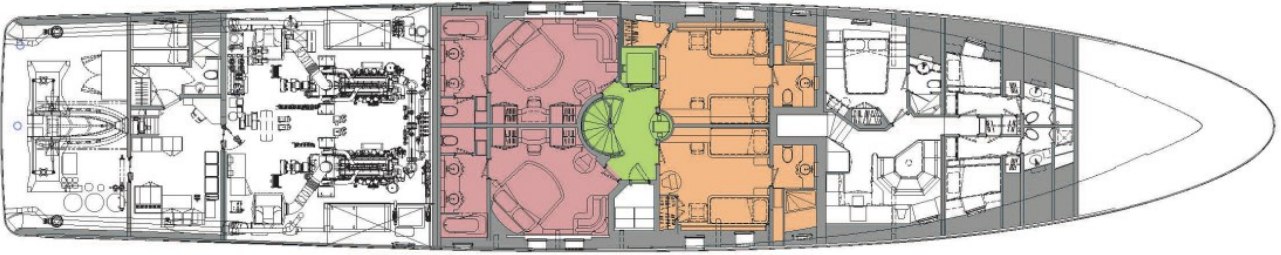

LOWER DECK

■ GUEST AREAS ■ MASTER SUITE ■ VIP SUITE ■ GUEST CABINS ■ JACUZZI

BURGESS

WORLD CLASS. WORLD WIDE.

| | | | | | | | |
|----------------------------|----------------------------|-----------------------------|-----------------------------|----------------------------|----------------------------------|---------------------------|----------------------------|
| London +44 20 7766 4300 | Monaco +377 97 97 81 21 | New York +1 212 223 0410 | Miami +1 305 672 0150 | Singapore +65 9665 8990 | Beverly Hills +1 310 424 5112 | Palma +34 971 495 413 | Athens +30 210 967 1661 |
| | Dubai +971 4 425 5874 | Phuket +66 7623 9739 | Hong Kong +852 6496 2094 | Tokyo +81 46 738 8612 | Sydney +61 499 945 557 | Mumbai +91 98211 67253 | |

La publicité de ce(s) navire(s) dans des publications imprimées, sur Internet ou sur tout autre support n'est pas autorisée sans l'autorisation écrite préalable de Burgess.
Toutes les informations sont données de bonne foi et sont considérées comme exactes, mais elles ne peuvent être garanties.

Dernière mise à jour : 20 mars 2024