

G-FORCE



G-FORCE

SPECIFICATION.



Asking price
Price on application



Built
2006, Heesen, The Netherlands



Length
38m (124.6ft)



Beam
7.5m (24.6ft)



Draft
2.2m (7.2ft)



Gross tonnage
245



Cruising speed
22 knots



Maximum speed
31 knots



Flag
Isle of Man



Lying
West Mediterranean



Class
American Bureau of Shipping (ABS) + A1, AMS, MCA



Exterior designer
Omega Architects



Interior designer
Jean-Pierre Gilardino



Construction
Hull - Aluminium, Superstructure - Aluminium, Deck - Teak



Crew
6



Guests
12



Cabins
5 (4 × double, 1 × twin, 2 × additional berths)



Engines
2 × 3,648hp MTU



Generators
2



Propulsion
Twin screw diesel yacht

[View yacht on website](#)

[Watch yacht video](#)



G-FORCE

Main deck lounge and bar



Main deck saloon



Main deck lounge



Main deck dining area



G-FORCE

Guest double cabin



Master cabin en suite



Guest double cabin



Guest double cabin



G-FORCE

Ariel view



Cruising



Cruising



Cruising



BURGESS

Discover the difference.
burgessyachts.com

G-FORCE

OVERVIEW.

An award-winning, well maintained and lightly used example of Heesen's perennially popular 3700 Series, G Force is a 37-metre (122ft) high-speed yacht with a raised pilothouse and flybridge sundeck. She was delivered by the esteemed Dutch shipyard in 2006. Built in aluminium to ABS classification, her naval architecture and exterior design are a collaboration between Heesen and Omega Architects. She has an excellent charter reputation and is MCA compliant.

Her sundeck – large for a yacht of this type – has a flybridge helm and passenger seating up front, lounge and informal dining areas amidships beneath the arch, and a jacuzzi pool aft surrounded by a semicircle of sunpads. Companionways with steel handrails lead forward from here on both sides of the pilothouse to a large sunpad on the forward coachroof and a seating area built into the foredeck. The main deck aft cockpit has built-in seating astern, around a large drop-leaf teak table.

Her smart, contemporary interior design by Jean-Pierre Gilardino won a World Superyacht Award. She offers 245GT of internal volume, arranged on two main levels to host up to 12 guests on board in five cabins with separate quarters for up to six crew. The main deck saloon has an elegant, circular dining space aft with a 10-seat oval table under a chandelier and floor-to-ceiling glass astern. The lounge area is forward with L-shaped sofas and chairs. The yacht's main guest lobby, day heads and galley are amidships on the main deck.

The master suite is up front on the main deck with an entrance hallway leading into a full-beam cabin with a sofa and a king size bed on the centreline, facing forwards. Its en suite bathroom has twin sinks and a large, central bathtub as well as a separate shower. The other four guest cabins, located amidships on the lower deck, are three doubles and a twin with extra pullman berths, all with private en suite bathrooms. The crew's quarters are in the bow of the lower deck with separate access via the galley.

A twin-screw vessel propelled by a pair of 3648hp MTU 16V4000 M90 diesels, she has an impressive top speed of 31kts and cruises comfortably at 22kts with a 948-mile maximum range. She carries a 5.6m Nautica jet tender with a 285hp engine in her stern garage, which also has space for a jet ski.

Key features

World Superyacht Award winning Jean Pierre Gilardino designed interior

Capable of speeds up to 31 kts

Vast sundeck with Jacuzzi pool

Twin MTU 16V4000 M90 engines

MCA LY2 compliant and exceptional charter reputation

Seakeeper Gyros installed making her the only 3700 available with zero speeds

Tenders

5.6m Nautica jet tender with 285hp engine

G-FORCE

Deck plans

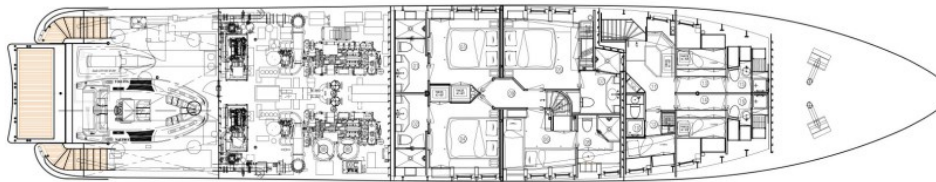
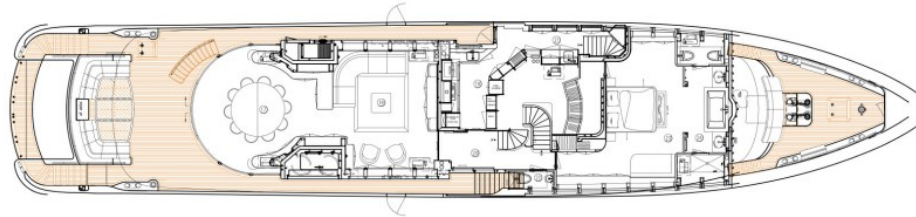
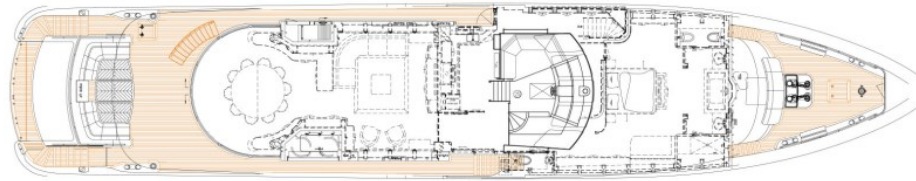
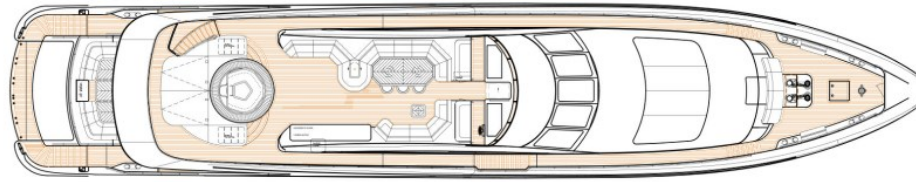
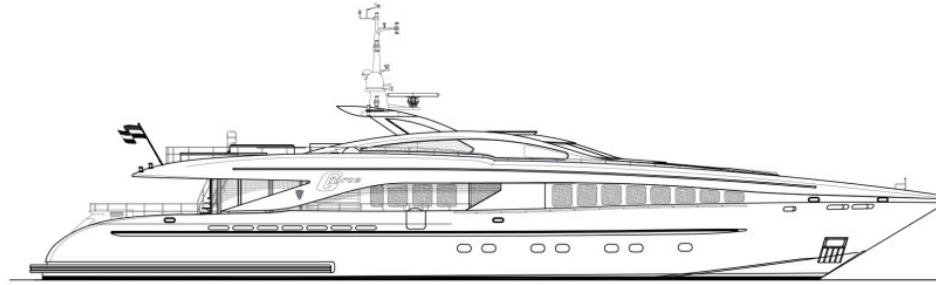

BURGESS

WORLD CLASS. WORLD WIDE.

London +44 20 7766 4300	Monaco +377 97 97 81 21	New York +1 212 223 0410	Miami +1 305 672 0150	Singapore +65 9665 8990	Beverly Hills +1 310 424 5112	Palma +34 971 495 413	Athens +30 210 967 1661
Dubai +971 4 425 5874	Phuket +66 8257 01150	Hong Kong +852 6496 2094	Tokyo +81 46 738 8612	Sydney +61 499 945 557	Mumbai +91 98211 67253	Shanghai +86 159 0162 1898	Rio de Janeiro +55 21 2553-3238
		Aspen +1 970 710 2294	Guernsey +44 1481 735360	Palm Beach +1 561 973 2768			

Advertising of these vessel(s) in printed publications, on the internet or in any other medium is not permitted without prior written permission from Burgess. All particulars are given in good faith and are believed correct but they cannot be guaranteed.

Last updated: 05 May 2026