

# G-FORCE

---





# G-FORCE SPÉCIFICATIONS.



Prix demandé  
EUR 6 950 000



Chantier  
2006, Heesen, The Netherlands



Longueur  
38m



Largeur  
7,5m



Tirant d'eau  
2,2m



Tonnage brut  
245



Vitesse de croisière  
22 knots



Vitesse maximale  
31 knots



Autonomie  
948 nm



Pavillon  
Isle of Man



Position  
West Mediterranean



Classe  
ABS + A1, AMS, MCA



Designer extérieur  
Omega Architects



Designer d'intérieur  
Jean-Pierre Gilardino



Construction  
Hull - Aluminium, Superstructure - Aluminium,  
Deck - Teak



Équipage  
6



Invités  
12



Cabines  
5 (4 x double, 1 x twin, 2 x additional berths)



Moteurs  
2 x 3 648hp MTU



Propulsion  
Twin screw diesel yacht

[Voir le yacht sur le site](#)

[Regarder la vidéo du yacht](#)





# G-FORCE

Main deck lounge and bar



Main deck saloon



Main deck lounge



Main deck dining area





G-FORCE

Guest double cabin



Master cabin en suite



Guest double cabin



Guest double cabin





G-FORCE

Ariel view



Cruising



Cruising



Cruising



BURGESS

Discover the difference.  
burgessyachts.com



G-FORCE

# APERÇU.

An award-winning, well maintained and lightly used example of Heesen's perennially popular 3700 Series, G Force is a 37-metre (122ft) high-speed yacht with a raised pilothouse and flybridge sundeck. She was delivered by the esteemed Dutch shipyard in 2006. Built in aluminium to ABS classification, her naval architecture and exterior design are a collaboration between Heesen and Omega Architects. She has an excellent charter reputation and is MCA compliant.

Her sundeck – large for a yacht of this type – has a flybridge helm and passenger seating up front, lounge and informal dining areas amidships beneath the arch, and a jacuzzi pool aft surrounded by a semicircle of sunpads. Companionways with steel handrails lead forward from here on both sides of the pilothouse to a large sunpad on the forward coachroof and a seating area built into the foredeck. The main deck aft cockpit has built-in seating astern, around a large drop-leaf teak table.

Her smart, contemporary interior design by Jean-Pierre Gilardino won a World Superyacht Award. She offers 245GT of internal volume, arranged on two main levels to host up to 12 guests on board in five cabins with separate quarters for up to six crew. The main deck saloon has an elegant, circular dining space aft with a 10-seat oval table under a chandelier and floor-to-ceiling glass astern. The lounge area is forward with L-shaped sofas and chairs. The yacht's main guest lobby, day heads and galley are amidships on the main deck.

The master suite is up front on the main deck with an entrance hallway leading into a full-beam cabin with a sofa and a king size bed on the centreline, facing forwards. Its en suite bathroom has twin sinks and a large, central bathtub as well as a separate shower. The other four guest cabins, located amidships on the lower deck, are three doubles and a twin with extra pullman berths, all with private en suite bathrooms. The crew's quarters are in the bow of the lower deck with separate access via the galley.

A twin-screw vessel propelled by a pair of 3648hp MTU 16V4000 M90 diesels, she has an impressive top speed of 31kts and cruises comfortably at 22kts with a 948-mile maximum range. She carries a 5.6m Nautica jet tender with a 285hp engine in her stern garage, which also has space for a jet ski.

## Principales caractéristiques

---

World Superyacht Award winning Jean Pierre Gilardino designed interior

---

Capable of speeds up to 31 kts

---

Vast sundeck with Jacuzzi pool

---

Twin MTU 16V4000 M90 engines

---

MCA LY2 compliant and exceptional charter reputation

---

Seakeeper Gyros installed making her the only 3700 available with zero speeds

---

## Annexes

---

5.6m Nautica jet tender with 285hp engine



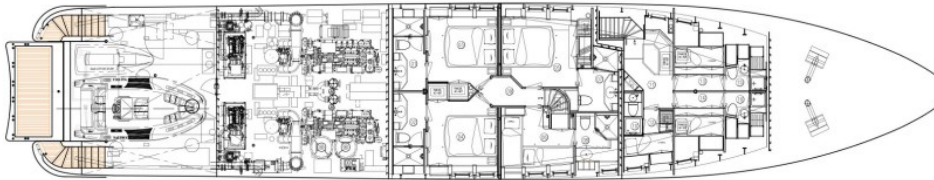
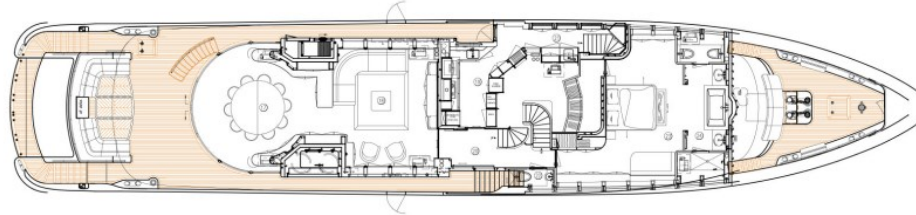
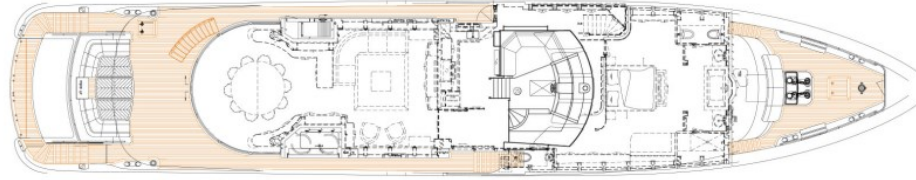
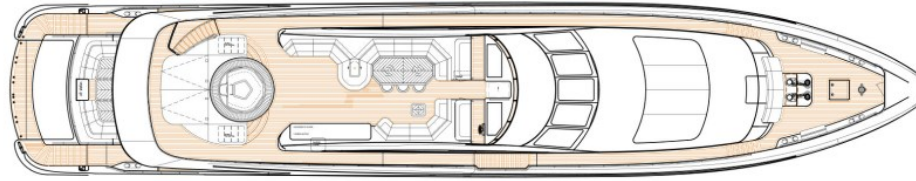
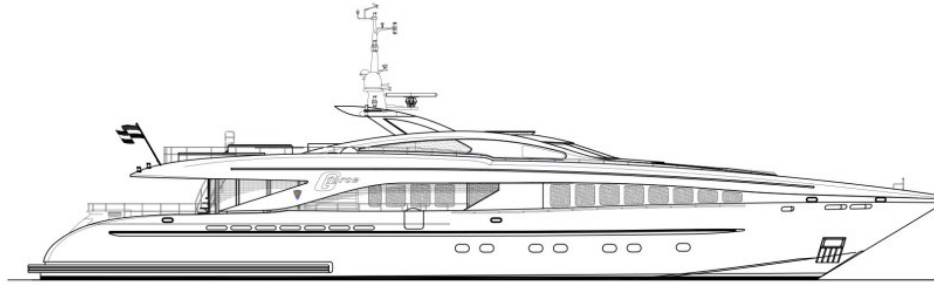

# BURGESS

# WORLD CLASS. WORLD WIDE.

London +44 20 7766 4300	Monaco +377 97 97 81 21	New York +1 212 223 0410	Miami +1 305 672 0150	Singapore +65 9665 8990	Beverly Hills +1 310 424 5112	Palma +34 971 495 413	Athens +30 210 967 1661
Dubai +971 4 425 5874	Phuket +66 7623 9739	Hong Kong +852 6496 2094	Tokyo +81 46 738 8612	Sydney +61 499 945 557	Mumbai +91 98211 67253	Shanghai +86 187 0898 6800	

La publicité de ce(s) navire(s) dans des publications imprimées, sur Internet ou sur tout autre support n'est pas autorisée sans l'autorisation écrite préalable de Burgess.  
Toutes les informations sont données de bonne foi et sont considérées comme exactes, mais elles ne peuvent être garanties.

Dernière mise à jour : 01 mai 2024