

# G-FORCE

---





G-FORCE

# SPECIFICATION.



Asking price  
EUR 6,950,000



Built  
2006, Heesen, The Netherlands



Length  
38m (124.6ft)



Beam  
7.5m (24.6ft)



Draft  
2.2m (7.2ft)



Gross tonnage  
245



Cruising speed  
22 knots



Maximum speed  
31 knots



Range  
948 nm



Flag  
Isle of Man



Lying  
West Mediterranean



Class  
ABS + A1, AMS, MCA



Exterior designer  
Omega Architects



Interior designer  
Jean-Pierre Gilardino



Construction  
Hull - Aluminium, Superstructure - Aluminium,  
Deck - Teak



Crew  
6



Guests  
12



Cabins  
5 (4 x double, 1 x twin, 2 x additional berths)



Engines  
2 x 3,648hp MTU



Propulsion  
Twin screw diesel yacht

[View yacht on website](#)

[Watch yacht video](#)





# G-FORCE

Main deck lounge and bar



Main deck saloon



Main deck lounge



Main deck dining area





G-FORCE

Guest double cabin



Master cabin en suite



Guest double cabin



Guest double cabin





G-FORCE

Ariel view



Cruising



Cruising



Cruising



BURGESS

Discover the difference.  
burgessyachts.com



# OVERVIEW.

An award-winning, well maintained and lightly used example of Heesen's perennially popular 3700 Series, G Force is a 37-metre (122ft) high-speed yacht with a raised pilothouse and flybridge sundeck. She was delivered by the esteemed Dutch shipyard in 2006. Built in aluminium to ABS classification, her naval architecture and exterior design are a collaboration between Heesen and Omega Architects. She has an excellent charter reputation and is MCA compliant.

Her sundeck – large for a yacht of this type – has a flybridge helm and passenger seating up front, lounge and informal dining areas amidships beneath the arch, and a jacuzzi pool aft surrounded by a semicircle of sunpads. Companionways with steel handrails lead forward from here on both sides of the pilothouse to a large sunpad on the forward coachroof and a seating area built into the foredeck. The main deck aft cockpit has built-in seating astern, around a large drop-leaf teak table.

Her smart, contemporary interior design by Jean-Pierre Gilardino won a World Superyacht Award. She offers 245GT of internal volume, arranged on two main levels to host up to 12 guests on board in five cabins with separate quarters for up to six crew. The main deck saloon has an elegant, circular dining space aft with a 10-seat oval table under a chandelier and floor-to-ceiling glass astern. The lounge area is forward with L-shaped sofas and chairs. The yacht's main guest lobby, day heads and galley are amidships on the main deck.

The master suite is up front on the main deck with an entrance hallway leading into a full-beam cabin with a sofa and a king size bed on the centreline, facing forwards. Its en suite bathroom has twin sinks and a large, central bathtub as well as a separate shower. The other four guest cabins, located amidships on the lower deck, are three doubles and a twin with extra pullman berths, all with private en suite bathrooms. The crew's quarters are in the bow of the lower deck with separate access via the galley.

A twin-screw vessel propelled by a pair of 3648hp MTU 16V4000 M90 diesels, she has an impressive top speed of 31kts and cruises comfortably at 22kts with a 948-mile maximum range. She carries a 5.6m Nautica jet tender with a 285hp engine in her stern garage, which also has space for a jet ski.

## Key features

---

World Superyacht Award winning Jean Pierre Gilardino designed interior

---

Capable of speeds up to 31 kts

---

Vast sundeck with Jacuzzi pool

---

Twin MTU 16V4000 M90 engines

---

MCA LY2 compliant and exceptional charter reputation

---

Seakeeper Gyros installed making her the only 3700 available with zero speeds

---

## Tenders

---

5.6m Nautica jet tender with 285hp engine



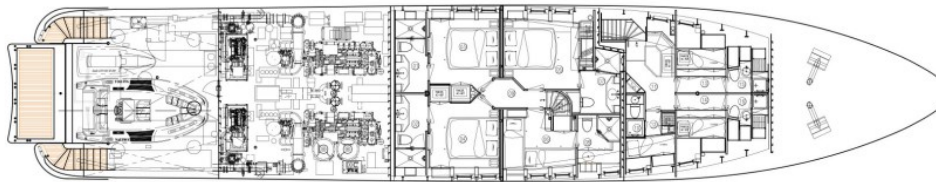
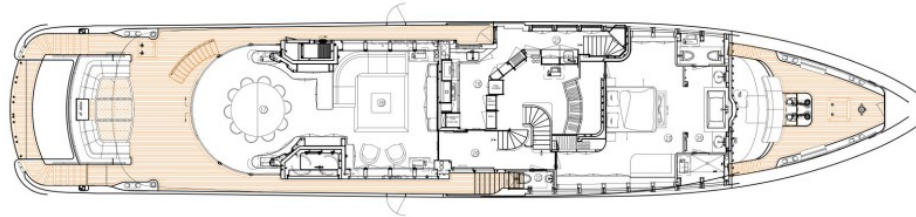
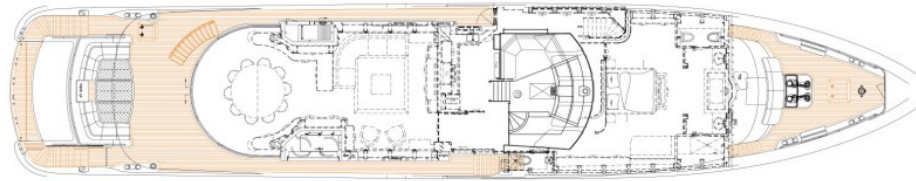
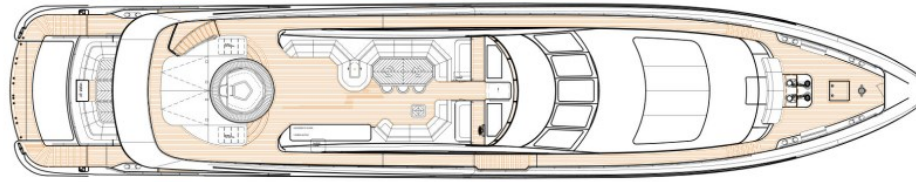
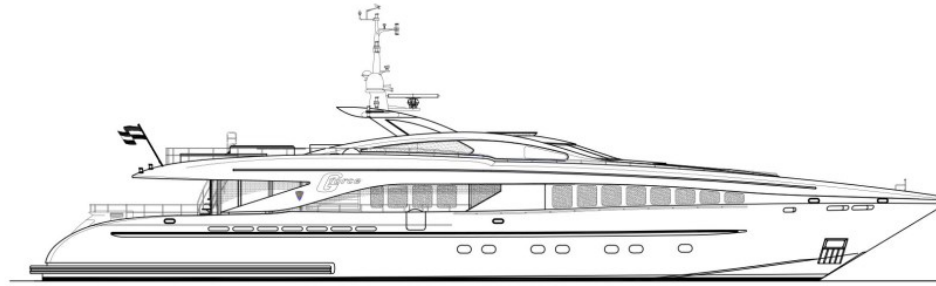

BURGESS

WORLD CLASS.  
WORLD WIDE.

London	Monaco	New York	Miami	Singapore	Beverly Hills	Palma	Athens
+44 20 7766 4300	+377 97 97 81 21	+1 212 223 0410	+1 305 672 0150	+65 9665 8990	+1 310 424 5112	+34 971 495 413	+30 210 967 1661
Dubai	Phuket	Hong Kong	Tokyo	Sydney	Mumbai	Shanghai	
+971 4 425 5874	+66 7623 9739	+852 6496 2094	+81 46 738 8612	+61 499 945 557	+91 98211 67253	+86 187 0898 6800	

---

Advertising of these vessel(s) in printed publications, on the internet or in any other medium is not permitted without prior written permission from Burgess. All particulars are given in good faith and are believed correct but they cannot be guaranteed.

Last updated: 01 May 2024