

# G-FORCE

---



G-FORCE

# APERÇU.

**Speed. Space. Style.** That's what you get when you charter the award-winning G-FORCE.

With a top speed of 31 knots and a cruising speed of 22 knots, this aptly-named sports flybridge yacht is the consummate island-hopper. She will expand your cruising range and the potential of your holiday, as you can go further and see more in the same time, as well as cutting a clean wake on the way.

On arrival the 5.5m Nautica tender continues the speed theme as its 285hp engine lets you explore, get ashore or enjoy the exhilarating tow toys. There's also a three-seater Sea-Doo jetski to add to the high-speed thrills.

Sleeping eight in five cabins, including a full-beam master cabin on the bridge deck, she offers her guests plenty of space. There are sun pads surrounding the sun deck jacuzzi, aft of the shaded lounges, more sun pads on the foredeck and well deck seating where you can feel the adrenaline with the wind in your hair, before enjoying a sundowner at anchor as the sun sets on another day of amazing adventures.

As for style, she is all about high contrast, with the theme of her black-and-white exterior being reflected in Jean-Pierre Gilardino's clean-lined interior, which he described to Boat International as 'simple, contemporary, chic and sophisticated - in essence the style is contemporary with Art Deco touches.' Gilardino's inspired design was recognised with the Interior Design category in the World Superyacht Awards 2007.

Chief among these 1930s touches is the bathroom in the master cabin, where the bevelled mirror and the wall lights perfectly frame the cinematic glamour of the age. Another highlight is the Macassar ebony dining table beneath a Murano-glass chandelier, surrounded by a semi-circle of sliding glass that opens onto the main deck aft.

With six experienced and professional crew to take care of guests' every need, G-FORCE always delivers unforgettable memories of amazing charters.

## Principales caractéristiques

---

**Maximum speed of 32 knots, perfect for thrill-seeking clients!**

---

**Charismatic Captain Jonathan leads a long-standing and highly-skilled crew**

---

**Constantly maintained to extremely high standard, in immaculate condition**

---

G-FORCE

Underway



Main deck lounge



Main deck saloon



Main deck lounge



BURGESS

Discover the difference.  
[burgessyachts.com](http://burgessyachts.com)



G-FORCE

Main deck dining area



Main deck lounge and bar



Main deck dining area



Master cabin



G-FORCE

Guest double cabin



Master cabin study



Master cabin en suite



Guest double cabin



## G-FORCE

Guest double cabin



Guest cabin en suite



Cruising



BURGESS

Discover the difference.  
burgessyachts.com



# G-FORCE SPÉCIFICATIONS.



Longueur  
38m



Chantier  
2006, Heesen, The Netherlands



Designer d'intérieur  
Jean-Pierre Gilardino



Largeur  
7,5m



Tirant d'eau  
2,2m



Tonnage brut  
245



Vitesse de croisière  
22 knots



Vitesse maximale  
31 knots



Consommation de carburant en vitesse de croisière  
220 litres par heure



Moteurs  
2 x 3 648hp MTU



Invités  
8



Nb de cabines invités  
5 (4 x double, 1 x twin, 2 x additional berths)



Équipage  
6

## Note

Fully licensed for charters in Spanish waters. Not available for charter to US residents while in US waters.

[Voir le yacht sur le site](#)

[Regarder la vidéo du yacht](#)



## Annexes & jeux nautiques

---



1 x Tender



1 x Deck jacuzzi



1 x Stand up jetski



1 x Kayak



Wakeboard



Waterskis



Inflatable toys

5.5m Nautica jet tender with 285hp engine | 1 x Sea-Doo waverunner (3 man) jetski | Kayak | Waterskis & toys



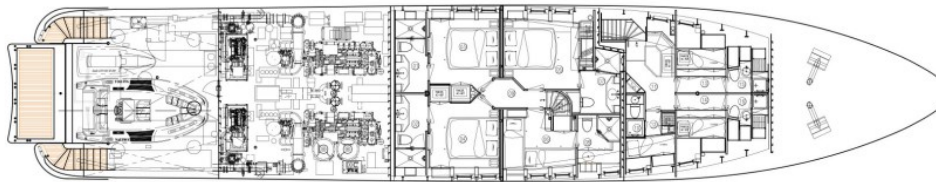
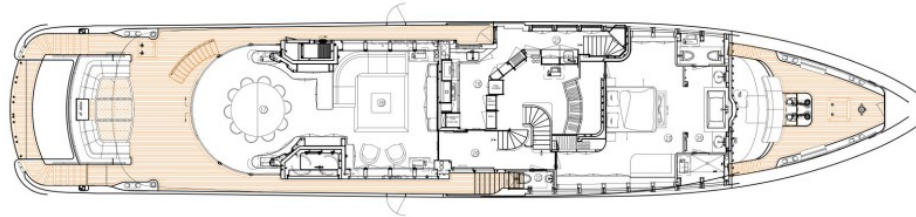
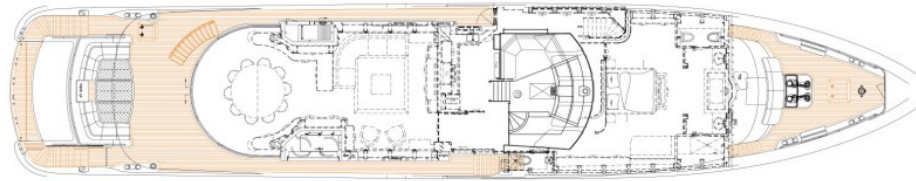
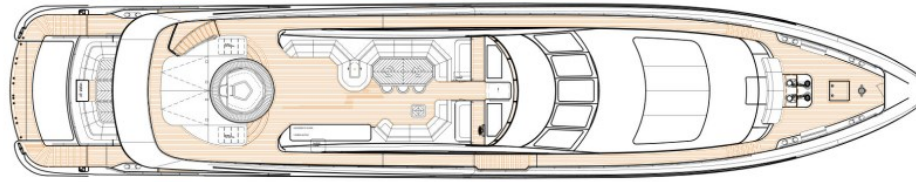
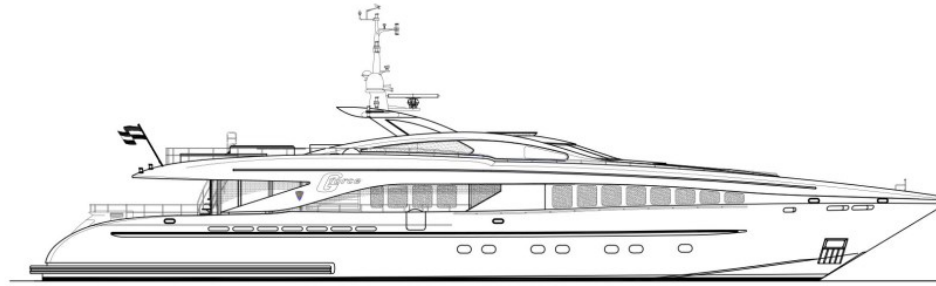

BURGESS

WORLD CLASS.  
WORLD WIDE.

London	Monaco	New York	Miami	Singapore	Beverly Hills	Palma	Athens
+44 20 7766 4300	+377 97 97 81 21	+1 212 223 0410	+1 305 672 0150	+65 9665 8990	+1 310 424 5112	+34 971 495 413	+30 210 967 1661
Dubai	Phuket	Hong Kong	Tokyo	Sydney	Mumbai	Shanghai	
+971 4 425 5874	+66 7623 9739	+852 6496 2094	+81 46 738 8612	+61 499 945 557	+91 98211 67253	+86 187 0898 6800	

La publicité de ce(s) navire(s) dans des publications imprimées, sur Internet ou sur tout autre support n'est pas autorisée sans l'autorisation écrite préalable de Burgess.  
Toutes les informations sont données de bonne foi et sont considérées comme exactes, mais elles ne peuvent être garanties.

Dernière mise à jour : 01 mai 2024