

FRIENDSHIP



FRIENDSHIP

APERÇU.

Launched in 2000 and refitted in 2015, FRIENDSHIP has become one of the top charter yachts on the market. With an enviable pedigree, the 52.8m (173.2ft) yacht was built by Oceanco, with naval architecture by The A Group and an interior design by Jean Pierre Fantini. With many unique attributes, including a split level master suite and the latest in AV equipment and amenities, she is the ideal choice for those looking to explore the world's finest cruising grounds in absolute luxury.

Guests boarding FRIENDSHIP from her swim platform will find a double set of steps leading up to the main deck. Greeted by an attentive crew of 12, settle into your accommodation in the main deck master suite, where you will be afforded breathtaking 180 degree views. This cabin also benefits from a private deck forward with a jacuzzi, and stairs leading down to a private study. Your guests will be shown to their very own comfortable rooms, which include three double and two twin suites on the lower deck.

Once all the guests are settled in, it's time to relax and kick back in style. FRIENDSHIP's design encourages nothing more than pure relaxation. Some guests may choose to head directly up to the flybridge deck where the entire space is dedicated to al fresco living. Take a dip in the jacuzzi surrounded by sun pads or on one of the loungers aft. When it comes to lunchtime, the upper deck is where it's at – with sumptuous seating and a large dining table, partially shaded by the overhang of the flybridge above.

Follow lunch with an afternoon of activities. Whether you choose to work out in the gym or dive into the water to play with her many toys, the crew on SUNRISE has it covered. The large swim platform provides easy access to her toybox, which includes jetskis, SeaBobs and plenty of towable toys. Alternatively, you could take the kayaks and paddleboards out to explore the coastline, donning your snorkel every so often to view the underwater world as you gently paddle along.

Back on board, as the children play in the playroom or watch a movie, take time to freshen up before a sundowner on one of her spacious aft decks, followed by either a casual al fresco dinner on the flybridge deck or a formal dinner in the main deck dining saloon. Whatever the occasion, with FRIENDSHIP's talented chef, rest assured your cuisine will be fresh and delicious, taking into consideration all your personal preferences.

Principales caractéristiques

ShowBoats Awards 2000 Highest Technical Achievement winner

Recently refitted

Private owner's deck

Exercise equipment

Jacuzzi on the sun deck and the foredeck

Zero speed stabilisers to reduce any rolling motion while at anchor

FRIENDSHIP

At anchor



Cruising



Sun deck



Sun deck jacuzzi

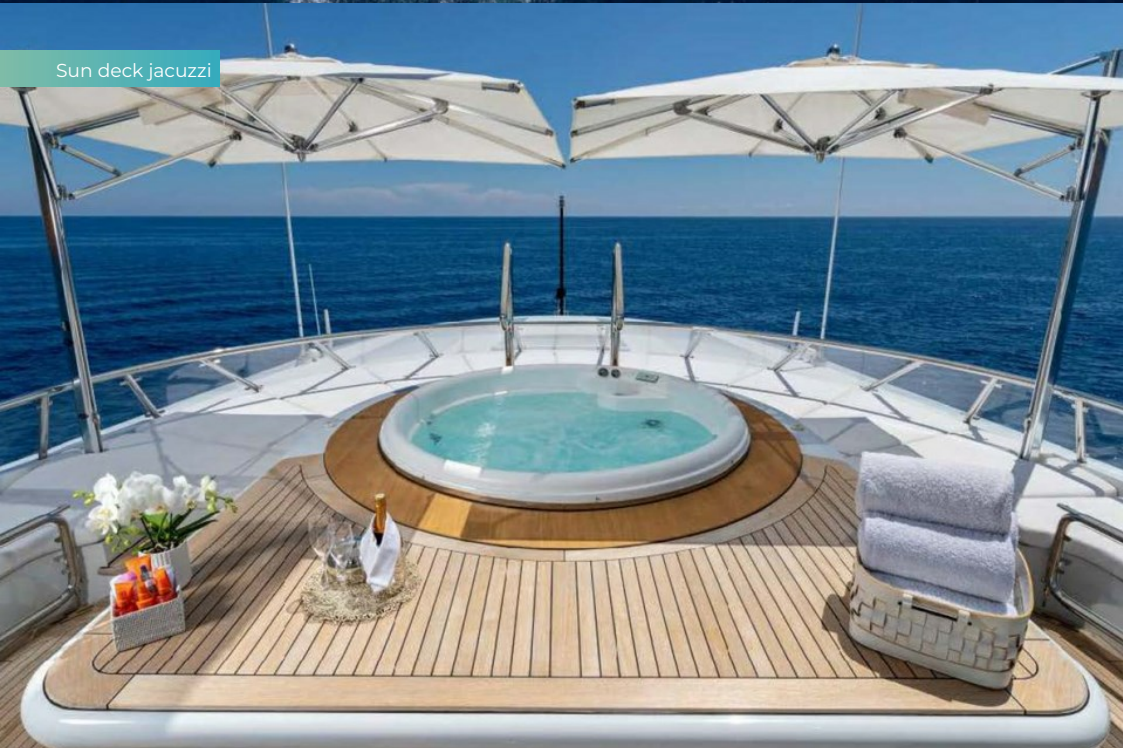

BURGESS

Discover the difference.
burgessyachts.com



FRIENDSHIP

Sun deck bar



Sun deck exercise equipment



Bridge deck aft



Bridge deck dining

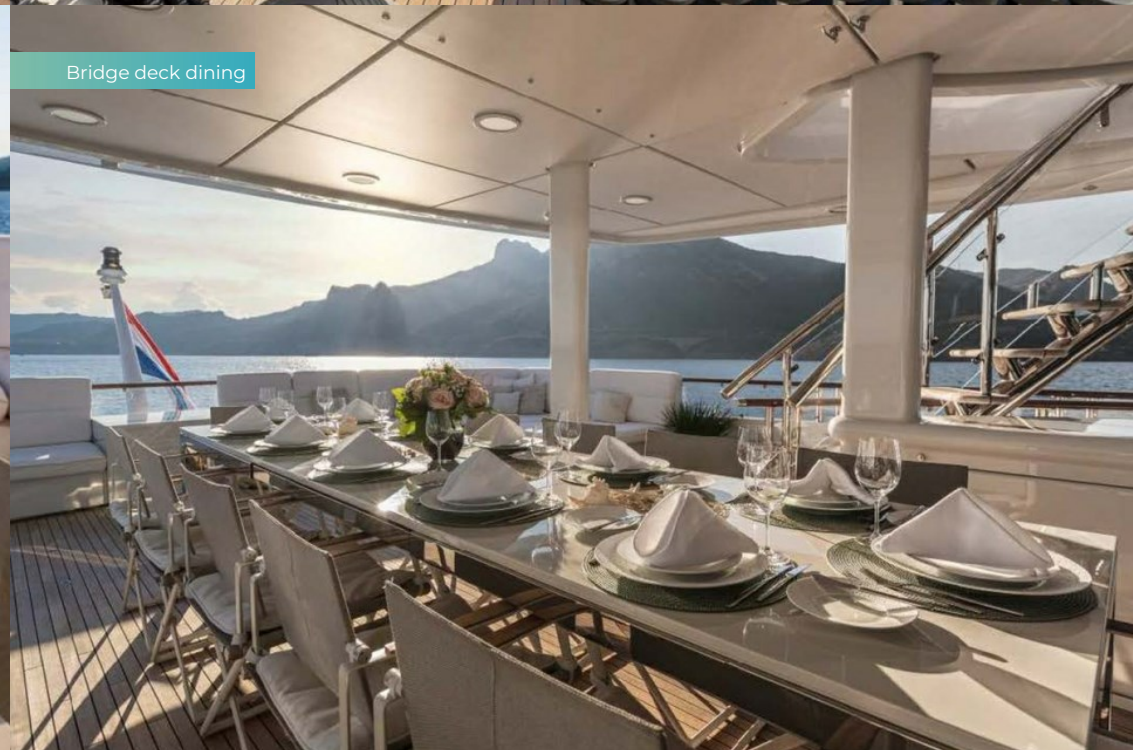

FRIENDSHIP

Foredeck



Foredeck jacuzzi



Main deck aft



Main deck lounge



FRIENDSHIP

Main deck dining



Sky lounge



Sky lounge bar



Main deck master cabin



FRIENDSHIP

Master cabin study



Master bathroom en suit



Lower deck double cabin



Guest bathroom en suite



FRIENDSHIP

Swim platform and toys



Lifestyle



At anchor



BURGESS

Discover the difference.
burgessyachts.com



FRIENDSHIP

SPECIFICATIONS.



Longueur
52,8m



Chantier
2000 (refitted 2022), Oceanco, The Netherlands



Largeur
9,5m



Tirant d'eau
3,8m



Tonnage brut
643



Vitesse de croisière
12 knots



Vitesse maximale
16 knots



Consommation de carburant en vitesse de croisière
350 litres par heure



Moteurs
2 x 1 710hp MTU



Invités
12



Nb de cabines invités
6 (4 x double, 2 x twin)



Équipage
12

Note

Fully licensed for charters in Spanish waters.

[Voir le yacht sur le site](#)



FRIENDSHIP

ANNEXES & JEUX NAUTIQUES



1 x Tender



2 x Deck jacuzzis



2 x Waverunners



2 x SeaBobs



2 x eFoil



2 x Kayaks



2 x Stand up paddleboards



Wakeboard



Kneeboard



Waterskis



Anti-jellyfish pool



Trampoline



Inflatable platform



Inflatable tows



Dive centre



Snorkelling gear



Fishing gear



RYA training centre for jetskis
& waverunners

FRIENDSHIP

REMISE EN FORME & BIEN-ETRE



Balance trainer



Cross trainer



Free weights



Training bench

FRIENDSHIP

Deck plans

SUN DECK

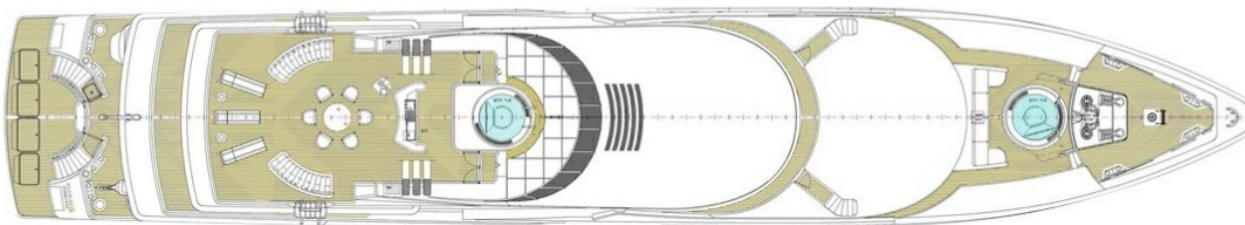

UPPER DECK



MAIN DECK

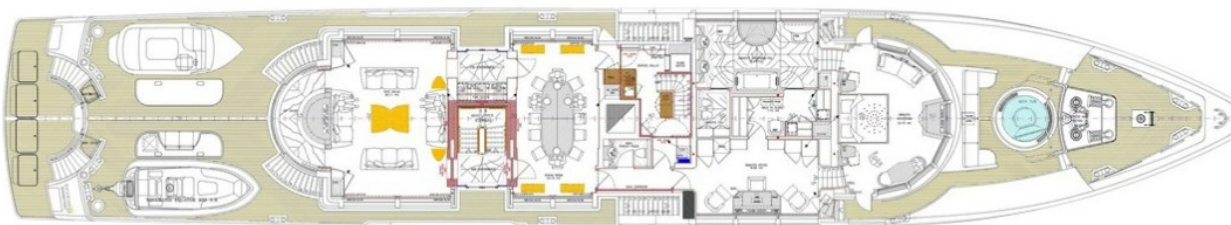

LOWER DECK

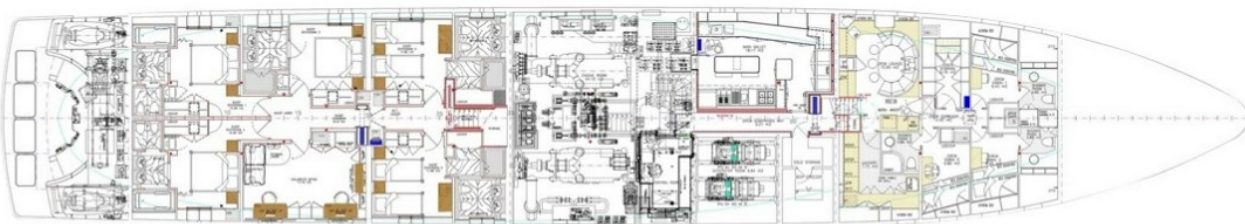

BURGESS

WORLD CLASS. WORLD WIDE.

London +44 20 7766 4300	Monaco +377 97 97 81 21	New York +1 212 223 0410	Miami +1 305 672 0150	Singapore +65 9665 8990	Beverly Hills +1 310 424 5112	Palma +34 971 495 413	Athens +30 210 967 1661
Dubai +971 4 425 5874	Phuket +66 7623 9739	Hong Kong +852 6496 2094	Tokyo +81 46 738 8612	Sydney +61 499 945 557	Mumbai +91 98211 67253	Shanghai +86 159 0162 1898	Rio de Janeiro +55 21 2553-3238
Aspen +1 970 710 2294							

La publicité de ce(s) navire(s) dans des publications imprimées, sur Internet ou sur tout autre support n'est pas autorisée sans l'autorisation écrite préalable de Burgess.
Toutes les informations sont données de bonne foi et sont considérées comme exactes, mais elles ne peuvent être garanties.

Dernière mise à jour : 06 mai 2025