

FORE ACES



FORE ACES

OVERVIEW.

If you've ever dreamed of voyaging to distant, sun-drenched shores with a cocktail in hand and a tropical yacht rock soundtrack from Jimmy Buffett, this one is for you. FORE ACES was Jimmy's own private yacht and his muse in later life – she is the quintessence of the Caribbean cruising lifestyle. All of that aside, she's an elegant and tasteful 38m (124ft) tri-deck yacht with some excellent features and a unique, easygoing charm.

FOUR ACES has refined modern-classic exterior styling with clean, crisp lines – she'll look great in your holiday photos. Her interior is an elegant, inviting and soothing place with fine craftsmanship clearly evident in the American cherry wood finish and touches of luxury throughout. She's designed to host up to 12 guests on board in a five-cabin layout, with service from a crew of six.

Key features include an abundance of outside living space with ample shade on all three levels, a superb and spacious main deck lounge, a master suite up front on the main deck, an excellent inventory of watersports equipment, and state-of-the-art stabilisers that minimise any rolling motion when she's anchored or under way.

Her sundeck has a jacuzzi pool with a big TV and a hardtop above for shade. The upper aft deck is a great open-air social hub with a sit-up cocktail bar and a nice arrangement of seating, lounging and dining areas. From here you can step straight into the skylounge, which is a cosy living room with comfy sofas and a huge TV – it's ideal for a cosy movie night on board.

The main deck aft is dedicated to al fresco dining with ten armchairs around a big table. Moving into the main deck lounge, you'll find another cocktail bar and a comfortable, elegant lounge, plus a stylish formal dining area up forward. There are excellent sea views from anywhere you might choose to sit and it's an open, airy space with plenty of natural light.

The master suite has a bright and relaxing feel, with two big windows on each side of the king size bed. Her other four guest cabins, all on the lower deck, are two doubles with queen size beds and two twins with extra pullman bunks, which are ideal for children. All cabins have their own private en suite bathrooms.

Her main guest tender is a 10m (34ft) powerboat that's fully rigged for fishing, with 700hp engines. She also carries a jet RIB for waterskiing, a giant water slide, SeaBobs, kayaks, paddleboards, inflatable tows and more.

Key features

Recently refitted

Flexible cabin configurations

10m Jupiter center console towed tender

Jacuzzi on the sun deck

Zero speed stabilisers to reduce any rolling motion while at anchor

FORE ACES



Sun deck jacuzzi



Bridge deck aft



Bridge deck aft



FORE ACES

Bridge deck bar



Bridge deck aft



Main deck aft dining area



Main deck lounge



FORE ACES

Main deck wet bar



Main deck dining area



Sky lounge



Main deck master cabin



FORE ACES

Main deck master cabin



Master bathroom en suite



Lower deck double cabin



Lower deck twin cabin



FORE ACES



Lifestyle



BURGESS

Discover the difference.
burgessyachts.com



FORE ACES

SPECIFICATION.



Length
37.8m (124ft)



Built
2003 (refitted 2021), Delta Marine, United States Of America



Interior designer
Delta Design Group



Beam
7.9m (25.9ft)



Draft
1.9m (6.2ft)



Gross tonnage
298



Cruising speed
12 knots



Maximum speed
15 knots



Fuel consumption at cruising speed
250 litres per hour



Engines
2 x 1,400hp Caterpillar



Guests
12



No. of guest cabins
5 (4 x double, 1 x twin, 2 x additional berths)



Crew
6

[View yacht on website](#)



FORE ACES

TENDERS & TOYS



1 × Towed tender



1 × Tender



1 × Deck jacuzzi



1 × Waverunner



2 × SeaBobs



2 × Kayaks



2 × Stand up paddleboards



Wakeboard



Waterskis



Waterslide



Inflatable tows



Snorkelling gear



Fishing gear

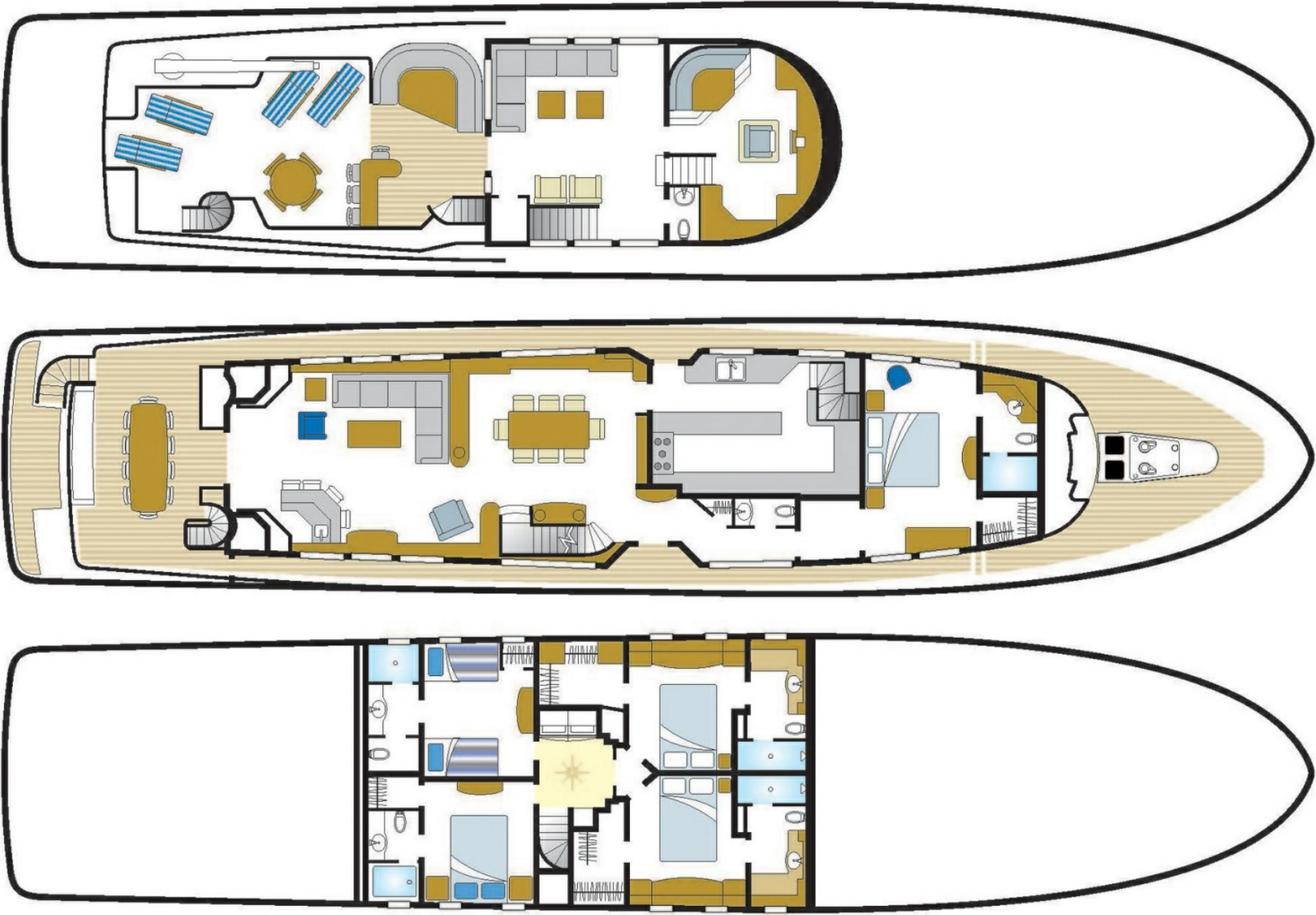

BURGESS

WORLD CLASS. WORLD WIDE.

London +44 20 7766 4300	Monaco +377 97 97 81 21	New York +1 212 223 0410	Miami +1 305 672 0150	Singapore +65 9665 8990	Beverly Hills +1 310 424 5112	Palma +34 971 495 413	Athens +30 210 967 1661
Dubai +971 4 425 5874	Phuket +66 7623 9739	Hong Kong +852 6496 2094	Tokyo +81 46 738 8612	Sydney +61 499 945 557	Mumbai +91 98211 67253	Shanghai +86 159 0162 1898	Rio de Janeiro +55 21 2553-3238
Aspen +1 970 710 2294							

Advertising of these vessel(s) in printed publications, on the internet or in any other medium is not permitted without prior written permission from Burgess. All particulars are given in good faith and are believed correct but they cannot be guaranteed.

Last updated: 23 May 2025