

# ESTHER 7

---



ESTHER 7

# SPECIFICATION.



Asking price  
USD 7,880,000



Built  
2014, Horizon Yachts, Taiwan



Length  
33.5m (110ft)



Beam  
7.6m (25ft)



Draft  
1.8m (6ft)



Gross tonnage  
227



Cruising speed  
15 knots



Maximum speed  
18 knots



Flag  
Panama



Lying  
Asia



Exterior designer  
Espinosa Yacht Design



Interior designer  
Espinosa Yacht Design



Construction  
Hull - GRP, Superstructure - GRP, Deck - Teak



Guests  
10



Cabins  
5 (3 x double, 2 x double/twin)



Engines  
2 x 1,800hp Caterpillar



Propulsion  
Twin screw diesel yacht

[View yacht on website](#)



ESTHER 7

Main saloon



Main saloon



Dining



Master cabin



ESTHER 7

VIP cabin



Twin guest cabin



Utility room



Bridge



ESTHER 7

Main aft



Sun deck



BURGESS

Discover the difference.  
burgessyachts.com



ESTHER 7

# OVERVIEW.

The 33.5m (110ft) motor yacht ESTHER 7, from Horizon Yachts' popular RP110 series, was constructed in fibreglass with naval architecture by Don Blount and contemporary interiors and exteriors by Espinosa Yachts Design. She was delivered in 2014.

The large sun deck has a deck crane for launching tender and toys, sunlounging deck space and a raised jacuzzi aft, and beneath the hardtop there is L-shaped seating around two tables port and starboard as well as a bar and BBQ. Forward there is forward facing seating to port, a flybridge helm station to starboard and behind a central sliding door are steps leading to the bridge, which has guest seating.

The main deck aft has open-air dining and a drop-down TV. Steps either side lead down to the large swim platform, which is used for toy stowage underway, and the tender garage, which also has internal access from the main deck aft. Walkaround sidedecks lead forward to a Portuguese bridge and large sunpad and full-height sliding glass doors open into the main saloon. Inside the main saloon, which has huge picture windows, is a fully equipped bar, making the main deck aft well suited to entertainment. There is an L-shaped lounge opposite a pop-up TV, a formal dining area forward and a dayhead off the main lobby.

The owner's suite, forward on the main deck, is well lit through large windows port and starboard and two circular skylights. There is a walk-in wardrobe and steps forward lead down to a marble bathroom with shower and bath. On the lower deck are two double guest suites and two twin guest suites, both of which have an additional berth, completing accommodation for 12 guests in five suites.

Twin 1,800hp Caterpillar diesel engines give her a top speed of 18 knots and a cruising speed of 15 knots.

## Key features

---

Very low engine and generator hours

---

Modern interior design

---

Stabilized at anchor and underway

---

Light use

---

Yearly maintenance undergone thoroughly

---

# SUN DECK

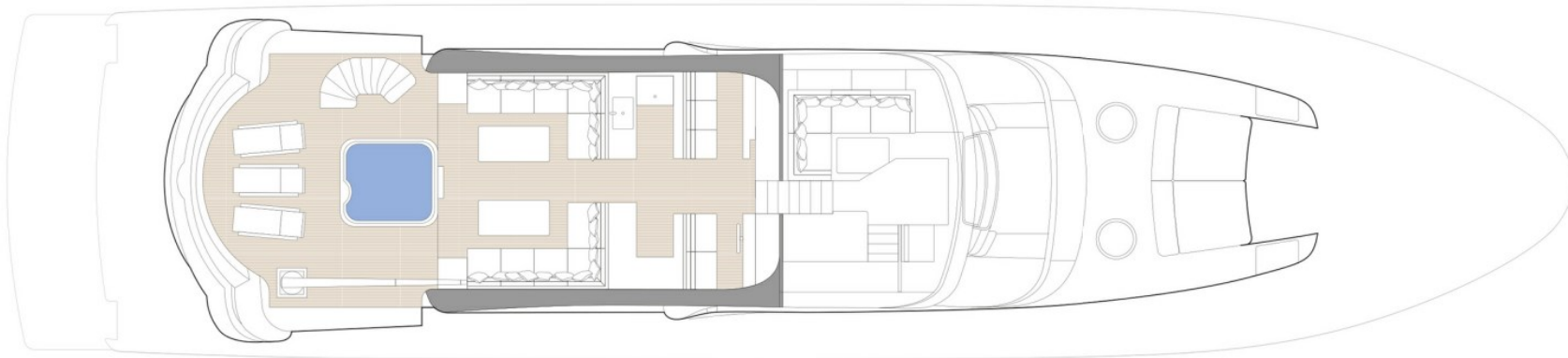

- GUEST AREAS
- OWNER'S SUITE
- GUEST CABINS
- JACUZZI

# MAIN DECK



■ GUEST AREAS   ■ OWNER'S SUITE   ■ GUEST CABINS   ■ JACUZZI



# LOWER DECK

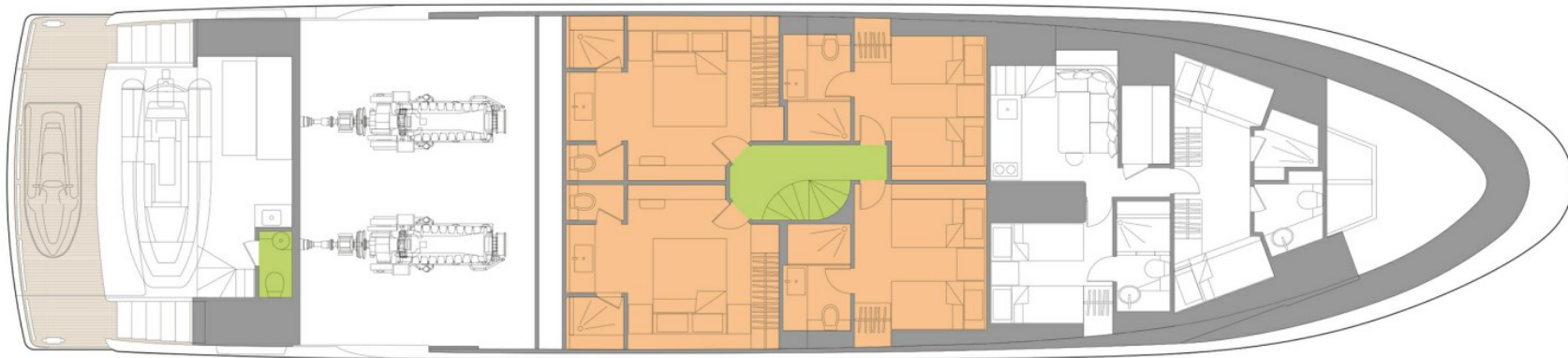

- GUEST AREAS
- OWNER'S SUITE
- GUEST CABINS
- JACUZZI

BURGESS

WORLD CLASS.  
WORLD WIDE.

London +44 20 7766 4300	Monaco +377 97 97 81 21	New York +1 212 223 0410	Miami +1 305 672 0150	Singapore +65 9665 8990	Beverly Hills +1 310 424 5112	Palma +34 971 495 413	Athens +30 210 967 1661
	Dubai +971 4 425 5874	Phuket +66 7623 9739	Hong Kong +852 6496 2094	Tokyo +81 46 738 8612	Sydney +61 499 945 557	Mumbai +91 98211 67253	

---

Advertising of these vessel(s) in printed publications, on the internet or in any other medium is not permitted without prior written permission from Burgess. All particulars are given in good faith and are believed correct but they cannot be guaranteed.

Last updated: 07 March 2024