

ELENI



ELENI

APERÇU.

Built in 2005 by CBI Navi, the 50m (164ft) ELENI blends the refined elegance of a gentleman's club with spectacular, traditionally styled interiors by Luca Dini and spacious al fresco living areas for fun on the water. Refitted in 2018, she accommodates 12 guests in six spacious cabins, including a full beam master suite with office and two VIP cabins. Step on board this spacious motor yacht and enjoy a fun-fuelled charter with her exceptional crew of 13.

However you wish to begin your first morning on board ELENI, weather permitting it should be outside taking advantage of your beautiful surroundings both on board ELENI and the destination around you. The sun deck is the hub of this luxury charter yacht during the day. Here the jacuzzi is flanked by oversized sun pads, while aft is a large lounging area with sofas and clamshell awning daybeds. Spend a relaxing few hours up here while your crew prepare lunch to be enjoyed on the upper deck beneath the shade of the sun deck overhang. Aft of the large dining area is a comfortable seating space where you might like to relax with a book, or join the other guests on board and make plans for the afternoon ahead.

The large and bright main saloon and sky lounge are finished in rich woods with light fabrics and furnishings. Devoid of clutter, they provide a calm and relaxing space to escape the heat of the midday sun or to relax during that twilight period between sundowners and dinner. Some guests might prefer to take full advantage of all the amenities both on board and in the water. ELENI offers an array of water toys including Sea-Doo jetskis, SeaBobs, waterskis and wakeboards. She also has the latest inflatables including a large inflatable slide, providing fun for all the family. Other guests might prefer to head up to sun deck, where the glass-enclosed and air-conditioned gym affords panoramic views that should inspire your workout.

Whether you have worked up an appetite or not, dinner is always a special occasion when prepared by ELENI's Michelin trained chef, whose style of cooking is classical with a modern twist. Choose to dine al fresco on the upper deck, or change it up with dinner in the main deck dining saloon. Finish off your first day on board with a nightcap on the main deck aft, where sumptuous sofas will leave you fully relaxed and ready for a deep slumber in your luxury cabin.

Principales caractéristiques

Regularly maintained

Two VIP cabins

Exercise equipment

11m Wellcraft Scarab chase tender

Jacuzzi on the sun deck

Zero speed stabilisers to reduce any rolling motion while at anchor

ELENI

Sun deck jacuzzi



Sun deck jacuzzi

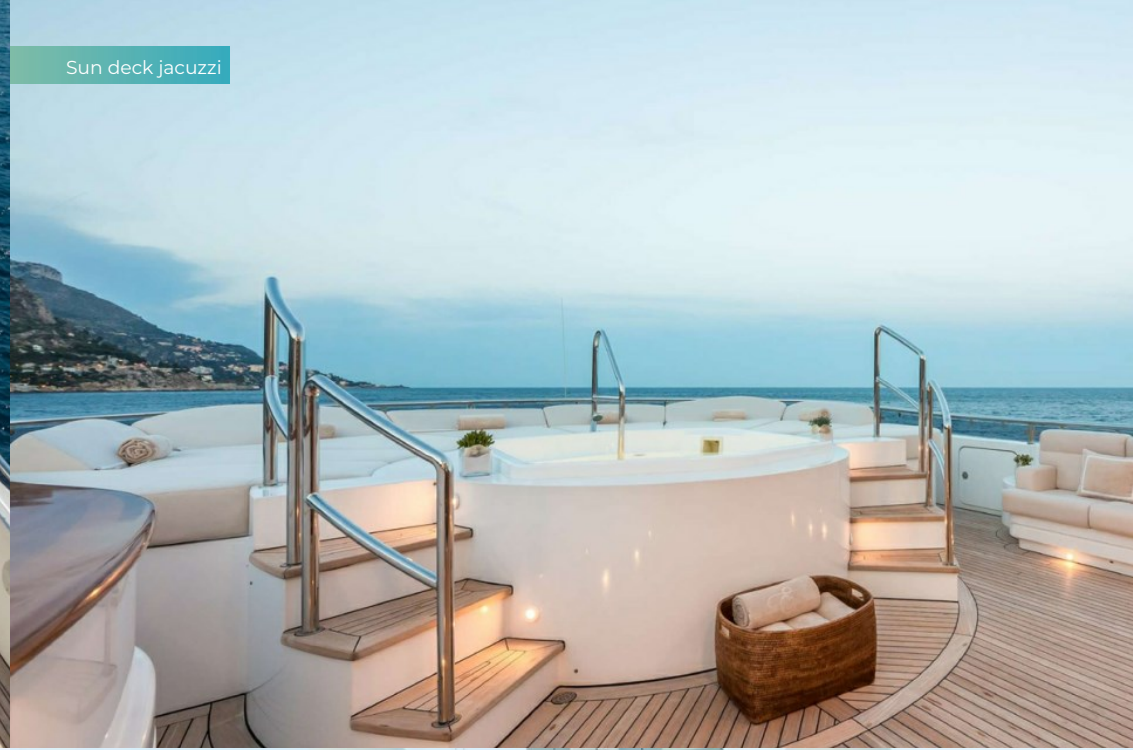

Sun deck gym



Sun deck



ELENI

Sun deck loungers



Sun deck aft loungers



Upper deck aft dining area



Side deck



BURGESS

Discover the difference.
burgessyachts.com



ELENI

Main deck aft seating area



Main deck lounge



Main deck dining area



Main deck dining area



ELENI

Sky lounge



Sky lounge



Sky lounge



Main deck owner's private office



ELENI

Main deck owner's cabin



Lower deck double cabin



Lower deck double cabin



Lower deck twin cabin



ELENI

Tender



Portugese bridge



ELENI

SPECIFICATIONS.



Longueur
50m



Chantier
2005 (refitted 2018), CBI Navi, Italy



Designer d'intérieur
Luca Dini Design/Giorgio Radice



Largeur
9,3m



Tirant d'eau
3,1m



Tonnage brut
663



Vitesse de croisière
13 knots



Vitesse maximale
16 knots



Consommation de carburant en vitesse de croisière
550 litres par heure



Moteurs
2 x 2 200hp Caterpillar



Invités
12



Nb de cabines invités
6 (5 x double, 1 x twin)



Équipage
13

Note

Fully licensed for charters in Spanish waters.

[Voir le yacht sur le site](#)

[Regarder la vidéo du yacht](#)



ELENI

ANNEXES & JEUX NAUTIQUES



1 x Towed tender



1 x Tender



1 x Deck jacuzzi



Waterslide



RYA training centre for jetskis & waverunners



2 x Waverunners



2 x SeaBobs



2 x Stand up paddleboards



Wakeboard



Waterskis



Inflatable tows

ELENI

REMISE EN FORME & BIEN-ETRE



Cross trainer



Rowing machine



Treadmill



Upright stationary bike



ELENI

COMMUNICATION ET DIVERTISSEMENT



Satcom & cellular communications facilities



Wi-Fi internet access



Starlink



Speaker systems



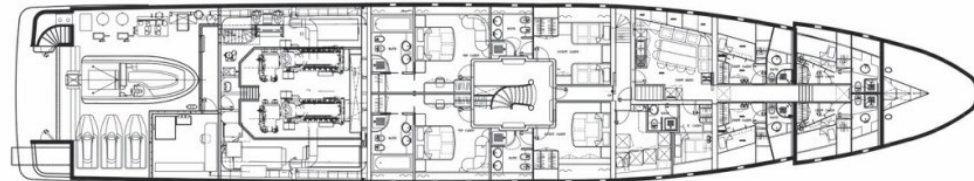
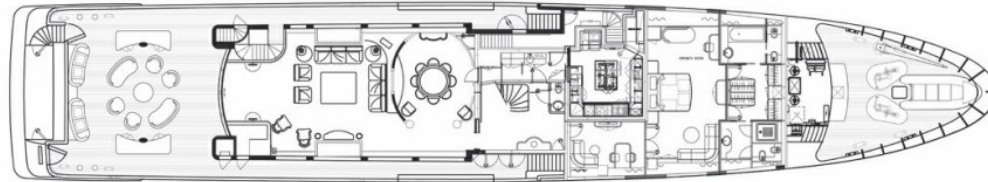
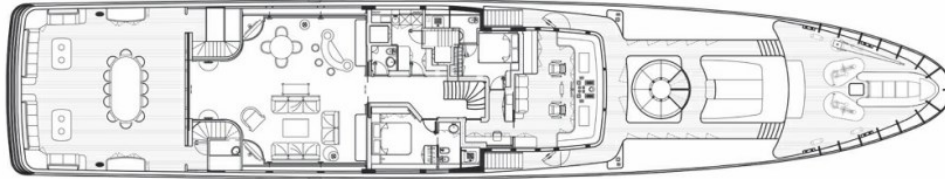
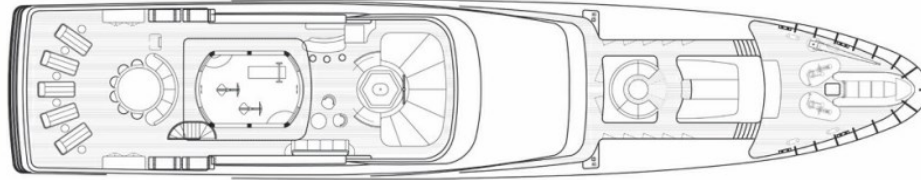

BURGESS

WORLD CLASS. WORLD WIDE.

London +44 20 7766 4300	Monaco +377 97 97 81 21	New York +1 212 223 0410	Miami +1 305 672 0150	Singapore +65 9665 8990	Beverly Hills +1 310 424 5112	Palma +34 971 495 413	Athens +30 210 967 1661
Dubai +971 4 425 5874	Phuket +66 7623 9739	Hong Kong +852 6496 2094	Tokyo +81 46 738 8612	Sydney +61 499 945 557	Mumbai +91 98211 67253	Shanghai +86 187 0898 6800	Rio de Janeiro +55 21 2553-3238
Aspen +1 970 710 2294							

La publicité de ce(s) navire(s) dans des publications imprimées, sur Internet ou sur tout autre support n'est pas autorisée sans l'autorisation écrite préalable de Burgess.
Toutes les informations sont données de bonne foi et sont considérées comme exactes, mais elles ne peuvent être garanties.

Dernière mise à jour : 14 janvier 2025