

DOKINHA



DOKINHA

OVERVIEW.

Step aboard DOKINHA, the epitome of modern luxury, where breathtaking design meets unparalleled performance. Launched in 2024 by Overmarine Group and designed by the visionary Alberto Mancini, her sleek exterior lines and sophisticated, contemporary interior promise to redefine your charter experience.

Accommodating up to 12 guests, DOKINHA boasts six exquisitely appointed suites. The main deck master suite is a sanctuary, featuring a private balcony on the starboard side, an electric fireplace, and luxurious his-and-hers bathrooms. The full-beam VIP suite, accessed by a private staircase offers the utmost in privacy and comfort, while the other guest cabins are spacious and individually styled.

The yacht's expansive interiors are bathed in natural light, with floor-to-ceiling windows providing stunning views. The seamless flow between indoor and outdoor spaces gives a feeling of openness throughout the yacht.

The foredeck features the largest infinity pool ever created by Mangusta, offering semi-submerged sunbeds. For those seeking more excitement, the sun deck is a vibrant space for entertainment, complete with a jacuzzi, an al fresco dining area, and workout equipment.

The beach club on DOKINHA is a true retreat, offering fold-out terraces on three sides that connect guests directly to the water. With teak wall panelling, built-in towel rails, and comfortable loose seating, this space is ideal for lounging, diving into water sports, or simply enjoying the close connection to the ocean. Zero-speed stabilisers guarantee a smooth and comfortable experience whether at anchor or cruising. A towed tender is also available to explore nearby destinations with ease.

With a dedicated crew of 11, whether you're seeking relaxation, adventure, or both, DOKINHA is waiting to create unforgettable memories for you and your guests.

Key features

Stunning contemporary interior with a lot of natural light

Full-beam master suite with private balcony

Full-beam VIP cabin with private stair access

Flexible accommodation

Sprawling beach club with fold-out terraces on three sides

Expansive sun deck with al fresco dining, exercise equipment and jacuzzi

Variety of al fresco dining areas

Large foredeck infinity pool with sun loungers

Zero speed stabilisers to reduce any rolling motion while at anchor

DOKINHA

At anchor



Main deck aft



Main deck aft



Main deck lounge



DOKINHA

Main deck lounge



Main deck lounge



Main deck dining



Main deck dining



DOKINHA

Main deck dining



Master cabin



Master cabin



Master cabin



DOKINHA

Master cabin



Master cabin balcony



Master walk-in wardrobe



Master cabin en suite



DOKINHA

Master cabin en suite



Master cabin en suite

VIP cabin private staircase



VIP cabin



DOKINHA

VIP cabin



VIP cabin

VIP cabin



VIP cabin



BURGESS

Discover the difference.
burgessyachts.com



DOKINHA

Lower deck foyer



Double cabin



Double cabin



Double cabin



BURGESS

Discover the difference.
burgessyachts.com



DOKINHA

Convertible double/twin cabin



Convertible double/twin cabin



Cuést en suite



Cuést en suite



DOKINHA

Sky lounge



Sky lounge



Sky lounge



Sky lounge



BURGESS

Discover the difference.
burgessyachts.com



DOKINHA

Sky lounge



Bridge deck aft



Bridge deck aft



Sun deck



BURGESS

Discover the difference.
burgessyachts.com



DOKINHA

Sun deck



Sun deck dining



Sun deck



Sun deck



BURGESS

Discover the difference.
burgessyachts.com



DOKINHA

Foredeck



Foredeck



Foredeck



Foredeck



BURGESS

Discover the difference.
burgessyachts.com



DOKINHA

Foredeck



Foredeck



Beach club



Beach club



DOKINHA

Beach club



Beach club



At anchor



Beach club



BURGESS

Discover the difference.
burgessyachts.com



DOKINHA

At anchor



Aerial



Chase tender



Aerial



BURGESS

Discover the difference.
burgessyachts.com



DOKINHA

SPECIFICATION.



Length
49.9m (163.7ft)



Built
2024, Overmarine, Italy



Interior designer
TBD



Beam
9.1m (29.8ft)



Draft
2.7m (8.9ft)



Gross tonnage
499



Cruising speed
11 knots



Maximum speed
16 knots



Engines
2 x 1,724hp MTU



Guests
12



No. of guest cabins
6 (4 x double, 2 x double/twin, 3 x additional berths)



Crew
11

Note

Not available for charter to US residents while in US waters. Registered under the Yacht Engaged in Trade scheme (YET). All Mediterranean charters must start in either the South of France, Monaco or Corsica. For all charters, the principal charterer must be a non-EU resident.

[View yacht on website](#)



DOKINHA

TENDERS & TOYS



1 × Towed tender



1 × Tender



1 × Deck jacuzzi



2 × Waverunners



2 × SeaBobs



2 × Stand up paddleboards



Scuba diving equipment



Snorkelling gear



Fishing gear

11.3m (37ft) Pursuit center console | 6.4m (21ft) Williams jet 625 tender | 2 x Sea-Doo jetskis | 2 x SeaBobs (iAqua Nano Darts) | 2 x Stand up paddle boards (inflatable) | Snorkeling gear | Fishing gear | Beach party set up for 12: BBQ, table and chairs for 12 pax plus canopy | Games: Chess, playing cards, backgammon, dominos

DOKINHA

FITNESS & WELLNESS



Free weights



Resistance bands



Treadmill



Upright stationary bike



Yoga mats

Treadmill | Exercise bike | Ankle weights | Pilates rings | Yoga mats | Dumbbells | Weighted vest | Resistance bands



DOKINHA

COMMUNICATION & ENTERTAINMENT



Satcom & cellular communications facilities



Wi-Fi internet access



Starlink



Satellite television



Speaker systems



Streaming services

Comprehensive audio-visual systems and satellite television | Satcom & cellular communications facilities | Wi-Fi internet access

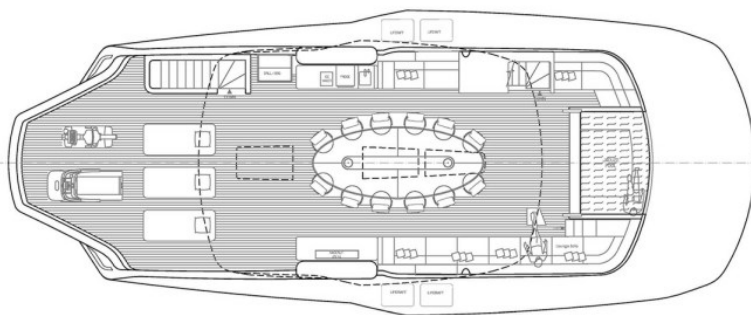

SUN DECK

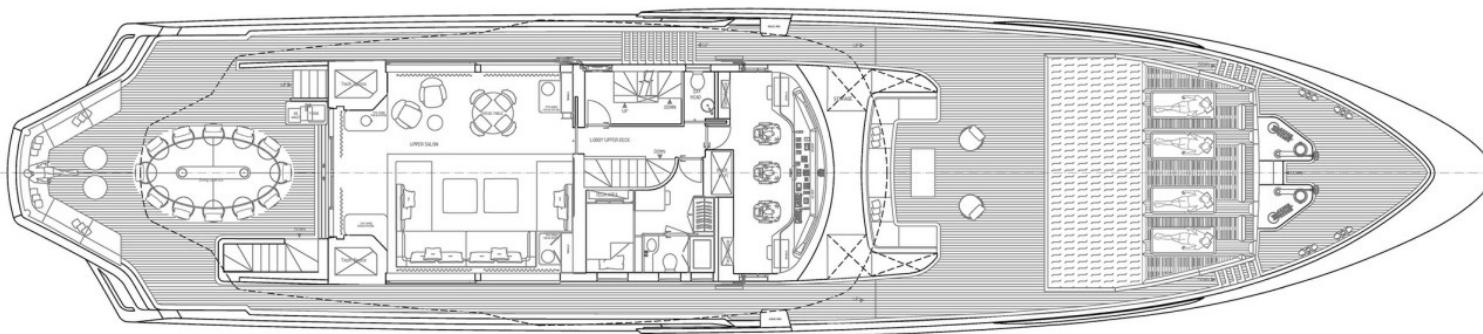

UPPER DECK

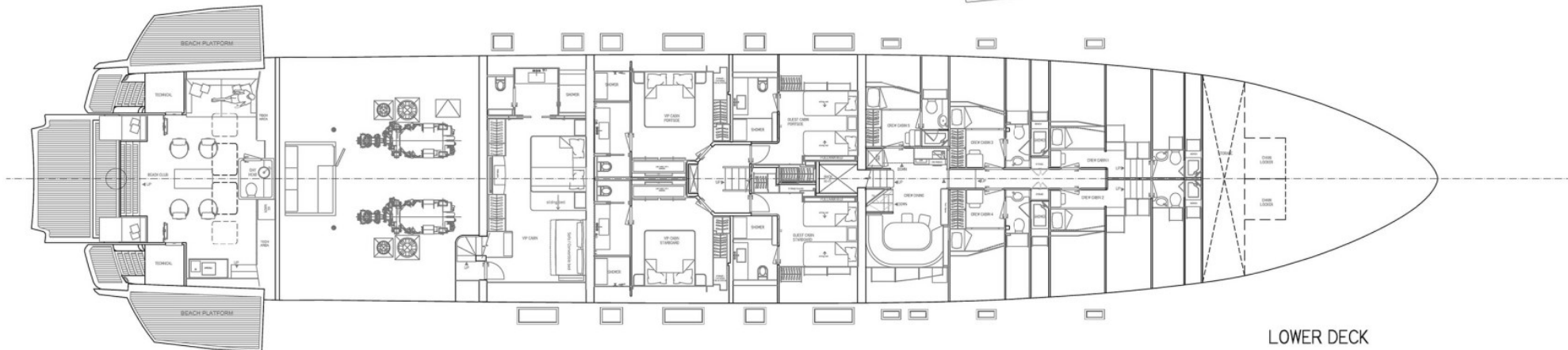
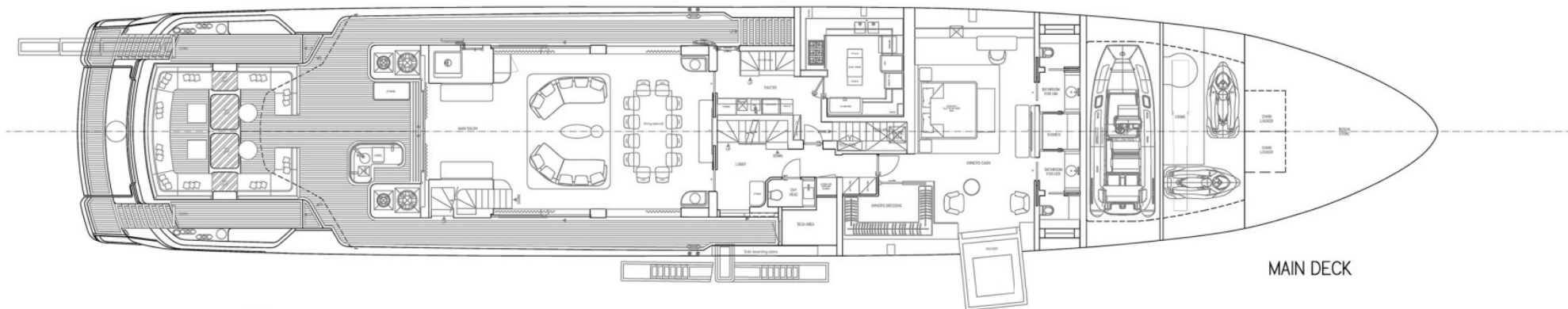

BURGESS

WORLD CLASS. WORLD WIDE.

London +44 20 7766 4300	Monaco +377 97 97 81 21	New York +1 212 223 0410	Miami +1 305 672 0150	Singapore +65 9665 8990	Beverly Hills +1 310 424 5112	Palma +34 971 495 413	Athens +30 210 967 1661
Dubai +971 4 425 5874	Phuket +66 7623 9739	Hong Kong +852 6496 2094	Tokyo +81 46 738 8612	Sydney +61 499 945 557	Mumbai +91 98211 67253	Shanghai +86 159 0162 1898	Rio de Janeiro +55 21 2553-3238
Aspen +1 970 710 2294							

Advertising of these vessel(s) in printed publications, on the internet or in any other medium is not permitted without prior written permission from Burgess. All particulars are given in good faith and are believed correct but they cannot be guaranteed.

Last updated: 23 July 2025